

F.A.U. RTE.	SECTION	COUNTY	TOTAL SHEETS	SHEET NO.
0085	00-00246-02-FP	MCHENRY	292	290
STA. 30+50.00		TO STA. 31+50.00		
FED. ROAD DIST. NO. 1		ILLINOIS FED. AID PROJECT		
CONTRACT NO. 63522				

NOTE: THE EXACT LOCATION AND ELEVATION OF EXISTING STRUCTURES, UTILITIES, AND PIPING SHALL BE VERIFIED IN THE FIELD BY THE CONTRACTOR.

FINAL SURVEY	DATE
BY	
REVIEWED	
DATE	
BY	
REVIEWED	
DATE	
BY	
REVIEWED	
DATE	
BY	
REVIEWED	
DATE	

ORIGINAL SURVEY	DATE
BY	
REVIEWED	
DATE	
BY	
REVIEWED	
DATE	
BY	
REVIEWED	
DATE	
BY	
REVIEWED	
DATE	

STANWEL
 1.2.3.4.5.6.7.8.9.10.11.12.13.14.15.16.17.18.19.20.21.22.23.24.25.26.27.28.29.30.31.32.33.34.35.36.37.38.39.40.41.42.43.44.45.46.47.48.49.50.51.52.53.54.55.56.57.58.59.60.61.62.63

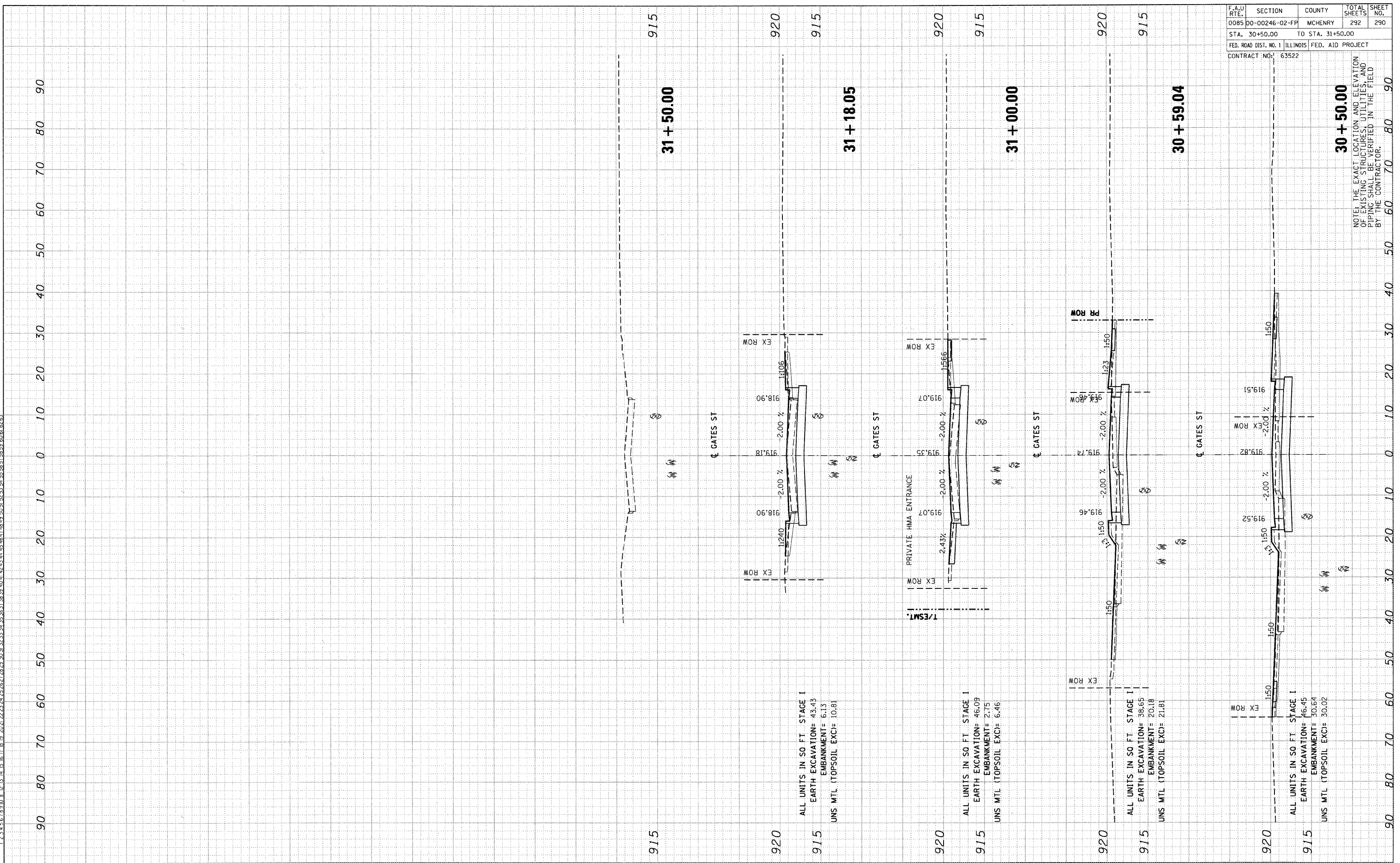

ALL UNITS IN 50 FT. STAGE I
 EARTH EXCAVATION= 43.43
 EMBANKMENT= 6.13
 UNS MTL (TOPSOIL EXC)= 10.81

ALL UNITS IN 50 FT. STAGE I
 EARTH EXCAVATION= 46.09
 EMBANKMENT= 2.75
 UNS MTL (TOPSOIL EXC)= 6.46

ALL UNITS IN 50 FT. STAGE I
 EARTH EXCAVATION= 38.65
 EMBANKMENT= 20.18
 UNS MTL (TOPSOIL EXC)= 21.81

ALL UNITS IN 50 FT. STAGE I
 EARTH EXCAVATION= 46.45
 EMBANKMENT= 30.64
 UNS MTL (TOPSOIL EXC)= 30.02

PROPOSED CROSS-SECTIONS: GATES STREET