

POT Sta. 10+00.00

10+00

ILLINOIS ROUTE 22

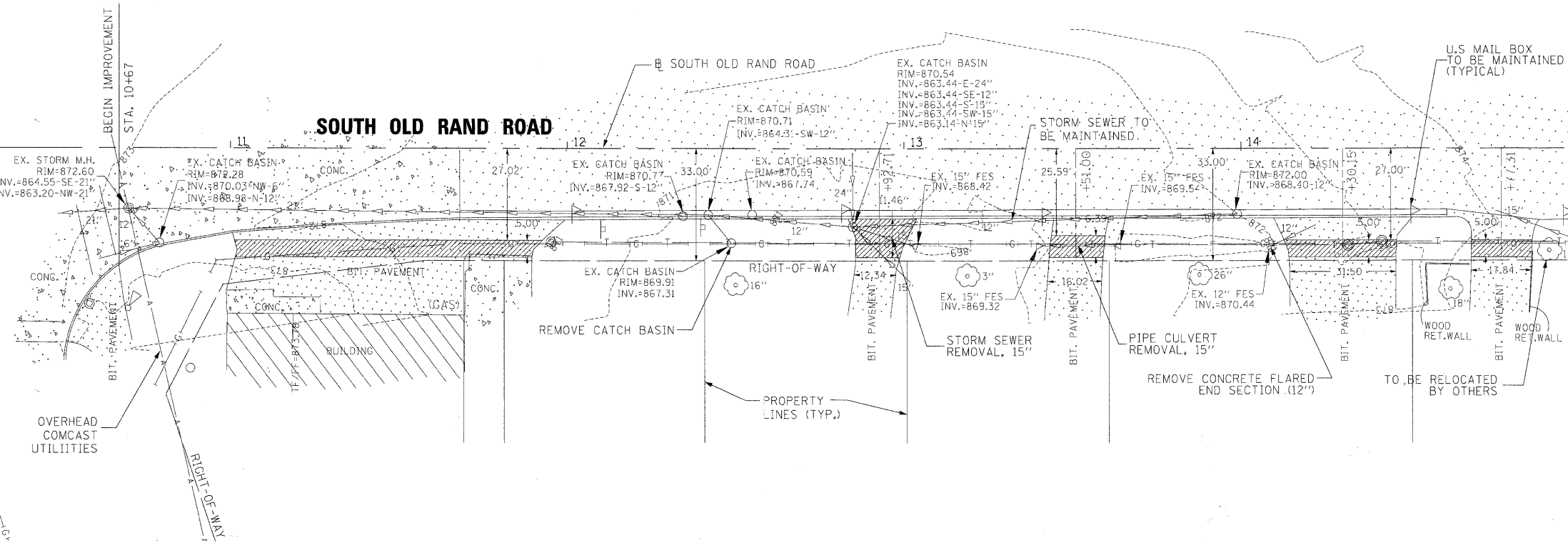

MATCHLINE STA. 15+00

MATCHLINE STA. 15+00

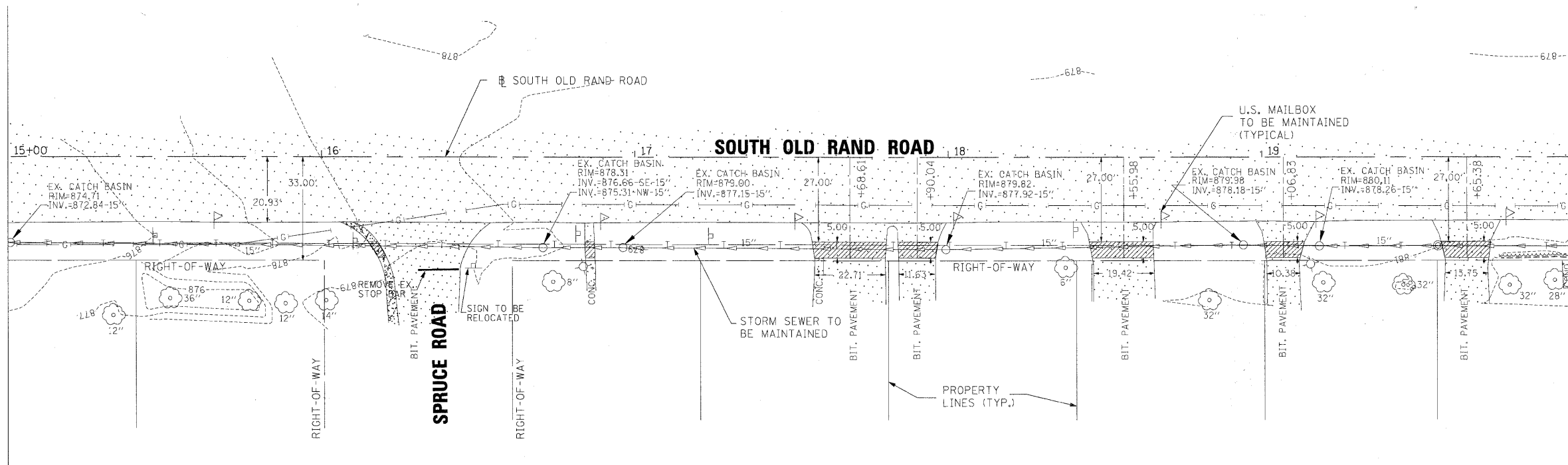

MATCHLINE STA. 20+00

LEGEND	
EXISTING ELEMENTS	
	SANITARY SEWER
	STORM SEWER
	WATERMAIN
	TELEPHONE
	MANHOLE
	CATCH BASIN
	VALVE VAULT
	FIRE HYDRANT
	UTILITY POWER POLE
	GAS VALVE/METER
	MAILBOX
	TRAFFIC SIGN
	TRAFFIC LIGHT
	TREE W/DIAMETER
	UTILITY LIGHT POLE
REMOVALS	
	TREE REMOVAL
	DRIVEWAY/SIDEWALK PAVEMENT REMOVAL
	PAVEMENT REMOVAL

FILE NAME =	DESIGNED LSM	REVISED -
USER NAME = TRICE	DRAWN AO	REVISED -
PLOT DATE = 03/28/2011	CHECKED OIU	REVISED -
	DATE 03/28/2011	REVISED -

2im GROUP
 2IM Group, LLC
 203 North Wabash Avenue
 Suite 604
 Chicago, IL 60601

STATE OF ILLINOIS
 DEPARTMENT OF TRANSPORTATION

VILLAGE OF LAKE ZURICH
 REMOVAL PLAN - SOUTH OLD RAND ROAD

SCALE: SHEET NO. 1 OF 4 SHEETS STA. 10+00 TO STA. 20+00

F.A.U. RTE. 3504	SECTION 09-00071-00-SW	COUNTY LAKE	TOTAL SHEETS 27	SHEET NO. 9
CONTRACT NO. 63589				
ILLINOIS FED. AID PROJECT				