

MATCHLINE STA. 20+00

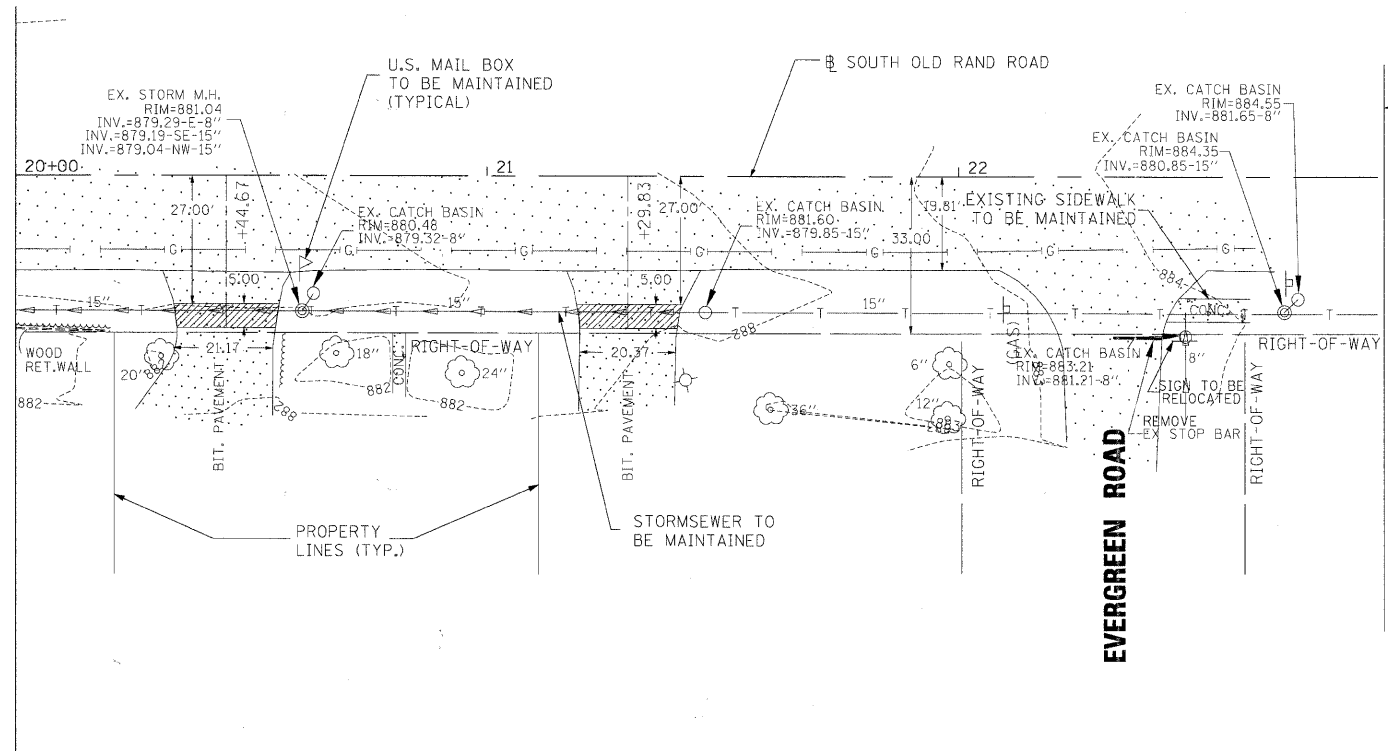

WORK OMISSION
FROM STATION 22+50
(EVERGREEN ROAD) TO
STATION 29+00
(CEDAR ROAD).

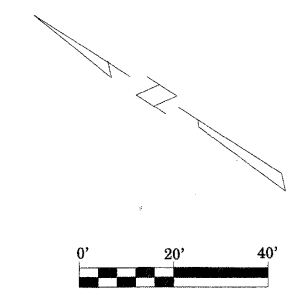

LEGEND

EXISTING ELEMENTS

- SANITARY SEWER
- STORM SEWER
- w— WATERMAIN
- T— TELEPHONE
- ⊙ MANHOLE
- CATCH BASIN
- (WV) VALVE VAULT
- ⊕ FIRE HYDRANT
- ⊠ UTILITY POWER POLE
- (GAS) GAS VALVE/METER
- ⊠ MAILBOX
- ⊠ TRAFFIC SIGN
- ⊠ TRAFFIC LIGHT
- 18" TREE W/DIAMETER
- UTILITY LIGHT POLE

REMOVALS

- ⊗ 18" TREE REMOVAL
- ▨ DRIVEWAY/SIDEWALK PAVEMENT REMOVAL
- ▩ PAVEMENT REMOVAL

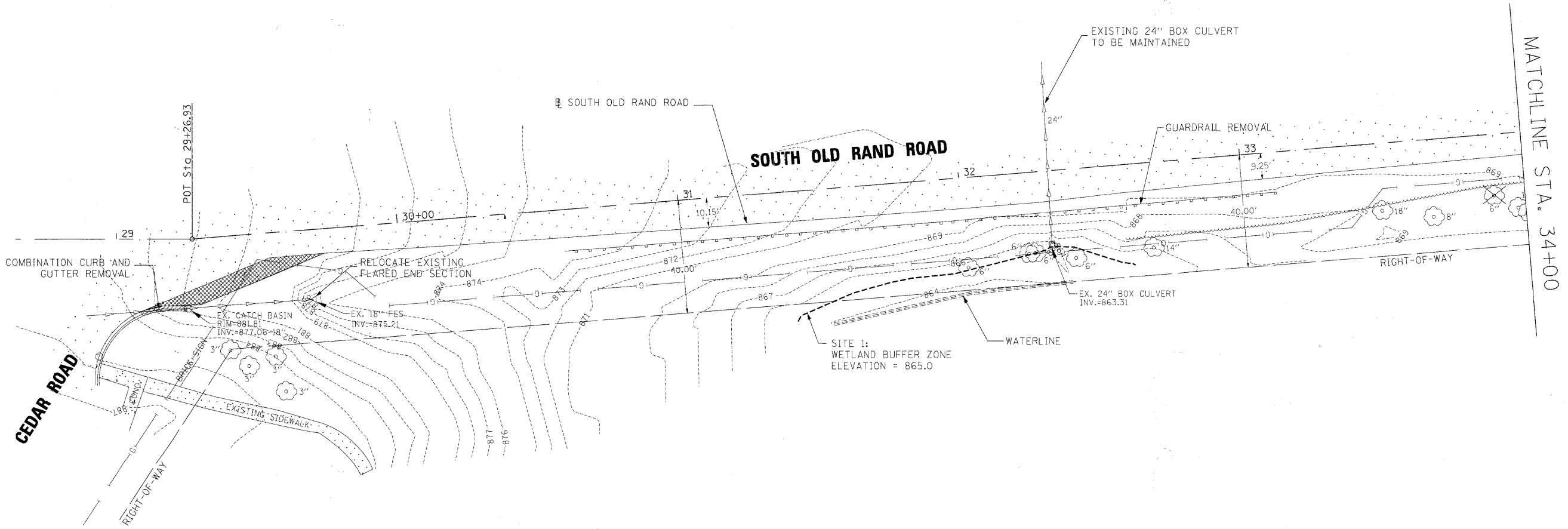

FILE NAME =	DESIGNED <i>LSM</i>	REVISED -
USER NAME = TRICE	DRAWN <i>AO</i>	REVISED -
PLOT DATE = 03/28/2011	CHECKED <i>OTU</i>	REVISED -
	DATE <i>03/28/2011</i>	REVISED -



**STATE OF ILLINOIS
DEPARTMENT OF TRANSPORTATION**

VILLAGE OF LAKE ZURICH REMOVAL PLAN - SOUTH OLD RAND ROAD	
SCALE:	STATION 20+00 TO STATION 34+00

F.A.U. RTE. 3504	SECTION 09-00071-00-SW	COUNTY LAKE	TOTAL SHEETS 27	SHEET NO. 10
CONTRACT NO. 63589				
[ILLINOIS] FED. AID PROJECT				