

PROPOSED SIDEWALK CROSS-SECTIONS - PORTER DRIVE - STA 9+10 TO STA 11+35
SCALE: 1" = 5' H & V

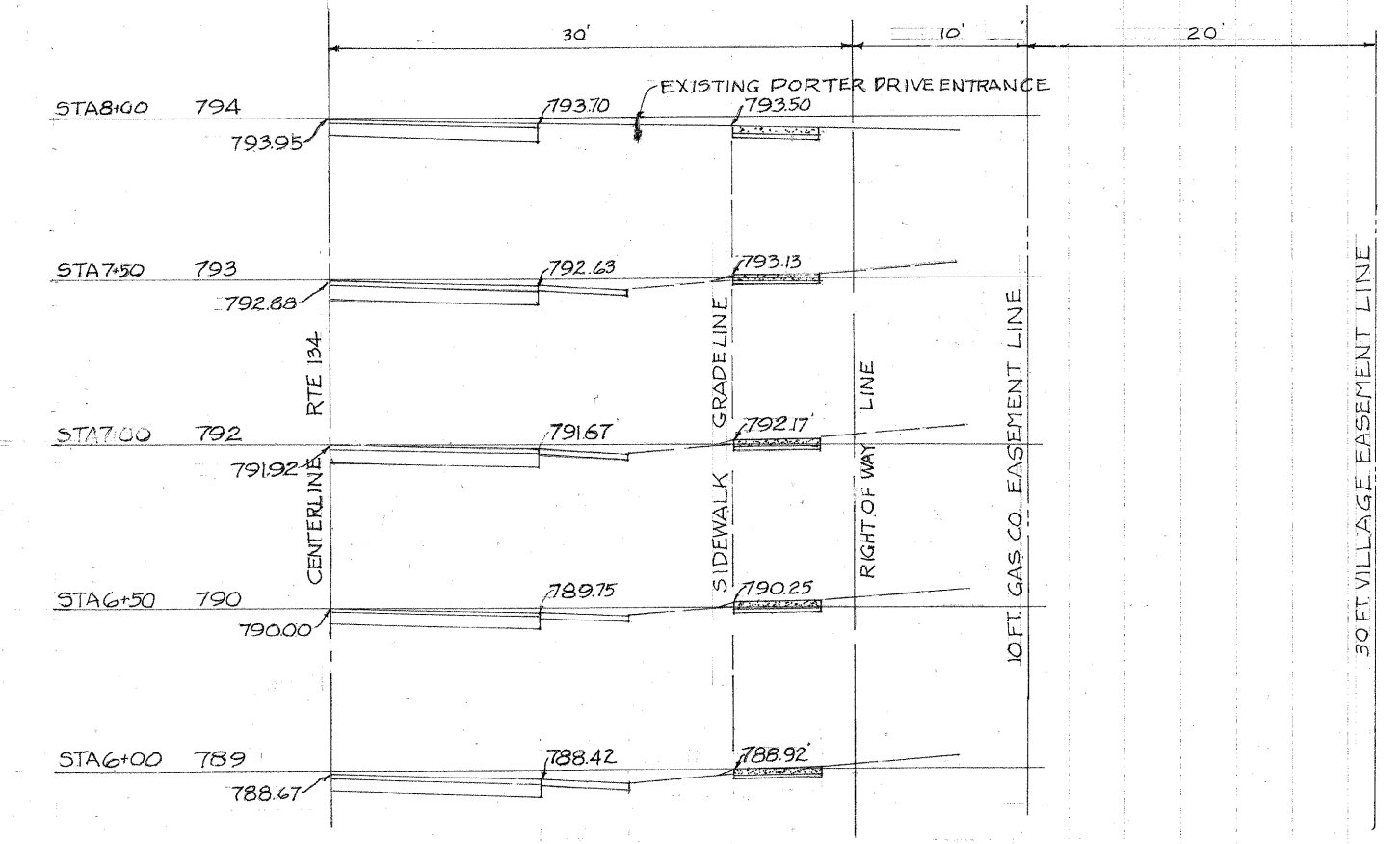

STATE OF ILLINOIS
DEPARTMENT OF TRANSPORTATION

CROSS-SECTIONS

DESIGNED	REVISD
DRAWN	REVISD
CHECKED	REVISD
DATE	REVISD

F.A.U. SECTION	COUNTY	TOTAL SHEETS	SHEET NO.
0188 10-00032-00-SW	LAKE	16	13
ILLINOIS		CONTRACT NO. 63599	
SCALE: 1" = 5' H & V		SHEET NO. 3 OF 16 SHEETS	
STA 2+50 TO STA 11+35		CONTRACT NO. 63599	