

- REMOVAL LEGEND**
- [Hatched Box] DENOTES HOT-MIX ASPHALT SURFACE REMOVAL, 3"
 - [Hatched Box] DENOTES DRIVEWAY PAVEMENT REMOVAL
 - [Hatched Box] DENOTES HOT-MIX ASPHALT SURFACE REMOVAL
 - [Hatched Box] DENOTES SIDEWALK REMOVAL
 - [Hatched Box] DENOTES COMBINATION CURB AND GUTTER REMOVAL
 - [Star] DENOTES ALLEY RETURN TO BE REMOVED WITH "PAVEMENT REMOVAL"

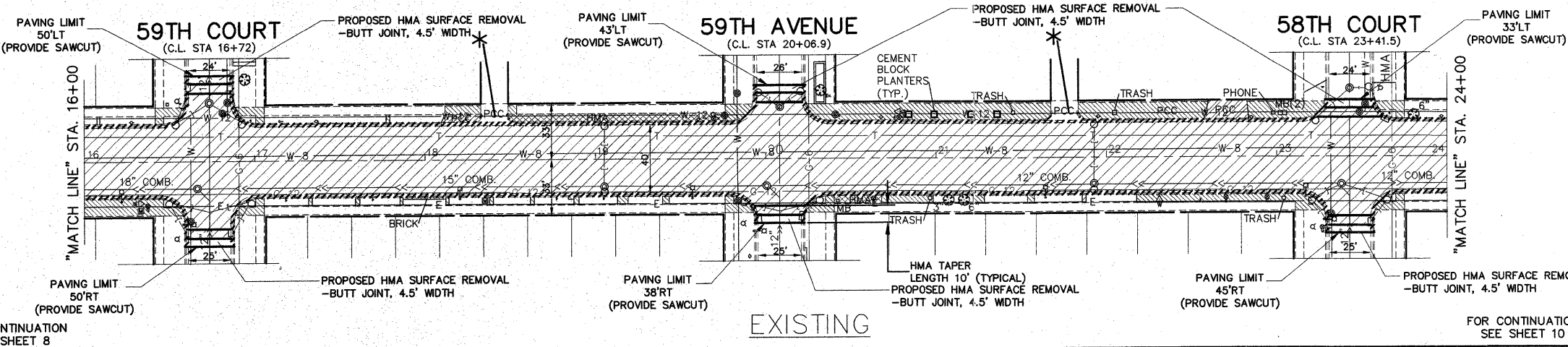

- PROPOSED PAVEMENT LEGEND**
- [Hatched Box] DENOTES PROPOSED P.C. CONCRETE DRIVEWAY PAVEMENT, 7 INCH
 - [Hatched Box] DENOTES PROPOSED INCIDENTAL HOT-MIX ASPHALT SURFACING
 - [Hatched Box] DENOTES PROPOSED PORTLAND CEMENT CONCRETE SIDEWALK, 5" (7" THICKNESS AT DRIVEWAYS)
 - [Hatched Box] DENOTES P.C. CONCRETE SIDEWALK, 5 INCH WITH DETECTABLE WARNING STRIP WHERE APPLICABLE
 - [Hatched Box] DENOTES "COMBINATION CONCRET CURB AND GUTTER, TYPE B-V.12" (DEPRESS AT SIDEWALK AND DRIVEWAYS)
 - [Star] DENOTES ALLEY RETURN TO BE REPLACED WITH "PORTLAND CEMENT CONCRETE PAVEMENT, 8"

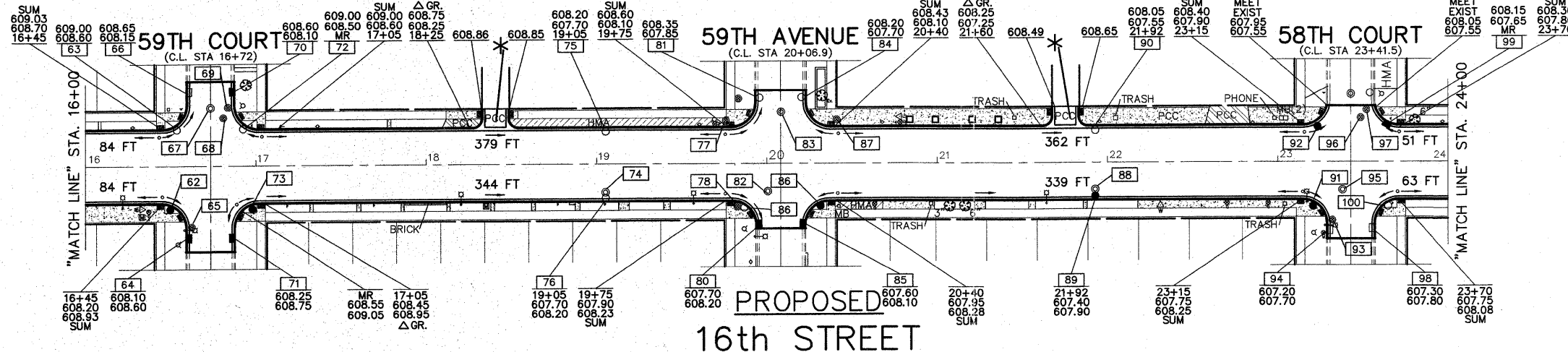

EXISTING ELEVATION	PROPOSED ELEVATION	STATION	EXISTING Q. PROFILE	PROPOSED Q. PROFILE
610	609.28	16		
608	609.26	+72		
606	609.14	17		
	609.02	18		
	608.79	19		
	608.73	20+06.9		
	608.71	21		
	608.75	22		
	608.65	23		
	608.52	24		
	608.47			
	608.35			
	608.34			
	608.53			
	608.50			

BENCHMARKS
(U.S.G.S. DATUM)
SW BOLT ON FIRE HYDRANT AT NW CORNER OF 16TH STREET AND 59TH AVENUE
ELEV.=610.28

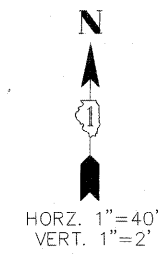

STRUCTURE SCHEDULE

- 62 PROPOSED CATCH BASIN, TYPE A, 4' DIA., TYPE 1 FR. & C.L., SPECIAL RIM=608.80 INV(SE)=605.00 INV(E)=604.50
- 63 CATCH BASIN TO BE RECONSTRUCTED NEW TYPE 1 FR. & O.L. RIM=608.80 INV(NE)=604.35
- 64 PROPOSED INLET, TYPE A, TYPE 1 FR. & O.L., SPECIAL RIM=608.10 INV(NW)=605.70
- 65 VALVE VAULT TO BE RECONSTRUCTED RIM=608.20
- 66 INLET TO BE ADJUSTED RIM=618.15
- 67 MANHOLE, FRAME AND LID TO BE ADJUSTED SPECIAL NEW TYPE 1 FR. & O.L. RIM= 608.95
- 68 VALVE VAULT TO BE RECONSTRUCTED RIM=608.60
- 69 VALVE VAULT TO BE ADJUSTED RIM=608.30
- 70 PROPOSED INLET, TYPE A, TYPE 1 FR. & O.L., SPECIAL RIM=608.10 INV(SE)=605.70
- 71 PROPOSED INLET, TYPE A, TYPE 1 FR. & O.L., SPECIAL RIM=608.25 INV(NE)=605.85
- 72 PROPOSED CATCH BASIN, TYPE A, 4' DIA., TYPE 1 FR. & C.L., SPECIAL RIM=608.50 INV(N)=605.30 INV(NW)=605.05
- 73 PROPOSED CATCH BASIN, TYPE A, 4' DIA., TYPE 1 FR. & C.L., SPECIAL RIM=609.05 INV(SW)=605.25 INV(W)=605.05
- 74 MANHOLE, FRAME AND LID TO BE ADJUSTED SPECIAL RIM= 608.30
- 75 CATCH BASIN TO BE ADJUSTED RIM=607.70
- 76 CATCH BASIN TO BE ADJUSTED RIM=607.70
- 77 VALVE VAULT TO BE ADJUSTED NEW TYPE 1 FR. & C.L. RIM=608.20
- 78 VALVE VAULT TO BE RECONSTRUCTED NEW TYPE 1 FR. & C.L. RIM=608.10
- 79 CATCH BASIN TO BE RECONSTRUCTED NEW TYPE 1 FR. & O.L. RIM=608.10 INV(S)=603.86 INV(SE)=603.60
- 80 PROPOSED INLET, TYPE A, TYPE 1 FR. & O.L., SPECIAL RIM=607.70 INV(NW)=605.20
- 81 CATCH BASIN TO BE ADJUSTED RIM=607.85
- 82 MANHOLE, FRAME AND LID TO BE ADJUSTED SPECIAL NEW TYPE 1 FR. & O.L. RIM= 608.20
- 83 MANHOLE, FRAME AND LID TO BE ADJUSTED SPECIAL NEW TYPE 1 FR. & O.L. RIM= 608.35
- 84 CATCH BASIN TO BE ADJUSTED RIM=607.70
- 85 PROPOSED INLET TYPE A, TYPE 1 FR. & O.L., SPECIAL RIM=607.60 INV(NE)=605.10
- 86 PROPOSED CATCH BASIN, TYPE A, 4' DIA., TYPE 1 FR. & C.L., SPECIAL RIM=618.15
- 87 VALVE VAULT TO BE ADJUSTED NEW TYPE 1 FR. & C.L. RIM=608.45
- 88 MANHOLE, FRAME AND LID TO BE ADJUSTED SPECIAL NEW TYPE 1 FR. & O.L. RIM= 607.75
- 89 PROPOSED CATCH BASIN, TYPE C, TYPE 1 FR. & O.L., SPECIAL RIM=607.40 INV(N)=604.40
- 90 CATCH BASIN TO BE ADJUSTED RIM=607.55
- 91 PROPOSED CATCH BASIN, TYPE A, 4' DIA., TYPE 1 FR. & C.L., SPECIAL RIM=608.30 INV(SE)=604.20 INV(E)=604.00
- 92 PROPOSED CATCH BASIN TYPE A, 4' DIA., TYPE 1 FR. & C.L., SPECIAL RIM=607.90 INV(NE)=604.40
- 93 VALVE VAULT TO BE ADJUSTED RIM=607.25
- 94 INLET TO BE ADJUSTED RIM=607.20
- 95 MANHOLE, FRAME AND LID TO BE ADJUSTED SPECIAL NEW TYPE 1 FR. & O.L. RIM= 608.05
- 96 VALVE VAULT TO BE ADJUSTED NEW TYPE 1 FR. & C.L. RIM=607.95
- 97 VALVE VAULT TO BE ADJUSTED RIM=607.75
- 98 INLET TO BE ADJUSTED RIM=607.30
- 99 PROPOSED INLET, TYPE A, TYPE 1 FR. & O.L., SPECIAL RIM=607.65 INV(N)=605.45
- 100 CATCH BASIN TO BE ADJUSTED RIM=608.10

NOTE:
ALL SCHEDULED RIM ELEVATIONS ARE PROPOSED.

IMPORTANT!
FULL SIZE PLANS HAVE BEEN PREPARED USING STANDARD ENGINEERING SCALES.
REDUCED SIZED PLANS WILL NOT CONFORM TO STANDARD SCALES INDICATED IN TITLE BLOCK.

FOR TYPICAL CROSS SECTION OF NEW PAVEMENT WORK
SEE SHEET 4

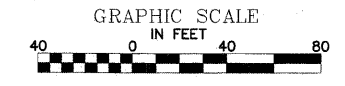

Frank Novotny & Associates, Inc.
Civil Engineers
835 Midway Drive • Willowbrook, IL • 60527 • Telephone: (630) 887-8640 • Fax: (630) 887-0133
ILLINOIS PROFESSIONAL DESIGN PERM NO. 134-000828

FILE NAME = FAU 1447 (16TH STREET) LOMBARD AVE. TO FAU 2798 (CENTRAL AVE.)	USER NAME =	DESIGNED - AMS	REVISED - AMS 4-7-11
10080 HPP RESURFACING	PLOT SCALE =	DRAWN - JFP-JEP	REVISED - AMS 4-22-11
	PLOT DATE =	CHECKED - TPG	REVISED -
		DATE - 3/11	REVISED -

STATE OF ILLINOIS
DEPARTMENT OF TRANSPORTATION

PLAN & PROFILE:
16th STREET - (EXISTING AND PROPOSED ROADWAY PAVING AND REMOVAL PLAN)
SCALE: AS NOTED SHEET NO. OF SHEETS STA. 16+00 TO STA. 24+00

F.A.U. RTE. 1447	SECTION 11-00213-00-RS	COUNTY COOK	TOTAL SHEETS 25	SHEET NO. 9
FED. ROAD DIST. NO. ILLINOIS FED. AID PROJECT			CONTRACT NO. 63607	
			HPP-3045(003)	