

B.M. #7: Chiseled "X" on Northeast Bolt of Large Traffic Signal Base @ Southeast Quadrant of CH 35 (55th St) and Cass Ave. Sta. 36+40.25' Rt. Elev. 768.71

◆ Approximate Boring Location
 * Construct sidewalk and/or steps to transition to existing private sidewalk as directed by the Engineer. See Roadway Plans. (Cost included with Concrete Structures)

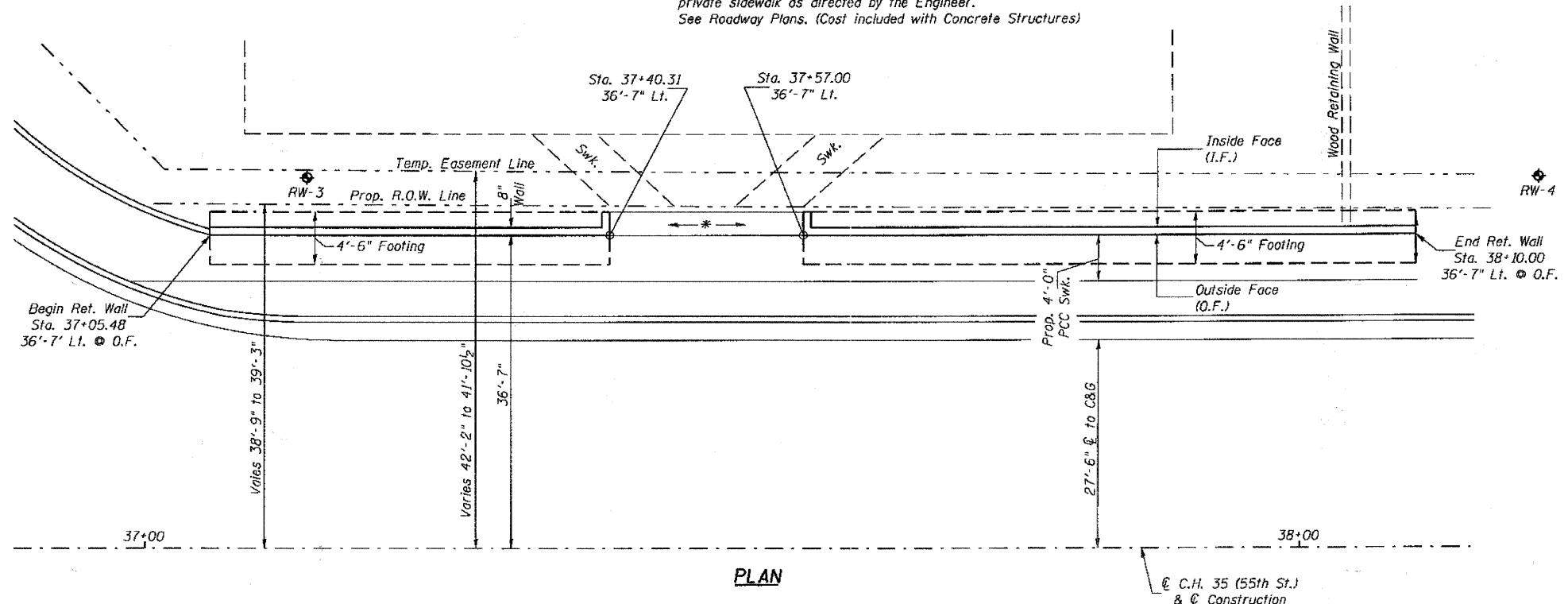

PLAN

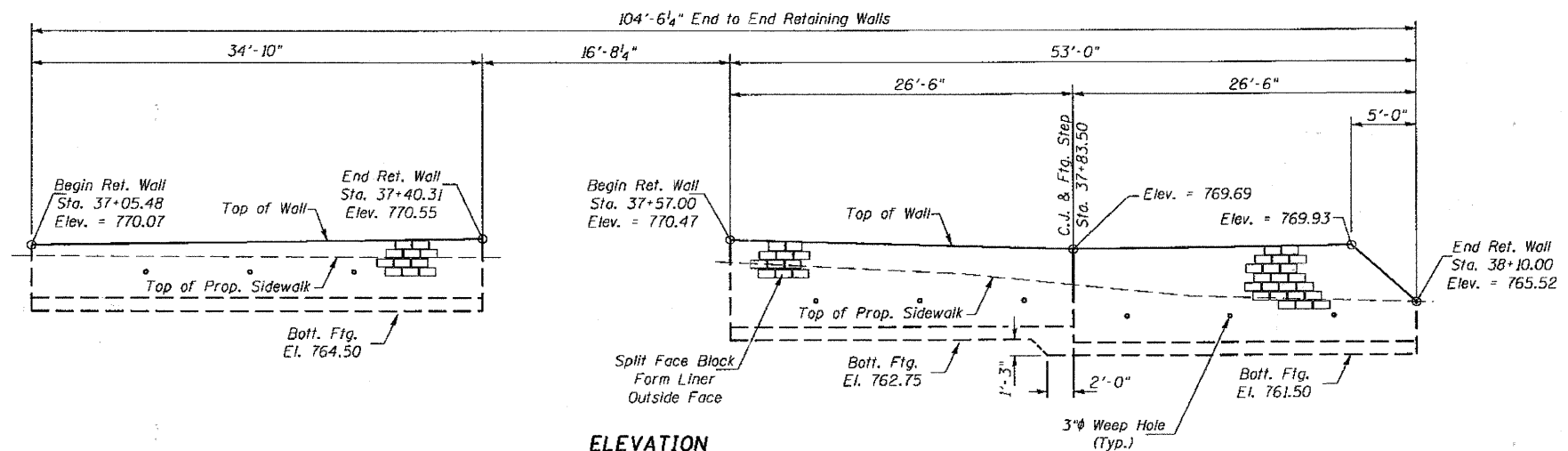

ELEVATION

C.J. = Construction Joint

GENERAL NOTES

Reinforcement bars shall conform to the requirements of ASTM A 706 Grade 60
 Reinforcement bars designated (E) shall be epoxy coated.
 For Total Bill of Material, See Sh. 3 of 3.
 For Borings, see Special Provisions.
 Fill placement must not vary >1' in elevation on either side of wall until fill at front face (Outside Face) is fully placed.
 Concrete in Concrete Retaining Wall to be paid for as Concrete Structures.

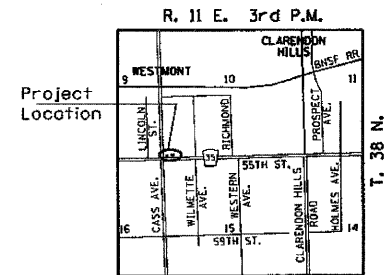

LOCATION SKETCH

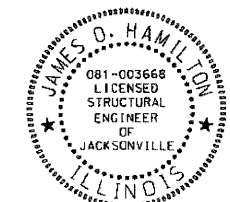

Expires: 11/30/2012
 Signature: James O. Hamilton
 Date: 5/13/2012

**RETAINING WALL #2
 GENERAL PLAN & ELEVATION
 C.H. 35 (55TH STREET)
 SECTION 94-00302-00-FP
 DU PAGE COUNTY
 STA. 37+05.48 TO STA. 38+10.00**

DESIGNED	JOH
CHECKED	BAN
DRAWN	TAC
CHECKED	JOH

DESIGN STRESSES
 FIELD UNITS
 (Concrete)
 f'c = 3,500 p.s.i.
 (Reinforcement Bars)
 fy = 60,000 p.s.i.

DESIGN SPECIFICATIONS
 AASHTO 17th Edition, 2002

HUTCHISON ENGINEERING, INC. Jacksonville & Shorewood, Illinois Date: 2011	SHEET NO. 1 3 SHEETS	F.A.U. RTE.	SECTION	COUNTY	TOTAL SHEETS	SHEET NO.
		1504	94-00302-00-FP	DU PAGE	240	147
					CONTRACT NO. 63609	
					ILLINOIS FED. AID PROJECT	