

PLAN	SURVEYED	DATE
	NOTED	
	CHECKED	
	BY	
	DATE	

PROFILE	SURVEYED	DATE
	NOTED	
	CHECKED	
	BY	
	DATE	

P:\2010\ME10015-Roselle-DPCDOT\CADD\Shs\Roselle-sht-Du02.dgn  
 FILE NAME = 20100901  
 SCALE = 1"=20'  
 USER NAME = Millennium Professional Services

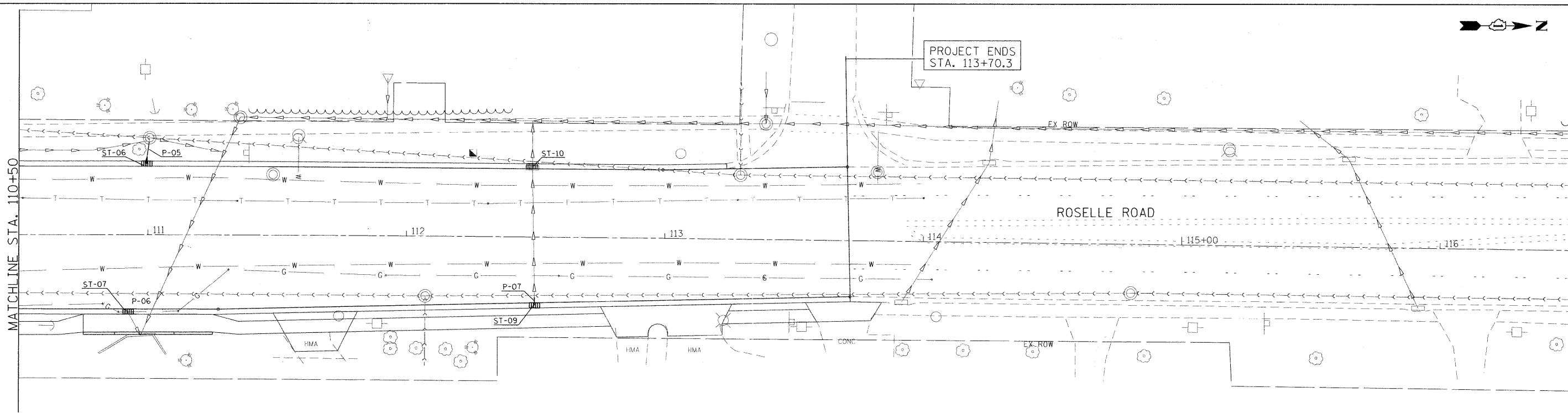

ST-06 STA 110+99.4, 27.5 'LT 4' CB TY D W/TY-23 F&G RIM = 744.41 INV (W) = 741.64	ST-07 STA 110+92.3, 27.4 'RT 4' CB TY D W/TY-23 F&G RIM = 744.37 INV (E) = 741.40	ST-09 STA 112+49.5, 26.3 'RT 4' CB TY D W/TY-23 F&G RIM = 745.28 INV (W) = 742.09	ST-10 STA 112+48.3, 27.3 'LT 4' CB TY D W/TY-23 F&G RIM = 745.26 INV (W) = 741.41
--	--	--	--

P-05 14 LF-STORM SEWER REMOVAL 10" 14 LF-10" STORM SEW CL A, TY-1	P-06 8 LF-PARTIAL REMOVED EXIST. STORM SEWER 10"	P-07 EXTEND EX. STORM SEW 4 LF-10" STORM SEW CL A, TY-1
---	--	--

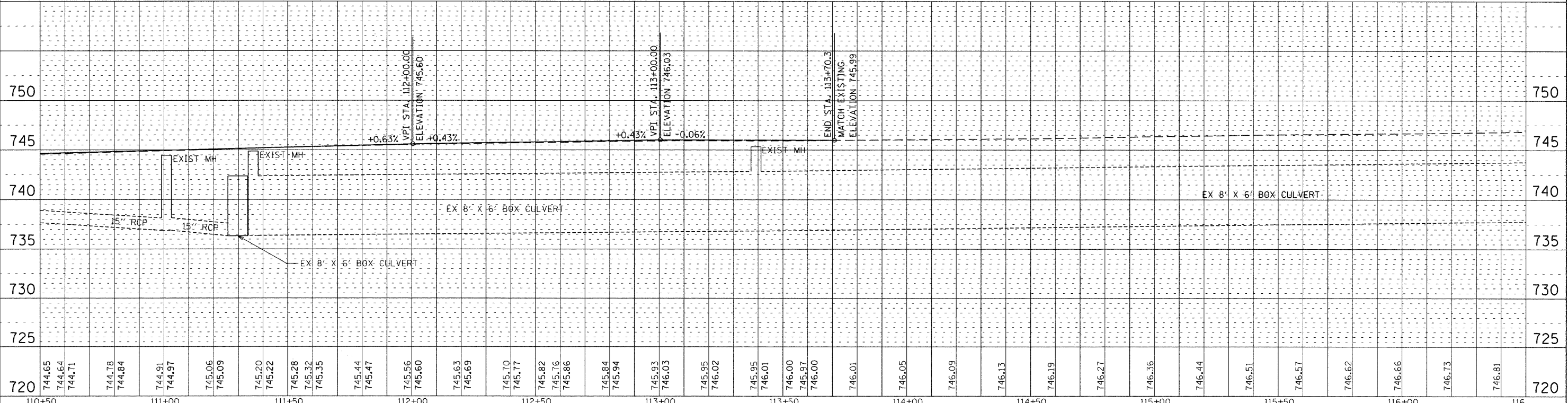

**MILLENNIA PROFESSIONAL SERVICES**  
 200 22ND Street, Suite 216, Lombard, IL 60148  
 630.785.0110 voice, 630.839.2566 fax  
 WWW.MPS-IL.COM

DESIGNED - TVN	REVISED -
DRAWN - TVN	REVISED -
CHECKED - RPD	REVISED -
DATE - 5/25/2011	REVISED -

**DUPAGE COUNTY  
DEPARTMENT OF TRANSPORTATION**

**ROSELLE RD. & WALNUT ST.  
INTERSECTION IMPROVEMENTS**

**DRAINAGE AND UTILITIES PLAN**

SCALE: 1"=20' SHEET NO. 2 OF 3 SHEETS STA. 110+50 TO STA. 113+70.3

F.A.P. RTE. 364	SECTION 07-00184-12-CH	COUNTY DUPAGE	TOTAL SHEETS 49	SHEET NO. 21
CONTRACT NO. 63611				

FED. ROAD DIST. NO. 1 ILLINOIS FED. AID PROJECT  
 P:\2010\ME10015-Roselle-DPCDOT\CADD\Shs\Roselle-sht-Du02.dgn