

STATE OF ILLINOIS  
 DEPARTMENT OF TRANSPORTATION  
 DIVISION OF HIGHWAYS

**PROPOSED  
 HIGHWAY PLANS**

FAI ROUTE 80 (I-80)  
 SECTION (37-1BY-1, 81-1VB, 81-1HB-1)M-1

BRIDGE REPAIRS  
 HENRY & ROCK ISLAND COUNTIES

C-92-144-11

Structure Number 081-0014 (SB)  
 Structure Number 081-0015 (NB)

Structure Number 081-0016 (SB)  
 Structure Number 081-0017 (NB)

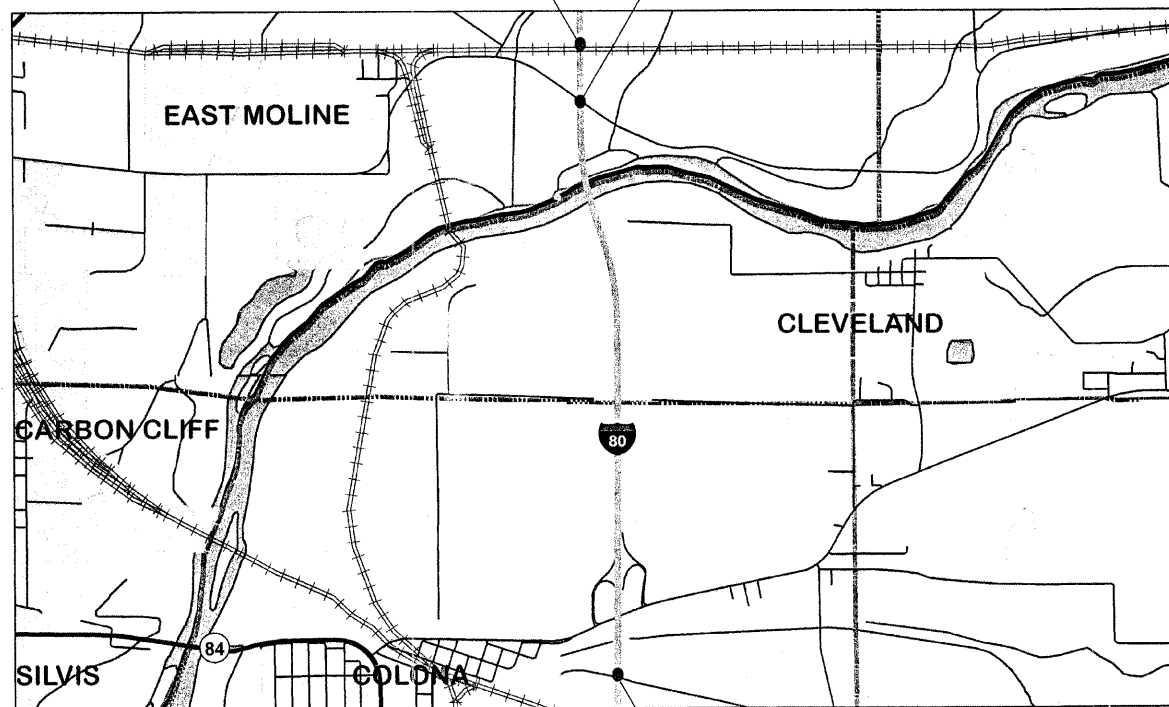

FOR INDEX OF SHEETS, SEE SHEET NO. 2

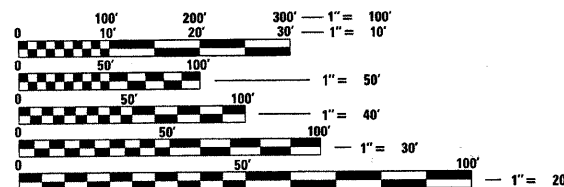

FULL SIZE PLANS HAVE BEEN PREPARED USING STANDARD ENGINEERING SCALES. REDUCED SIZED PLANS WILL NOT CONFORM TO STANDARD SCALES. IN MAKING MEASUREMENTS ON REDUCED PLANS, THE ABOVE SCALES MAY BE USED.

J.U.L.I.E.  
 JOINT UTILITY LOCATION INFORMATION FOR EXCAVATION  
 1-800-892-0123  
 OR 811

PROJECT ENGINEER: Mahmoud Etemadi 815/284-5393  
 PLAN TECH: Dan Link 815/284-5416

CONTRACT NO. 64H27

FAI RTE.	SECTION	COUNTY	TOTAL SHEETS	SHEET NO.
80	*	**	15	1

ILLINOIS CONTRACT NO. 64H27  
 (37-1BY-1, 81-1VB, 81-1HB-1)M-1  
 \*\* Henry & Rock Island Counties  
 C-92-144-11

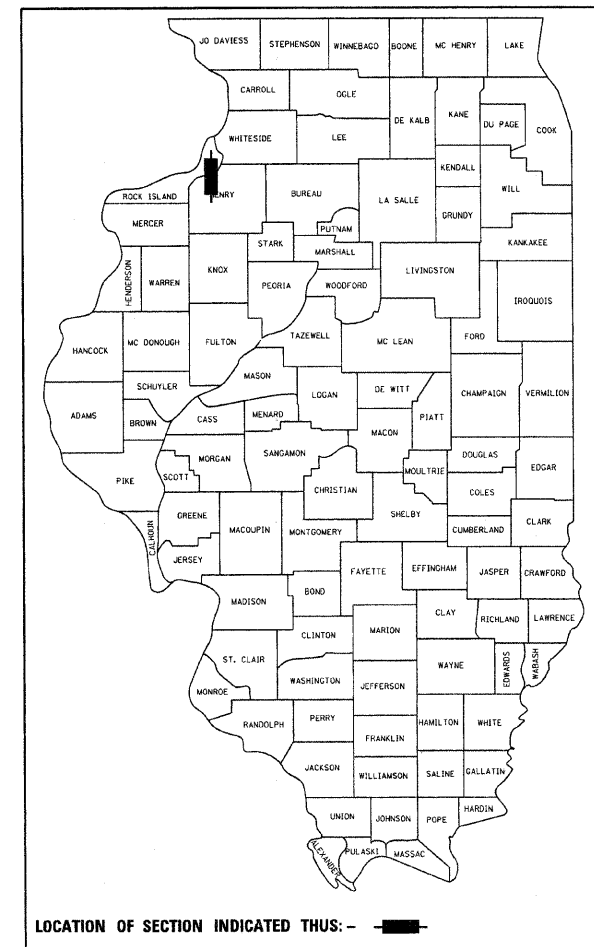

STATE OF ILLINOIS  
 DEPARTMENT OF TRANSPORTATION  
 DIVISION OF HIGHWAYS

SUBMITTED June 17 20 11  
Eric S. Theilbender  
 DEPUTY DIRECTOR OF HIGHWAYS, REGION ENGINEER

July 1 20 11  
Scott E. Stitt, P.E.  
 ENGINEER OF DESIGN AND ENVIRONMENT

July 1 20 11  
Christine M. Road  
 DIRECTOR OF HIGHWAYS, CHIEF ENGINEER

PRINTED BY THE AUTHORITY  
 OF THE STATE OF ILLINOIS

# GENERAL NOTES

The final top 100 mm (four inches) of soil in any right-of-way area disturbed by the Contractor must be capable of supporting vegetation. The soil must be from the A horizon (zero to 2' deep) of soil profiles of local soils.

All Borrow/Waste/Use sites must be approved by the Department prior to removing any material from the project or initiating any earthmoving activities, including temporary stockpiling outside the limits of construction.

The Contractor shall seed all disturbed areas within the project limits. Seeding Class 4 or 2A shall be used, except in front of properties where the grass will be mowed, then use Seeding, Class 1. Class 2A shall be used on front slopes and ditch bottoms. Class 4 shall be used behind Type A gutter, on all backslopes and areas behind the backslope, and beyond the toe of front slope on fill sections without ditches. This work will be included in the contract unit price per SQ YD for DECK SLAB REPAIR.

Fertilizer shall be applied to all disturbed areas and incorporated into the seedbed prior to seeding or placement of sod at the rate specified in Sections 250 and 252 of the Standard Specifications. This work shall be included in the cost of DECK SLAB REPAIR.

Mulch Method II shall be applied over all seeded areas. This shall be included in the cost of the DECK SLAB REPAIR.

The following Mixture Requirements are applicable for this project:

Mixture Uses(s):	Surface	Level Binder
PG:	SBS PG 70-22	SBS PG 70-22
Design Air Voids	4.0 @ N90	4.0 @ N50
Mixture Composition (Gradation Mixture)	IL 9.5 or 12.5	IL 4.75
Friction Aggregate	D	N/A
20 Year ESAL	0.0	
	112 lbs/sy/in	

Bituminous and Aggregate prime coat shall be placed in accordance with Section 406 of the Standard Specifications. The cost of the prime coats shall be included in the contract unit price per metric ton (ton) for LEVELING BINDER (MACHINE METHOD) of the type specified.

The Contractor shall be responsible for protecting utility property during construction operations as outlined in Article 107.31 of the Standard Specifications. A minimum of 48 hours advance notice is required for non-emergency work. The JULIE number is 800-892-0123.

Temporary Impact Attenuators that have been furnished and placed could be relocated on the same project. The attenuators relocated, from one stage to another, from the project to an offsite location, or from the offsite location back to the project, will be paid for at the contract unit price per Each for IMPACT ATTENUATORS RELOCATE of the particular type specified.

Temporary Concrete Barrier that has been furnished and placed could be relocated on the same project. The Temporary Concrete Barrier relocated, from one stage to another, from the project to an offsite location, or from the offsite location back to the project, will be paid for at the contract unit price per Foot for RELOCATE TEMPORARY CONCRETE BARRIER.

At all deck drain locations, taper new HMA for a distance of 1' on all sides of the drain down towards the drain. The cost of this work is included in the cost of POLYMERIZED LEVELING BINDER (MACHINE METHOD), N50.

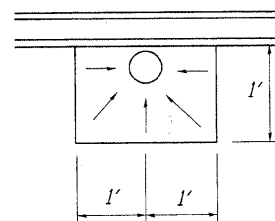

Deck Drain Taper Detail

# INDEX OF SHEETS

1. Cover Sheet
2. General Notes, Index of Sheets, Standards
3. Summary of Quantities
4. Bridge Approach Details
5. Informational Warning Sign
- 6.-9. Bridge Repair Plans Structures 081-0014 & 0015
10. -12. Bridge Repair Plans Structures 081-0016 & 0017
13. -15. Bridge Repair Plans Structures 037-0025 & 0026

# STANDARDS

- 701101-02
- 701400-05
- 701401-06
- 701402-08
- 701426-04
- 704001-06

• (37-1BY-1, 81-1VB, 81-1HB-1IM-1  
 •• HENRY & ROCK ISLAND COUNTIES

FILE NAME =	USER NAME = linkdj	DESIGNED -	REVISED -	<b>STATE OF ILLINOIS DEPARTMENT OF TRANSPORTATION</b>	<b>GENERAL NOTES, INDEX OF SHEETS, STANDARDS</b>	F.A.I. RTE.	SECTION	COUNTY	TOTAL SHEETS	SHEET NO.
0:\BRYCADD plans\Various Counties\2011 1-	80 deck patching\PLANeng.dgn	DRAWN -	REVISED -			80	.	••	15	2
	PLOT SCALE = 50.0000' / in.	CHECKED -	REVISED -			CONTRACT NO. 64H27				
	PLOT DATE = Fri Jun 17 13:02:39 2011	DATE -	REVISED -			ILLINOIS FED. AID PROJECT				

# SUMMARY OF QUANTITIES

## SUMMARY OF QUANTITIES

100% State 0014 0005 0014 0005 0014 0005

Pay Code	Item	Unit	Total Quantity	Rock Island County				Henry County	
				081-0014 & 081-0015	14 & 15 Approaches	081-0016 & 081-0017	16 & 17 Approaches	037-0025 & 037-0026	25 & 26 Approaches
40600825	POLYMERIZED LEVELING BINDER (MACHINE METHOD), N50	TON	424	56	80	52	80	76	80
40600982	HOT-MIX ASPHALT SURFACE REMOVAL - BUTT JOINT	SQ YD	2400		800		800		800
40603545	POLYMERIZED HOT-MIX ASPHALT SURFACE COURSE, MIX "D", N90	TON	846	112	160	102	160	152	160
50157300	PROTECTIVE SHIELD	SQ YD	1000	520		480			
67100100	MOBILIZATION	L SUM	1	0.3		0.4		0.3	
70100207	TRAFFIC CONTROL AND PROTECTION, STANDARD 701402	EACH	3	1		1		1	
70100420	TRAFFIC CONTROL AND PROTECTION, STANDARD 701411	EACH	1					1	
70100800	TRAFFIC CONTROL AND PROTECTION, STANDARD 701401	L SUM	1	0.3		0.4		0.3	
70300220	TEMPORARY PAVEMENT MARKING - LINE 4"	FOOT	24110	7320		8320		8470	
70301000	WORK ZONE PAVEMENT MARKING REMOVAL	SQ FT	8040	2440		2775		2825	
70400100	TEMPORARY CONCRETE BARRIER	FOOT	3500	1175		1100		1225	
70400200	RELOCATE TEMPORARY CONCRETE BARRIER	FOOT	3500	1175		1100		1225	
* 78001110	PAINT PAVEMENT MARKING - LINE 4"	FOOT	3882	1292		1100		1490	
78300100	PAVEMENT MARKING REMOVAL	SQ FT	750	250		250		250	
Z0030250	IMPACT ATTENUATORS, TEMPORARY (NON- REDIRECTIVE), TEST LEVEL 3	EACH	6	2		2		2	
Z0030350	IMPACT ATTENUATORS, RELOCATE (NON- REDIRECTIVE), TEST LEVEL 3	EACH	6	2		2		2	
Z0016001	DECK SLAB REPAIR (FULL DEPTH, TYPE 1)	SQ YD	957	450		257		250	
Z0016200	DECK SLAB REPAIR (PARTIAL)	SQ YD	733	200		250		283	
Z0021907	SILICONE JOINT SEALER 1 3/4 "	FOOT	142	70				72	
Z0021914	SILICONE JOINT SEALER, 2 3/4 "	FOOT	70	70					
Z0021908	SILICONE JOINT SEALER, 2"	FOOT	286			214		72	
Z0041895	POLYMER CONCRETE	CU FT	28.8			20.8		8	
Z0048665	RAILROAD PROTECTIVE LIABILITY INSURANCE	L SUM	1	1					

\*Specialty Items

• (37-1BY-1, 81-1VB, 81-1HB-1)M-1  
 •• HENRY & ROCK ISLAND COUNTIES

FILE NAME = D:\BR\CADD plans\Various Counties\2011-11-08 deck patching\PLANeng.dgn	USER NAME = linkdj	DESIGNED - _____	REVISED - _____	<b>STATE OF ILLINOIS DEPARTMENT OF TRANSPORTATION</b>	<b>SUMMARY OF QUANTITIES</b>	F.A.I. RTE. 80	SECTION •	COUNTY ••	TOTAL SHEETS 15	SHEET NO. 3		
PLOT SCALE = 50.0000' / 1"	CHECKED - _____	REVISED - _____	SCALE: _____			SHEET NO. _____ OF _____ SHEETS	STA. _____ TO STA. _____	CONTRACT NO. 64H27				
PLOT DATE = Fri Jun 17 13:03:02 2011	DATE - _____	REVISED - _____	ILLINOIS FED. AID PROJECT									

# BRIDGE APPROACH DETAILS

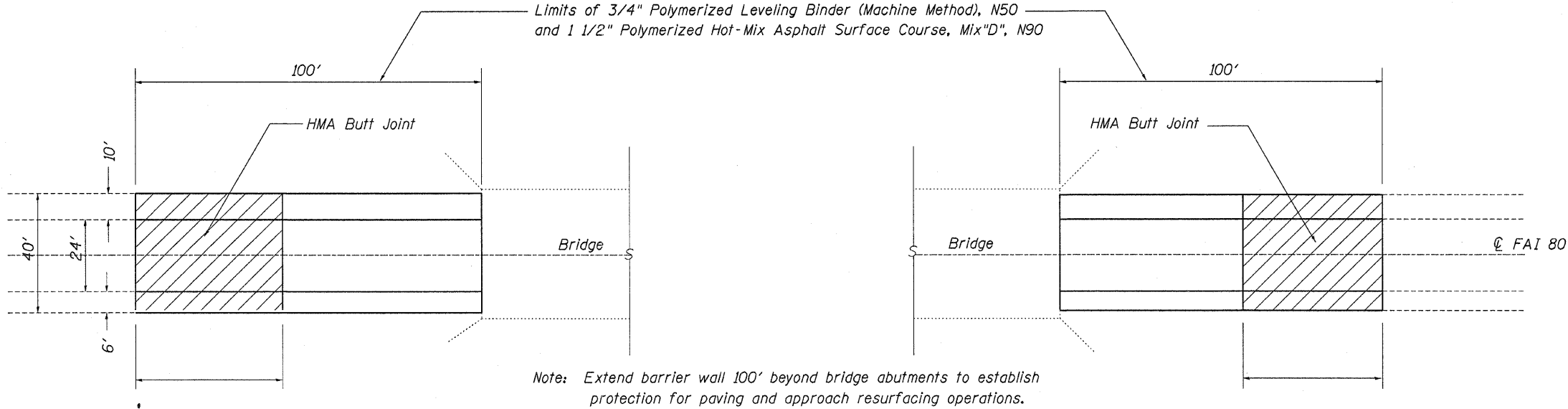

Bridge Approach Quantities

	UNIT	Structure 081-0014	Structure 081-0015	Structure 081-0016	Structure 081-0017	Structure 037-0025	Structure 037-0026	Total Approaches
HOT-MIX ASPHALT SURFACE REMOVAL - BUTT JOINT	Sq Yd	400	400	400	400	400	400	2400
POLYMERIZED LEVELING BINDER (MACHINE METHOD), N50	Ton	40	40	40	40	40	40	240
POLYMERIZED HOT-MIX ASPHALT SURFACE COURSE, MIX "D", N90	Ton	80	80	80	80	80	80	480

TYPICAL TAPER

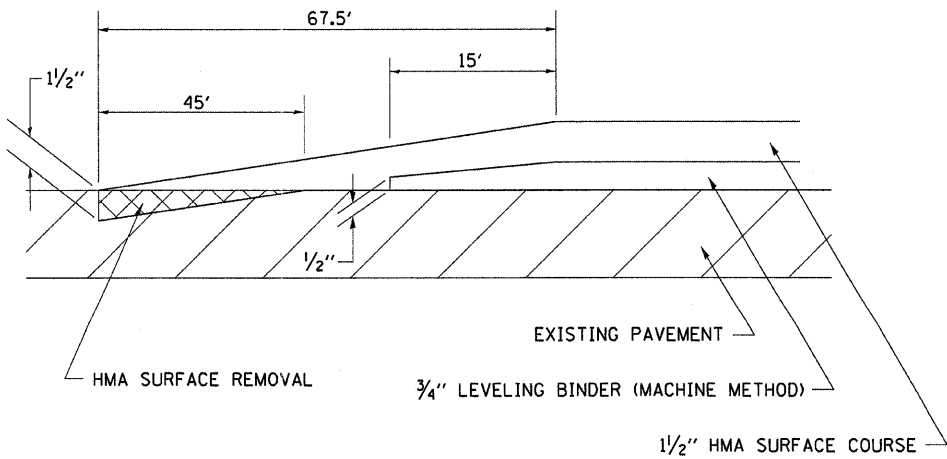

• (37-1BY-1, 81-1VB, 81-1HB-1)M-1  
•• HENRY & ROCK ISLAND COUNTIES

FILE NAME =	USER NAME = linkdj	DESIGNED -	REVISED -	<b>STATE OF ILLINOIS DEPARTMENT OF TRANSPORTATION</b>	<b>BRIDGE APPROACH DETAILS</b>	F.A.I. RTE.	SECTION	COUNTY	TOTAL SHEETS	SHEET NO.	
Q:\BR\CAD\plans\Various Counties\2011 I-	20 deck patching\PLANeng.dgn	DRAWN -	REVISED -			80	.	••	15	4	
PLOT SCALE = 58.0000' / in.	CHECKED -	REVISED -				CONTRACT NO. 64H27					
PLOT DATE = Fri Jun 17 13:03:11 2011	DATE -	REVISED -				ILLINOIS FED. AID PROJECT					

# INFORMATIONAL WARNING SIGN (FOR NARROW TRAVEL LANES)

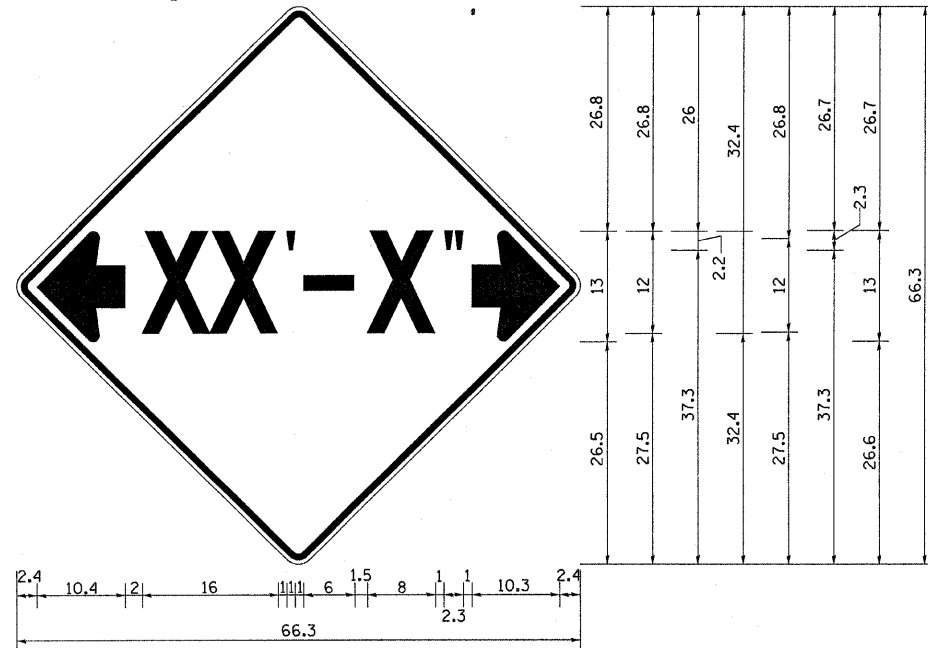

**NOTES**  
 W12-2 - Horizontal Clearance Sign  
 48.0" across sides, 1.9" Radius,  
 0.8" Border, 0.5" Indent, Black on  
 Orange; Standard Arrow Custom  
 10.4" X 8.1" 180° Black 11 Inch  
 D Series Lettering; Standard Arrow  
 Custom 10.4" X 8.1" 0°

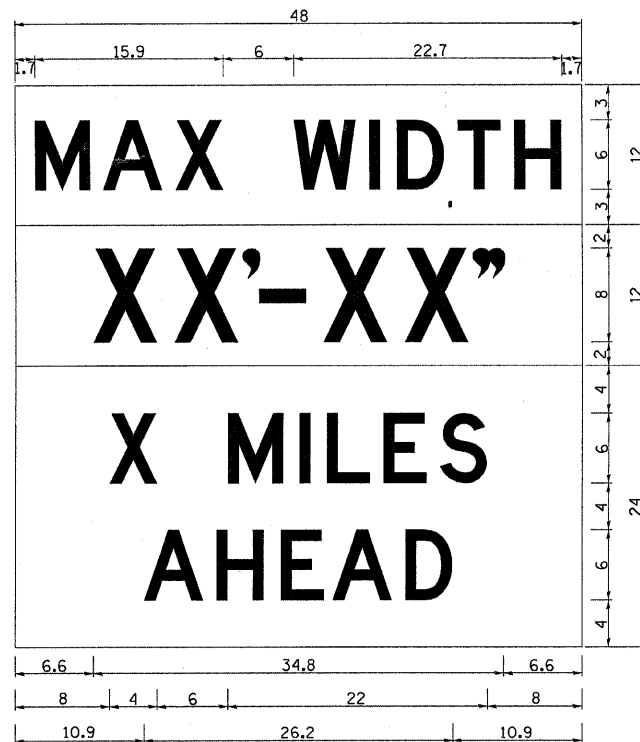

W12-1103 (Width is 80);  
 No border, Black on White;  
 [MAX WIDTH] D;

No border, Black on Orange;  
 [XX'-XX''] D;

No border, Black on White;  
 [X MILES] D; [AHEAD] D;

All work to furnish and install these signs shall be included in the cost of the Traffic Control Standards and shall not be paid for separately.

ALL DIMENSIONS ARE IN INCHES UNLESS OTHERWISE NOTED.

REVISED - 5-15-09

• (37-1BY-1, 81-1VB, 81-1HB-1)M-1  
 •• HENRY & ROCK ISLAND COUNTIES

REVISED -	REGION 2 / DISTRICT 2 STANDARD	F.A.I. RTE.	SECTION	COUNTY	TOTAL SHEETS	SHEET NO.
REVISED -		80	.	••	15	5
REVISED -		CONTRACT NO. 64H27				
REVISED -		FED. ROAD DIST. NO. ILLINOIS FED. AID PROJECT				

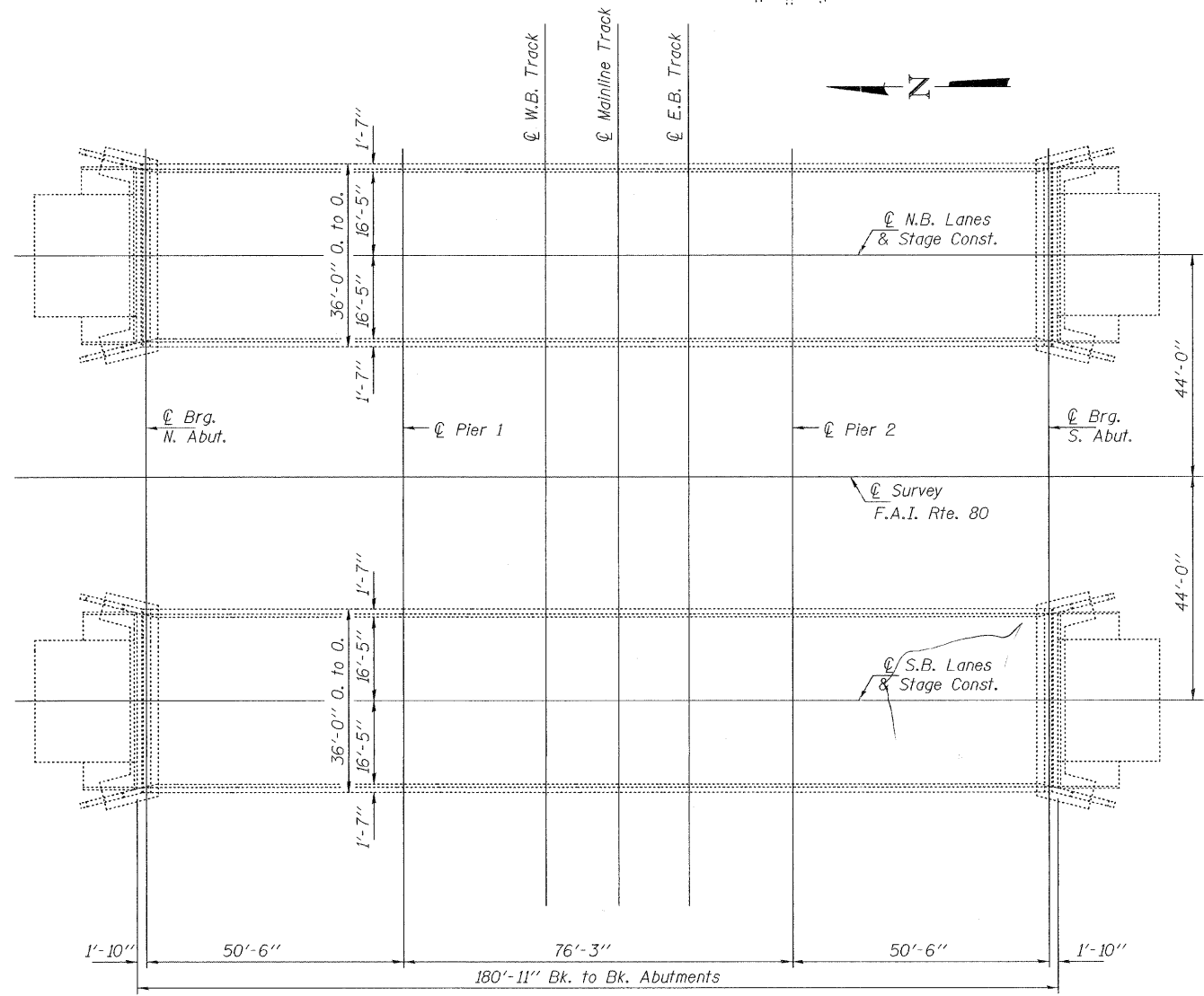
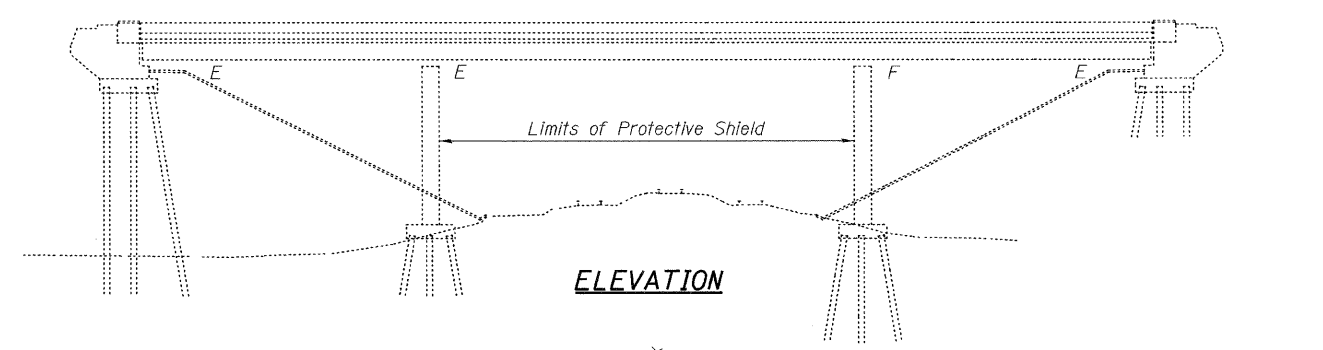

**GENERAL NOTES**

Plan dimensions and details relative to existing plans are subject to nominal construction variations. The Contractor shall field verify existing dimensions and details affecting new construction and make necessary approved adjustments prior to construction or ordering of materials. Such variations shall not be cause for additional compensation for a change in scope of the work, however, the Contractor will be paid for the quantity actually furnished at the unit price bid for the work.

Existing reinforcement bars extending into the removal area shall be cleaned, straightened and incorporated into the new construction. Any reinforcement bars that are damaged during concrete removal shall be replaced with an approved bar splicer or anchorage system. Cost included with Concrete Removal.

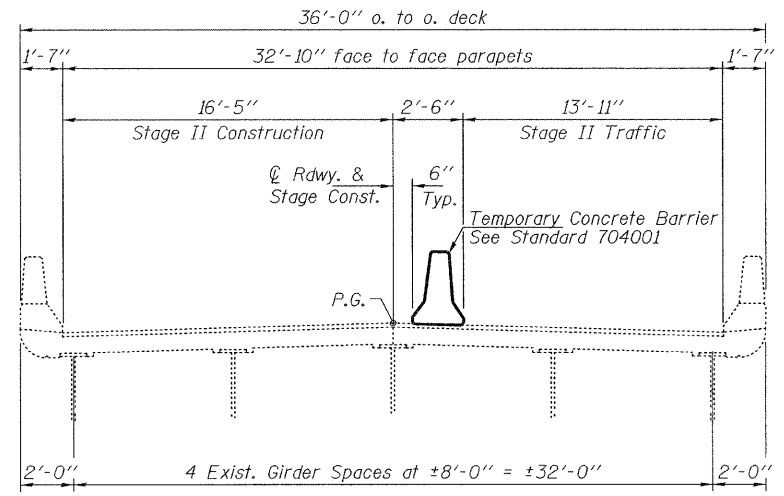
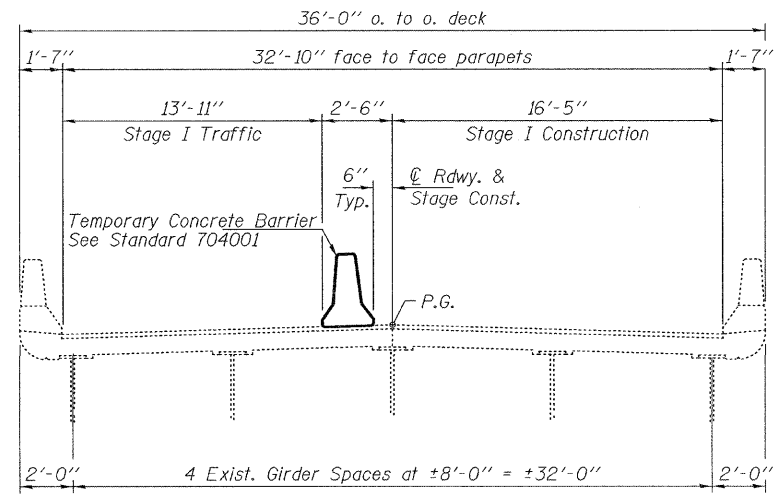

**TOTAL BILL OF MATERIAL**

Item	Unit	Quantity
Deck Slab Repair (Partial)	Sq. Yd.	200
Deck Slab Repair (Full Depth, Type I)	Sq. Yd.	450
Protective Shield	Sq. Yd.	520
Polymerized Leveling Binder (Machine Method), N50	Ton	56
Polymerized Hot-Mix Asphalt Surface Course, Mix "D", N90	Ton	112
Silicone Joint Sealer, 2-3/4"	Foot	70
Silicone Joint Sealer, 1-3/4"	Foot	70



EXPIRES 11-30-2012

DESIGNED <i>Victor Kelly</i>	EXAMINED <i>John F. [Signature]</i>	DATE <u>JUNE 29, 2011</u>	<b>STATE OF ILLINOIS DEPARTMENT OF TRANSPORTATION</b>	<b>PLAN AND ELEVATION FAI 80 OVER BNRR SN 081-0014 (SB) &amp; 081-0015 (NB)</b>	F.A.I. RTE. 80	SECTION (37-18Y-1, 81-1VB, 81-1HB-1M-1)	COUNTY ROCK ISLAND	TOTAL SHEETS 15	SHEET NO. 6	
CHECKED <i>[Signature]</i>	PASSED <i>[Signature]</i>	REVISED			CONTRACT NO. 64H27					
DRAWN <i>baliva</i>	ACTING ENGINEER OF STRUCTURAL SERVICES	REVISED			ILLINOIS FED. AID PROJECT					
CHECKED <i>[Signature]</i>	ACTING ENGINEER OF BRIDGES AND STRUCTURES	REVISED			SHEET NO. 1 OF 3 SHEETS					

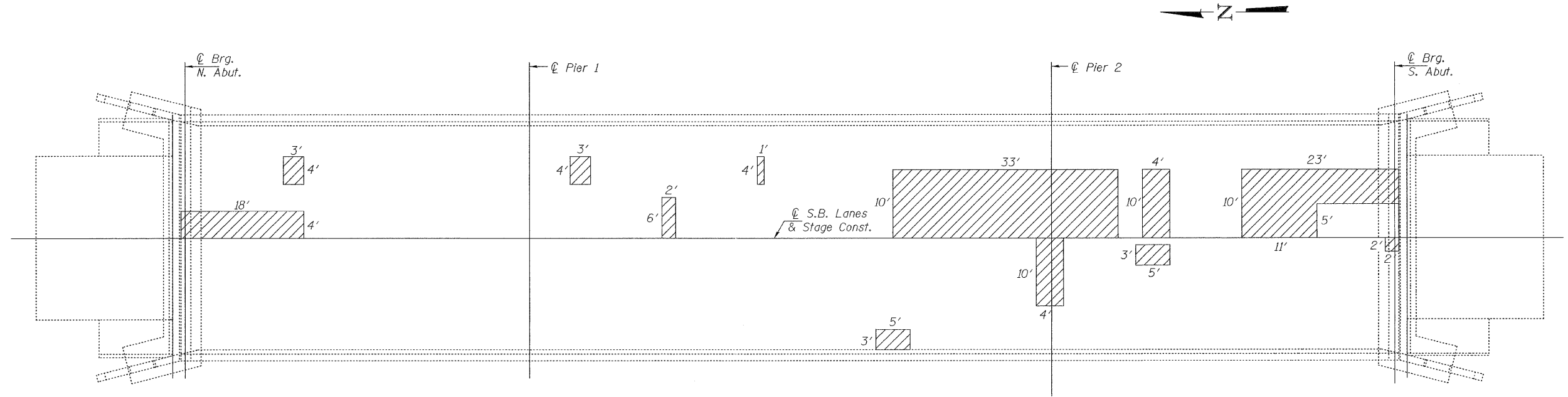

**PLAN**

Hatched areas indicate Deck Slab Repair (Partial). Areas of deck repair are estimated. Actual locations shall be shown by the engineer for As Built Plans.

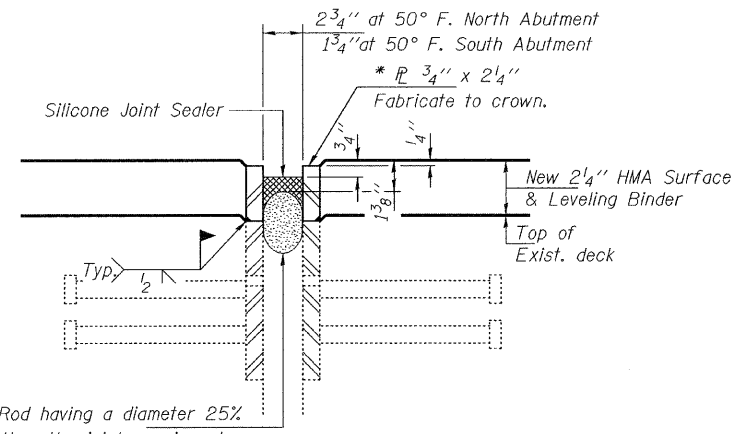

**SECTION THRU JOINT**

\* Furnish in segments of 20 ft. maximum length. Maximum space between installed segments shall be 3/16". Seal space with Silicone Sealant suitable for Structural Steel. After fabrication, all surfaces of the steel L shall be given one shop coat of paint specified for structural steel. No field painting required. Cost included with HMA overlay.

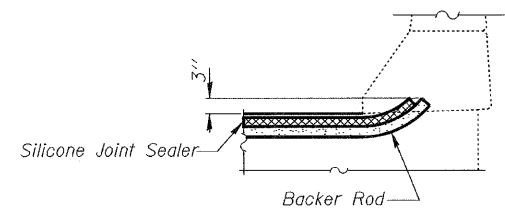

**TYPICAL END OF SEAL TREATMENT**

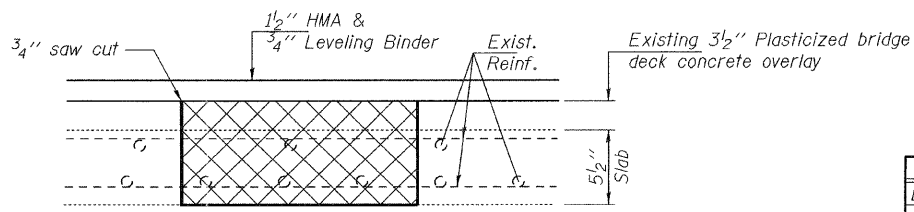

**TYPICAL DECK REPAIR DETAIL**

Cross hatched areas indicate Deck Slab Repair (Full Depth, Type I).

**BILL OF MATERIAL**

Item	Unit	Quantity
Deck Slab Repair (Partial)	Sq. Yd.	100
Deck Slab Repair (Full Depth, Type I)	Sq. Yd.	225
Protective Shield	Sq. Yd.	260
Polymerized Leveling Binder (Machine Method), N50	Ton	28
Polymerized Hot-Mix Asphalt Surface Course, Mix "D", N90	Ton	56
Silicone Joint Sealer, 2 3/4"	Foot	35
Silicone Joint Sealer, 1 3/4"	Foot	35

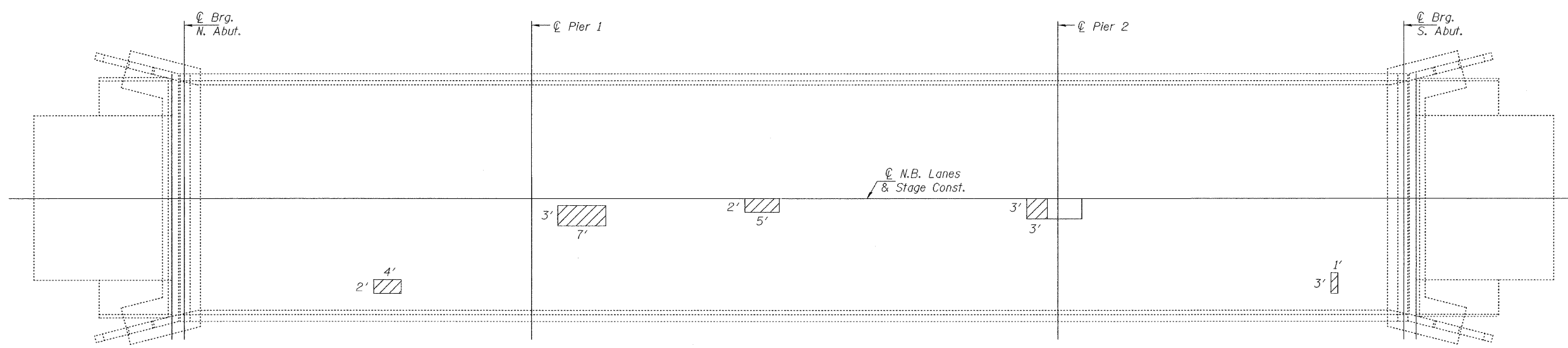
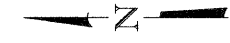

**PLAN**

Hatched areas indicate Deck Slab Repair (Partial). Areas of deck repair are estimated. Actual locations shall be shown by the engineer for As Built Plans.

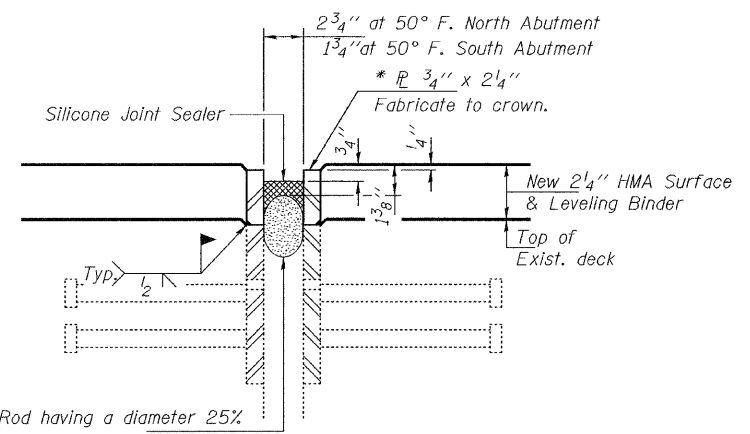

Backer Rod having a diameter 25% greater than the joint opening at the time of installation.

**SECTION THRU JOINT**

\* Furnish in segments of 20 ft. maximum length. Maximum space between installed segments shall be 3/16". Seal space with Silicone Sealant suitable for Structural Steel. After fabrication, all surfaces of the steel R shall be given one shop coat of paint specified for structural steel. No field painting required. Cost included with HMA overlay.

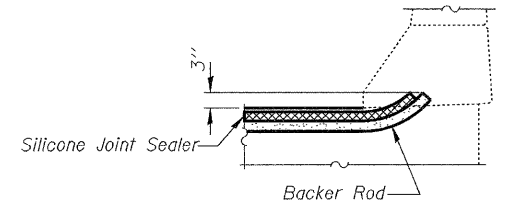

**TYPICAL END OF SEAL TREATMENT**

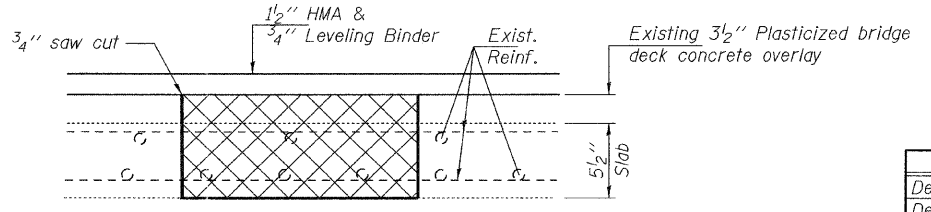

**TYPICAL DECK REPAIR DETAIL**

Cross hatched areas indicate Deck Slab Repair (Full Depth, Type I).

**BILL OF MATERIAL**

Item	Unit	Quantity
Deck Slab Repair (Partial)	Sq. Yd.	100
Deck Slab Repair (Full Depth, Type I)	Sq. Yd.	225
Protective Shield	Sq. Yd.	260
Polymerized Leveling Binder (Machine Method), N50	Ton	28
Polymerized Hot-Mix Asphalt Surface Course, Mix "D", N90	Ton	56
Silicone Joint Sealer, 2 3/4"	Foot	35
Silicone Joint Sealer, 1 3/4"	Foot	35



THIS SHEET  
 INTENTIONALLY LEFT BLANK

DESIGNED <i>VHV</i>	EXAMINED <i>James F. Duff</i>	DATE <i>JUNE 29, 2011</i>	<b>STATE OF ILLINOIS DEPARTMENT OF TRANSPORTATION</b>	SHEET NO. OF 3 SHEETS	F.A.I. RTE.	SECTION	COUNTY	TOTAL SHEETS	SHEET NO.
CHECKED <i>DAB</i>	<i>ACTING ENGINEER OF STRUCTURAL SERVICES</i>	REVISED			80	137-1B1-1, 81-1VB, 81-1HB-1M-1	ROCK ISLAND	15	9
DRAWN <i>balva</i>	<i>ACTING ENGINEER OF BRIDGES AND STRUCTURES</i>	REVISED			CONTRACT NO. 64H27		ILLINOIS FED. AID PROJECT		
CHECKED <i>VHV DAB</i>									

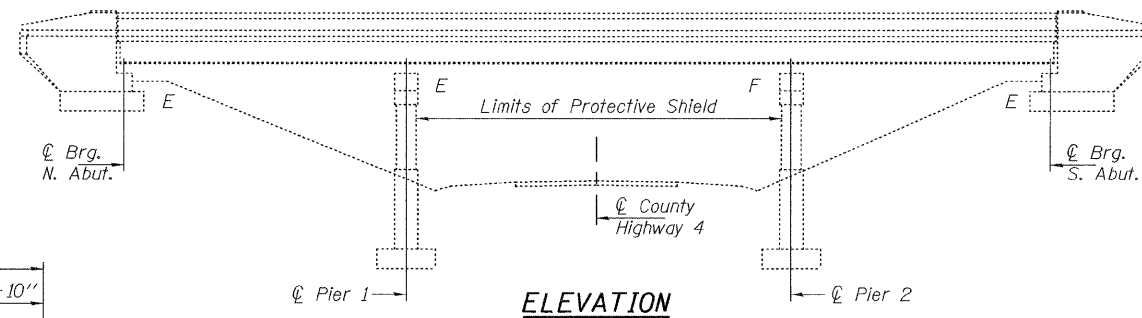

**ELEVATION**

**GENERAL NOTES**

Plan dimensions and details relative to existing plans are subject to nominal construction variations. The Contractor shall field verify existing dimensions and details affecting new construction and make necessary approved adjustments prior to construction or ordering of materials. Such variations shall not be cause for additional compensation for a change in scope of the work, however, the Contractor will be paid for the quantity actually furnished at the unit price bid for the work.

Existing reinforcement bars extending into the removal area shall be cleaned, straightened and incorporated into the new construction. Any reinforcement bars that are damaged during concrete removal shall be replaced with an approved bar splicer or anchorage system. Cost included with Concrete Removal.

Areas of deck repairs shown are estimated. The Engineer shall show actual locations of deck repairs on As-built Plans.

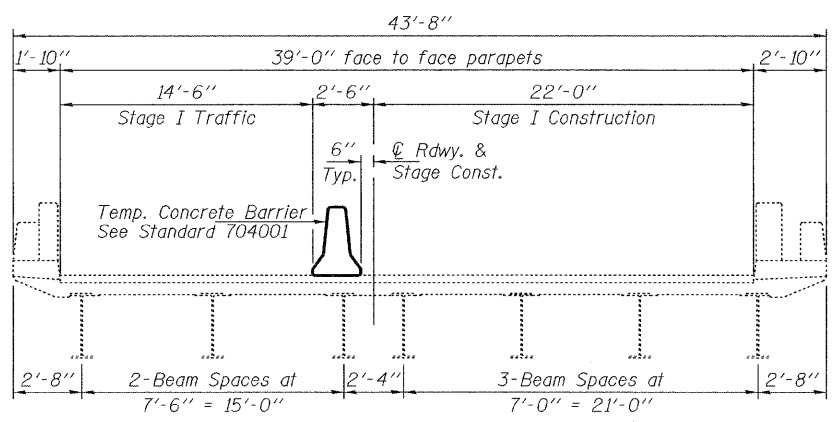

**CROSS SECTION**  
(Looking South SN 081-0017)  
(Looking North SN 081-0016)

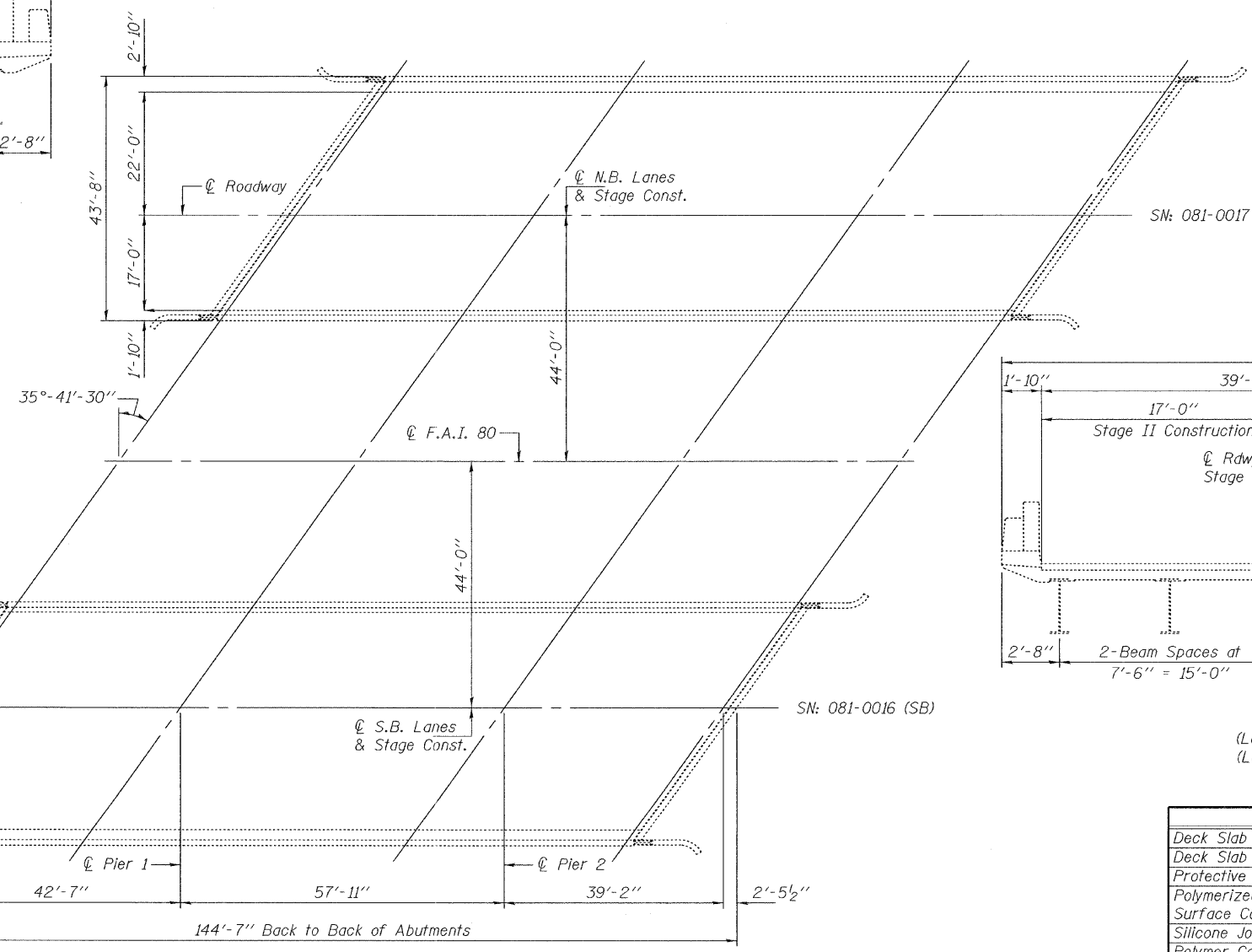

**PLAN**

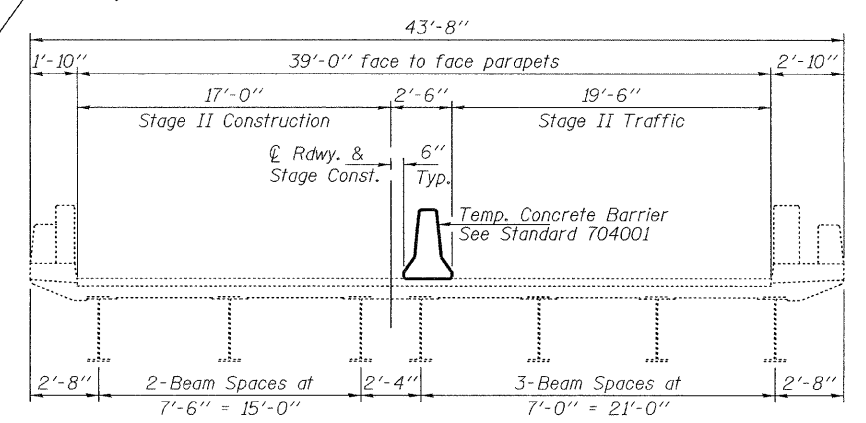

**CROSS-SECTION**  
(Looking South SN 081-0017)  
(Looking North SN 081-0016)

**TOTAL BILL OF MATERIAL**

Item	Unit	Quantity
Deck Slab Repair (Partial)	Sq. Yd.	250
Deck Slab Repair (Full Depth, Type I)	Sq. Yd.	257
Protective Shield	Sq. Yd.	480
Polymerized Hot-Mix Asphalt Surface Course, Mix "D", N90	Ton	102
Silicone Joint Sealer, 2"	Foot	214
Polymer Concrete	Cu. Ft.	20.8
Polymerized Leveling Binder (Machine Method), N50	Ton	52



EXPIRES 11-30-2012

DESIGNED: <i>Victor Kelly</i>	EXAMINED: <i>Jim F. Jolly</i>	DATE: JUNE 29, 2011	<b>STATE OF ILLINOIS DEPARTMENT OF TRANSPORTATION</b>	<b>GENERAL PLAN &amp; ELEVATION F.A.I. ROUTE 80 OVER COUNTY HIGHWAY 4 SN 081-0016 (SB) &amp; 0017 (NB)</b>	F.A.I. RTE. 80	SECTION (37-1B1-1, 81-1VB, 81-1HB-1M-1)	COUNTY ROCK ISLAND	TOTAL SHEETS 15	SHEET NO. 10	
CHECKED: <i>Kyle M. Steffen</i>	PASSED: <i>Jim F. Jolly</i>	REVISIONS:			CONTRACT NO. 64H27					
DRAWN: <i>Kyle M. Steffen</i>	ACTING ENGINEER OF BRIDGES AND STRUCTURES: <i>Jim F. Jolly</i>	REVISIONS:			ILLINOIS FED. AID PROJECT					
CHECKED: <i>Kyle M. Steffen</i>	ACTING ENGINEER OF STRUCTURAL SERVICES: <i>Jim F. Jolly</i>	REVISIONS:								

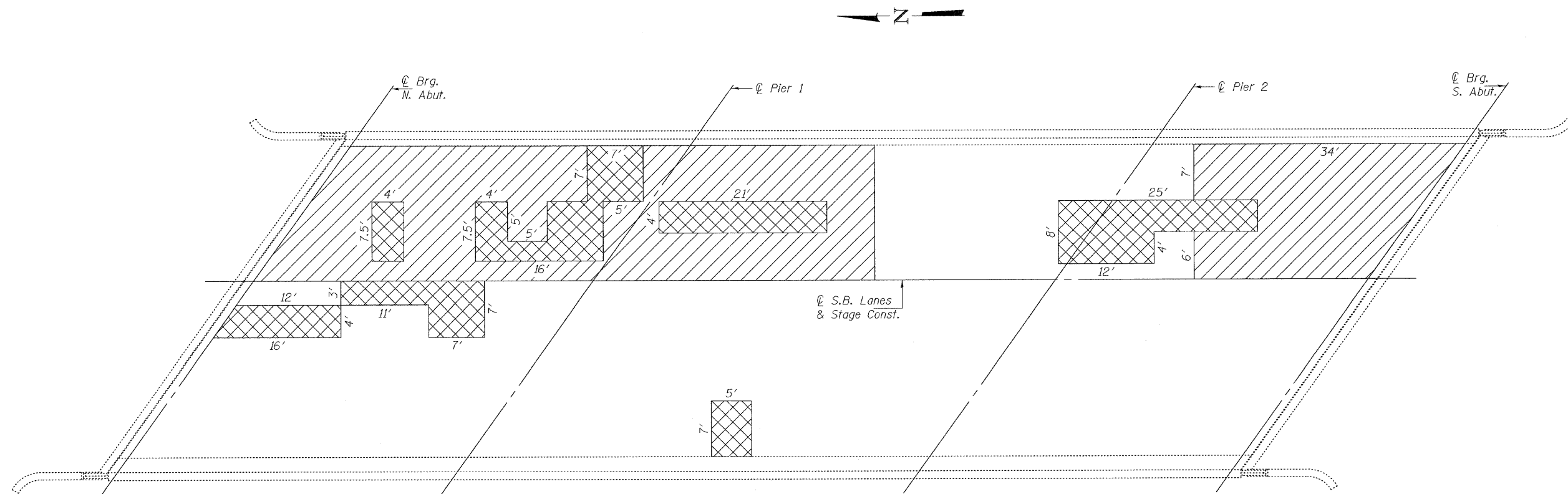

**PLAN**

Hatched areas indicate Deck Slab Repair (Partial)  
Areas of deck repair are estimated. Actual locations shall be shown by the Engineer for As Built Plans.

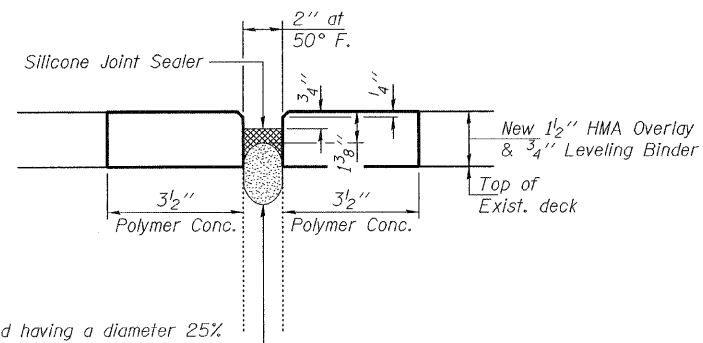

**SECTION THRU JOINT**

Backer Rod having a diameter 25% greater than the joint opening at the time of installation.

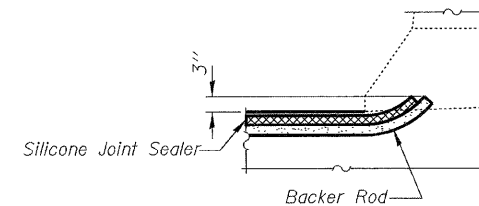

**TYPICAL END OF SEAL TREATMENT**

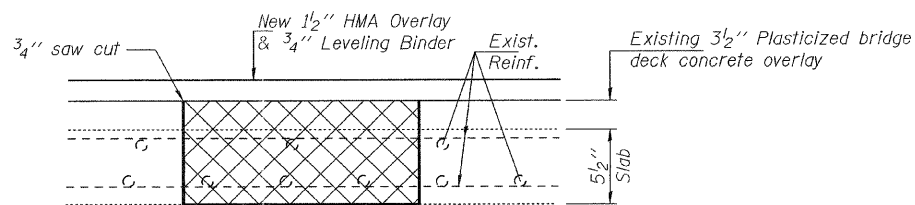

**TYPICAL DECK REPAIR DETAIL**

Cross hatched areas indicate Deck Slab Repair (Full Depth, Type II)

**BILL OF MATERIAL**

Item	Unit	Quantity
Deck Slab Repair (Partial)	Sq. Yd.	150
Deck Slab Repair (Full Depth, Type I)	Sq. Yd.	125
Protective Shield	Sq. Yd.	240
Polymerized Hot-Mix Asphalt Surface Course, Mix "D", N90	Ton	62
Silicone Joint Sealer, 2"	Foot	107
Polymer Concrete	Cu. Ft.	10.4
Polymerized Leveling Binder (Machine Method), N50	Ton	26

DESIGNED - <i>Victa Nely</i>	EXAMINED - <i>Joanne F. Jaffe</i>	DATE - JUNE 29, 2011
CHECKED - <i>Daniel Bode</i>	PASSED - <i>ACTING ENGINEER OF STRUCTURAL SERVICES</i>	REVISED
DRAWN - Kyle M. Steffen	ACTING ENGINEER OF BRIDGES AND STRUCTURES	REVISED

**STATE OF ILLINOIS  
DEPARTMENT OF TRANSPORTATION**

**DECK PATCHING DETAILS  
SN 081-0016 (SB)**

SHEET NO. 2 OF 3 SHEETS

F.A.I. RTE.	SECTION	COUNTY	TOTAL SHEETS	SHEET NO.
80	(37-1BY-1, 81-1VB, 81-1HB-1M-1)	ROCK ISLAND	15	11
ILLINOIS FED. AID PROJECT			CONTRACT NO. 64H27	

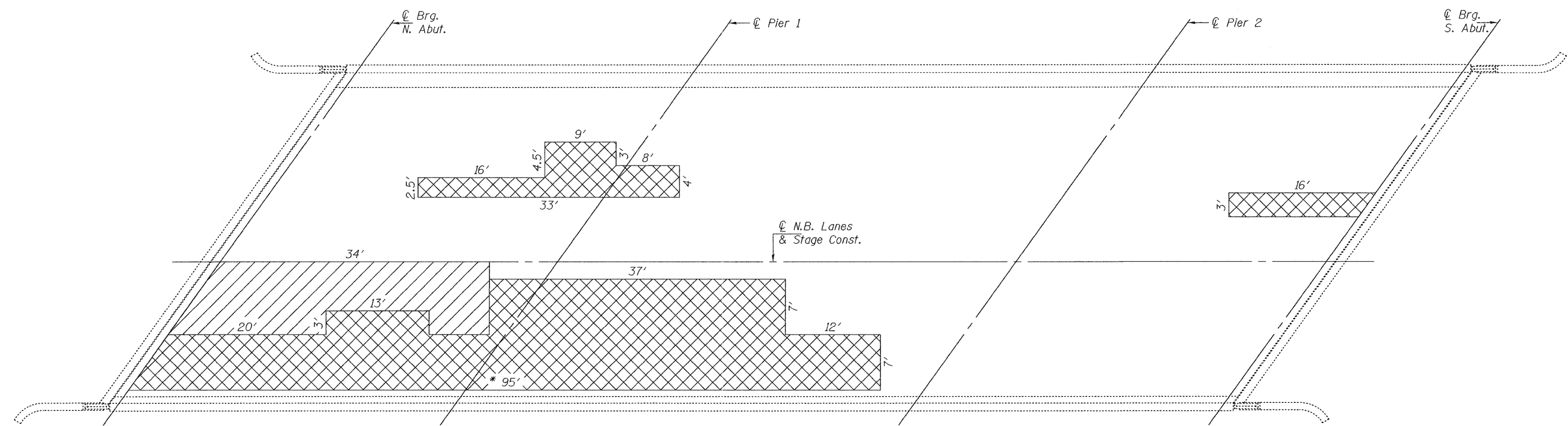
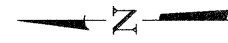

\* Full depth removal to be done in 10' increments along the length of the parapet.

**PLAN**

Hatched areas indicate Deck Slab Repair (Partial)  
Areas of deck repair are estimated. Actual locations shall be shown by the Engineer for As Built Plans.

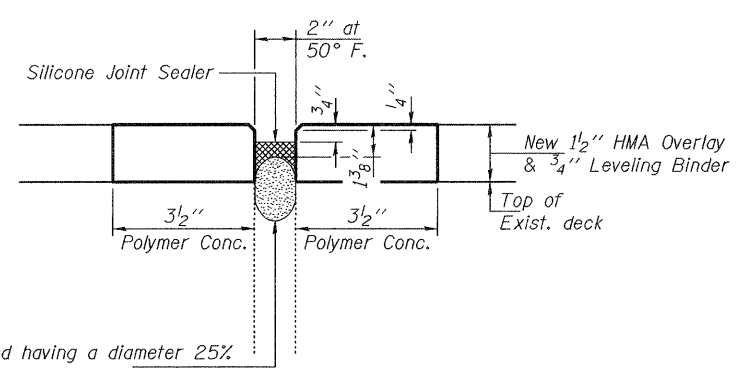

Backer Rod having a diameter 25% greater than the joint opening at the time of installation.

**SECTION THRU JOINT**

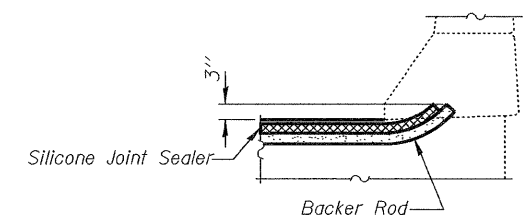

**TYPICAL END OF SEAL TREATMENT**

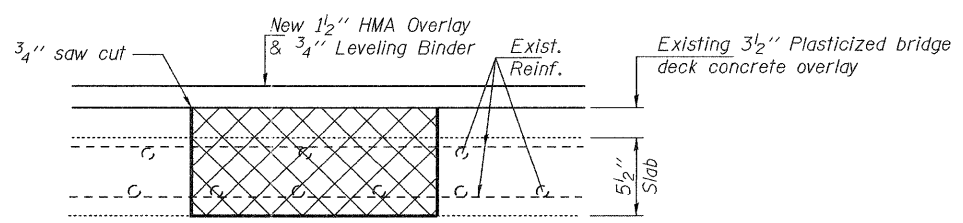

**TYPICAL DECK REPAIR DETAIL**

Cross hatched areas indicate Deck Slab Repair (Full Depth, Type II)

**BILL OF MATERIAL**

Item	Unit	Quantity
Deck Slab Repair (Partial)	Sq. Yd.	100
Deck Slab Repair (Full Depth, Type I)	Sq. Yd.	132
Protective Shield	Sq. Yd.	240
Polymerized Hot-Mix Asphalt Surface Course, Mix "D", N90	Ton	62
Silicone Joint Sealer, 2"	Foot	107
Polymer Concrete	Cu. Ft.	10.4
Polymerized Leveling Binder (Machine Method), N50	Ton	26

DESIGNED <i>VHV</i>	EXAMINED	DATE <i>JUNE 29, 2011</i>
CHECKED <i>DAB</i>	 ACTING ENGINEER OF STRUCTURAL SERVICES  ACTING ENGINEER OF BRIDGES AND STRUCTURES	REVISED
DRAWN <i>Kyle M. Steffen</i>		REVISED
CHECKED <i>VHV DAB</i>		REVISED

**STATE OF ILLINOIS  
DEPARTMENT OF TRANSPORTATION**

**DECK PATCHING DETAILS  
SN 081-0017 (NB)**  
SHEET NO. 3 OF 3 SHEETS

F.A.I. RTE.	SECTION	COUNTY	TOTAL SHEETS	SHEET NO.
80	137-1B1-1, 81-1VB, 81-1HB-1M-1	ROCK ISLAND	15	12
CONTRACT NO. 64H27			ILLINOIS FED. AID PROJECT	

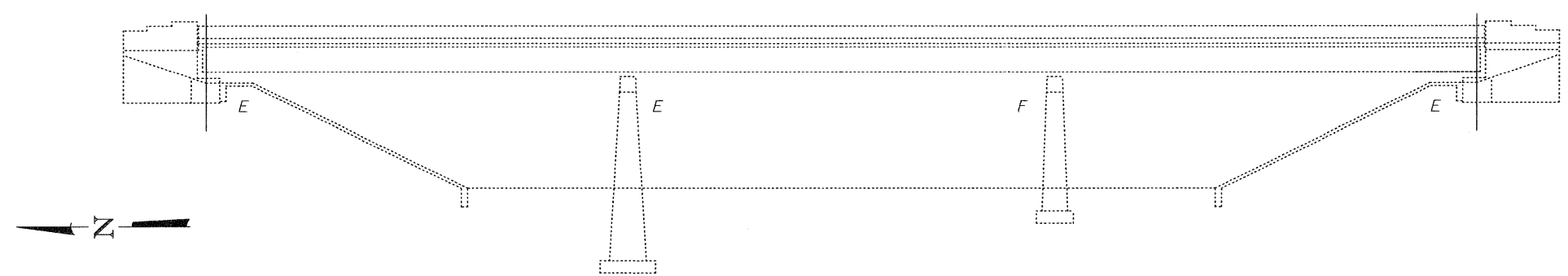

**ELEVATION**

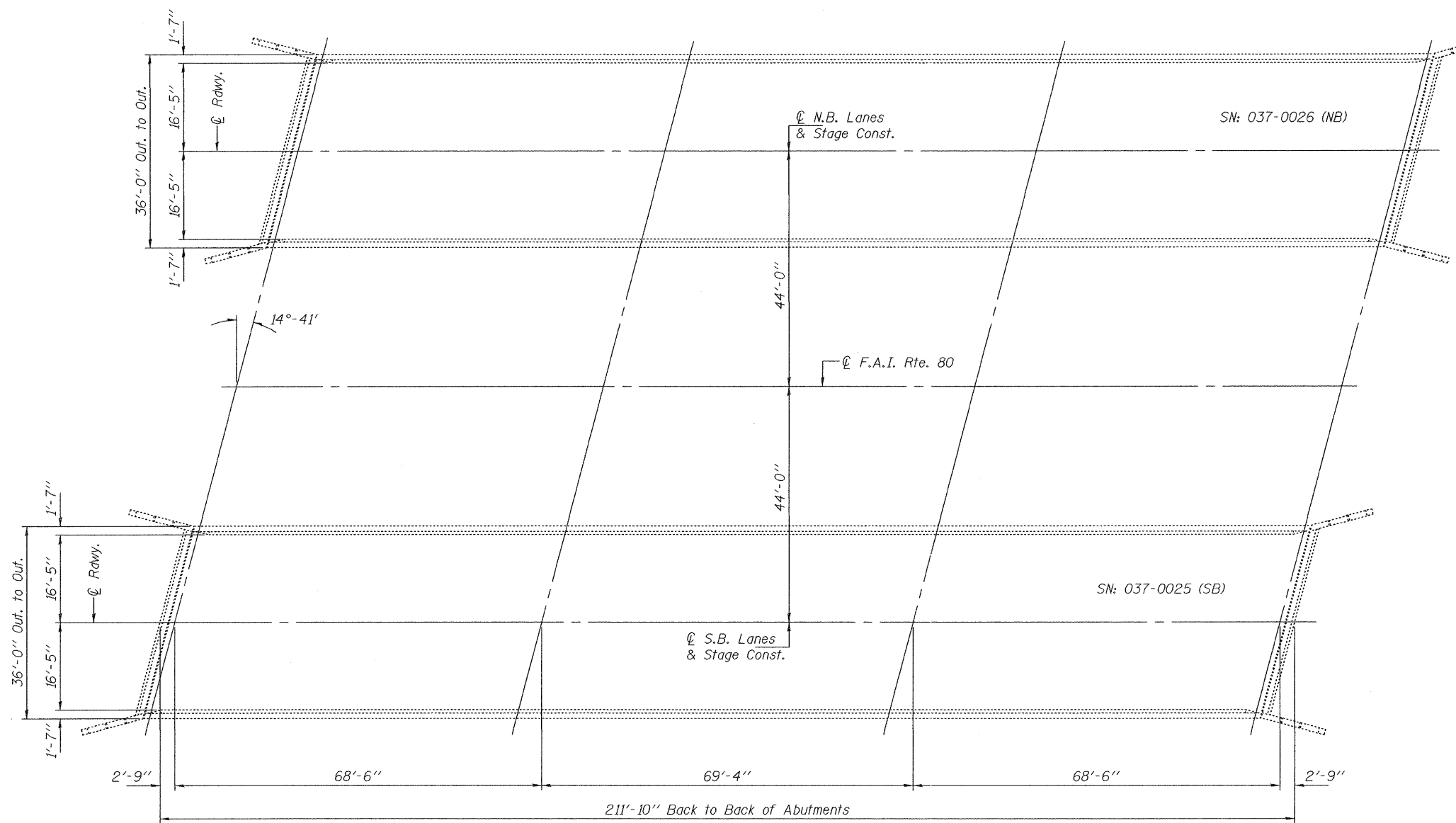

**PLAN**

**GENERAL NOTES**

Plan dimensions and details relative to existing plans are subject to nominal construction variations. The Contractor shall field verify existing dimensions and details affecting new construction and make necessary approved adjustments prior to construction or ordering of materials. Such variations shall not be cause for additional compensation for a change in scope of the work, however, the Contractor will be paid for the quantity actually furnished at the unit price bid for the work.

Existing reinforcement bars extending into the removal area shall be cleaned, straightened and incorporated into the new construction. Any reinforcement bars that are damaged during concrete removal shall be replaced with an approved bar splicer or anchorage system. Cost included with Concrete Removal.

Areas of deck repairs shown are estimated. The Engineer shall show actual locations of deck repairs on As-built Plans.

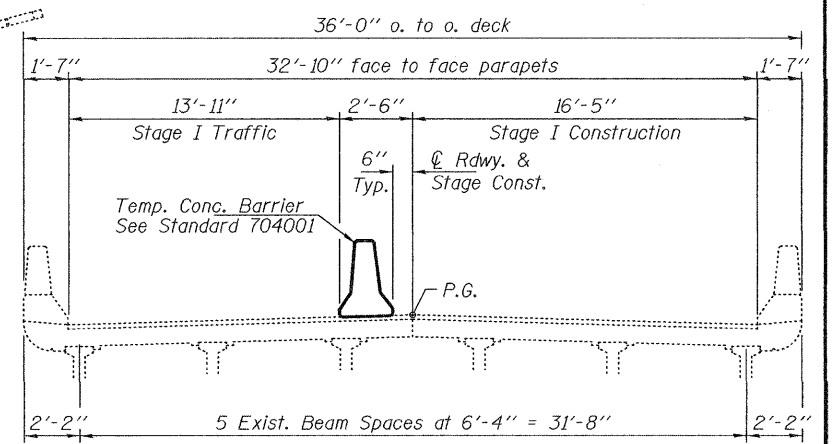

**CROSS SECTION**

(Looking South SN 037-0026)  
(Looking North SN 037-0025)

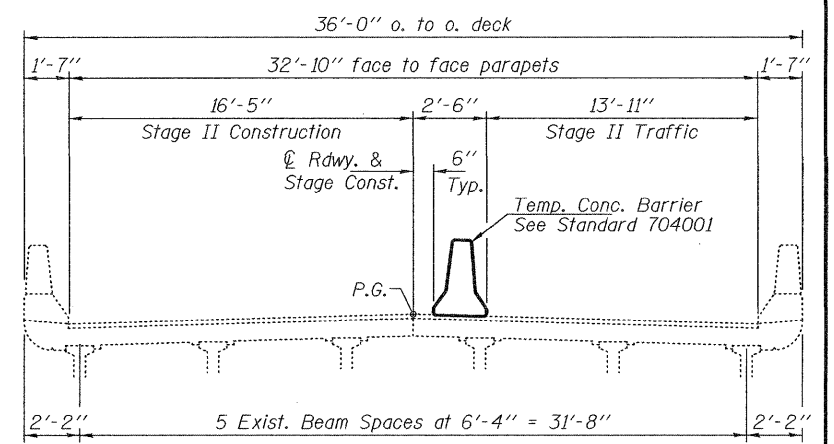

**CROSS SECTION**

(Looking South SN 037-0026)  
(Looking North SN 037-0025)

**TOTAL BILL OF MATERIAL**

Item	Unit	Quantity
Deck Slab Repair (Partial)	Sq. Yd.	283
Deck Slab Repair (Full Depth, Type I)	Sq. Yd.	250
Polymerized Hot-Mix Asphalt	Ton	152
Surface Course, Mix "D", N90	Ton	152
Silicone Joint Sealer, 1 3/4"	Foot	72
Silicone Joint Sealer, 2"	Foot	72
Polymer Concrete	Cu. Ft.	8.0
Polymerized Leveling Binder (Machine Method), N50	Ton	76



EXPIRES 11-30-2012

DESIGNED <i>Victor Veliz</i>	EXAMINED <i>Jean F. Joffe</i>	DATE <u>JUNE 29, 2011</u>
CHECKED <i>Kyle M. Steffen</i>	PASSED <i>David Carl Puzey</i>	REVISED
DRAWN <i>Kyle M. Steffen</i>	ACTING ENGINEER OF STRUCTURAL SERVICES	REVISED
CHECKED	ACTING ENGINEER OF BRIDGES AND STRUCTURES	

**STATE OF ILLINOIS  
DEPARTMENT OF TRANSPORTATION**

**GENERAL PLAN & ELEVATION  
F.A.I. ROUTE 80 OVER GREEN RIVER  
SN 037-0025 (SB) & 0026 (NB)**

SHEET NO. 1 OF 3 SHEETS

F.A.I. RTE.	SECTION	COUNTY	TOTAL SHEETS	SHEET NO.
80	(37-1B)-1, 81-1VB, 81-1HB-1M-1	HENRY	15	13
			CONTRACT NO. 64H27	
ILLINOIS FED. AID PROJECT				

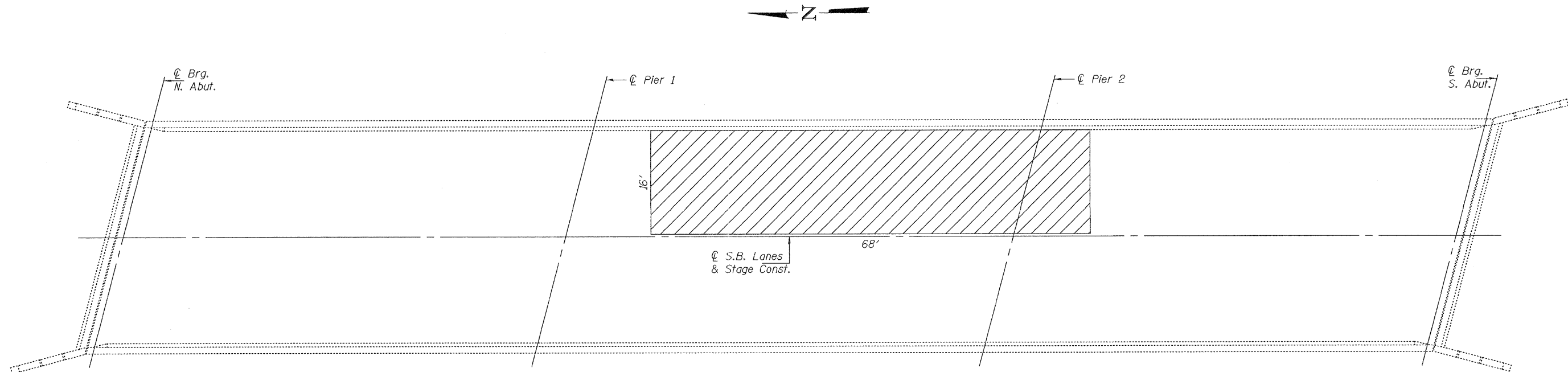

**PLAN**

Hatched areas indicate Deck Slab Repair (Partial)  
Areas of deck repair are estimated. Actual locations shall be shown by the Engineer for As Built Plans.

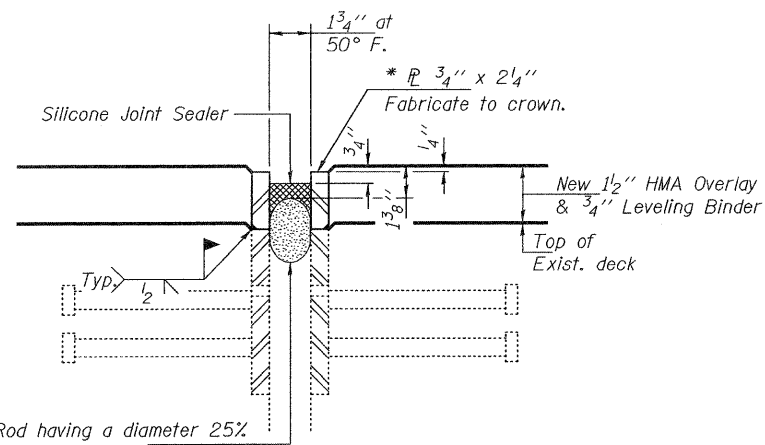

**SECTION THRU JOINT AT SOUTH ABUTMENT**

\* Furnish in segments of 20 ft. maximum length. Maximum space between installed segments shall be 3/6". Seal space with Silicone Sealant suitable for Structural Steel. After fabrication, all surfaces of the steel P shall be given one shop coat of paint specified for structural steel. No field painting required. Cost included with HMA overlay.

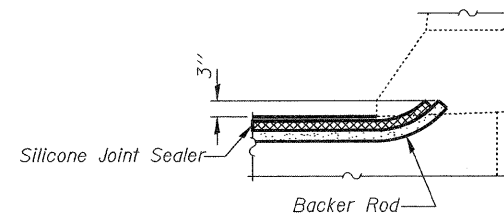

**TYPICAL END OF SEAL TREATMENT**

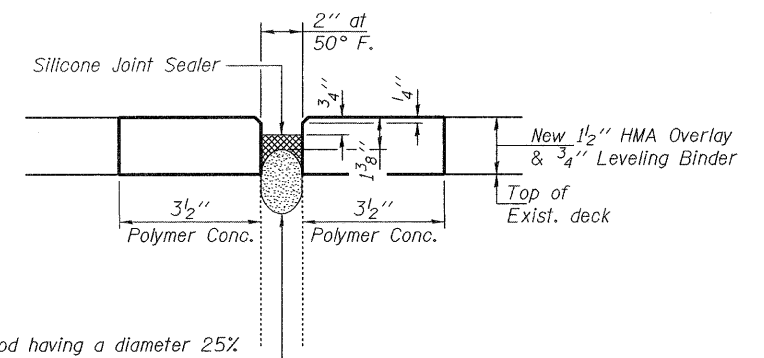

**SECTION THRU JOINT AT NORTH ABUTMENT**

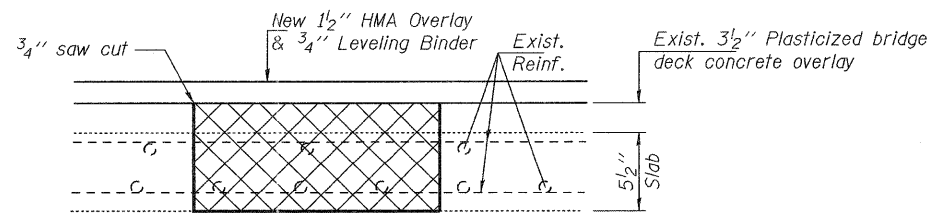

**TYPICAL DECK REPAIR DETAIL**

Cross hatched areas indicate Deck Slab Repair (Full Depth, Type II)

**BILL OF MATERIAL**

Item	Unit	Quantity
Deck Slab Repair (Partial)	Sq. Yd.	120
Deck Slab Repair (Full Depth, Type I)	Sq. Yd.	125
Polymerized Hot-Mix Asphalt Surface Course, Mix "D", N90	Ton	76
Silicone Joint Sealer, 1 3/4"	Foot	36
Silicone Joint Sealer, 2"	Foot	36
Polymer Concrete	Cu. Ft.	4.0
Polymerized Leveling Binder (Machine Method), N50	Ton	38

DESIGNED VHV	EXAMINED	DATE JUNE 29, 2011
CHECKED DAB	PASSED	REVISIED
DRAWN Kyle M. Steffen	ACTING ENGINEER OF BRIDGES AND STRUCTURES	REVISIED
CHECKED -		

STATE OF ILLINOIS  
DEPARTMENT OF TRANSPORTATION

DECK PATCHING DETAILS  
SN 037-0025 (SB)

SHEET NO. 2 OF 3 SHEETS

F.A.T. RTE.	SECTION	COUNTY	TOTAL SHEETS	SHEET NO.
80	037-1BY-1, 81-1VB, 81-1HB-1M-1	HENRY	15	14
CONTRACT NO. 64H27			ILLINOIS FED. AID PROJECT	

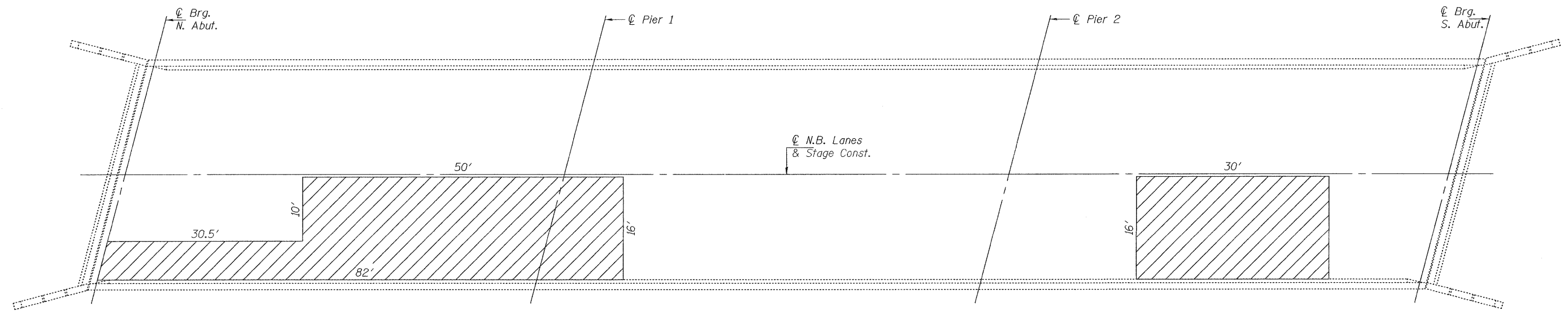
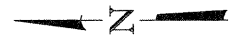

**PLAN**

Hatched areas indicate Deck Slab Repair (Partial). Areas of deck repair are estimated. Actual locations shall be shown by the Engineer for As Built Plans.

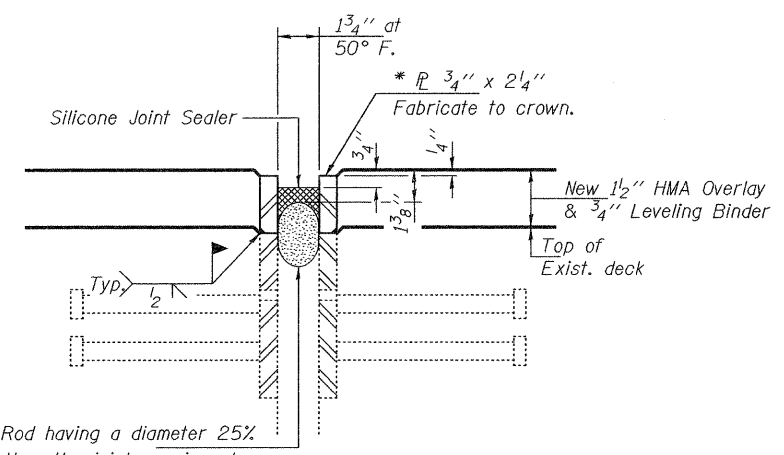

Backer Rod having a diameter 25% greater than the joint opening at the time of installation.

**SECTION THRU JOINT AT SOUTH ABUTMENT**

\* Furnish in segments of 20 ft. maximum length. Maximum space between installed segments shall be 3/6". Seal space with Silicone Sealant suitable for Structural Steel. After fabrication, all surfaces of the steel R shall be given one shop coat of paint specified for structural steel. No field painting required. Cost included with HMA overlay.

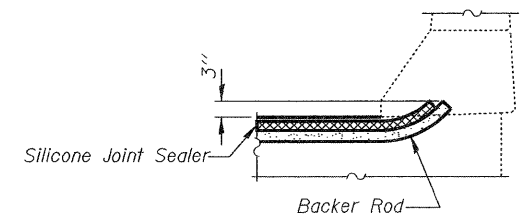

**TYPICAL END OF SEAL TREATMENT**

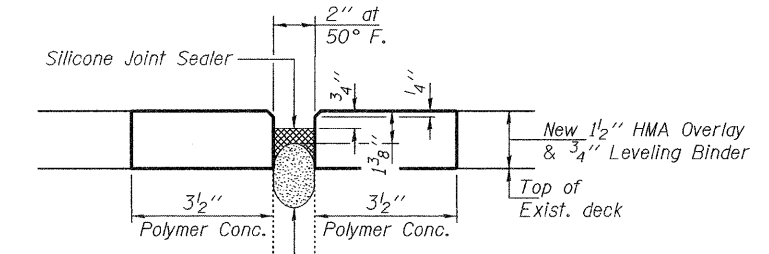

Backer Rod having a diameter 25% greater than the joint opening at the time of installation.

**SECTION THRU JOINT AT NORTH ABUTMENT**

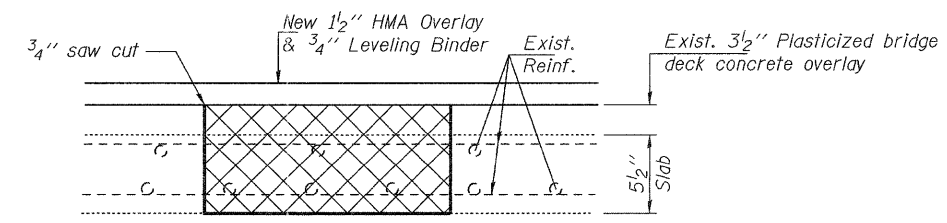

**TYPICAL DECK REPAIR DETAIL**

Cross hatched areas indicate Deck Slab Repair (Full Depth, Type II)

**BILL OF MATERIAL**

Item	Unit	Quantity
Deck Slab Repair (Partial)	Sq. Yd.	163
Deck Slab Repair (Full Depth, Type I)	Sq. Yd.	125
Polymerized Hot-Mix Asphalt Surface Course, Mix "D", N90	Ton	76
Silicone Joint Sealer, 1 3/4"	Foot	36
Silicone Joint Sealer, 2"	Foot	36
Polymer Concrete	Cu. Ft.	4.0
Polymerized Leveling Binder (Machine Method), N50	Ton	38