

BENCHMARK: PAINTED TRIANGLE ON TOP OF NW CORNER OF NORTH ABUTMENT
ELEV = 471.91

EXISTING STRUCTURE: SN 078-0003 IS A THREE-SPAN R.C. SLAB BRIDGE ON OPEN ABUTMENTS.

ROUTE NO.	SECTION	COUNTY	TOTAL SHEETS	SHEET NO.
VAR	*	VAR	38	13
FED. ROAD DIST. NO. 4		ILLINOIS	FED. AID PROJECT	

*** D4 SCOUR MITIGATION 2011**

INDEX OF SHEETS

SHEET NUMBER	DESCRIPTION
1	GENERAL PLAN AND ELEVATION, SUMMARY OF QUANTITIES, LOCATION MAP
2	PROPOSED SITE PLAN
3	PROPOSED DIMENSION PLAN
4	SITE PROFILE
5-8	CROSS SECTIONS

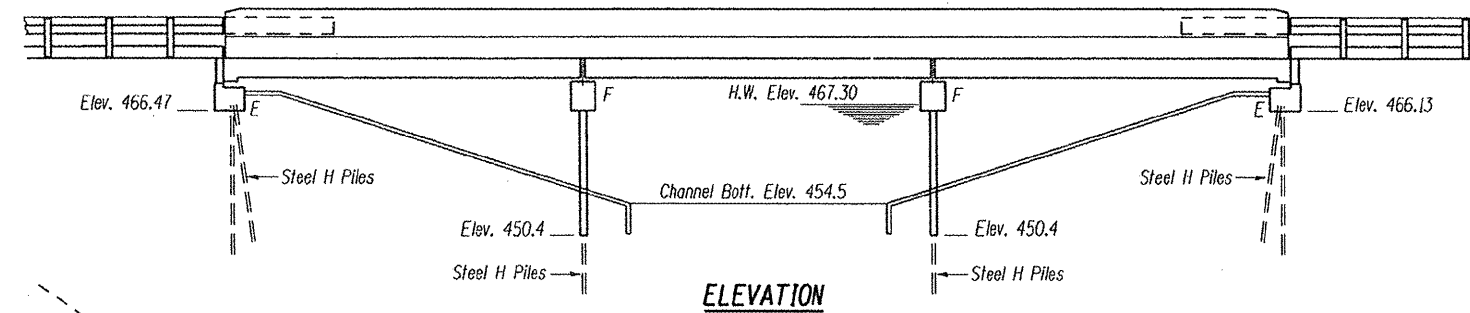

BILL OF MATERIALS

ITEM	UNIT	TOTAL
CHANNEL EXCAVATION	CU YD	52
STONE RIPRAP, CLASS A5	TONS	689
FILTER FABRIC	SQ YD	316
SUB-BASE GRANULAR MATERIAL, TYPE C	CU YD	10
DEWATERING STRUCTURE NO. 2	EACH	1
CONSTRUCTION ACCESS	EACH	1

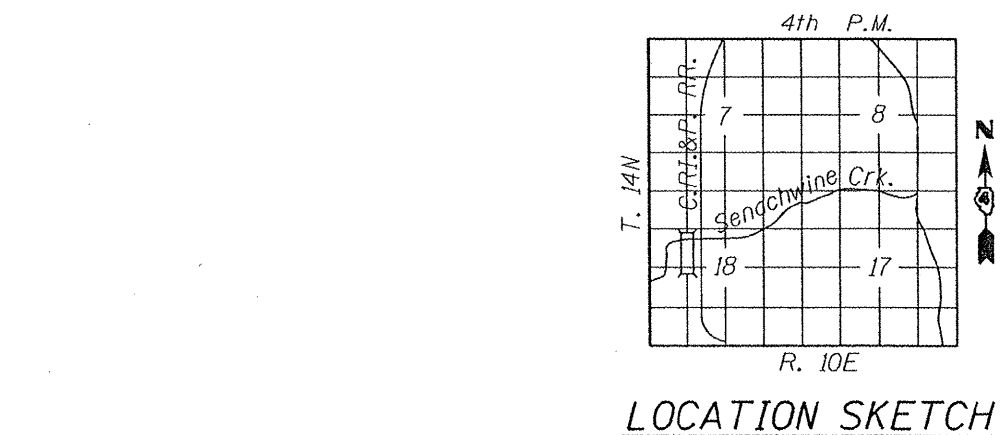
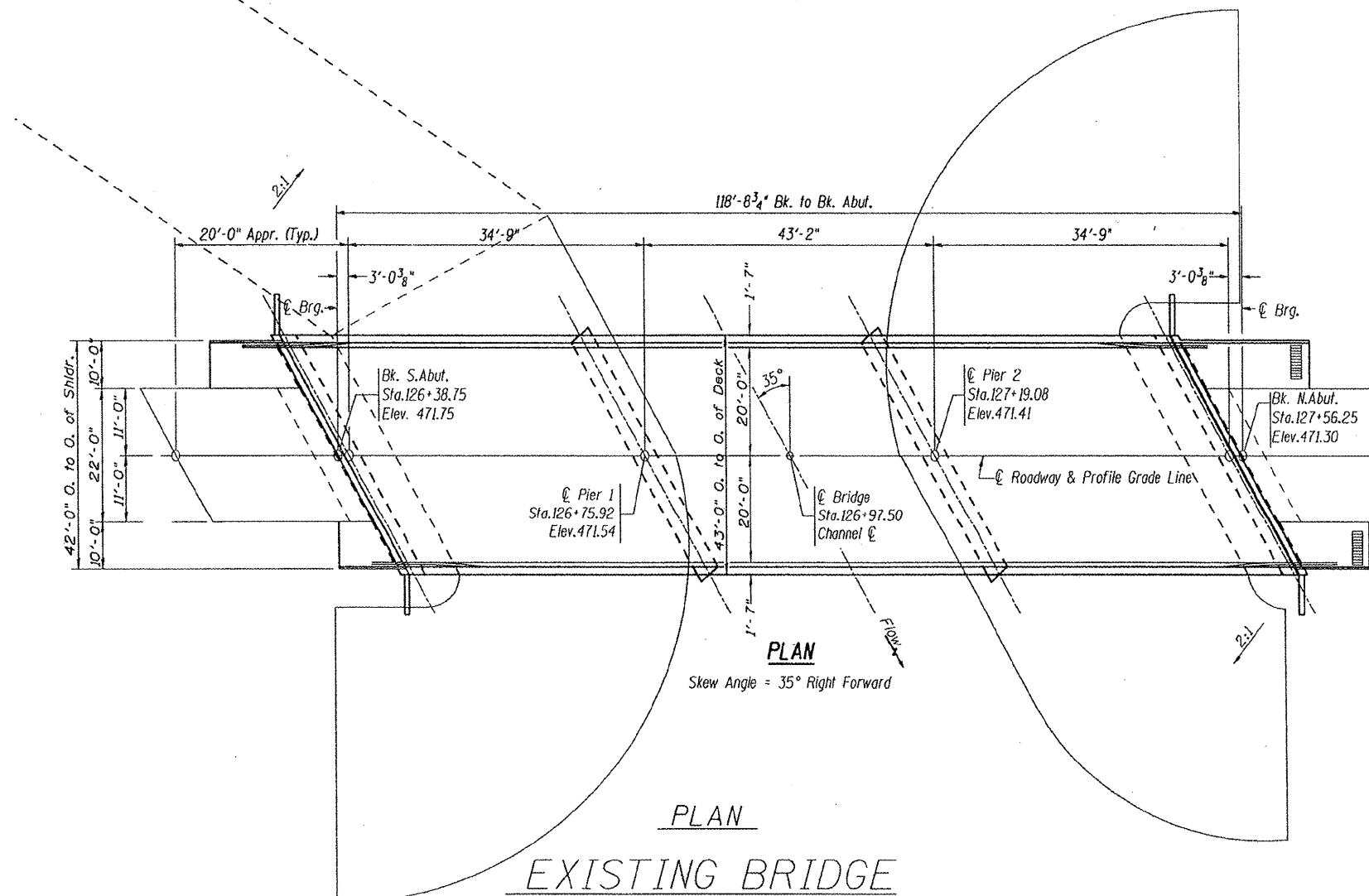

WATERWAY/SCOUR INFORMATION

DESIGN FLOOD	100 YRS
DRAINAGE AREA	18.2 SQ MI
FLOW	6,997 CFS
FLOW DEPTH	11.37 FT
CONTRACTION SCOUR DEPTH	17 FT

ILLINOIS DEPARTMENT OF TRANSPORTATION
GENERAL PLAN & ELEVATION
S.N. 078-0003
F.A.P. 318 (ILLINOIS 29)
OVER SENACHWINE CREEK
PUTNAM COUNTY
SHEET 1 OF 7