

ROUTE NO.	SECTION	COUNTY	TOTAL SHEETS	SHEET NO.
VAR	*	VAR	38	24
FED. ROAD DIST. NO. 4		ILLINOIS	FED. AID PROJECT	

*** D4 SCOUR MITIGATION 2011**

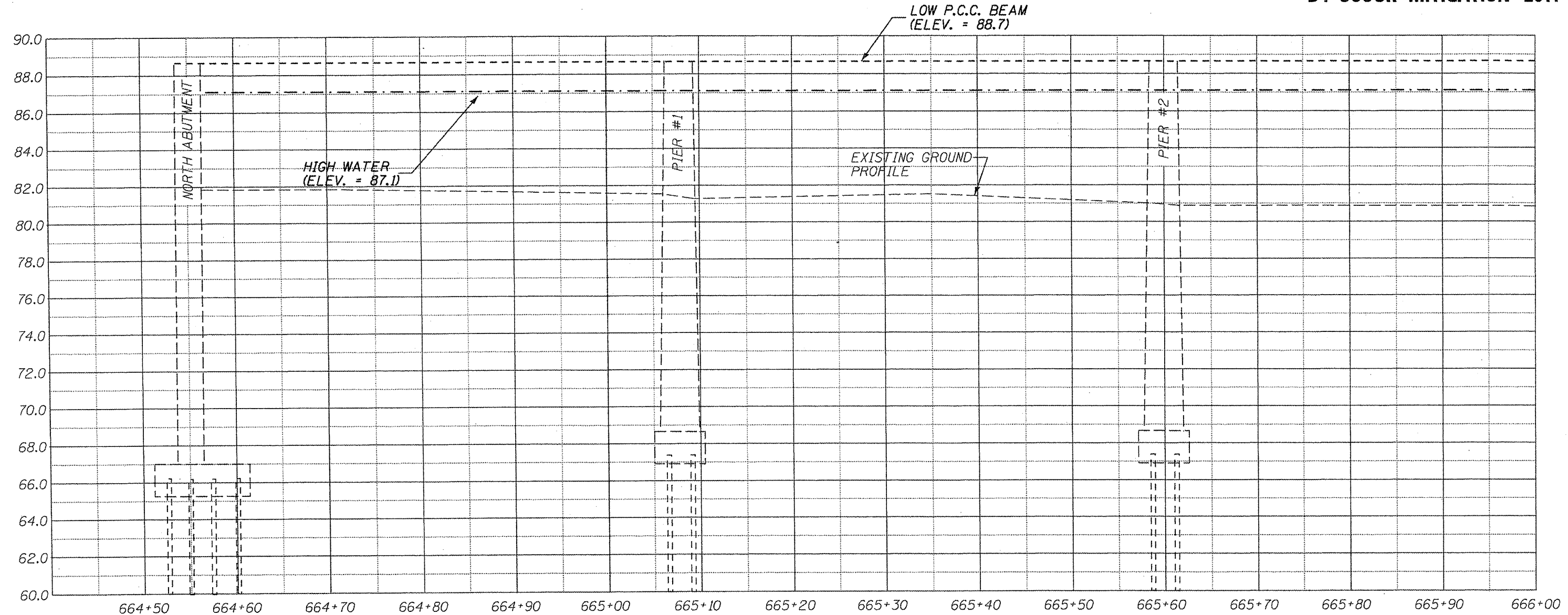

SECTION A-A THROUGH \odot SN 090-0087

NOTE: ELEVATIONS OF EXISTING FOOTINGS ARE TAKEN FROM EXISTING PLANS. THE ELEVATION OF THE RIPRAP ABOVE SHALLOW FOOTINGS IS TO BE BASED ON FIELD MEASUREMENTS OF THE DEPTH.

ILLINOIS DEPARTMENT OF TRANSPORTATION
 SITE CROSS SECTION
 S.N. 090-0087
 OLD IL 121
 OVER MACKINAW RIVER
 TAZEWELL COUNTY
 SHEET 5 OF 9

SCALE: 1" = 20'