

STATE OF ILLINOIS  
DEPARTMENT OF TRANSPORTATION  
DIVISION OF HIGHWAYS

**PROPOSED  
HIGHWAY PLANS**

FAI 72 (I-72)  
SECTION (84-10-1)I-7

INTERSTATE PAVING  
SANGAMON COUNTY

C-96-083-11

F.A.I. RTE.	SECTION	COUNTY	TOTAL SHEETS	SHEET NO.
I-72	(84-10-1)I-7	SANGAMON	41	1
		ILLINOIS	CONTRACT NO. 72E51	

D-96-083-11

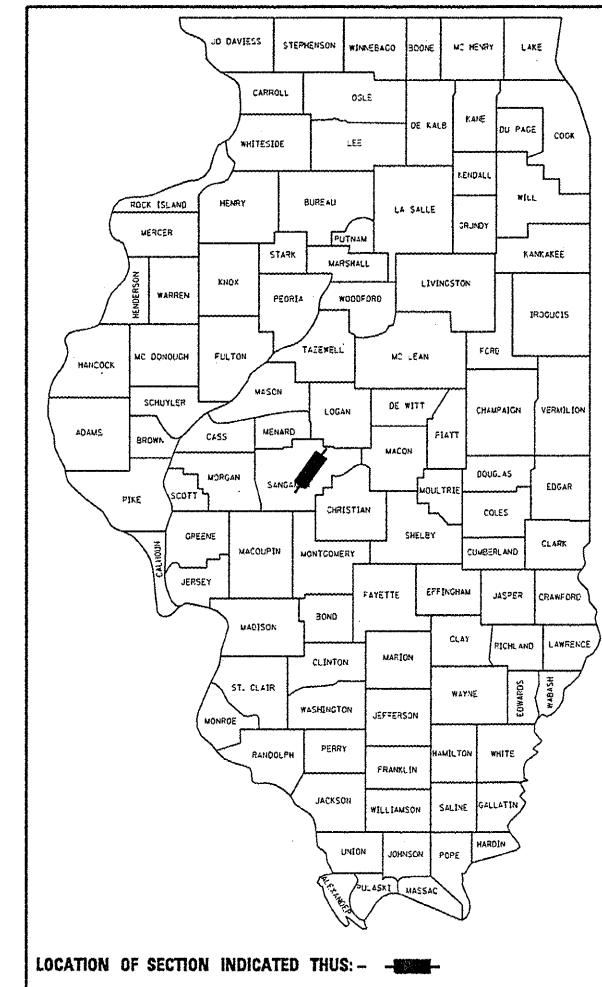

**INDEX OF SHEETS**

- 1 COVER SHEET
- 2 GENERAL NOTES
- 3-4 SUMMARY OF QUANTITIES
- 5 SCHEDULE OF QUANTITIES
- 6-8 TYPICAL SECTIONS
- 9 ALIGNMENT, TIES, AND BENCHMARKS
- 10-13 PLAN AND PROFILE SHEETS
- 14-18 EROSION AND SEDIMENT CONTROL DETAILS (SWPPP)
- 19-20 ELEVATION DETAIL SHEETS
- 21 LIGHTING PLAN SHEET
- 22-24 LIGHTING DETAIL SHEETS
- 25 MISCELLANEOUS DETAIL SHEET
- 26-30 PROPOSED MAINTENANCE OF TRAFFIC SHEETS
- 31-41 CROSS SECTIONS

**STANDARDS**

000001-06	635011-02
001006	701101-02
280001-05	701401-06
542301-03	701901-01
602306-03	720011-01
604106-01	728001-01
604101-01	729001-01
630001-09	780001-02
631031-09	781001-03
635006-03	701400-05
701101-02	701406-06
701106-02	

END IMPROVEMENT  
FAI 72 STA. 209 + 97.15

SN 084-0152 WB  
SN 084-0153 EB  
FAI 72 OVER SANGAMON RIVER  
STA. 197 + 39.58

BEGIN IMPROVEMENT  
I-72 STA. 183 + 50.00

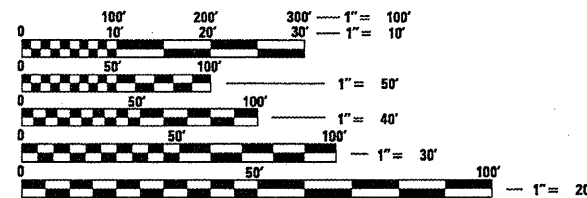
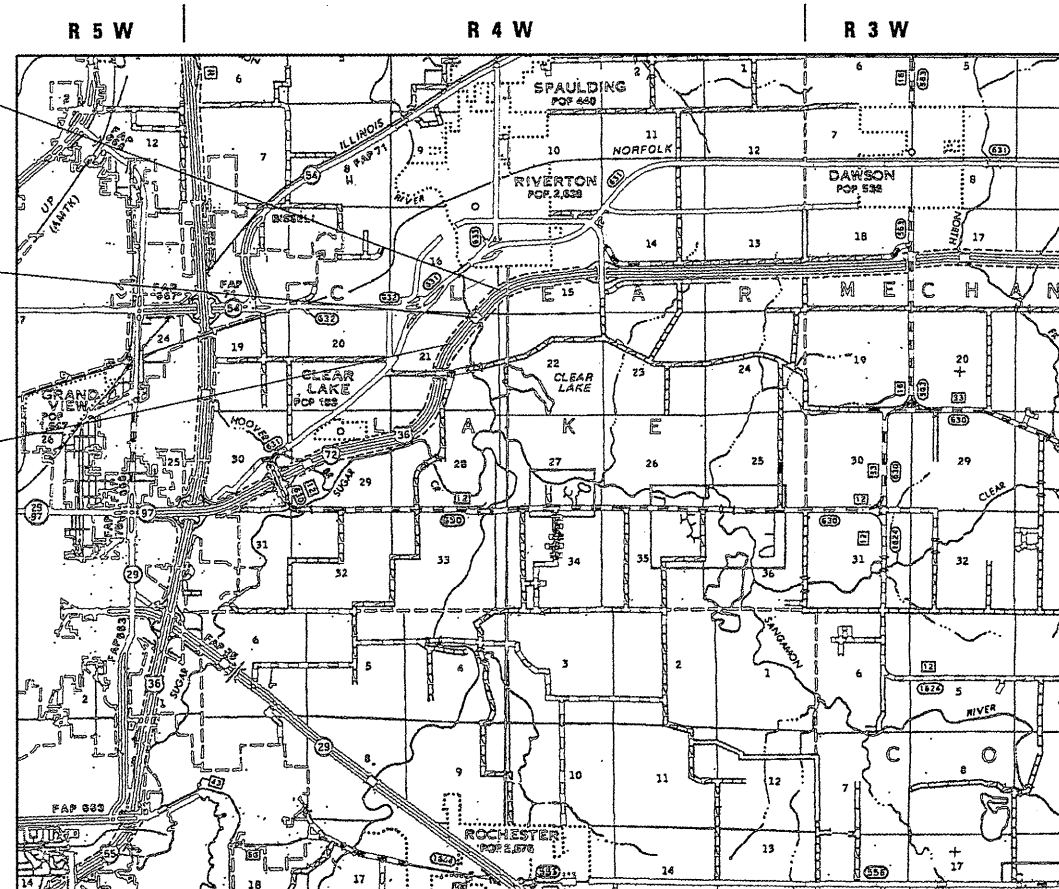

FULL SIZE PLANS HAVE BEEN PREPARED USING STANDARD ENGINEERING SCALES. REDUCED SIZED PLANS WILL NOT CONFORM TO STANDARD SCALES. IN MAKING MEASUREMENTS ON REDUCED PLANS, THE ABOVE SCALES MAY BE USED.

J.U.L.I.E.  
JOINT UTILITY LOCATION INFORMATION FOR EXCAVATION  
1-800-892-0123  
OR 811

PROJECT ENGINEER : JOHN NEGANGARD (217) 782-6990  
PROJECT MANAGER : VICTOR YOUNG (217) 557-7897  
CONTRACT NO. 72E51

FAI 55  
FUNCTION CLASS = INTERSTATE  
A.D.T. (2011) 13,100  
SU (2011) 410  
MU (2011) 1,590  
PV (2011) 11,100

NET LENGTH OF FAI 72 = 2,988.20 FT = 0.566 MILES  
TOTAL LENGTH OF PROJECT = 2,988.20 FT = 0.566 MILES



STATE OF ILLINOIS  
DEPARTMENT OF TRANSPORTATION  
DIVISION OF HIGHWAYS

SUBMITTED *June 7 20 11*  
*Roy D. Dickey*  
DEPUTY DIRECTOR OF HIGHWAYS, REGION ENGINEER

*July 1 20 11*  
*Scott E. Stett, P.E.*  
ASSISTANT ENGINEER OF DESIGN AND ENVIRONMENT

*July 1 20 11*  
*Christine M. Beal*  
DIRECTOR OF HIGHWAYS, CHIEF ENGINEER

PRINTED BY THE AUTHORITY  
OF THE STATE OF ILLINOIS

**HE**  
HOELSCHER  
ENGINEERING

11 Executive Drive Suite 12  
Fairview Heights, Illinois 62208  
(618) 624-8610  
(618) 624-8611 (fax)

2501 Chatham Road, Suite 120  
Springfield, Illinois 62704  
(217) 698-8610  
(217) 698-8608 (fax)

115 North Neil Street, Suite 105  
Champaign, Illinois 61820  
(217) 351-8610  
(217) 351-8611 (fax)

JEFFREY S. ANTON  
LICENSED PROFESSIONAL ENGINEER  
OF ILLINOIS

DATE: *6-7-2011*  
LICENSE EXP. *11/30/2011*