

EXIST. CURVE 8
 PI STA. = 1571+72.53
 $\Delta = 42^\circ 41' 20''$ (RT)
 $D = 1^\circ 12' 00''$
 $R = 4,774.74'$
 $T = 1,865.86'$
 $L = 3,557.41'$
 $E = 351.62'$
 $e = \text{-----}$
 $T.R. = \text{-----}$
 $S.E. RUN = \text{-----}$
 P.C. STA. = 1553+06.67
 P.T. STA. = 1588+64.08

NOT DRAWN TO SCALE

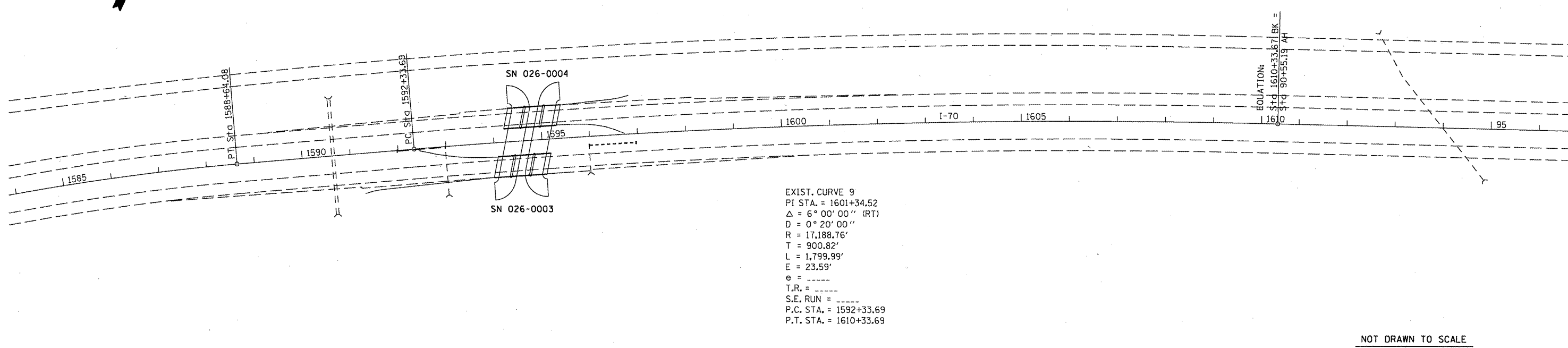

EXIST. CURVE 9
 PI STA. = 1601+34.52
 $\Delta = 6^\circ 00' 00''$ (RT)
 $D = 0^\circ 20' 00''$
 $R = 17,188.76'$
 $T = 900.82'$
 $L = 1,799.99'$
 $E = 23.59'$
 $e = \text{-----}$
 $T.R. = \text{-----}$
 $S.E. RUN = \text{-----}$
 P.C. STA. = 1592+33.69
 P.T. STA. = 1610+33.69

NOT DRAWN TO SCALE

FILE NAME =
 c:\pwork\pwork\swartzrw\d0268526\077

USER NAME = swartzrw
 522-sht-plan.dgn
 PLOT SCALE = 200.0000' / in.
 PLOT DATE = 5/28/2011

| | |
|------------|-----------|
| DESIGNED - | REVISED - |
| DRAWN - | REVISED - |
| CHECKED - | REVISED - |
| DATE - | REVISED - |

**STATE OF ILLINOIS
 DEPARTMENT OF TRANSPORTATION**

PLAN

SCALE: NA SHEET NO. 2 OF 7 SHEETS STA. 1554+00 TO STA. 96+00

| F.A.I. RTE. | SECTION | COUNTY | TOTAL SHEETS | SHEET NO. |
|---------------------------|----------------------|---------|--------------|-----------|
| 70 | D7 HMA RESURF 2012-1 | FAYETTE | 12 | 7 |
| CONTRACT NO. 74522 | | | | |
| ILLINOIS FED. AID PROJECT | | | | |