

FINAL SURVEY	SURVEYED	BY	DATE
NOTE BOOK	PLOTTED		
NO.	TEMPLATE		
	AREAS CHECKED		

ORIGINAL SURVEY	SURVEYED	BY	DATE
NOTE BOOK	PLOTTED		
NO.	TEMPLATE		
	AREAS CHECKED		

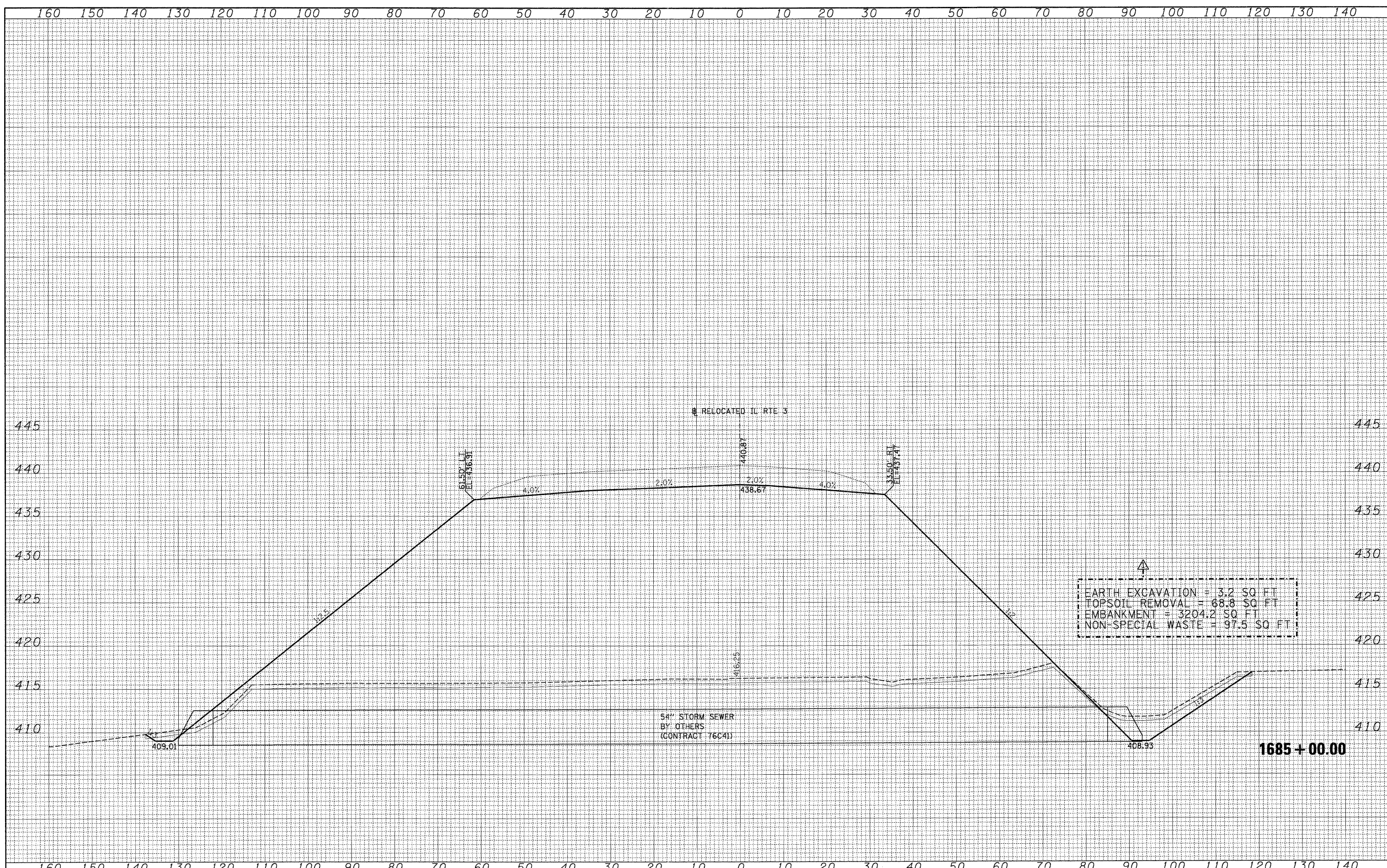

▲
 EARTH EXCAVATION = 3.2 SQ FT
 TOPSOIL REMOVAL = 68.8 SQ FT
 EMBANKMENT = 3204.2 SQ FT
 NON-SPECIAL WASTE = 97.5 SQ FT

FILE NAME =	USER NAME = *USER*	DESIGNED - JB	REVISED - 07/22/11 JB	STATE OF ILLINOIS DEPARTMENT OF TRANSPORTATION				CROSS SECTIONS RELOCATED IL ROUTE 3				F.A. RTE. 998	SECTION 82-2-IHVB-1	COUNTY ST. CLAIR	TOTAL SHEETS 345	SHEET NO. 322
FILEL	PLOT SCALE = *SCALE*	DRAWN - AG	REVISED -					SCALE:	SHEET NO.	OF	SHEETS	STA. 1685+00.00 TO STA. 1685+00.00	ILLINOIS FED. AID PROJECT			
	PLOT DATE = *DATE*	CHECKED - ACL	REVISED -									CONTRACT NO. 76D05				
		DATE - 05/13/11	REVISED -													