

PROJECT INFORMATION AND REVISIONS:
1. 05/13/11, 10:55:53
2. 05/13/11, 10:55:53
3. 05/13/11, 10:55:53
4. 05/13/11, 10:55:53
5. 05/13/11, 10:55:53
6. 05/13/11, 10:55:53
7. 05/13/11, 10:55:53
8. 05/13/11, 10:55:53
9. 05/13/11, 10:55:53
10. 05/13/11, 10:55:53
11. 05/13/11, 10:55:53
12. 05/13/11, 10:55:53
13. 05/13/11, 10:55:53
14. 05/13/11, 10:55:53
15. 05/13/11, 10:55:53
16. 05/13/11, 10:55:53
17. 05/13/11, 10:55:53
18. 05/13/11, 10:55:53
19. 05/13/11, 10:55:53
20. 05/13/11, 10:55:53
21. 05/13/11, 10:55:53
22. 05/13/11, 10:55:53
23. 05/13/11, 10:55:53
24. 05/13/11, 10:55:53
25. 05/13/11, 10:55:53
26. 05/13/11, 10:55:53
27. 05/13/11, 10:55:53
28. 05/13/11, 10:55:53
29. 05/13/11, 10:55:53
30. 05/13/11, 10:55:53
31. 05/13/11, 10:55:53
32. 05/13/11, 10:55:53
33. 05/13/11, 10:55:53
34. 05/13/11, 10:55:53
35. 05/13/11, 10:55:53
36. 05/13/11, 10:55:53
37. 05/13/11, 10:55:53
38. 05/13/11, 10:55:53
39. 05/13/11, 10:55:53
40. 05/13/11, 10:55:53
41. 05/13/11, 10:55:53
42. 05/13/11, 10:55:53
43. 05/13/11, 10:55:53
44. 05/13/11, 10:55:53
45. 05/13/11, 10:55:53
46. 05/13/11, 10:55:53
47. 05/13/11, 10:55:53
48. 05/13/11, 10:55:53
49. 05/13/11, 10:55:53
50. 05/13/11, 10:55:53
51. 05/13/11, 10:55:53
52. 05/13/11, 10:55:53
53. 05/13/11, 10:55:53
54. 05/13/11, 10:55:53
55. 05/13/11, 10:55:53
56. 05/13/11, 10:55:53
57. 05/13/11, 10:55:53
58. 05/13/11, 10:55:53
59. 05/13/11, 10:55:53
60. 05/13/11, 10:55:53
61. 05/13/11, 10:55:53
62. 05/13/11, 10:55:53
63. 05/13/11, 10:55:53
64. 05/13/11, 10:55:53
65. 05/13/11, 10:55:53
66. 05/13/11, 10:55:53
67. 05/13/11, 10:55:53
68. 05/13/11, 10:55:53
69. 05/13/11, 10:55:53
70. 05/13/11, 10:55:53
71. 05/13/11, 10:55:53
72. 05/13/11, 10:55:53
73. 05/13/11, 10:55:53
74. 05/13/11, 10:55:53
75. 05/13/11, 10:55:53
76. 05/13/11, 10:55:53
77. 05/13/11, 10:55:53
78. 05/13/11, 10:55:53
79. 05/13/11, 10:55:53
80. 05/13/11, 10:55:53
81. 05/13/11, 10:55:53
82. 05/13/11, 10:55:53
83. 05/13/11, 10:55:53
84. 05/13/11, 10:55:53
85. 05/13/11, 10:55:53
86. 05/13/11, 10:55:53
87. 05/13/11, 10:55:53
88. 05/13/11, 10:55:53
89. 05/13/11, 10:55:53
90. 05/13/11, 10:55:53
91. 05/13/11, 10:55:53
92. 05/13/11, 10:55:53
93. 05/13/11, 10:55:53
94. 05/13/11, 10:55:53
95. 05/13/11, 10:55:53
96. 05/13/11, 10:55:53
97. 05/13/11, 10:55:53
98. 05/13/11, 10:55:53
99. 05/13/11, 10:55:53
100. 05/13/11, 10:55:53

MATCH LINE STA. 20+00
SEE SHEET 43

MATCH LINE STA. 1679+50
SEE SHEET 41

MATCH LINE STA. 53+50
SEE SHEET 43

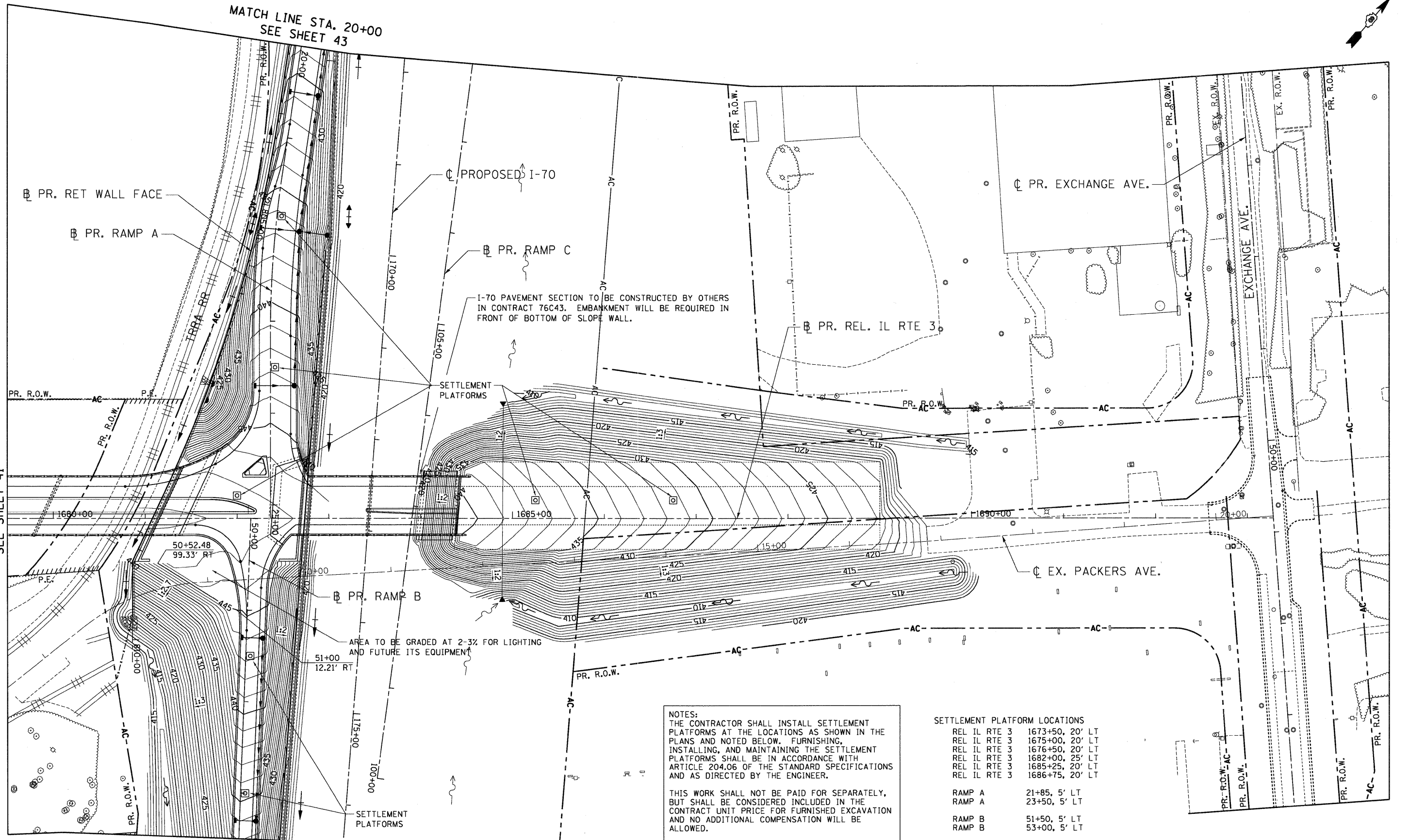

NOTES:
THE CONTRACTOR SHALL INSTALL SETTLEMENT PLATFORMS AT THE LOCATIONS AS SHOWN IN THE PLANS AND NOTED BELOW. FURNISHING, INSTALLING, AND MAINTAINING THE SETTLEMENT PLATFORMS SHALL BE IN ACCORDANCE WITH ARTICLE 204.06 OF THE STANDARD SPECIFICATIONS AND AS DIRECTED BY THE ENGINEER.

THIS WORK SHALL NOT BE PAID FOR SEPARATELY, BUT SHALL BE CONSIDERED INCLUDED IN THE CONTRACT UNIT PRICE FOR FURNISHED EXCAVATION AND NO ADDITIONAL COMPENSATION WILL BE ALLOWED.

REL IL RTE 3	1673+50, 20' LT
REL IL RTE 3	1675+00, 20' LT
REL IL RTE 3	1676+50, 20' LT
REL IL RTE 3	1682+00, 25' LT
REL IL RTE 3	1685+25, 20' LT
REL IL RTE 3	1686+75, 20' LT
RAMP A	21+85, 5' LT
RAMP A	23+50, 5' LT
RAMP B	51+50, 5' LT
RAMP B	53+00, 5' LT

TEN TENG & ASSOCIATES, INC.
ENGINEERS/ARCHITECTS/PLANNERS
CHICAGO, ILLINOIS

FILE NAME =	USER NAME = *USER*	DESIGNED - JB	REVISED -
#FILE#		DRAWN - JB	REVISED -
PLOT SCALE = *SCALE*		CHECKED - ACL	REVISED -
PLOT DATE = *DATE*		DATE - 05/13/11	REVISED -

**STATE OF ILLINOIS
DEPARTMENT OF TRANSPORTATION**
RELOCATED ILLINOIS ROUTE 3

**PROPOSED RELOCATED ILLINOIS ROUTE 3
GRADING PLAN
STA. 1679 + 50 TO STA. 1693 + 28.38**
SCALE: 1"=50' SHEET NO. 2 OF 3 SHEETS STA. TO STA.

F.A.P. RTE. 998	SECTION 82-2-IHV-B-1	COUNTY ST. CLAIR	TOTAL SHEETS 345	SHEET NO. 42
FED. ROAD DIST. NO.				ILLINOIS FED. AID PROJECT
CONTRACT NO. 76D05				