

- ① TOPSOIL FURNISH AND PLACE, 4"
- ② COMBINATION CONCRETE CURB & GUTTER, TYPE B-6.24
- ③ PROPOSED PAVEMENT (EXCLUDING SURFACE)
- ④ REMOVE EXISTING PAVEMENT
- ⑤ AGGREGATE SHOULDER, TYPE B, 6"
- ⑥ TEMPORARY PAVEMENT MARKING, 4" - SOLID - WHITE
- ⑦ TEMPORARY PAVEMENT MARKING, 4" - SOLID - DOUBLE YELLOW, 11" C-C
- ⑧ TYPE II BARRICADE OR DRUM
- ⑨ TEMPORARY CONCRETE BARRIER
- ⑩ TEMPORARY HOT-MIX ASPHALT BINDER COURSE

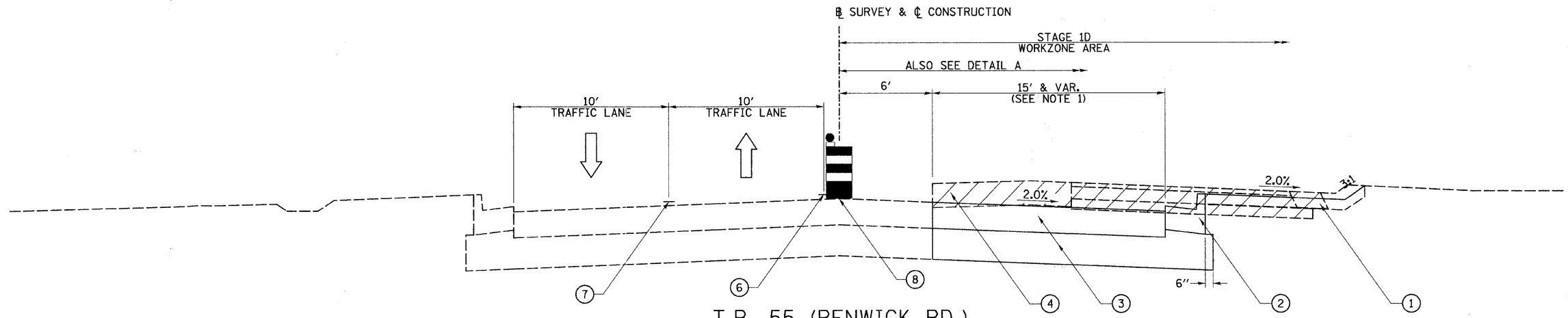

T.R. 55 (RENWICK RD.)
STAGE 1D
 STA. 126+96 TO STA. 133+44

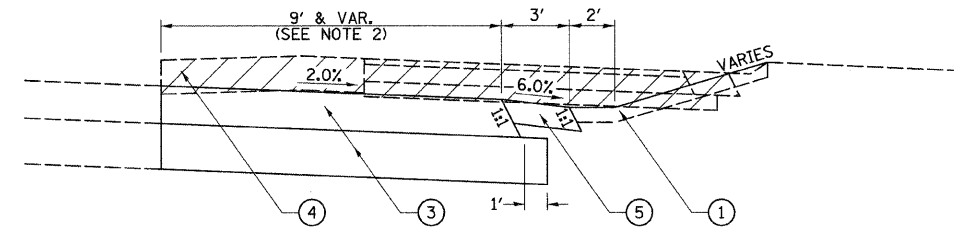

DETAIL A
 STA. 132+25.28 TO STA. 133+44.19

- NOTES:**
- 1. VARIES FROM 15' @ STA. 129+85.28 TO 9.0' @ STA. 132+25.28
 - 2. VARIES FROM 9.0' @ STA. 132+25.28 TO 8.2' @ STA. 133+44.19
 - 3. VARIES FROM 1' @ STA. 11+60.34 TO 9' @ STA. 12+43.50

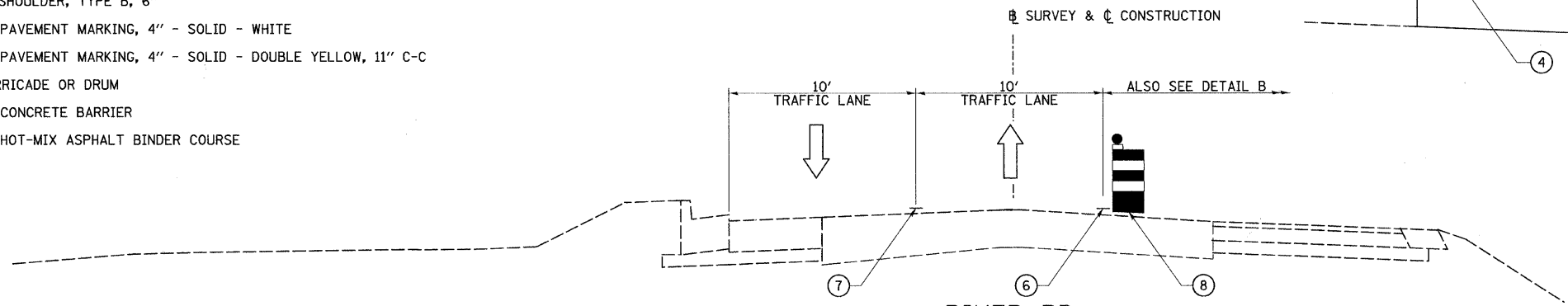

RIVER RD.
STAGE 1D
 STA. 7+90.99 TO STA. 10+00.00
 STA. 16+44.11 TO STA. 19+81.31

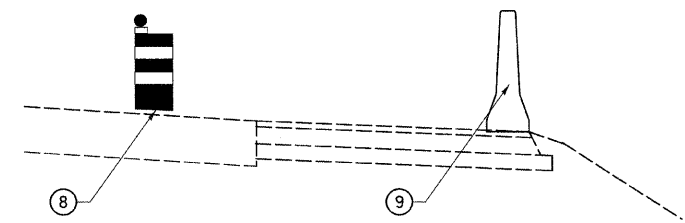

DETAIL B
 STA. 8+47 TO STA. 11+63

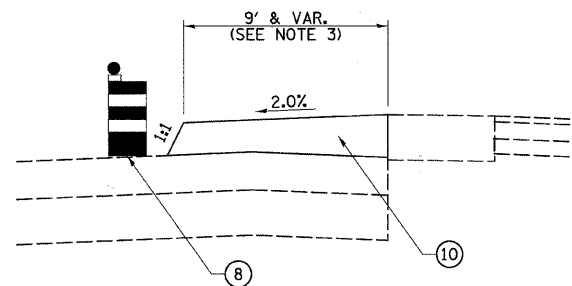

DETAIL D
 STA. 11+60.34 TO STA. 12+43.50

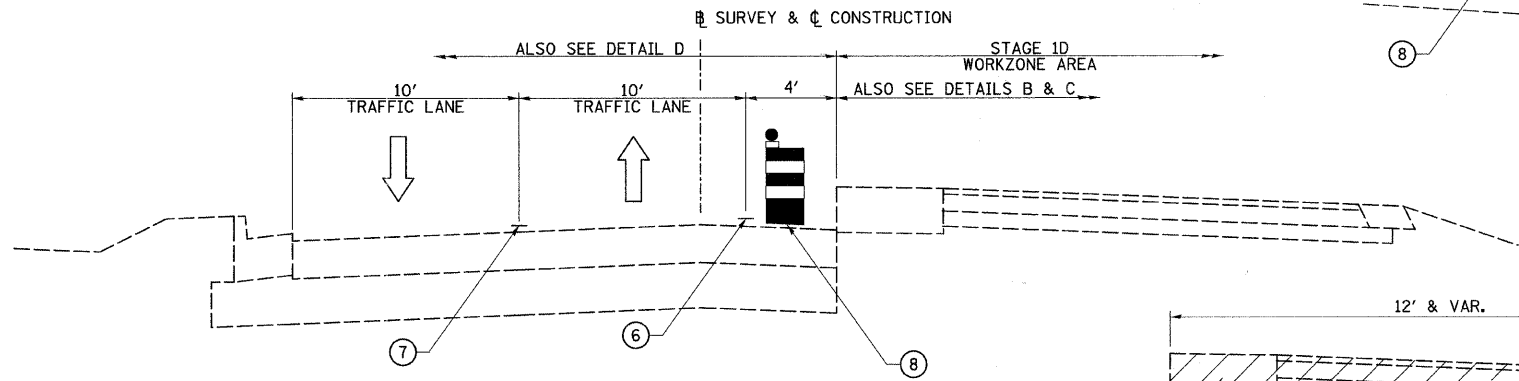

RIVER RD.
STAGE 1D
 STA. 11+05.30 TO STA. 16+44.11

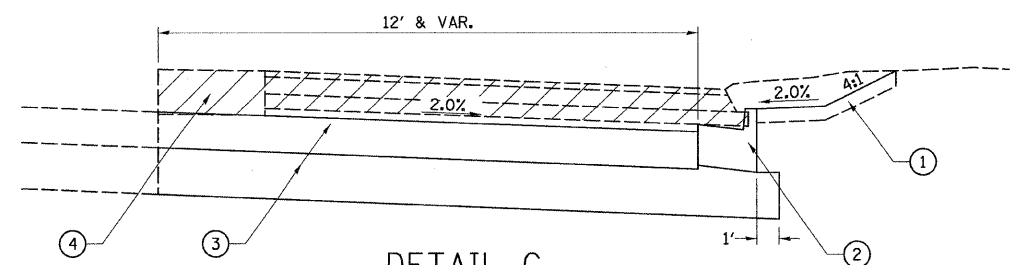

DETAIL C
 STA. 12+43.59 TO STA. 13+25.10

FILE NAME = v:\2545\2545f1d01.dgn	USER NAME = bdecrone	DESIGNED -	REVISED -	STATE OF ILLINOIS DEPARTMENT OF TRANSPORTATION	T.R. 55 (RENWICK RD.) & RIVER RD. STAGE 1D TYPICAL SECTIONS		F.A. RTE. TR 55	SECTION 90-16103-01-BR	COUNTY WILL	TOTAL SHEETS 255	SHEET NO. 63	
PLOT SCALE = 4,000' / IN.		CHECKED -	REVISED -		SCALE: 1"=4'	SHEET NO. 2 OF 4 SHEETS	STA. N/A	TO STA. N/A	CONTRACT NO. 83126			
PLOT DATE = 5/18/2011		DATE -	REVISED -		FED. ROAD DIST. NO. ILLINOIS FED. AID PROJECT							