

POINT COORDINATES															
NO.	NORTHING	EASTING	ELEVATION	NO.	NORTHING	EASTING	ELEVATION	NO.	NORTHING	EASTING	ELEVATION	NO.	NORTHING	EASTING	ELEVATION
1	9,224.01	6,431.66	595.92	19	9,436.59	6,541.14		37	9,734.66	6,725.98	595.62	55	10,054.42	7,437.38	596.43
2	9,231.60	6,424.22	596.14	20	9,413.43	6,529.92		38	9,695.89	6,732.76		56	10,038.37	7,462.25	596.25
3	9,264.41	6,390.56	597.26	21	9,394.29	6,500.03		39	9,660.76	6,735.29		57	10,022.33	7,487.11	596.54
4	9,294.65	6,368.84	598.58	22	9,371.53	6,486.95		40	9,631.57	6,730.91		58	9,996.26	7,511.90	597.45
5	9,319.24	6,373.41	598.87	23	9,348.88	6,473.38		41	9,595.92	6,734.05		59	9,953.19	7,486.55	597.15
6	9,343.75	6,378.38	599.06	24	9,325.01	6,465.48	595.92	42	9,577.41	6,717.23		60	9,943.97	7,481.14	596.89
7	9,368.19	6,383.63	599.08	25	9,299.20	6,466.58		43	9,557.73	6,701.78		61	9,934.78	7,461.39	596.62
8	9,393.40	6,385.30	599.19	26	9,272.95	6,469.73		44	9,542.15	6,681.55	595.00	62	9,925.09	7,436.31	596.56
9	9,422.12	6,370.69	601.09	27	9,249.60	6,459.39		45	9,835.23	7,210.57		63	9,926.10	7,427.59	596.09
10	9,446.47	6,376.34	600.89	28	9,228.86	6,436.93		46	9,908.54	7,236.17		64	9,919.27	7,411.26	596.48
11	9,471.15	6,380.52	601.49	29	9,582.92	6,595.69	599.28	47	9,908.73	7,236.17		65	9,912.16	7,394.28	596.48
12	9,495.57	6,385.87	601.37	30	9,614.00	6,597.87	599.80	48	9,957.39	7,261.57		66	9,904.60	7,386.14	596.95
13	9,520.11	6,390.64	601.61	31	9,641.57	6,604.14	600.17	49	9,994.98	7,286.88		67	9,893.40	7,361.05	596.92
14	9,530.97	6,459.06	599.34	32	9,660.34	6,620.65	599.48	50	10,030.71	7,312.18		68	9,883.21	7,335.96	597.08
15	9,541.36	6,529.62	600.00	33	9,677.87	6,638.61	598.89	51	10,065.40	7,337.46	595.82	69	9,886.43	7,332.83	596.15
16	9,508.48	6,563.56		34	9,696.26	6,655.57	598.48	52	10,102.55	7,362.77	595.72	70	9,877.25	7,310.91	595.55
17	9,487.37	6,542.86	595.92	35	9,715.09	6,672.01	598.33	53	10,086.51	7,387.64	596.07	71	9,866.75	7,285.83	595.47
18	9,460.93	6,546.89		36	9,724.85	6,699.10	597.51	54	10,070.46	7,412.51	596.33	72	9,856.24	7,260.74	595.90

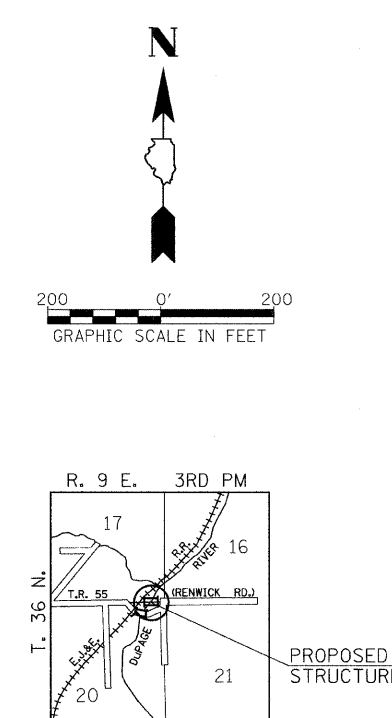
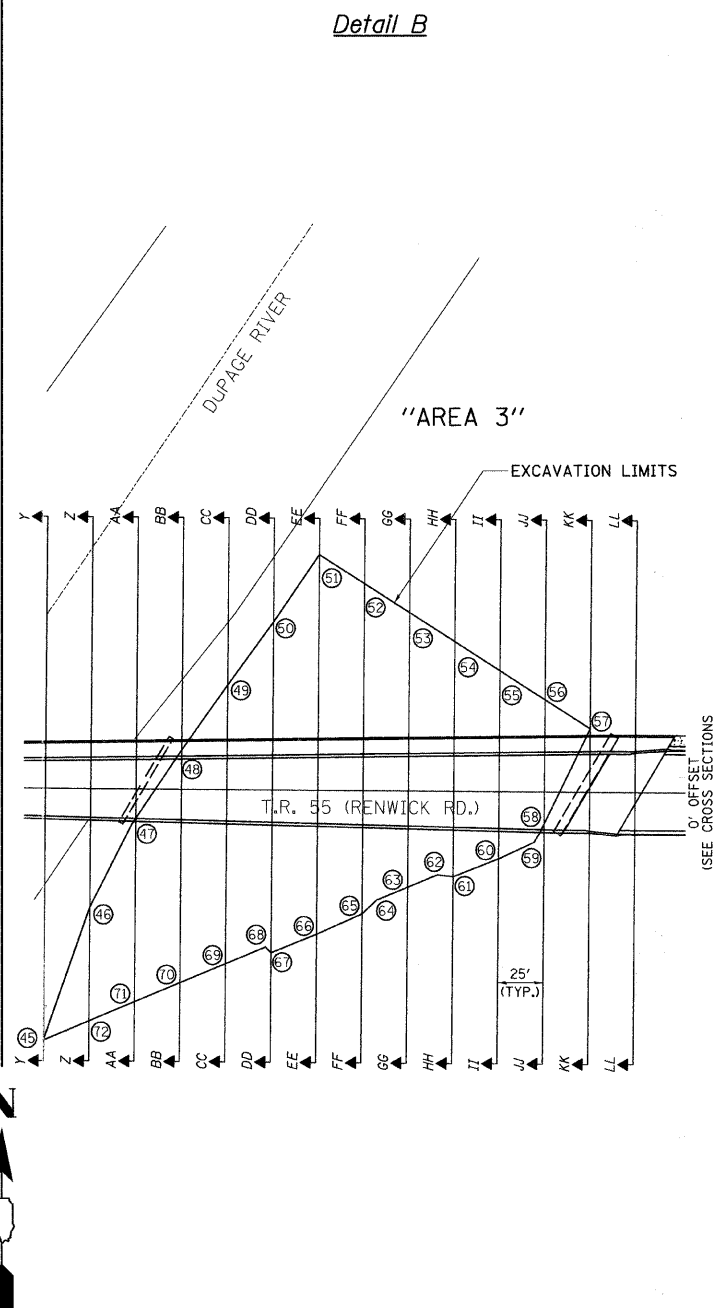
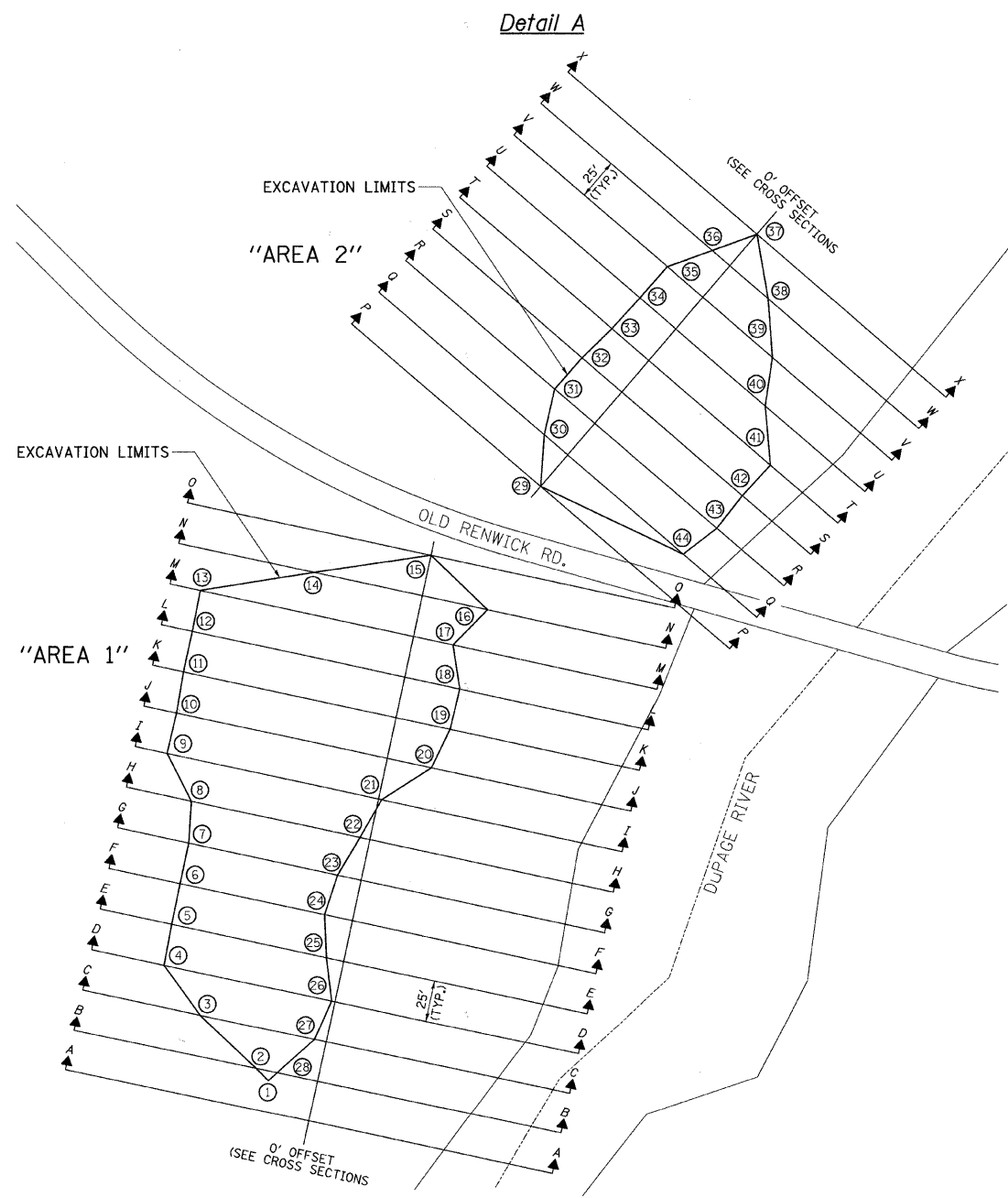
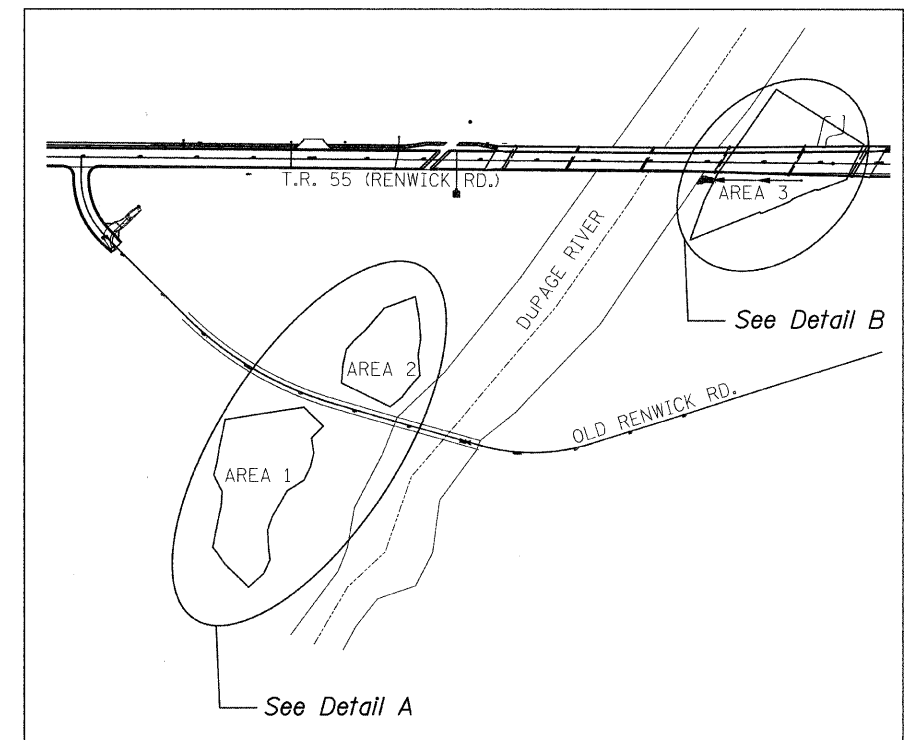

FILE NAME =	USER NAME = bdeoraene	DESIGNED -	REVISED -	STATE OF ILLINOIS DEPARTMENT OF TRANSPORTATION	T.R. 55 (RENWICK RD.) COMPENSATORY STORAGE PLAN	F.A. RTE.	SECTION	COUNTY	TOTAL SHEETS	SHEET NO.	
v:\2545\compensatory storage\for plans\2545cs01.dgn	PLOT SCALE = 20.0000' / IN.	DRAWN -	REVISED -			TR 55	90-16103-01-BR	WILL	255	130	
	PLOT DATE = 5/10/2011	CHECKED -	REVISED -			CONTRACT NO. 83126					
		DATE -	REVISED -			SCALE: 1"=100'	SHEET NO. 1 OF 12 SHEETS	STA. N/A	TO STA. N/A	FED. ROAD DIST. NO.	ILLINOIS FED. AID PROJECT