

STATION & OFFSETS TO BOTTOM FACE OF BLOCK

COURSE NO.	START STATION	OFFSET
1	26+38.86	13.56' RT
2	26+28.89	13.42' RT
3	26+26.58	13.28' RT
4	26+25.61	13.14' RT
5	26+23.30	12.99' RT

PLAN  
SCALE: 1"=5'

NOTES:  
1. SEE HANDRAIL DETAIL SHEET FOR HANDRAIL DETAILS

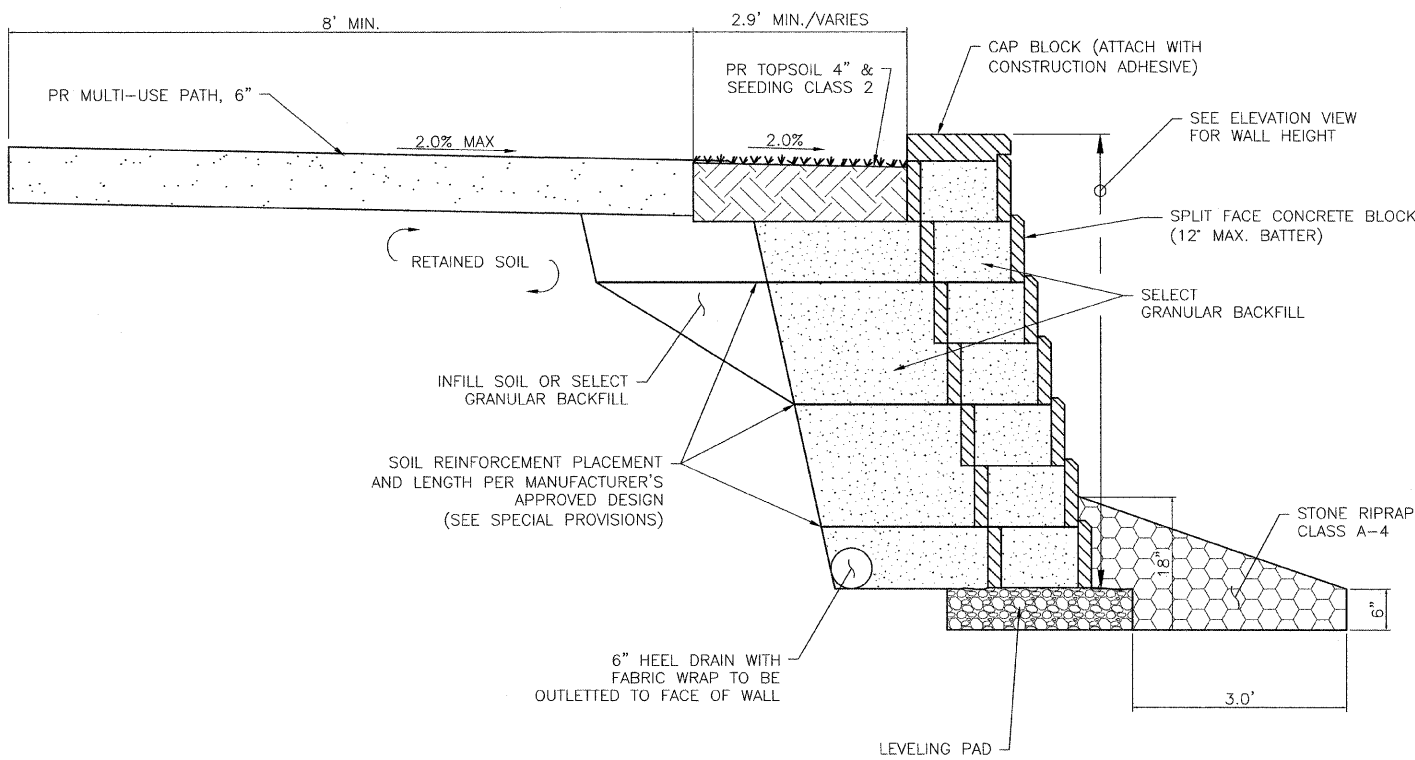

SEGMENTAL CONCRETE BLOCK WALL, DETAIL

NO SCALE  
STA. 26+23.3 RT TO STA. 26+64.2 RT

GENERAL RETAINING WALL NOTES:

- THE STATIONS, OFFSETS AND ELEVATIONS AS SHOWN IN THE DETAILS ARE BASED ON BLOCKS WITH THE FOLLOWING DIMENSIONS:  
 STANDARD BLOCK:  
 FRONT FACE WIDTH 18"  
 BACK FACE HEIGHT 8"  
 FRONT TO BACK DEPTH 12"  
 SET BACK: 12' WALL BATTER FROM VERTICAL  
 THE ACTUAL STATIONS, OFFSETS AND ELEVATIONS MAY VARY FROM THE DETAILS AT THE APPROVAL OF THE ENGINEER.
- COLOR OF MODULAR BLOCK SHALL BE "GRAY".
- ESTIMATED QUANTITIES  
 SEGMENTAL CONCRETE BLOCK WALL = 140 SQ.FT.  
 STONE RIPRAP, CLASS A-4 = 505 SQ.YD.
- SEE SPECIAL PROVISIONS FOR PAYMENT INFORMATION.
- PLACE 2 - NO. 6 REINFORCEMENT BARS HORIZONTALLY IN COURSE NO. 2 AND 4 AT CORNER OF WALL PER DETAIL. SAW CUT NOTCH IN SIDES OF BLOCK UNIT TO ALLOW FOR REBAR PLACEMENT. DO NOT REMOVE BACK OF BLOCKS. FILL CORNER OF WALL WITH CLASS SI CONCRETE.

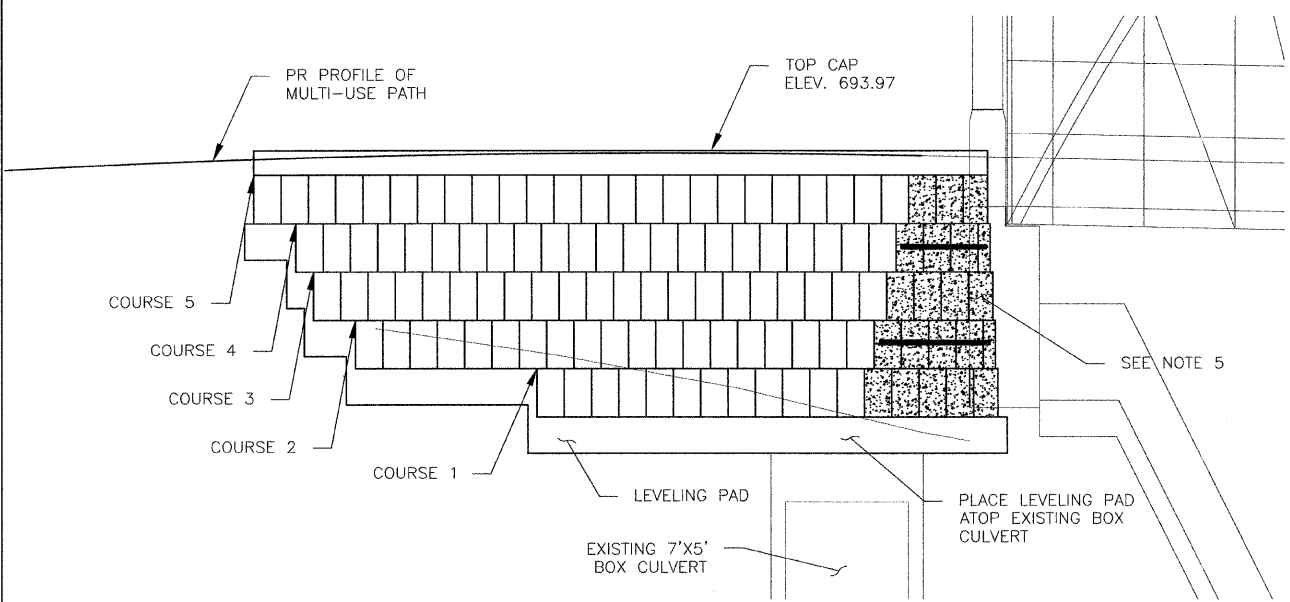

ELEVATION  
VERT - 1"=2'  
HORIZ - 1"=5'

TOP COURSE ELEVATIONS

COURSE NO.	ELEV.
1	690.97
2	691.63
3	692.30
4	692.97
5	693.64

SEGMENTAL CONCRETE BLOCK WALL  
STA. 26+23.3 RT TO STA. 26+64.2 RT.