

**EXISTING FIELD CONDITIONS**

DUE TO ONGOING UTILITY CONSTRUCTION AND OTHER BUILDING PROJECTS IN THE VICINITY OF THIS PROJECT, THE EXISTING TOPOGRAPHIC FEATURES MAY BE DIFFERENT FROM THE FEATURES SHOWN ON THE PLANS. THE ADJUSTMENT AND RECONSTRUCTION OF STRUCTURES WILL BE MEASURED TO REFLECT ACTUAL FIELD CONDITIONS. THE CONTRACTOR SHALL NOTIFY THE ENGINEER OF ANY CHANGED FIELD CONDITIONS THAT ARE DISCOVERED PRIOR TO PERFORMING WORK. NO ADDITIONAL COMPENSATION WILL BE ALLOWED DUE TO CHANGED FIELD CONDITIONS.

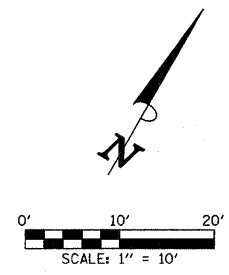

- NOTES:**
1. THE PIPE UNDERDRAIN LAYOUT AS SHOWN IS SCHEMATIC IN NATURE. PIPE UNDERDRAINS SHALL BE PLACED AS SHOWN OR AS DIRECTED BY THE ENGINEER.
  2. ALL ELEVATIONS SHALL BE VERIFIED BY THE CONTRACTOR PRIOR TO CONSTRUCTION. ANY DIFFERENCES BETWEEN THE INTENDED DESIGN AND ACTUAL FIELD CONDITIONS SHALL BE COMMUNICATED TO THE ENGINEER. NO ADDITIONAL COMPENSATION WILL BE ALLOWED AS A RESULT OF ANY DIFFERENCES DISCOVERED DURING CONSTRUCTION.
  3. THE PIPE UNDERDRAINS AND PIPE DRAINS WILL BE PAID FOR AT THE CONTRACT UNIT PRICE PER FOOT FOR PIPE UNDERDRAINS 6" AND PIPE DRAINS 6", WHICH INCLUDES ALL LABOR, EQUIPMENT, PIPE, FABRIC WRAP, TRENCHING, AND POROUS GRANULAR BACKFILL MATERIAL NEEDED TO CONSTRUCT THE PROPOSED UNDERDRAIN SYSTEM AS SHOWN ON THE PLANS OR AS DIRECTED BY THE ENGINEER.
  4. CLEANOUTS FOR THE PROPOSED PIPE UNDERDRAINS SHALL BE PROVIDED AS SHOWN IN THE PLANS OR AS DIRECTED BY THE ENGINEER. THE COST OF CONSTRUCTING THE PIPE UNDERDRAIN CLEANOUTS SHALL BE INCLUDED IN COST OF PIPE UNDERDRAINS 6" AND NO ADDITIONAL COMPENSATION WILL BE ALLOWED.
  5. APPLICABLE ARTICLES OF SECTION 601 OF THE STANDARD SPECIFICATIONS SHALL APPLY EXCEPT DELETE ALL REFERENCE TO MEASUREMENT AND PAYMENT.
  6. SEE LANDSCAPING PLANS AND SPECIAL PROVISIONS FOR ADDITIONAL INFORMATION.

**LEGEND**

- OR ● PROPOSED INLET
- ⊕ STRUCTURE NUMBER (SEE SCHEDULE)
- - - - - PIPE UNDERDRAINS 6"
- PROPOSED STORM SEWER (BY OTHERS)
- ⊙ PROPOSED CISTERN (BY OTHERS)

STR. NO.	STRUCTURE TYPE	EX. T/O FRAME & GRATE ELEV.	PR. T/O FRAME & GRATE ELEV.	INVERT IN ELEV.	U/S STR. NO.	INVERT OUT ELEV.	D/S STR. NO.
10	MANHOLE ADJUST	785.63	TBD	780.28	EAST	780.23	11
11	MANHOLE RECONSTRUCT	785.22	790.0*	780.02	10	779.97	12
				780.02	SOUTH		
12	MANHOLE ADJUST	787.39	788.5*	779.40	11	778.24	18
				778.40	SOUTH		
13	INLETS ADJ W/SPCL FG	--	788.90*	--	--	782.01*	14
				786.35*	UNDERDRAIN		
14	INLETS ADJ W/SPCL FG	--	786.68*	781.84*	13	781.74*	15
				784.15*	UNDERDRAIN		
				781.84*	BLDG. WEST		
15	INLETS ADJ W/SPCL FG	--	784.48*	781.48*	14	781.38*	16
				781.95*	UNDERDRAIN		
				781.48*	BLDG. WEST		
16	INLETS ADJ W/SPCL FG	--	784.40*	781.22*	15	781.12*	18
				781.85*	UNDERDRAIN	TBD	CISTERN
17	INLETS TA SPCL. F&G	--	785.09*	782.05*	19	781.95*	CISTERN
18	MANHOLE ADJUST	--	784.9*	777.6*	12	777.6*	20
				779.35*	16		
19	INLETS TA SPCL. F&G	--	785.41*	782.35*	UNDERDRAIN	782.25*	17
20	MANHOLE (NO WORK)	784.47	--	777.03	12	777.03	WEST
				780.56	21		
21	INLET (NO WORK)	784.42	--	--	--	781.00	20

\* FIELD VERIFY ELEVATIONS

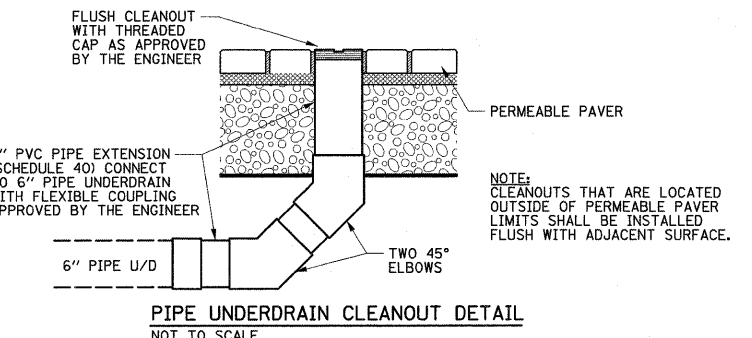
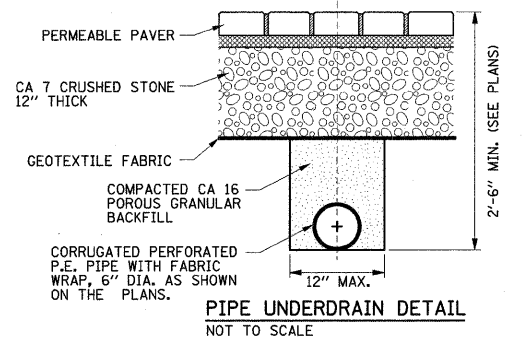
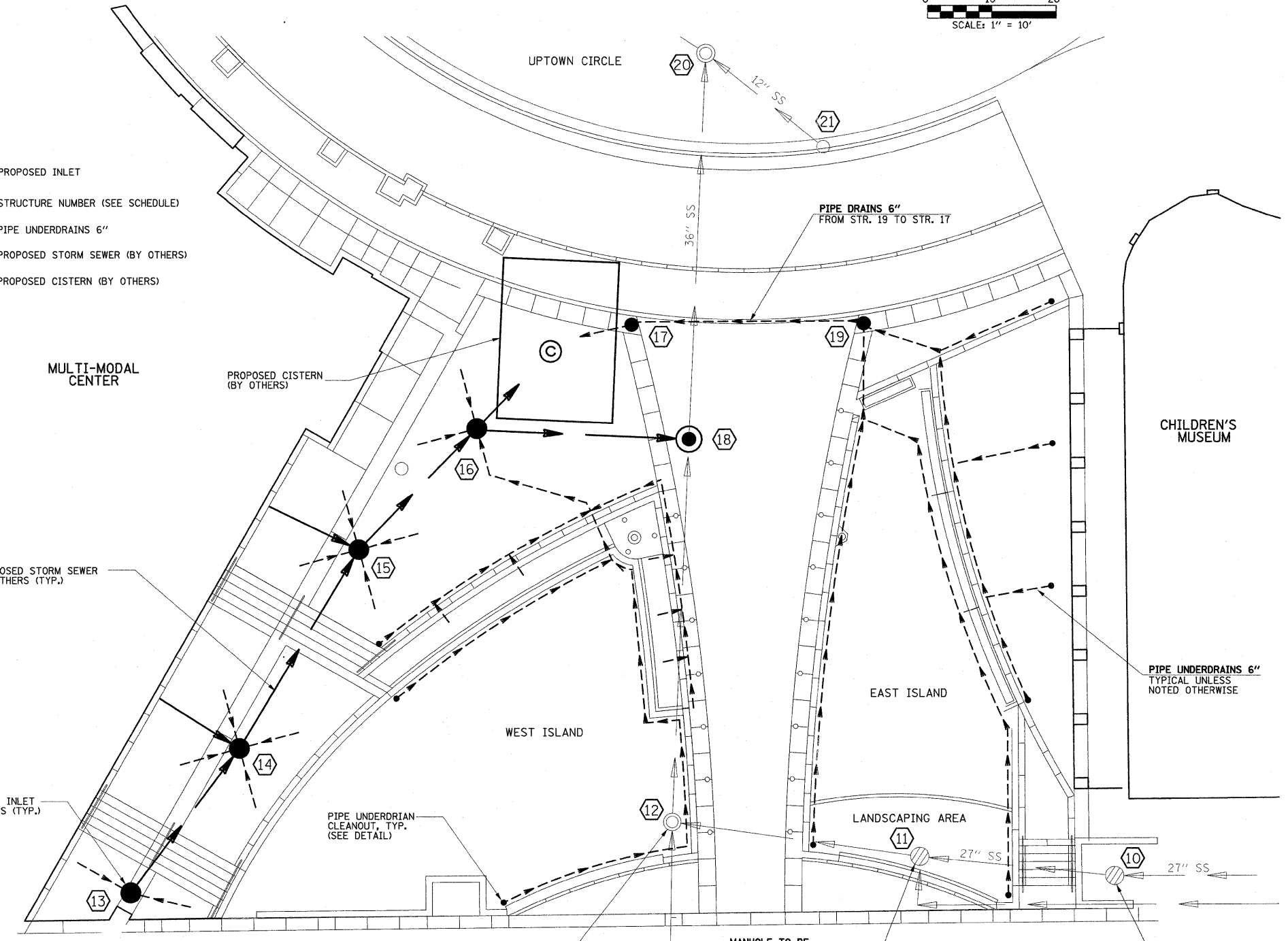

FILE NAME = p:\N0240094\Plans\sheets\ 08 DRAINAGE.dgn  
 PLOT DATE = 4/22/2011 11:15:11 AM

DESIGNED - K.L.R.	REVISED -
DRAWN - K.L.R.	REVISED -
CHECKED - S.M.W.	REVISED -
DATE - 4-11	REVISED -

STATE OF ILLINOIS  
 DEPARTMENT OF TRANSPORTATION

**DRAINAGE PLAN**  
 SCALE: 1"=10' SHEET NO. 10 OF 40 SHEETS STA. TO STA.

F.A.U. RTE.	SECTION	COUNTY	TOTAL SHEETS	SHEET NO.
	10-00243-02-LS	MCLEAN	40	10
CONTRACT NO. 91461				
FED. ROAD DIST. NO.	ILLINOIS	FED. AID PROJECT		