

INDEX OF SHEETS

- 1 COVER SHEET
- 2 SUMMARY OF QUANTITIES, GENERAL NOTES, AND TYPICAL SECTIONS
- 3 PLAN AND PROFILE
- 4 HORIZONTAL LAYOUT
- 5-10 STATION CROSS SECTIONS
- 11 STORM WATER POLLUTION PREVENTION AND EROSION CONTROL PLAN
- 12-21 BRIDGE PLANS

LIST OF STANDARDS

- STANDARD 000001-06 STANDARD SYMBOLS, ABBREVIATIONS AND PATTERNS
- STANDARD 280001-05 TEMPORARY EROSION CONTROL SYSTEMS
- STANDARD 515001-03 NAME PLATE FOR BRIDGES
- STANDARD 606001-04 CONCRETE CURB TYPE B AND COMBINATION CONCRETE CURB AND GUTTER
- STANDARD 630301-05 SHOULDER WIDENING FOR TYPE 1 (SPECIAL) GUARDRAIL TERMINALS
- STANDARD 631026-05 TRAFFIC BARRIER TERMINAL TYPE 5
- STANDARD 631031-09 TRAFFIC BARRIER TERMINAL TYPE 6
- STANDARD 635006-03 REFLECTIVE AND TERMINAL MARKER PLACEMENT
- STANDARD 701901-01 TRAFFIC CONTROL DEVICES
- STANDARD BLR-21-8 TYPICAL APPLICATION OF TRAFFIC CONTROL DEVICES FOR CONSTRUCTION ON RURAL LOCAL HIGHWAYS

STATE OF ILLINOIS  
DEPARTMENT OF TRANSPORTATION  
DIVISION OF HIGHWAYS  
**PLANS FOR PROPOSED  
LOCAL AGENCY IMPROVEMENT**

ROUTE NO.	SECTION	COUNTY	TOTAL SHEETS	SHEET NO.
C.H. 7	05-00204-00-BR	MACON	21	1
FED. ROAD DIST. NO.		ILLINOIS PROJECT:		

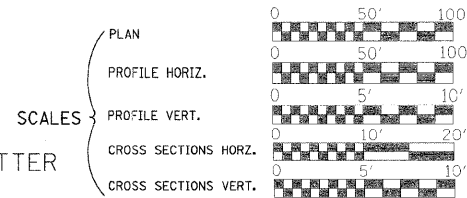

HIGHWAY BRIDGE PROGRAM  
F.A.U. 7449, C.H. 7  
(BALTIMORE AVE.) OVER BIG CREEK  
SECTION 05-00204-00-BR  
MACON COUNTY  
CONTRACT NO. 95658  
PROJ. #BRS-0115(067)

ROADWAY CLASSIFICATION: MINOR ARTERIAL (URBAN)  
2030 ADT = 8600  
DESIGN SPEED: 40 MPH  
DESIGN GUIDELINES: SUBURBAN  
VARIANCES GRANTED:  
COMMITMENTS: NONE

JOINT UTILITY LOCATING INFORMATION FOR EXCAVATORS  
J.U.L.I.E. TELEPHONE NO. TOLL FREE 1-800-892-0123

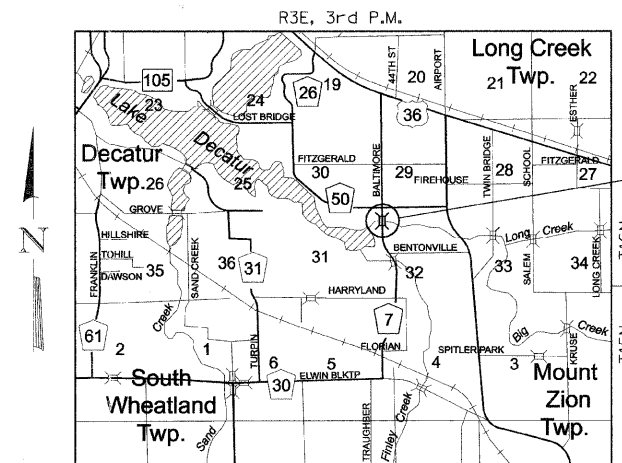
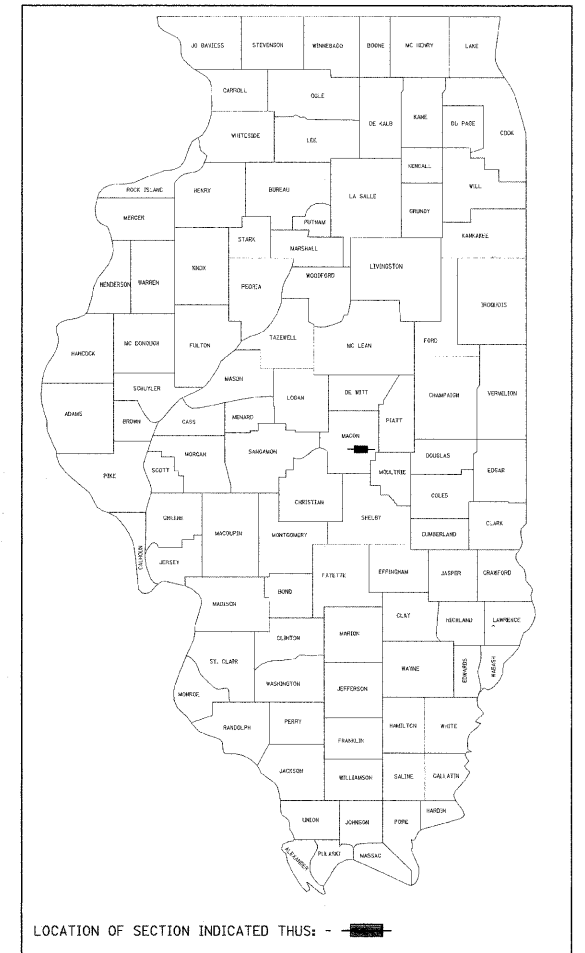

PROJECT LOCATION  
IMPROVEMENT BEGINS  
STA. 12+33.78  
IMPROVEMENT ENDS  
STA. 23+17.15

EXIST. STR. NO. 058-6007  
PROP. STR. NO. 058-6024

IMPROVEMENT CONSISTS OF THE REMOVAL OF A THREE SPAN CONCRETE DECK BEAM BRIDGE ON PILE BENT ABUTMENTS AND PIERS WITH CONCRETE SLOPE WALLS, 0-0 DECK = 28'-0", BK.-BK. ABUTMENTS = 117'-6" AND THE CONSTRUCTION OF A THREE SPAN PRECAST PRESTRESSED CONCRETE DECK BEAM BRIDGE ON CONCRETE SPILL THRU ABUTMENTS AND CONCRETE PILE BENT PIERS. TOTAL LENGTH = 150'-11", WIDTH = 48'-0" O.-O. DECK AND NECESSARY APPROACH ROADWAY WORK.

LAYOUT

APPROXIMATE SCALE scale miles

TOTAL AND NET LENGTH OF IMPROVEMENT 1083.37 FEET = 0.205 MILES



345 EAST ASH AVENUE, SUITE B  
DECATUR, ILLINOIS 62526  
PH. 217-875-4800



*Keith W. Besting*  
ILLINOIS PROFESSIONAL NO. 43789

APPROVED April 13, 2011  
*Chris A. S.* COUNTY ENGINEER

PASSED 4-20 2011  
*Maureen K. [Signature]* DISTRICT SEVEN ENGINEER OF LOCAL ROADS & STREETS

RELEASING FOR BID BASED ON LIMITED REVIEW 4-20 2011  
*Roger L. [Signature]* DEPUTY DIRECTOR OF HIGHWAYS, REGION FOUR ENGINEER

STATE OF ILLINOIS  
DEPARTMENT OF TRANSPORTATION

4/13/2011  
DATE