

STATE OF ILLINOIS
DEPARTMENT OF TRANSPORTATION

F.A.I. RTE.	SECTION	COUNTY	TOTAL SHEETS	SHEET NO.
72/172	D6 PATCHING 2022-3	ADAMS/PIKE	6	1
		ILLINOIS	CONTRACT NO. 72205	

FOR INDEX OF SHEETS, SEE SHEET NO. 2

PROPOSED
HIGHWAY PLANS

FAI ROUTE I 72, 172 (I 72, I 172, IL 110)
SECTION D6 PATCHING 2022-3

PAVEMENT PATCHING
ADAMS/PIKE COUNTY

C-96-077-22

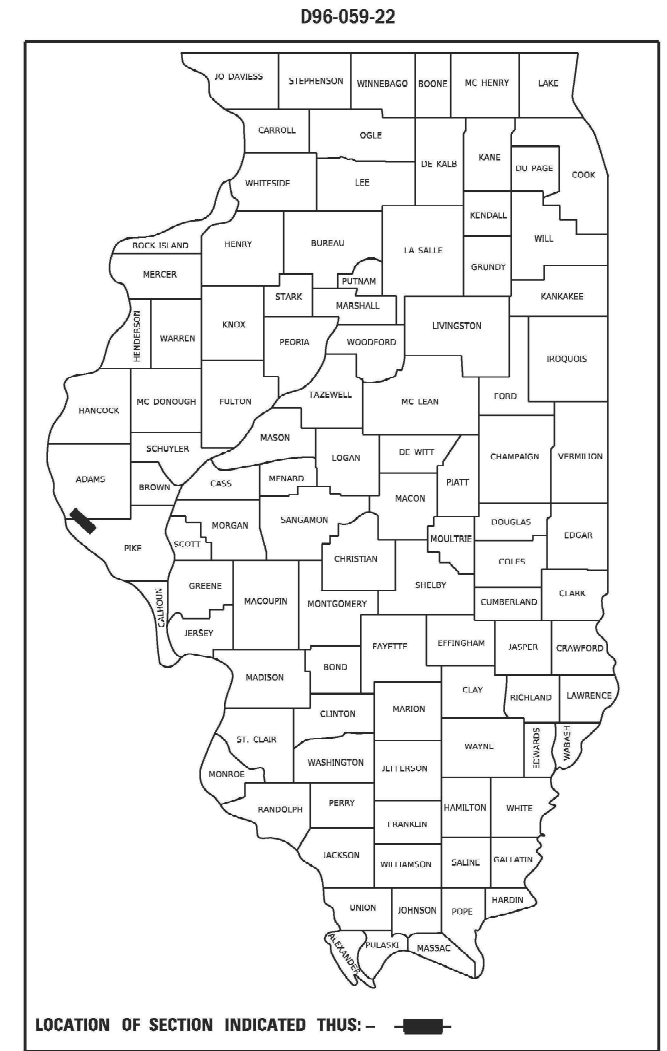

ADT = 7,600
SU = 250
MU = 1,550

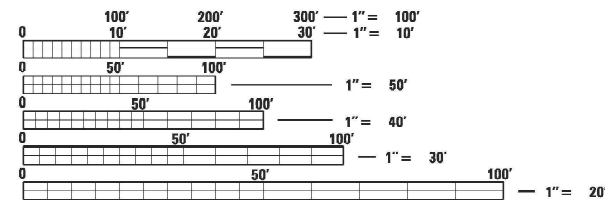

FULL SIZE PLANS HAVE BEEN PREPARED USING STANDARD ENGINEERING SCALES. REDUCED SIZED PLANS WILL NOT CONFORM TO STANDARD SCALES. IN MAKING MEASUREMENTS ON REDUCED PLANS, THE ABOVE SCALES MAY BE USED.

J.U.L.I.E.
JOINT UTILITY LOCATION INFORMATION FOR EXCAVATORS
1-800-892-0123
OR 811

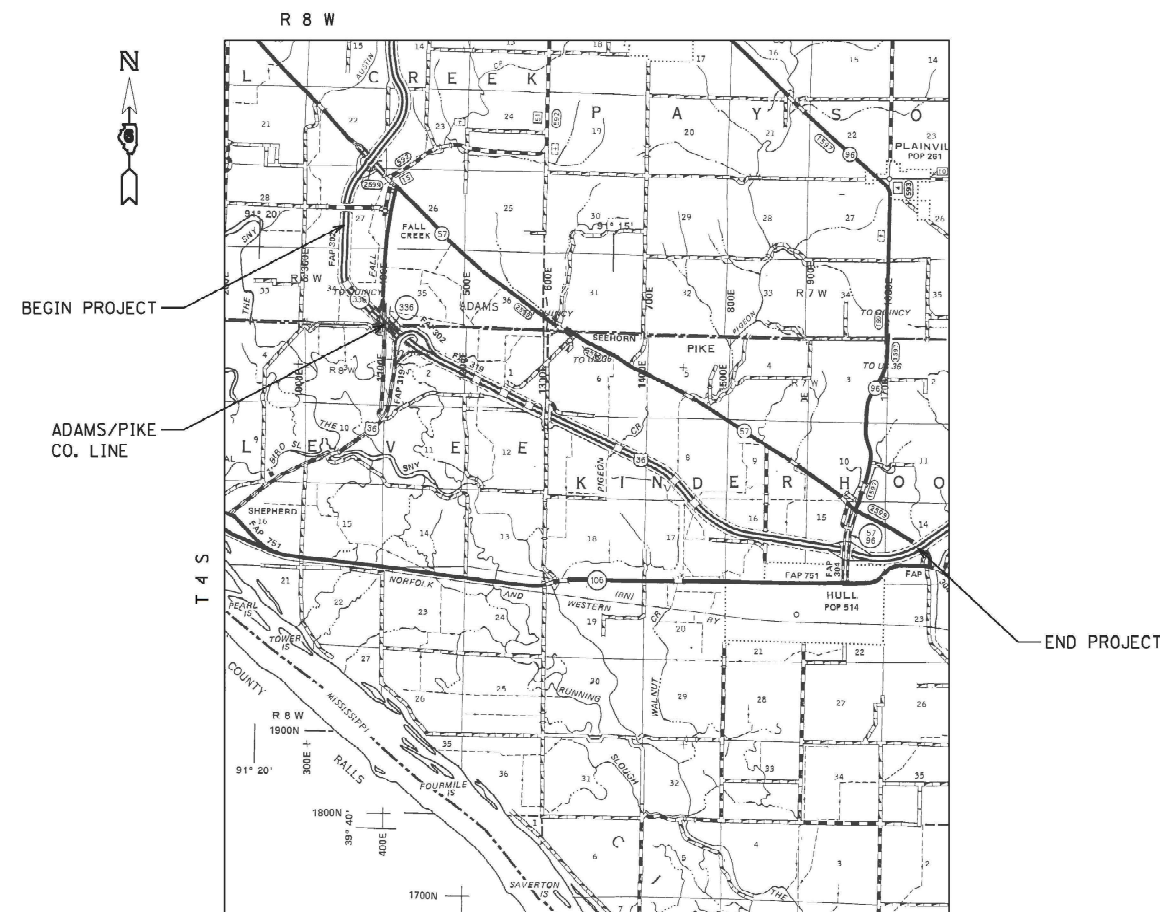

GROSS LENGTH = 46,411.20 FT. = 8.790 MILE
NET LENGTH = 46,411.20 FT. = 8.790 MILE

PROJECT ENGINEER: MIKE HAMBY (217)524-7765
PROJECT MANAGER TIM SHARP (217)524-9160

CONTRACT NO. 72205

STATE OF ILLINOIS
DEPARTMENT OF TRANSPORTATION

SUBMITTED May 11 20 22

John P. Meyer
REGIONAL ENGINEER

July 1, 2022 *Scott A. Etkin*
ENGINEER OF DESIGN AND ENVIRONMENT

July 1, 2022 *Stephen M. Smith*
DIRECTOR OF HIGHWAYS PROJECT IMPLEMENTATION



PRINTED BY THE AUTHORITY
OF THE STATE OF ILLINOIS

INDEX OF SHEETS

SHEET NO.	DESCRIPTION
1.	COVER SHEET
2.	INDEX OF SHEETS, STANDARDS, GENERAL NOTES & SIGNATURE
3.	SUMMARY OF QUANTITIES
4.	PATCHING SCHEDULE
5.	PROJECT LOCATION MAP
6.	PROJECT TYPICAL SECTIONS

STANDARDS

STANDARD NO.	DESCRIPTION
442001-04	CLASS A PATCHES
701101-05	OFF-RD OPERATIONS, MULTILANE, 15' TO 24" FROM EDGE OF PAVEMENT
701106-02	OFF-RD OPERATIONS, MULTILANE, MORE THAN 15" AWAY
701400-11	APPROACH TO LANE CLOSURE, FREEWAY/EXPRESSWAY
701401-13	LANE CLOSURE, FREEWAY/EXPRESSWAY
701411-09	LANE CLOSURE, MULTILANE AT ENTRANCE OR EXIT RAMP FOR SPEEDS \geq 45 MPH
701456-05	PARTIAL EXIT RAMP CLOSURE FREEWAY/EXPRESSWAY
701901-08	TRAFFIC CONTROL DEVICES
000001-08	STANDARD SYMBOLS, ABBREVIATIONS AND PATTERNS
001006	DECIMAL OF AN INCH AND OF A FOOT
420001-10	PAVEMENT JOINTS

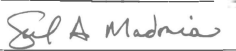
STATE OF ILLINOIS DEPARTMENT OF TRANSPORTATION DIVISION OF HIGHWAYS DISTRICT 6	
EXAMINED	April 10 20 22
	
ENGINEER OF OPERATIONS	
EXAMINED	April 10 20 22
	
ENGINEER OF PROJECT IMPLEMENTATION	
EXAMINED	April 10 20 22
	
ENGINEER OF PROGRAM DEVELOPMENT	

REV. - MS

FILE NAME =	USER NAME = sherpdt	DESIGNED -	REVISED -	STATE OF ILLINOIS DEPARTMENT OF TRANSPORTATION	INDEX OF SHEETS, STANDARDS GENERAL NOTES, SIGNATURES	F.A.I. RTE.:	SECTION	COUNTY	TOTAL SHEETS	SHEET NO.
S:\CONTRACTS\CAD\72205 - FAI 72.172 0	Z:\721 - CLASS A PATCHES - Adams-Pike Co. (8-9	DRAWN - DMS	REVISED -			72/172	D6 PATCHING 2022-3	ADAMS/PIKE	6	2
Default	PLOT SCALE = 80.0000' / in.	CHECKED -	REVISED -			ILLINOIS FED. AID PROJECT		CONTRACT NO. 72205		
	PLOT DATE = 5/11/2022	DATE -	REVISED -		SCALE: _____	SHEET _____ OF _____ SHEETS STA. _____ TO STA. _____				

CODE NO.	ITEM	UNIT	TOTAL QUANTITY	0-02177-6014	0-02177-6014
				100% STATE ADAMS	100% STATE PIKE
				ROADWAY 0006	ROADWAY 0006
				RURAL	RURAL
44200537	CLASS A PATCHES, TYPE I, 9 INCH	SQ YD	46	5	41
44200541	CLASS A PATCHES, TYPE II, 9 INCH	SQ YD	423	0	423
44200545	CLASS A PATCHES, TYPE III, 9 INCH	SQ YD	99	0	99
44200547	CLASS A PATCHES, TYPE IV, 9 INCH	SQ YD	153	0	153
44213000	PATCHING REINFORCEMENT	SQ YD	721	5	716
44213200	SAW CUTS	FOOT	3,994	38	3,956
44213204	TIE BARS 3/4"	EACH	61	0	61
67100100	MOBILIZATION	L SUM	1	0.1	0.9
70100420	TRAFFIC CONTROL AND PROTECTION, STANDARD 701411	EACH	8	0	8
70100800	TRAFFIC OCONTROL AND PROTECTION, STANDARD 701401	L SUM	1	0.1	0.9
70100825	TRAFFIC OCONTROL AND PROTECTION, STANDARD 701456	L SUM	1	0.1	0.9
70107025	CHANGEABLE MESSAGE SIGN	CAL DAY	30	1	29

MODEL: D:\msh\11\CONTRACT\MNT_CAD\72205 - FAI 72_172 (I 72,172) - CLASS A PATCHES - Adams\Pike Co. (8-05-2022)\PLANS\72205-INT-3-500.dgn
 FILE NAME: S:\CONTRACT\MNT_CAD\72205 - FAI 72_172 (I 72,172) - CLASS A PATCHES - Adams\Pike Co. (8-05-2022)\PLANS\72205-INT-3-500.dgn

USER NAME = sharptd	DESIGNED - _____	REVISED - _____
PLOT SCALE = 2.0000' / in.	CHECKED - _____	REVISED - _____
PLOT DATE = 5/11/2022	DATE - _____	REVISED - _____

**STATE OF ILLINOIS
DEPARTMENT OF TRANSPORTATION**

SUMMARY OF QUANTITIES

SCALE: _____ SHEET ___ OF ___ SHEETS STA. _____ TO STA. _____

F.A.I. RTE.	SECTION	COUNTY	TOTAL SHEETS	SHEET NO.
72/172	D6 PATCHING 2022-3	ADAMS/PIKE	6	3
CONTRACT NO. 72205				
ILLINOIS FED. AID PROJECT				

MODEL: D:\m\h\...
 FILE NAME: S:\CONTRACTS\CAD\72205 - FAI 72_172 (I 72,172) - CLASS A PATCHES - Adams-Pike Co. (8-05-2022)\PLANS\72205-SH-A-Section1.dwg

STATION	LANE	LENGTH	WIDTH	SQ.YD.	CLASS A, TY I, 9 INCH	CLASS A, TY II, 9 INCH	CLASS A, TY III, 9 INCH	CLASS A, TY IV, 9 INCH	PAVEMENT REINF.	SAW CUTS	TIE BARS 3/4"
					SQ. YD.	SQ. YD.	SQ. YD.	SQ. YD.	SQ. YD.	FOOT	EACH
1392+50	WBPL	7.00	12.00	9.33	--	9.3	--	--	9.3	62	--
1392+43	WBDL	7.00	6.00	4.67	4.7	--	--	--	4.7	38	--
1392+50	WBDL	6.00	12.00	8.00	--	8.0	--	--	8.0	60	--
1387+93	WBDL	10.00	12.00	13.33	--	13.3	--	--	13.3	68	--
1387+46	WBDL	6.00	12.00	8.00	--	8.0	--	--	8.0	60	--
1348+74	WBPL	6.00	12.00	8.00	--	8.0	--	--	8.0	60	--
1334+42	WBPL	6.00	12.00	8.00	--	8.0	--	--	8.0	60	--
1245+20	WBDL	6.00	12.00	8.00	--	8.0	--	--	8.0	60	--
1237+60	WBPL	7.00	12.00	9.33	--	9.3	--	--	9.3	62	--
1224+75	WBDL	6.00	12.00	8.00	--	8.0	--	--	8.0	60	--
1195+56	WBDL	8.00	12.00	10.67	--	10.7	--	--	10.7	64	--
1193+30	WBDL	9.00	12.00	12.00	--	12.0	--	--	12.0	66	--
1104+21	WBDL	10.00	6.00	6.67	--	6.7	--	--	6.7	44	--
1087+06	RAMP	8.00	6.00	5.33	--	5.3	--	--	5.3	40	--
1086+55	RAMP	6.00	6.00	4.00	4.0	--	--	--	4.0	36	--
1073+15	WBDL	12.00	6.00	8.00	--	8.0	--	--	8.0	48	--
1070+42	WBDL	10.00	6.00	6.67	--	6.7	--	--	6.7	44	--
1057+50	RAMP	6.00	12.00	8.00	--	8.0	--	--	8.0	60	--
1056+75	RAMP	15.00	12.00	20.00	--	--	20.0	--	20.0	78	--
1055+75	RAMP	48.00	6.00	32.00	--	--	--	32.0	32.0	120	15
1055+67	RAMP	10.00	12.00	13.33	--	13.3	--	--	13.3	68	--
1054+67	RAMP	22.00	6.00	14.67	--	14.7	--	--	14.7	68	7
1054+59	RAMP	12.00	6.00	8.00	--	8.0	--	--	8.0	48	--
1054+47	RAMP	62.00	6.00	41.33	--	--	--	41.3	41.3	148	20
1042+65	WBDL	30.00	12.00	40.00	--	--	--	40.0	40.0	108	9
1042+65	WBPL	30.00	12.00	40.00	--	--	--	40.0	40.0	108	9
1015+02	WBDL	10.00	6.00	6.67	--	6.7	--	--	6.7	44	--
1006+11	WBDL	7.00	6.00	4.67	4.7	--	--	--	4.7	38	--
933+65	WBDL	7.00	6.00	4.67	4.7	--	--	--	4.7	38	--
WESTBOUND TOTALS					18.0	180.0	20.0	153.3	371.3	1858	61

ADAMS/PIKE CO. LIN STATIONING 99+99.80

STATION	LANE	LENGTH	WIDTH	SQ.YD.	CLASS A, TY I, 9 INCH	CLASS A, TY II, 9 INCH	CLASS A, TY III, 9 INCH	CLASS A, TY IV, 9 INCH	PAVEMENT REINF.	SAW CUTS	TIE BARS 3/4"
					SQ. YD.	SQ. YD.	SQ. YD.	SQ. YD.	SQ. YD.	FOOT	EACH
1051+87	RAMP	7.00	7.50	5.83	--	5.8	--	--	5.8	44	--
1064+47	EBDL	6.00	12.00	8.00	--	8.0	--	--	8.0	60	--
1064+40	EBDL	6.00	12.00	8.00	--	8.0	--	--	8.0	60	--
1071+12	EBDL	16.00	6.00	10.67	--	10.7	--	--	10.7	56	--
1071+12	EBPL	16.00	6.00	10.67	--	10.7	--	--	10.7	56	--
1078+75	EBDL	6.00	12.00	8.00	--	8.0	--	--	8.0	60	--
1079+23	EBDL	8.00	12.00	10.67	--	10.7	--	--	10.7	64	--
1083+10	EBDL	6.00	12.00	8.00	--	8.0	--	--	8.0	60	--
1089+51	EBDL	16.00	12.00	21.33	--	--	21.3	--	21.3	80	--
1091+85	EBDL	10.00	12.00	13.33	--	13.3	--	--	13.3	68	--
1100+63	EBDL	6.00	12.00	8.00	--	8.0	--	--	8.0	60	--
1100+75	EBDL	6.00	12.00	8.00	--	8.0	--	--	8.0	60	--
1102+50	EBDL	17.00	12.00	22.67	--	--	22.7	--	22.7	82	--
1103+38	EBDL	6.00	6.00	4.00	4.0	--	--	--	4.0	36	--
1109+57	EBDL	8.00	12.00	10.67	--	10.7	--	--	10.7	64	--
1115+48	EBDL	6.00	12.00	8.00	--	8.0	--	--	8.0	60	--
1151+64	EBDL	6.00	12.00	8.00	--	8.0	--	--	8.0	60	--
1163+25	EBDL	6.00	12.00	8.00	--	8.0	--	--	8.0	60	--
1163+87	EBDL	10.00	12.00	13.33	--	13.3	--	--	13.3	68	--
1167+13	EBDL	8.00	6.00	5.33	--	5.3	--	--	5.3	40	--
1168+08	EBDL	6.00	6.00	4.00	4.0	--	--	--	4.0	36	--
1202+90	EBDL	10.00	12.00	13.33	--	13.3	--	--	13.3	68	--
1206+10	EBDL	6.00	12.00	8.00	--	8.0	--	--	8.0	60	--
1208+34	EBDL	8.00	12.00	10.67	--	10.7	--	--	10.7	64	--
1236+18	EBDL	6.00	6.00	4.00	4.0	--	--	--	4.0	36	--
1242+50	EBDL	6.00	12.00	8.00	--	8.0	--	--	8.0	60	--
1244+94	EBDL	8.00	12.00	10.67	--	10.7	--	--	10.7	64	--
1254+61	EBDL	6.00	6.00	4.00	4.0	--	--	--	4.0	36	--
1255+07	EBDL	6.00	11.00	7.33	--	7.3	--	--	7.3	56	--
1256+21	EBDL	13.00	12.00	17.33	--	--	17.3	--	17.3	74	--
1263+29	EBDL	6.00	6.00	4.00	4.0	--	--	--	4.0	36	--
1277+74	EBDL	6.00	6.00	4.00	4.0	--	--	--	4.0	36	--
1335+43	EBDL	13.00	12.00	17.33	--	--	17.3	--	17.3	74	--
1335+43	EBPL	7.00	12.00	9.33	--	9.3	--	--	9.3	62	--
1343+68	EBDL	9.00	6.00	6.00	--	6.0	--	--	6.0	42	--
1367+36	EBDL	6.00	6.00	4.00	4.0	--	--	--	4.0	36	--
1383+81	EBDL	8.00	6.00	5.33	--	5.3	--	--	5.3	40	--
1385+59	EBDL	17.00	6.00	11.33	--	11.3	--	--	11.3	58	--
EASTBOUND TOTALS					28.0	242.5	78.7	0.0	349.2	2136	0
TOTALS					46.0	422.5	98.7	153.3	720.5	3994	61

USER NAME = sharptd	DESIGNED - _____	REVISED - _____
PLOT SCALE = 2.0000' / in.	DRAWN - _____	REVISED - _____
PLOT DATE = 5/11/2022	CHECKED - _____	REVISED - _____
	DATE - _____	REVISED - _____

**STATE OF ILLINOIS
DEPARTMENT OF TRANSPORTATION**

SCHEDULES

SCALE: _____ SHEET ____ OF ____ SHEETS STA. _____ TO STA. _____

F.A.I. RTE.	SECTION	COUNTY	TOTAL SHEETS	SHEET NO.
72/172	D6 PATCHING 2022-3	ADAMS/PIKE	6	4
CONTRACT NO. 72205				
ILLINOIS FED. AID PROJECT				

BEGIN PROJECT

ADAMS/PIKE
CO. LINE
STA. 999+99.80

END PROJECT



MODEL: Default
 FILE NAME: S:\CONTRACT\CA072205 - FAI 72 - 172 (I 72,172) - CLASS A PATCHES - Adams/Pike Co. (8-05-2022)\PLANS\72205-1H-5-plans.dgn

USER NAME = sharptd	DESIGNED - _____	REVISED - _____
DRAWN - _____	REVISIONS - _____	REVISIONS - _____
PLOT SCALE = 2,000' / in.	CHECKED - _____	REVISIONS - _____
PLOT DATE = 5/11/2022	DATE - _____	REVISIONS - _____

**STATE OF ILLINOIS
DEPARTMENT OF TRANSPORTATION**

PLAN

SCALE: _____ SHEET ____ OF ____ SHEETS STA. _____ TO STA. _____

F.A.I. RTE.	SECTION	COUNTY	TOTAL SHEETS	SHEET NO.
72/172	D6 PATCHING 2022-3	ADAMS/PIKE	6	5
ILLINOIS FED. AID PROJECT			CONTRACT NO. 72205	

MODEL: D:\p1\h\1\1\CONTRACT\MAIN\CAD\72205 - FAI 72_172 (I 72,172) - CLASS A PATCHES - Adams-Pike Co. (8-05-2022)\PLANS\72205-sh-6-typical.dgn
 FILE NAME: S:\CONTRACT\MAIN\CAD\72205 - FAI 72_172 (I 72,172) - CLASS A PATCHES - Adams-Pike Co. (8-05-2022)\PLANS\72205-sh-6-typical.dgn

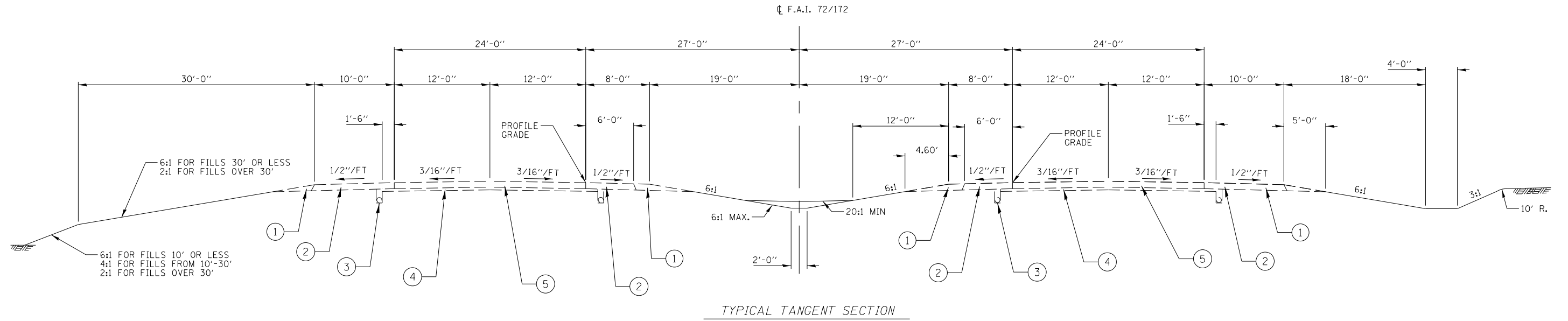

LEGEND

- ① EXISTING AGG. SHOULDER, TY B
- ② EXISTING BIT. SHOULDERS 9"
- ③ EXISTING PIPE UNDERDRAIN, 4"
- ④ EXISTING STABILIZED SUB-BASE, 4"
- ⑤ EXISTING C.R.P.C CONCRETE PAVEMENT, 9"

USER NAME = sharptd	DESIGNED - _____	REVISED - _____
	DRAWN - _____	REVISED - _____
PLOT SCALE = 2.0000' / in.	CHECKED - _____	REVISED - _____
PLOT DATE = 5/11/2022	DATE - _____	REVISED - _____

STATE OF ILLINOIS
DEPARTMENT OF TRANSPORTATION

TYPICALS	
SCALE: _____	SHEET ___ OF ___ SHEETS STA. _____ TO STA. _____

F.A.I. RTE.	SECTION	COUNTY	TOTAL SHEETS	SHEET NO.
72/172	D6 PATCHING 2022-3	ADAMS/PIKE	6	6
CONTRACT NO. 72205			ILLINOIS FED. AID PROJECT	