

**LEGEND**  
 [Solid Line] PROPOSED SIGN  
 [Dashed Line] EXISTING SIGN  
 [Arrow] DIRECTION OF TRAVEL

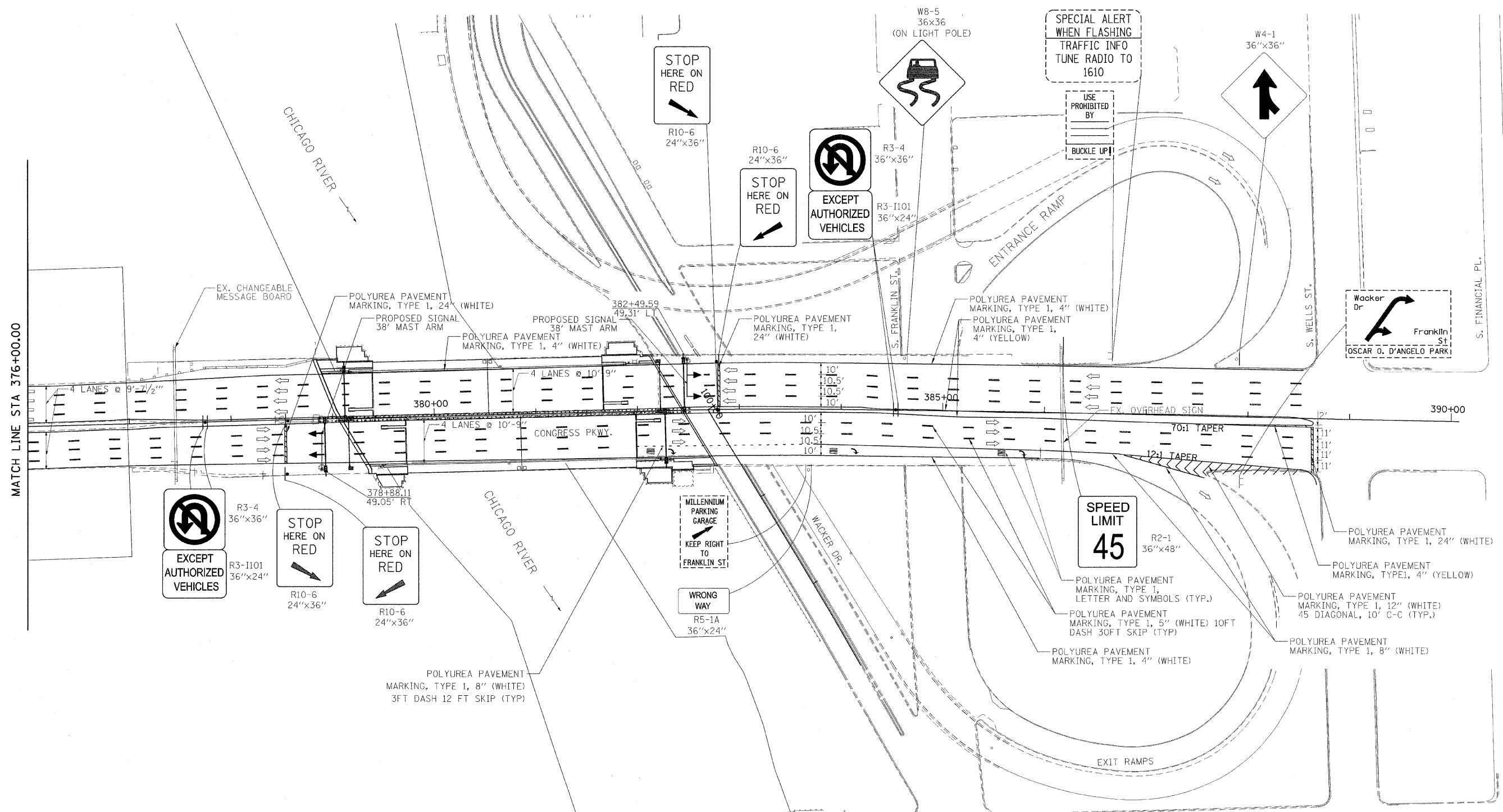
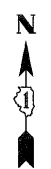

**PB Americas, Inc.**  
 230 WEST MONROE STREET,  
 SUITE 900  
 CHICAGO, IL. 60606

USER NAME = #USER#	DESIGNED - RT	REVISED -
FILE NAME = #FILENAME#	DRAWN - MS	REVISED -
PLOT SCALE = #SCALE#	CHECKED - DS	REVISED -
PLOT DATE = 5/7/2009	DATE - 5/08/09	REVISED -

**STATE OF ILLINOIS**  
**DEPARTMENT OF TRANSPORTATION**

**CONGRESS PARKWAY OVER SOUTH BRANCH OF THE CHICAGO RIVER**  
**PAVEMENT MARKING AND SIGNING PLAN**

SCALE: 1" = 50'    SHEET NO. 62 OF 83 SHEETS    STA. 377+01.00 TO STA. 382+45.28

F.A.P. R.T.E.	SECTION	COUNTY	TOTAL SHEETS	SHEET NO.
389	2424-2B-R	COOK	398	62
CONTRACT NO. 60D61				
FED. ROAD DIST. NO. 1 (ILLINOIS) FED. AID PROJECT				