

STATE OF ILLINOIS
DEPARTMENT OF TRANSPORTATION

B.M. (CDOT Wacker Drive Rehabilitation Survey Marker #1), Elev. 17.655' 3" brass disk set in sidewalk on the southerly side of Harrison Street, 3.6' southerly of the northerly back of curb, 3.1' northerly of the southerly back of curb, 15.5' easterly of the westerly traffic signal, 33.4' easterly of a utility manhole and 29.9' easterly of the easterly edge of pavement of Franklin Street. (Northing = 897601.505, Easting = 174477.842)

Existing Structure: S.N. 016-2445. The substructure was constructed in 1952 under section number 2424.1-B, the superstructure was constructed in 1954 under section number 2424.2-B, the electrical equipment was installed in 1954 under section number 2424.3-B, and the bridge houses and enclosures were constructed in 1956 under section number 2424.20-B. In 1981, the superstructure was rehabilitated under section number 1977-116-R. The existing structure is a dual double-leaf, trunnion type bascule bridge, carrying the eastbound and westbound traffic of Congress Parkway over the South Branch of the Chicago River. The movable structure has an overall length of approximately 333'-0" @ to @ of end bents and has an out-to-out deck width of approximately 110'-4". The deck cross section consists of four 10'-9" traffic lanes with no shoulder, a 9'-9 1/2" overall sidewalk on each side, and a 4'-9" median. Salvage: The median Aluminum barrier will be salvaged and reinstalled with new posts & hardware. Staging: Construction will be completed in two (2) stages as shown on sheets 6 of 7. The channel will remain open to traffic unless noted otherwise.

LOADING HS20/ALTERNATE
MILITARY LOADING

Allow 5#/sq. ft. for future wearing surface.

DESIGN SPECIFICATIONS

2002 AASHTO
AASHTO Standard Specifications for Movable Highway Bridges 1988, with Interims through 1995.

DESIGN STRESSES

FIELD UNITS (New Construction)

$F'_c = 3,500$ psi
 $f_y = 60,000$ psi (reinforcement)
 $f_y = 50,000$ psi (AASHTO M270, GR. 50)

FIELD UNITS (Existing Construction)

$F'_c = 3,500$ psi
 $f_y = 40,000$ psi (reinforcement)
 $f_y = 33,000$ psi (structure steel)
 $f_y = 44,000$ psi (silicon steel)

SEISMIC DATA

Seismic Performance Category (SPC) = A
Bedrock Acceleration Coefficient (A) = 0.025g
Site Coefficient (S) = 1.0

Notes:
All elevation shown are based on the Chicago City Datum.
The conversion equation from CCD to NAVD 88 is: NAVD 88 elevation = CCD + 579.19.

- * Existing Fender Systems and existing Dolphins to be replaced under contract No. 60E11.
- ** All dimension shown in the plans are based on centerline of existing structure.
- *** All station and offset shown in the plans are based on the survey baseline.

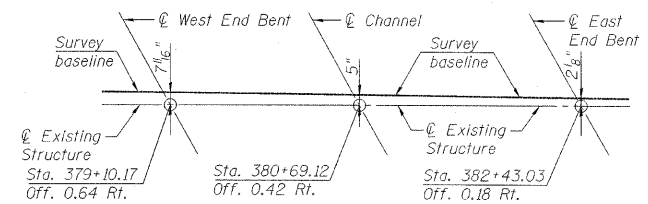

EXISTING STRUCTURE CENTERLINE
OFFSET SKETCH

APPROVED
FOR STRUCTURAL ADEQUACY ONLY

Rafael E. Audureau (TPE)
ENGINEER OF BRIDGES AND STRUCTURES

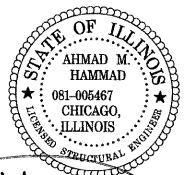

Signed: *Ahm*
Ahmad M. Hammad, S.E. Il. Lic. No. 081-005467
Expires 11-30-2010
Date: 5/8/2009

GENERAL PLAN
CONGRESS PARKWAY OVER
SOUTH BRANCH CHICAGO RIVER
PUBLIC WATER
F.A.P. RT. 389 - SEC. 2424.2B-R
COOK COUNTY
STATION 380+69.12
STRUCTURE NO. 016-2445

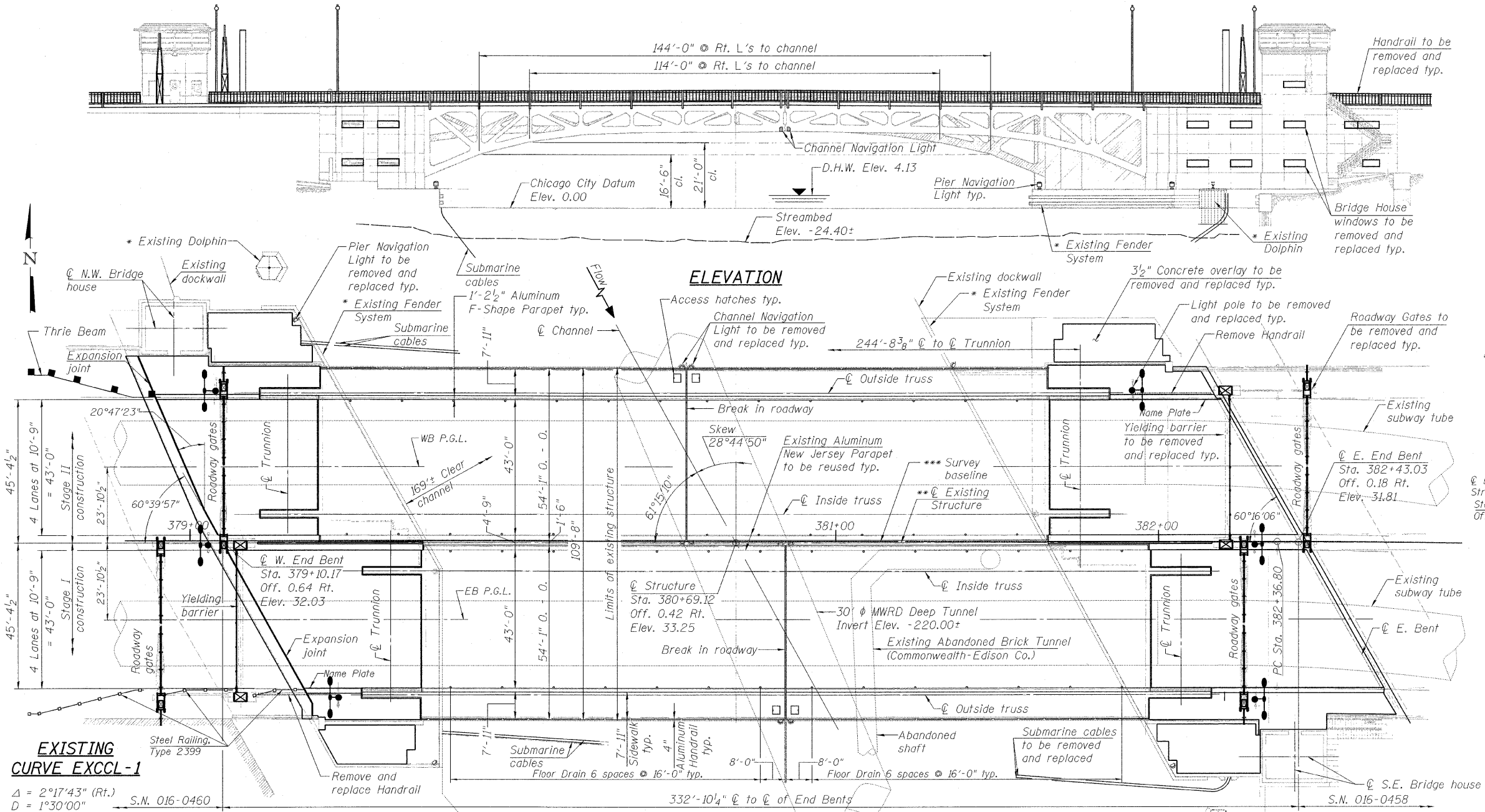

EXISTING CURVE EXCCL-1
 $\Delta = 2^\circ 17' 43''$ (Rt.)
 $D = 1^\circ 30' 00''$
 $T = 76.52'$
 $L = 153.01'$
 $E = 0.77'$
 $R = 3,819.72'$
P.C. = Sta. 382+36.80
P.T. = Sta. 383+89.81
P.I. = Sta. 383+13.31

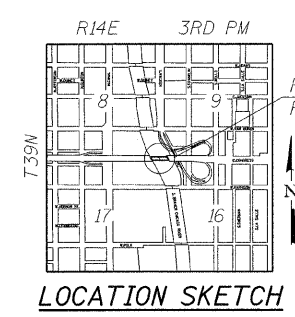
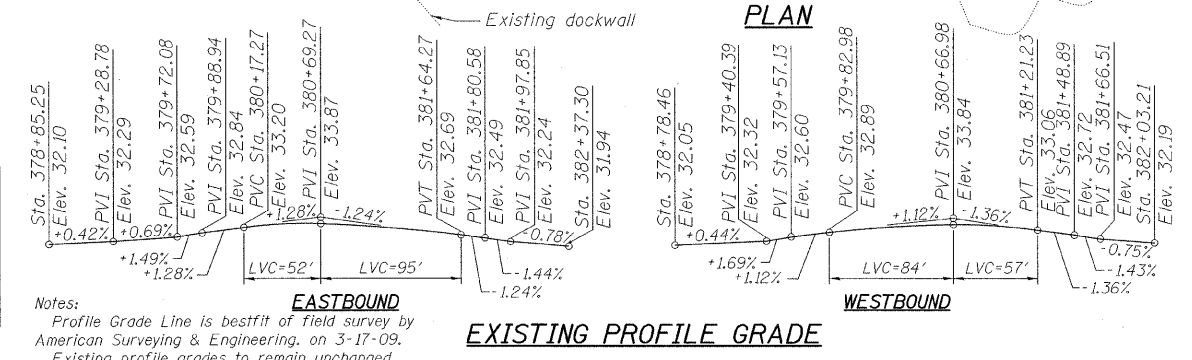

PB Americas, Inc.
230 WEST MONROE STREET,
SUITE 900
CHICAGO, IL. 60606

SHEET NO. 1	F.A.P. RTE. 389	SECTION 2424.2B-R	COUNTY COOK	TOTAL SHEETS 398	SHEET NO. 82
163 SHEETS			CONTRACT NO. 60D61		
FED. ROAD DIST. NO. 7 ILLINOIS FED. AID PROJECT					

T:\16845A\Structural\Cadd\Pre-final\EB_Plans\0162445-60D61-GPE-001.dgn 07-MAY-2009