

F.A.I. RTE.	SECTION	COUNTY	TOTAL SHEETS	SHEET NO.
74	(57-22)BR-2	MCLEAN	42	1

D-95-051-07

(217)465-4181

PROJECT ENGINEER: KENSIL GARNETT

SQUAD LEADER: CORY SHEEHY

STATE OF ILLINOIS  
 DEPARTMENT OF TRANSPORTATION  
 DIVISION OF HIGHWAYS

**PROPOSED  
 HIGHWAY PLANS**  
 FAI ROUTE 74 (I-74)  
 SECTION (57-22)BR-2  
 MCLEAN COUNTY  
 PROJECT

C-95-051-07

KICKAPOO CREEK 5.9 MI E OF US 51

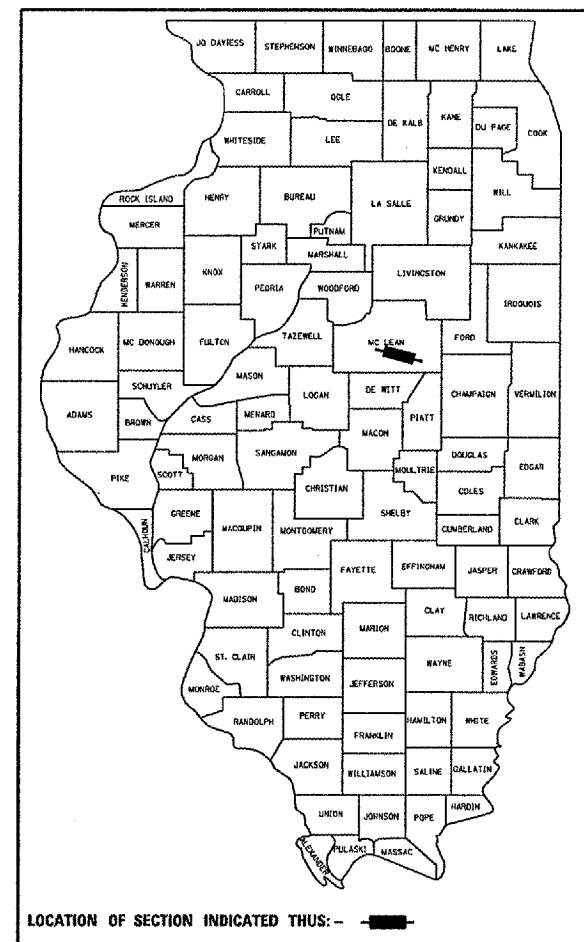

LOCATION OF SECTION INDICATED THUS: - ■ -

FOR INDEX OF SHEETS, SEE SHEET NO. 2  
 FOR SUMMARY OF QUANTITIES, SEE SHEET NO. 4

I-74 (WB)  
 ADT = 9,500 (2007)  
 % SU = 5.7  
 % MU = 39.2  
 % PCPU 55.1  
 DHV = 589

**DESIGN DESIGNATION**  
 FUNCTIONAL CLASSIFICATION  
 INTERSTATE

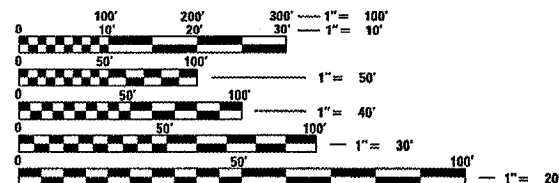

FULL SIZE PLANS HAVE BEEN PREPARED USING STANDARD ENGINEERING SCALES. REDUCED SIZED PLANS WILL NOT CONFORM TO STANDARD SCALES. IN MAKING MEASUREMENTS ON REDUCED PLANS, THE ABOVE SCALES MAY BE USED.

J.U.L.I.E.  
 JOINT UTILITY LOCATION INFORMATION FOR EXCAVATION  
 1-800-892-0123

CONTRACT NO. 70671

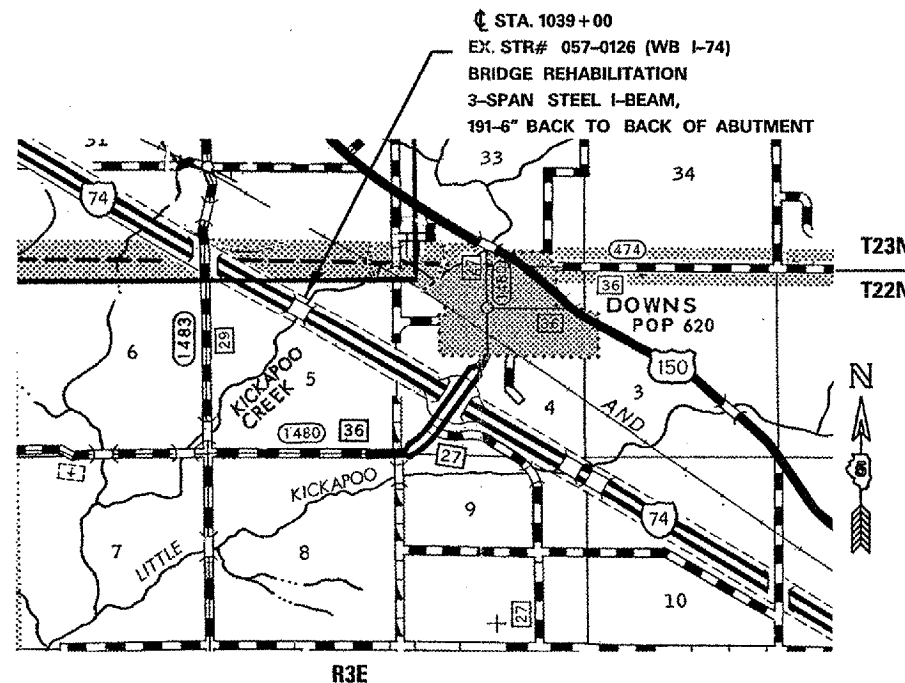

TOTAL LENGTH OF SECTION & PROJECT = 800.00 FEET = 0.151 MILES  
 NET LENGTH OF SECTION & PROJECT = 800.00 FEET = 0.151 MILES

STATE OF ILLINOIS  
 DEPARTMENT OF TRANSPORTATION  
 DIVISION OF HIGHWAYS

SUBMITTED 8/2 2007  
*Joseph E. Gowen*  
 DEPUTY DIRECTOR OF HIGHWAYS, REGION 3 ENGINEER

August 3, 2007  
*Eric E. Horn*  
 ENGINEER OF DESIGN AND ENVIRONMENT

August 3, 2007  
*Milton R. Sees*  
 DIRECTOR OF HIGHWAYS, CHIEF ENGINEER

**PRINTED BY THE AUTHORITY  
 OF THE STATE OF ILLINOIS**