

TIE POINT LAYOUT

CONTRACT NO. 70671				
F.A.L. RTE.	SECTION	COUNTY	TOTAL SHEETS	SHEET NO.
74	(57-22)BR-2	MCLEAN	42	8
STA.		TO STA.		
FED. ROAD DIST. NO.		ILLINOIS FED. AID PROJECT		

P.O.T. #4 1012 + 43.82
O/S = 0.0'

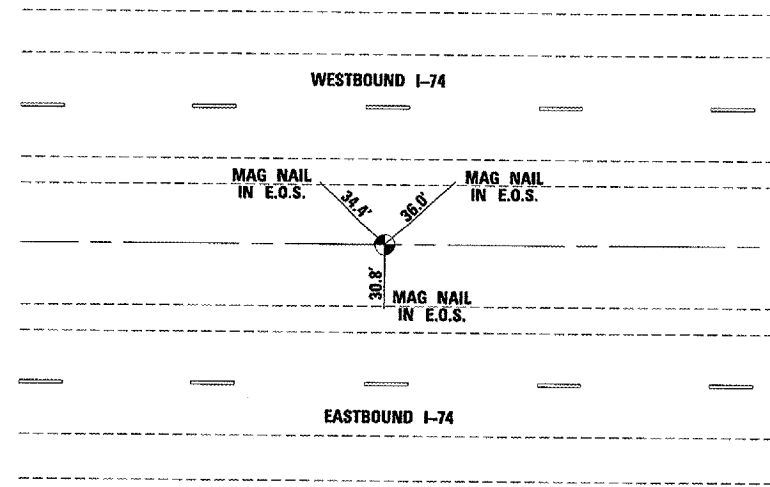

P.O.T. #3 1037 + 48.27
O/S = 0.25' RT

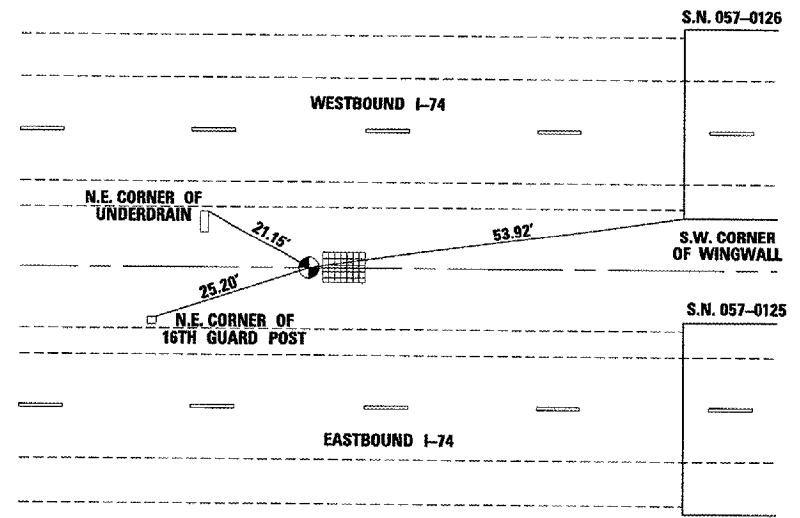

P.O.T. #1 1060 + 00.81
O/S = 0.0'

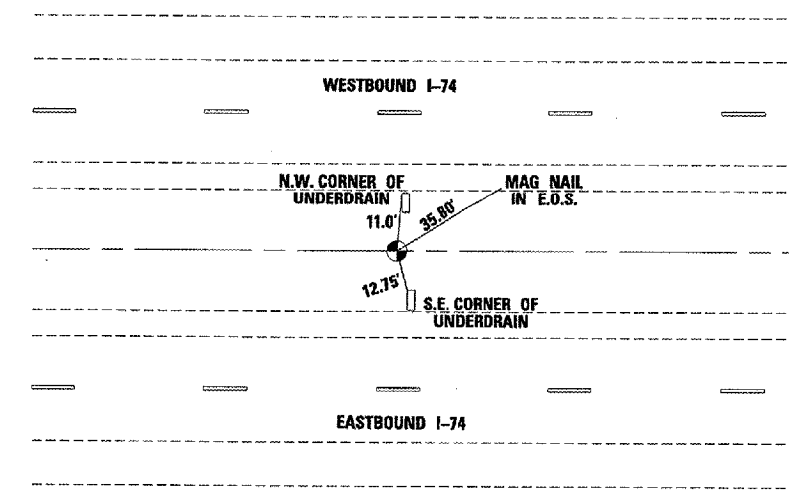

BENCHMARK DESCRIPTIONS

4818-1

STA. 1051+02

O/S = 0.15' RT

Description: Brass Stem

Location: To reach from the intersection of I-74 and Kickapoo Creek, go east on I-74 for 1300' to mark on the left. Said mark is a broken brass stem on the west side of a concrete drop box. Drop box is located 50' east of a turn around.

4818-2

STA. 1040+05.7

O/S = 69.1' LT

Description: Chiseled Square

Location: Said mark is a chiseled square located on the top of the NE wingwall of the North structure over Kickapoo Creek on I-74.

4818-3

STA. 1037+98

O/S = 28.8' RT

Description: Chiseled Square

Location: Said mark is a chiseled square located on the top of the NW wingwall of the South structure over Kickapoo Creek on I-74.

4814-4

STA. 1021+11.4

O/S = 10.8' LT

Description: Chiseled Square

Location: To reach from the intersection of I-74 and Kickapoo Creek, go west on I-74 for 1500' to mark on the left. Said mark is a chiseled square located on the SE corner of a drop box on the north side of the median.