

**LEGEND**

- ① EXISTING +/-3" HMA (BEFORE MILLING)
- ② EXISTING +/-4" HMA (BEFORE MILLING)
- ③ EXISTING +/-10" P.C.C. BASE
- ④ EXISTING B-6.24 CURB AND GUTTER
- ⑤ EXISTING BITUMINOUS SHOULDER +/-8"
- ⑥ EXISTING +/- 8" AGGREGATE SHOULDER, TYPE B
- ⑦ HMA SURFACE REMOVAL - 3" (SEE NOTE 1)
- ⑧ POLYMERIZED LEVELING BINDER (MACHINE METHOD), IL-4.75, N50 -1"
- ⑨ POLYMERIZED HOT-MIX ASPHALT SURFACE COURSE, STONE MATRIX ASPHALT, N80 -2"
- ⑩ PORTLAND CEMENT CONCRETE SURFACE REMOVAL VARIABLE DEPTH (SEE NOTE 2)
- ⑪ AGGREGATE WEDGE SHOULDER, TYPE B
- ⑫ HMA SURFACE REMOVAL - 2"
- ⑬ HOT-MIX ASPHALT SURFACE COURSE, MIX "D", N70 (IL-9.5mm) -2"
- ⑭ HOT-MIX ASPHALT SURFACE COURSE, MIX "D", N70 (IL-9.5mm) -3"
- ⑮ STRIP REFLECTIVE CRACK CONTROL TREATMENT

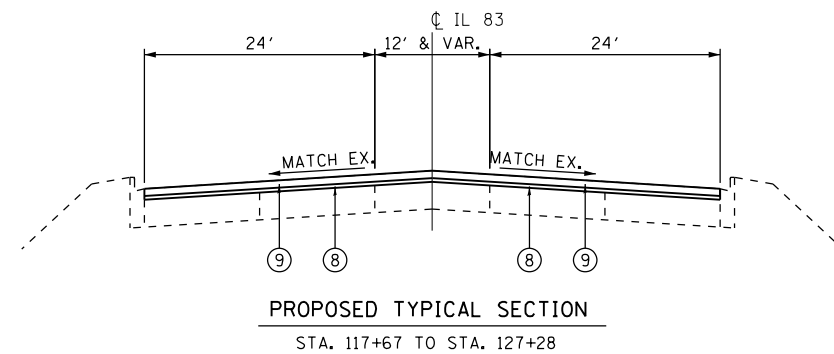
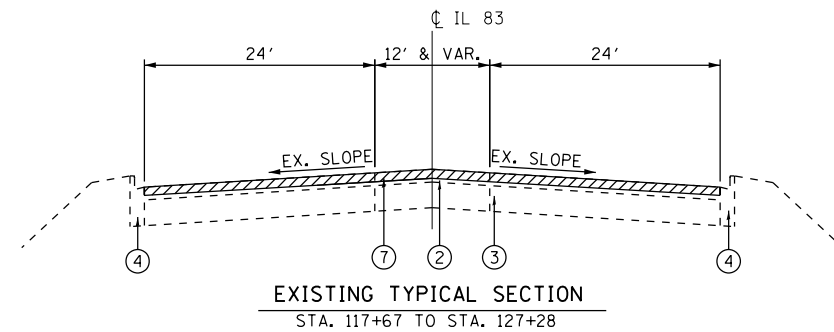

**NOTES**

1. THE CONTRACTOR SHALL PERFORM THE PAVEMENT PATCHING OPERATIONS PRIOR TO THE HMA SURFACE REMOVAL OPERATION. SEE IDOT DISTRICT 1 DETAIL PAVEMENT PATCHING FOR HMA SURFACED PAVEMENT BD-400-04 (BD-22) FOR ADDITIONAL INFORMATION.
2. CLASS D PATCH TYPE IV, 8 INCH TO BE USED ON 8 INCH HMA SHOULDER. LOCATIONS TO BE DETERMINED IN THE FIELD BY THE RESIDENT ENGINEER.
3. REFER TO DETAIL HMA TAPER AT EDGE OF P.C.C. PAVEMENT FOR DEPTH OF MILLING AT GUTTER FLAG.

**OMISSIONS**

STA. 109+04 TO STA. 117+67

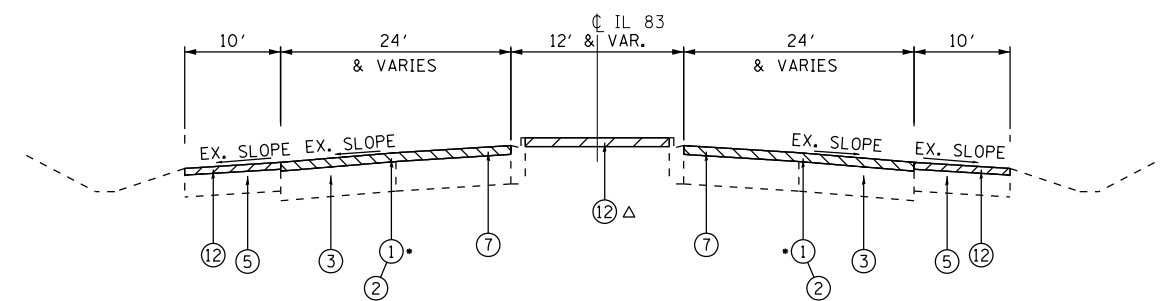

**EXISTING TYPICAL SECTION**  
 STA. 127+28 TO STA. 134+00 Δ  
 STA. 158+00 TO STA. 160+77  
 STA. 267+00 TO STA. 281+90 •

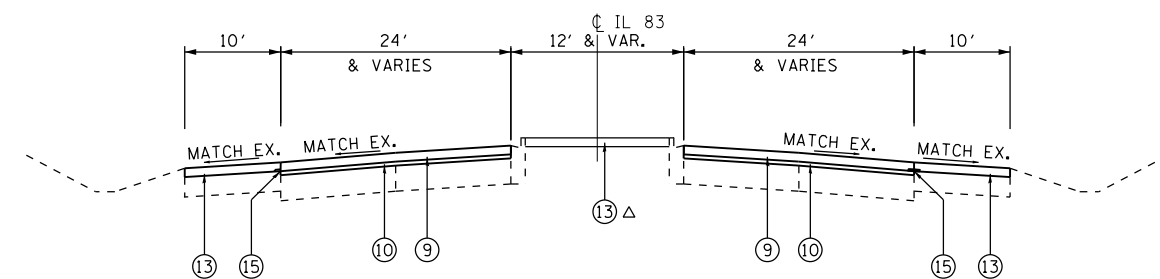

**PROPOSED TYPICAL SECTION**  
 STA. 127+28 TO STA. 134+00 Δ  
 STA. 158+00 TO STA. 160+77  
 STA. 267+00 TO STA. 281+90

HOT-MIX ASPHALT MIXTURE REQUIREMENTS			QUALITY MANAGEMENT PROGRAM (QMP)
MIXTURE TYPE	AIR VOIDS	Ndes	
<b>PAVEMENT RESURFACING</b>			
POLYMERIZED HOT-MIX ASPHALT SURFACE COURSE, STONE MATRIX ASPHALT, N80 (IL-12.5 mm)	3.5% @ 80 GYR.		PFP
POLYMERIZED LEVELING BINDER (MACHINE METHOD), IL-4.75, N50	3.5% @ 50 GYR.		PFP
<b>HMA SHOULDER RESURFACING</b>			
HOT-MIX ASPHALT SURFACE COURSE, MIX "D", N70 (IL-9.5 mm)	4% @ 70 GYR.		OCP
<b>HMA MEDIAN RESURFACING</b>			
HOT-MIX ASPHALT SURFACE COURSE, MIX "D", N70 (IL-9.5 mm)	4% @ 70 GYR.		OCP
<b>PATCHING</b>			
CLASS D PATCHES (HMA BINDER IL-19 mm)	4% @ 70 GYR.		QC/OA
HMA REPLACEMENT OVER PATCHES (HMA BINDER IL-19 mm)	4% @ 70 GYR.		QC/OA
<b>QMP DESIGNATION: QUALITY CONTROL/QUALITY ASSURANCE (QC/OA); QUALITY CONTROL FOR PERFORMANCE (OCP); PAY FOR PERFORMANCE (PFP)</b>			

MIXTURE NOTES:

- 1.) THE UNIT WEIGHT USED TO CALCULATE ALL HOT-MIX ASPHALT SURFACE MIXTURE QUANTITIES IS 112 LBS/SQ YD/IN.
- 2.) THE "AC TYPE" FOR POLYMERIZED HMA MIXES SHALL BE "SBS/SBR PG 76 -22" AND FOR NON-POLYMERIZED HMA THE "AC TYPE" SHALL BE "PG 64 -22" UNLESS MODIFIED BY DISTRICT ONE SPECIAL PROVISIONS. FOR USE OF RECYCLED MATERIALS SEE SPECIAL PROVISIONS.
- 3.) QUALITY MANAGEMENT PROGRAM (QMP) IDENTIFIES THE PARTICULAR QUALITY CONTROL SPECIFICATION THAT APPLIES TO THE HMA MIXTURE.