

EXISTING HORIZONTAL & VERTICAL CONTROL

IL 78 SOUTH

IL 78 SOUTH (CON'T)

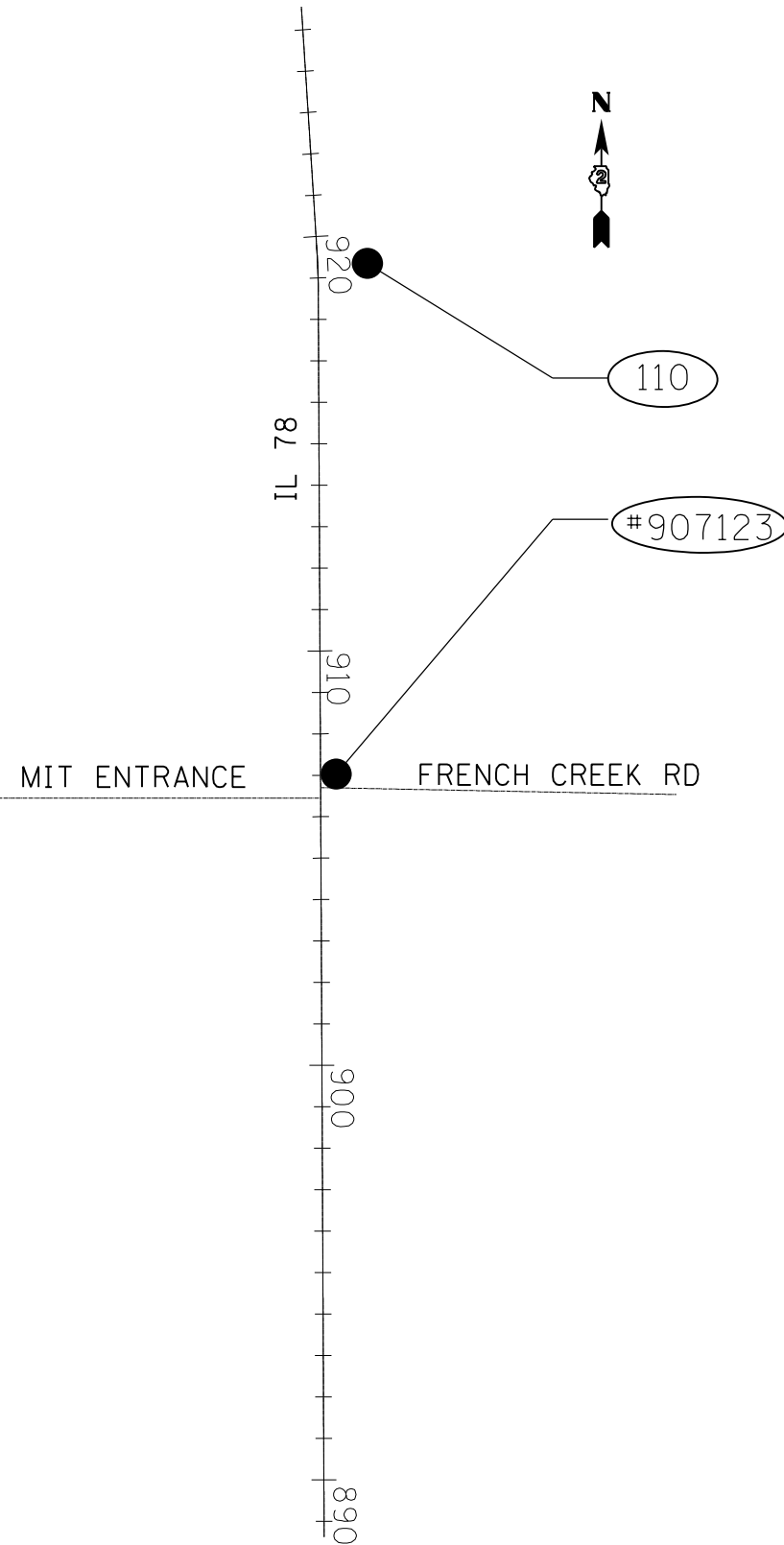

Chain IL78SOUTH contains:
A099283 CUR A1071440 CUR A1071450 CUR A1071460 CUR A1071470 CUR A1071480 CUR A1071490 CUR A1071500 A1071510 100008

Beginning chain IL78SOUTH description
=====

Point A099283 N 1,858,806.1379 E 2,351,622.6196 Sta 806+10.13
Course from A099283 to PC A1071440 N 0° 40' 50.57" E Dist 623.4058'

Curve Data

Curve A1071440
P.I. Station 813+81.63 N 1,859,577.5798 E 2,351,631.7853
Delta = 10° 33' 36.82" (RT)
Degree = 3° 34' 32.12"
Tangent = 148.0906'
Length = 295.3423'
Radius = 1,602.4153'
External = 6.8285'
Long Chord = 294.9245'
Mid. Ord. = 6.7995'
P.C. Station 812+33.54 N 1,859,429.4997 E 2,351,630.0259
P.T. Station 815+28.88 N 1,859,722.8295 E 2,351,660.6534
C.C. N 1,859,410.4623 E 2,353,232.3281

Course from PT A1071440 to PC A1071450 N 11° 14' 27.39" E Dist 1,183.3833'

Curve Data

Curve A1071450
P.I. Station 830+01.39 N 1,861,167.0878 E 2,351,947.6969
Delta = 10° 58' 11.36" (LT)
Degree = 1° 54' 10.44"
Tangent = 289.1234'
Length = 576.4793'
Radius = 3,010.9725'
External = 13.8494'
Long Chord = 575.5992'
Mid. Ord. = 13.7860'
P.C. Station 827+12.27 N 1,860,883.5110 E 2,351,891.3365
P.T. Station 832+88.74 N 1,861,456.2080 E 2,351,949.0650
C.C. N 1,861,470.4557 E 2,348,938.1262

Course from PT A1071450 to PC A1071460 N 0° 16' 16.03" E Dist 264.9654'

Curve Data

Curve A1071460
P.I. Station 839+39.63 N 1,862,107.0894 E 2,351,952.1449
Delta = 5° 04' 21.83" (RT)
Degree = 0° 39' 27.54"
Tangent = 385.9233'
Length = 771.3424'
Radius = 8,712.2055'
External = 8.5434'
Long Chord = 771.0905'
Mid. Ord. = 8.5350'
P.C. Station 835+53.71 N 1,861,721.1704 E 2,351,950.3188
P.T. Station 843+25.05 N 1,862,491.3354 E 2,351,988.0870
C.C. N 1,861,679.9450 E 2,360,662.4268

Course from PT A1071460 to PC A1071470 N 5° 20' 37.86" E Dist 1,404.2957'

Curve Data

Curve A1071470
P.I. Station 859+53.91 N 1,864,113.1088 E 2,352,139.7863
Delta = 17° 28' 46.80" (LT)
Degree = 3° 55' 21.00"
Tangent = 224.5572'
Length = 445.6257'
Radius = 1,460.6956'
External = 17.1601'
Long Chord = 443.8996'
Mid. Ord. = 16.9609'
P.C. Station 857+29.35 N 1,863,889.5276 E 2,352,118.8727
P.T. Station 861+74.97 N 1,864,332.6477 E 2,352,092.5777
C.C. N 1,864,025.5660 E 2,350,664.5257

Course from PT A1071470 to PC A1071480 N 12° 08' 08.94" W Dist 1,134.4005'

Curve Data

Curve A1071480
P.I. Station 875+76.48 N 1,865,702.8302 E 2,351,797.9400
Delta = 8° 04' 15.62" (RT)
Degree = 1° 30' 48.04"
Tangent = 267.1028'
Length = 533.3220'
Radius = 3,786.0342'
External = 9.4103'
Long Chord = 532.8812'
Mid. Ord. = 9.3870'
P.C. Station 873+09.37 N 1,865,441.6966 E 2,351,854.0930
P.T. Station 878+42.70 N 1,865,969.2611 E 2,351,779.0065
C.C. N 1,866,237.6336 E 2,355,555.5169

Course from PT A1071480 to PC A1071490 N 4° 03' 53.32" W Dist 31.8091'

Curve Data

Curve A1071490
P.I. Station 883+38.35 N 1,866,463.6697 E 2,351,743.8720
Delta = 3° 47' 29.13" (RT)
Degree = 0° 24' 31.84"
Tangent = 463.8463'
Length = 927.3541'
Radius = 14,014.1144'
External = 7.6742'
Long Chord = 927.1849'
Mid. Ord. = 7.6700'
P.C. Station 878+74.51 N 1,866,000.9902 E 2,351,776.7517
P.T. Station 888+01.86 N 1,866,927.5107 E 2,351,741.6588
C.C. N 1,866,994.3785 E 2,365,755.6136

Course from PT A1071490 to PC A1071500 N 0° 16' 24.19" W Dist 3,065.0455'

Curve Data

Curve A1071500
P.I. Station 919+23.94 N 1,870,049.5523 E 2,351,726.7619
Delta = 3° 28' 26.71" (LT)
Degree = 3° 02' 48.07"
Tangent = 57.0316'
Length = 114.0283'
Radius = 1,880.5935'
External = 0.8646'
Long Chord = 114.0109'
Mid. Ord. = 0.8642'
P.C. Station 918+66.90 N 1,869,992.5213 E 2,351,727.0340
P.T. Station 919+80.93 N 1,870,106.4620 E 2,351,723.0344
C.C. N 1,869,983.5481 E 2,349,846.4620

Course from PT A1071500 to A1071510 N 3° 44' 50.89" W Dist 100.7509'

Point A1071510 N 1,870,206.9975 E 2,351,716.4494 Sta 920+81.68

Course from A1071510 to 100008 N 3° 39' 36.83" W Dist 473.6100'

Point 100008 N 1,870,679.6414 E 2,351,686.2143 Sta 925+55.29

=====

Ending chain IL78SOUTH description

CURVE POINT NUMBERS

CHAIN	CURVE	PI	CC	PC	PT
IL78SOUTH	A1071440	1071440	1071441	1071442	1071443
IL78SOUTH	A1071450	1071450	1071451	1071452	1071453
IL78SOUTH	A1071460	1071460	1071461	1071462	1071463
IL78SOUTH	A1071470	1071470	1071471	1071472	1071473
IL78SOUTH	A1071480	1071480	1071481	1071482	1071483
IL78SOUTH	A1071490	1071490	1071491	1071492	1071493
IL78SOUTH	A1071500	1071500	1071501	1071502	1071503