

PRE-STAGE 1B

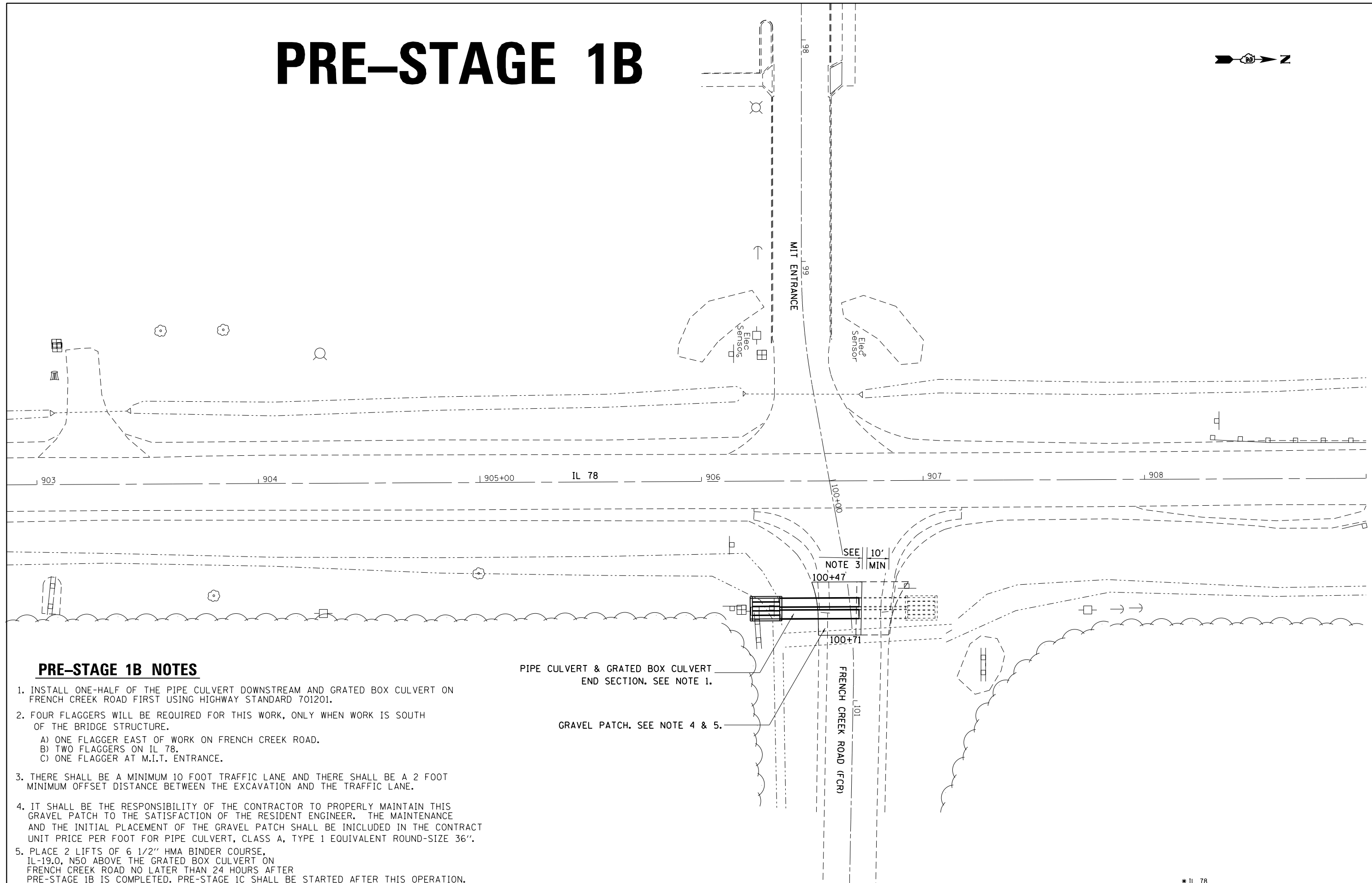

PRE-STAGE 1B NOTES

1. INSTALL ONE-HALF OF THE PIPE CULVERT DOWNSTREAM AND GRATED BOX CULVERT ON FRENCH CREEK ROAD FIRST USING HIGHWAY STANDARD 701201.
2. FOUR FLAGGERS WILL BE REQUIRED FOR THIS WORK, ONLY WHEN WORK IS SOUTH OF THE BRIDGE STRUCTURE.
 - A) ONE FLAGGER EAST OF WORK ON FRENCH CREEK ROAD.
 - B) TWO FLAGGERS ON IL 78.
 - C) ONE FLAGGER AT M.I.T. ENTRANCE.
3. THERE SHALL BE A MINIMUM 10 FOOT TRAFFIC LANE AND THERE SHALL BE A 2 FOOT MINIMUM OFFSET DISTANCE BETWEEN THE EXCAVATION AND THE TRAFFIC LANE.
4. IT SHALL BE THE RESPONSIBILITY OF THE CONTRACTOR TO PROPERLY MAINTAIN THIS GRAVEL PATCH TO THE SATISFACTION OF THE RESIDENT ENGINEER. THE MAINTENANCE AND THE INITIAL PLACEMENT OF THE GRAVEL PATCH SHALL BE INCLUDED IN THE CONTRACT UNIT PRICE PER FOOT FOR PIPE CULVERT, CLASS A, TYPE 1 EQUIVALENT ROUND-SIZE 36".
5. PLACE 2 LIFTS OF 6 1/2" HMA BINDER COURSE, IL-19.0, N50 ABOVE THE GRATED BOX CULVERT ON FRENCH CREEK ROAD NO LATER THAN 24 HOURS AFTER PRE-STAGE 1B IS COMPLETED. PRE-STAGE 1C SHALL BE STARTED AFTER THIS OPERATION.

PIPE CULVERT & GRATED BOX CULVERT
END SECTION. SEE NOTE 1.

GRAVEL PATCH. SEE NOTE 4 & 5.

FILE NAME =	USER NAME = Fasslermj	DESIGNED -	REVISED -
ca:\pw\work\pmdot\fasslermj\d0149594\0208209-shit-staging.dgn		DRAWN -	REVISED -
PLOT SCALE = 40.0000' / in.		CHECKED -	REVISED -
PLOT DATE = Fri Jun 13 11:07:47 2014		DATE -	REVISED -

STATE OF ILLINOIS
DEPARTMENT OF TRANSPORTATION

IL 78 STAGING DETAILS

PRE-STAGE 1B

SCALE: 20' / IN. SHEET NO. 1 OF 14 SHEETS STA. 903+00 TO STA. 909+00

* IL 78

F.A.P. RTE.	SECTION	COUNTY	TOTAL SHEETS	SHEET NO.
#22	15BR-1	WHITESIDE	146	37
CONTRACT NO. 64F19			ILLINOIS FED. AID PROJECT	