

STAGE 1

EXIST. CURVE A1071500
 P.I. STA. = 919+23.94
 $\Delta = 3^\circ 28' 27''$ (LT)
 $D = 3^\circ 02' 48''$
 $R = 1,880.59'$
 $T = 57.03'$
 $L = 114.03'$
 $E = 0.86'$
 T.R. = _____
 S.E. RUN = _____
 P.C. STA. = 918+66.90
 P.T. STA. = 919+80.93

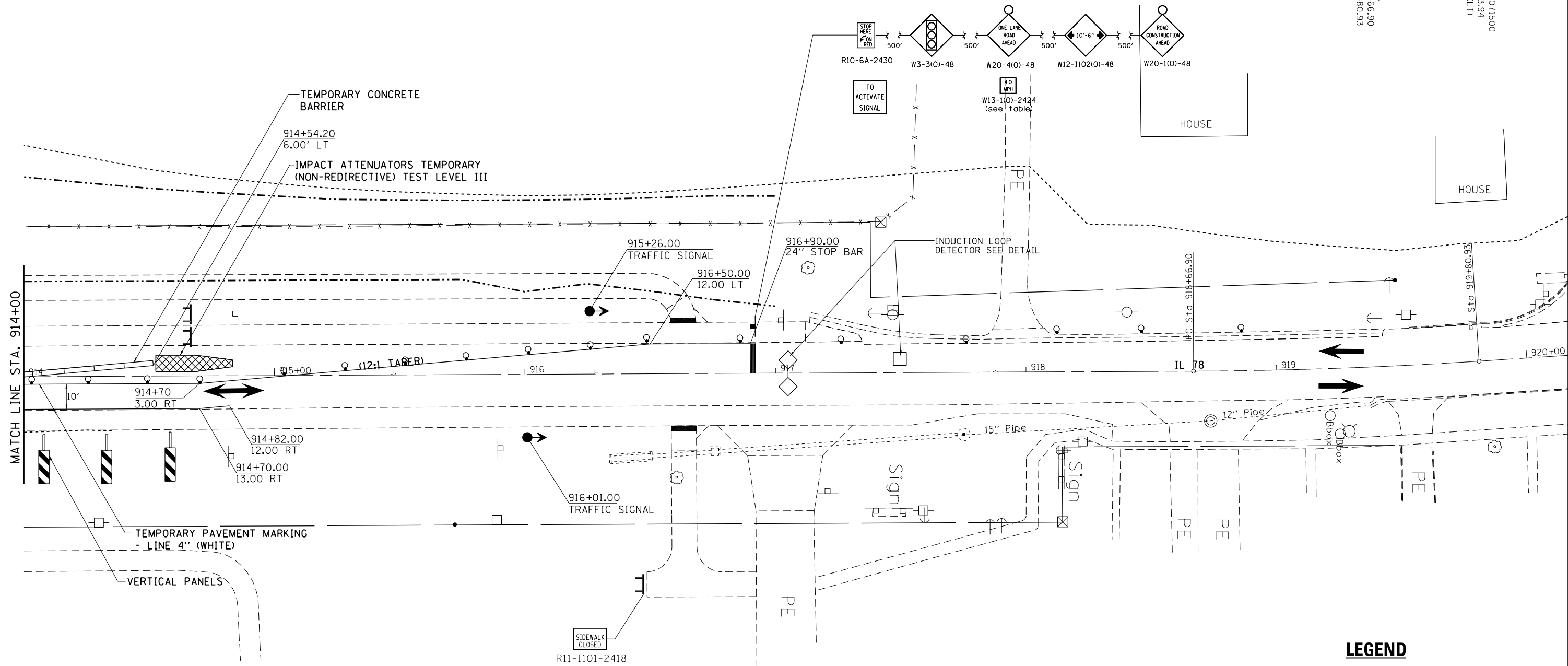

STAGE 1 NOTES

1. USE HIGHWAY STANDARD 701321 & 701801.
2. CONSTRUCT PROPOSED BRIDGE LT TO STAGE CONSTRUCTION LINE.
3. INSTALL GUARDRAIL LT. EXISTING GUARDRAIL RT TO REMAIN-IN-PLACE.
4. CONSTRUCT LEVEL BINDER RAMPS AND TEMPORARY RAMPS.
5. BUILD MULTI-USE PATH FROM LT STA. 906+64.4 TO LT STA. 916+63.34.
6. BARRIER WALL OFFSETS ARE TO THE CONSTRUCTION SIDE OF THE WALL.

LEGEND

	= TYPE III BARRICADE WITH FLASHING LIGHTS
	= SIGN
	= BARRICADE, OR DRUM WITH STEADY BURNING LIGHTS
	= INDUCTION LOOP DETECTOR
	= TRAFFIC SIGNAL

* IL 78

FILE NAME =	USER NAME = Fasslermj	DESIGNED -	REVISED -
ca:\pw_work\p\pidot\fasslermj\d0149594\0208209-sh1-staging.dgn		DRAWN -	REVISED -
	PLOT SCALE = 40.0000' / in.	CHECKED -	REVISED -
	PLOT DATE = Fri Jun 13 10:37:50 2014	DATE -	REVISED -

STATE OF ILLINOIS
DEPARTMENT OF TRANSPORTATION

IL 78 STAGING DETAILS		F.A.P. RTE.	SECTION	COUNTY	TOTAL SHEETS	SHEET NO.
STAGE 1		#22	15BR-1	WHITESIDE	146	50
SCALE: 20' / IN.		SHEET NO. 11 OF 14 SHEETS		STA. 914+00 TO STA. 920+00		CONTRACT NO. 64F19
ILLINOIS FED. AID PROJECT						