

B.M. Spike Washer in roof of 30" Maple RT Rt Sta 8+33 El. 183.67
 Existing Structure 50' R.C. Thru Girder - 15' Roadway
 R.C. Closed Abuts. Contractor shall remove Existing
 Structure. No Salvage. Broken Concrete shall be disposed
 of by Bridge Contractor as directed by the Engineer.

STATE OF ILLINOIS
 DEPARTMENT OF PUBLIC WORKS & BUILDINGS
 DIVISION OF HIGHWAYS

FOR REFERENCE ONLY

PROJECT NO.	SECTION	COUNTY	TOTAL SHEETS	SHEET NO.
5BR	Whiteside	27	18	8

SHEET NO. 1
 8 SHEETS

GENERAL NOTES

Class X Concrete shall be used thruout except as noted.
 Handrail Concrete shall be used in rails and posts.
 Concrete Floor Slab and Girders shall be poured in one
 continuous operation between joints.
 The concrete Floor Slab shall be finished in accordance
 with Art. 34.18(2) of the Standard Specifications.
 Handrails shall not be poured until after
 the falsework has been removed.
 All Rollers, Bearing Plates, Lead Plates and Anchor Bolts
 shall be fabricated and set in accordance with Art. 34.14
 of the Standard Specifications and are included for payment
 as Structural Steel.
 All Structural Steel shall receive one shop coat of red
 lead paint and two field coats of aluminum paint
 to top of railing. This shall be done in accordance with
 Art. 51.20 of the Standard Specifications.
 Structural Steel shall be inspected by Illinois Division
 of Highways before painting.
 Backfilling shall be done according to Art. 50.10 of the
 Standard Specifications.
 Boring Logs are shown on the plans only as a guide to
 bidders in estimating soil conditions which may be
 encountered in the work.
 The backs of Abutments and Wing Walls shall be water-
 proofed from top of parapet and top of wall respectively
 to top of footing. This shall be done in accordance with
 Art. 51.20 of the Standard Specifications.
 The Contractor shall excavate the channel to the lines
 and grades as shown on the plans and as directed by the
 Engineer. Suitable material therefrom may be placed
 in approach fill as directed by the Engineer. Estimated
 quantity of 391 cubic yards shown on bridge plans is for
 a distance of 35 ft left and right of centerline.

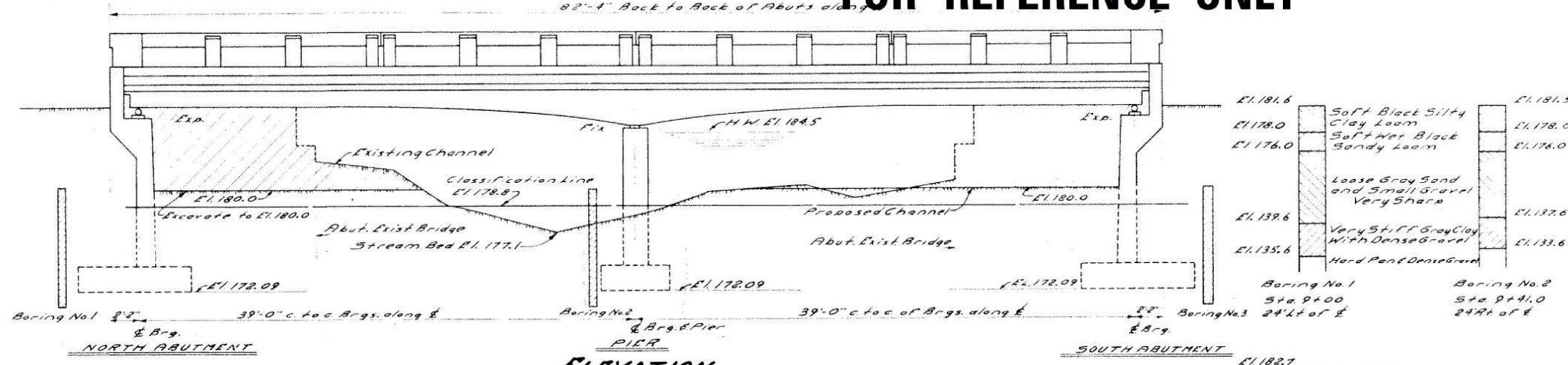

BORING DATA

Boring No. 1 Sta. 9+00 24' Rt of E	Boring No. 2 Sta. 9+41.0 24' Rt of E
El. 181.6 Soft Black Silty Clay Loam	El. 181.5
El. 178.0 Soft Wet Black Sandy Loam	El. 178.0
El. 176.0	El. 176.0
El. 139.6 Loose Gray Sand and Small Gravel Very Sharp	El. 137.6
El. 135.6 Very Stiff Gray Clay With Dense Gravel	El. 133.6
El. 135.6 Hard Pan Dense Gravel	

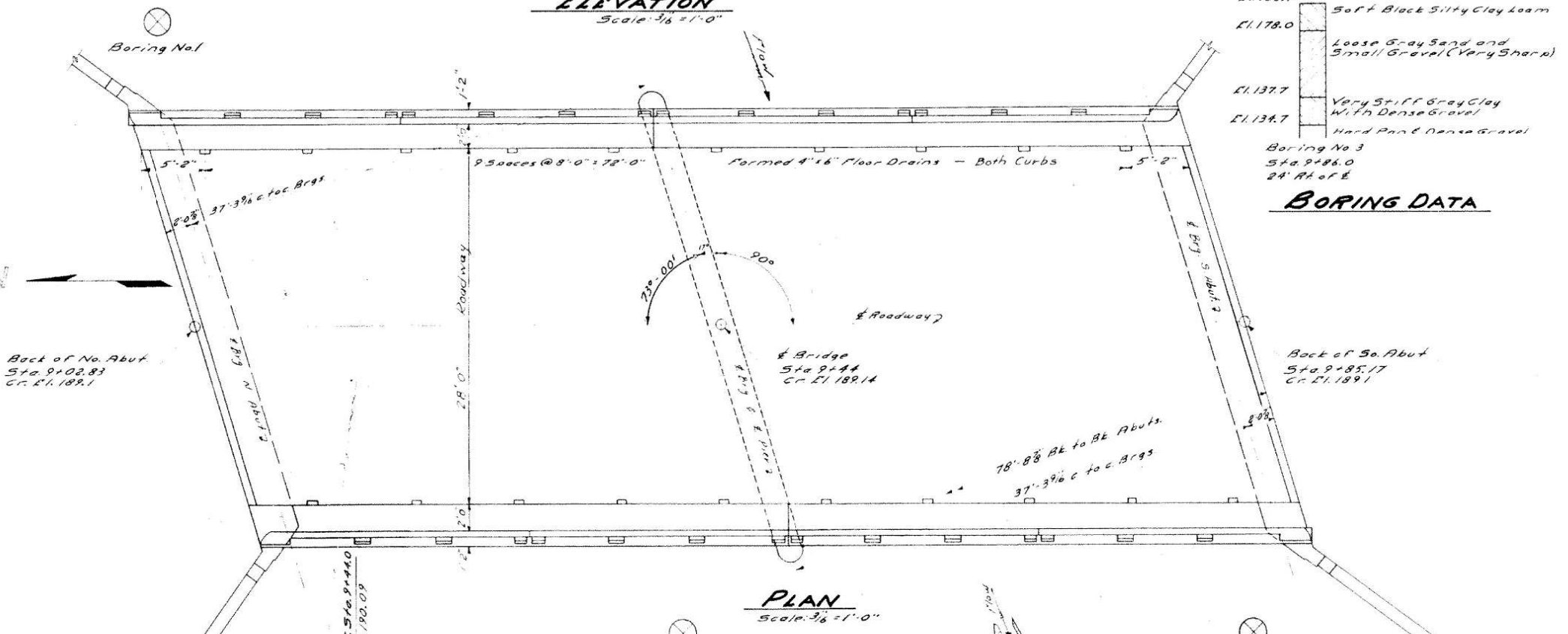

DESIGNED *Joseph J. Rimsay*
 CHECKED *Jack High*
 DRAWN *J.D.N. C. Pulley*
 CHECKED *J.J. Rimsay*

EXAMINED *W.E. Hanson*
 PASSED *[Signature]*
 APPROVED *[Signature]*

July 10 1953

WATERWAY INFORMATION
 Drainage Area - 7100 Acres
 Character - Rolling, Wooded, Cultivated
 Present Bridge Opening - 255' ±
 Proposed Bridge Opening - 350' ±



STRESSES
 Super. $f_c = 20000 \text{ psi}$
 $f_s = 1400 \text{ psi}$
 Sub. $f_c = 20000 \text{ psi}$
 $f_s = 800 \text{ psi}$
 $n = 10$

STATION 9+44
 BUILT 195- BY
 STATE OF ILLINOIS
 S.B.I. RT. 3 SEC. 15 BR
 LOADING H20-518

NAME & DATA
 See Standard 2113

TOTAL BILL OF MATERIAL

ITEM	SUPER	ABUTS.	PIER	TOTAL
Class X Concrete Cu.Yds.	131.0	182.9	46.7	360.6
Handrail Concrete Cu.Yds.	4.3			4.3
Reinforcement Bars Lbs.	34790	11970	2490	49250
Structural Steel Lbs.	4650			4650
Name Plates Ea.	1			1
Class A Excavation Cu.Yds. For Structures		333		333
Class B Excavation Cu.Yds. For Structures		470	93	563
Channel Excavation Cu.Yds.				391
Removal of Exst Struct Ea.				1
Temporary Bridge Complete Ea.				1
Untreated Piles (27/4) Lbs.		2150	500	2650
Test Piles Ea.		2	1	3
Metal Shoes Ea.		210	26	236

GENERAL PLAN & ELEVATION
FRENCH CREEK
S.B.I. RT. 3 (P.A. RT. 4) SEC. 15-BR
WHITESIDE COUNTY
STATION 9+44