

F.A.P. RTE.	SECTION	COUNTY	TOTAL SHEETS	SHEET NO.
332	(6,K-15d)RS-3	KANKAKEE	16	1
		ILLINOIS		CONTRACT NO. 66A95

- 1 COVER SHEET
- 2 GENERAL NOTES
- 3-5 SUMMARY OF QUANTITIES
- 6 TYPICAL SECTIONS
- 7-9 SCHEDULES
- 10 LAYOUT MAP
- 11-12 PAVEMENT MARKING DETAILS
- 13-16 DETAILS

DEPARTMENT OF TRANSPORTATION

DIVISION OF HIGHWAYS

PROPOSED HIGHWAY PLANS

FAP 332 (IL 1/17)
SECTION (6,K-15d)RS-3

3P RESURFACING
KANKAKEE COUNTY

C-93-053-11

3P MILLING AND RESURFACING ON IL 1 AND IL 17
FROM EAST OF IL 1(S) TO WEST OF IL 114 IN MOMENCE

LIST OF ILLINOIS DOT HIGHWAY STANDARDS

- 000001-06 STANDARD SYMBOLS, ABBREVIATIONS AND PATTERNS
- 001006 DECIMAL OF AN INCH AND OF A FOOT
- 635001-01 DELINEATORS
- 635011-02 REFLECTOR MARKER AND MOUNTING DETAILS
- 642006 SHOULDER RUMBLE STRIPS, 8 INCH
- 667101-02 PERMANENT SURVEY MARKERS
- 701006-05 OFF-ROAD OPERATIONS 2L, 2W, 15' (4.5 m) TO 24" (600 mm) FROM PAVEMENT EDGE
- 701011-04 OFF-ROAD MOVING OPERATIONS 2L, 2W, DAY ONLY
- 701301-04 LANE CLOSURE, 2L, 2W, SHORT TIME OPERATIONS
- 701306-03 LANE CLOSURE, 2L, 2W, SLOW MOVING OPERATIONS DAY ONLY, FOR SPEEDS ≥ 45 MPH
- 701311-03 LANE CLOSURE, 2L, 2W, MOVING OPERATIONS - DAY ONLY
- 701901-03 TRAFFIC CONTROL DEVICES
- 720011-01 METAL POSTS FOR SIGNS, MARKERS AND DELINEATORS
- 780001-04 TYPICAL PAVEMENT MARKINGS
- 781001-03 TYPICAL APPLICATIONS RAISED REFLECTIVE PAVEMENT MARKERS

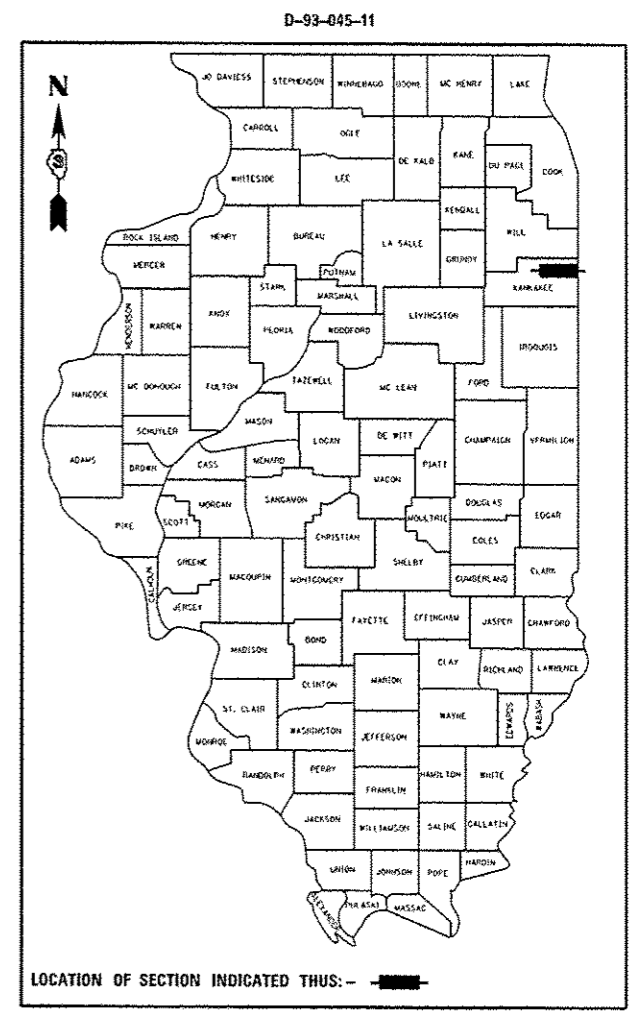

LOCATION OF SECTION INDICATED THUS: -

OTHER PRINCIPAL ARTERIAL
2013 ADT = 6950
P.V. = 67.6%
S.U. = 14.4%
M.U. = 18.0%

STATE OF ILLINOIS
DEPARTMENT OF TRANSPORTATION
DIVISION OF HIGHWAYS

SUBMITTED 6/11/14 20 14
DEPUTY DIRECTOR OF HIGHWAYS, REGIONAL ENGINEER
John D. Baranzelli, P.E.
ENGINEER OF DESIGN AND ENVIRONMENT
July 18 20 14
Omer Osman, P.E.
DIRECTOR OF HIGHWAYS, CHIEF ENGINEER

PRINTED BY THE AUTHORITY
OF THE STATE OF ILLINOIS

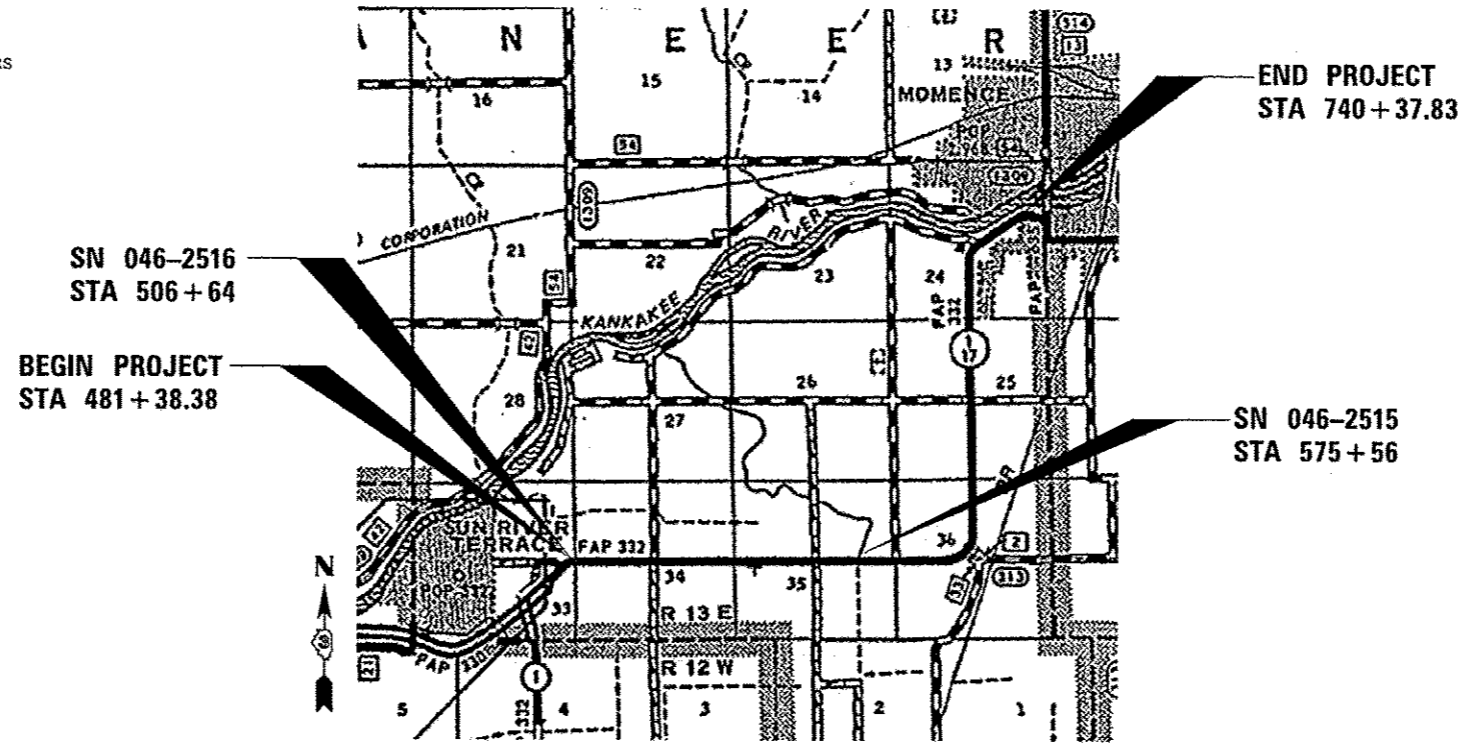

GROSS LENGTH = 25899.45 FT. = 4.905 MILE
NET LENGTH = 25899.45 FT. = 4.905 MILE

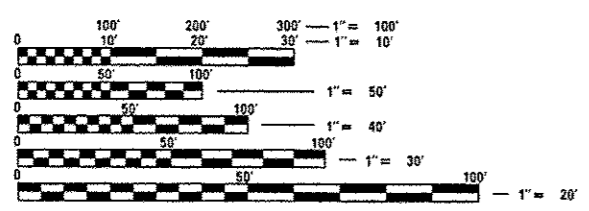

FULL SIZE PLANS HAVE BEEN PREPARED USING STANDARD ENGINEERING SCALES. REDUCED SIZED PLANS WILL NOT CONFORM TO STANDARD SCALES. IN MAKING MEASUREMENTS ON REDUCED PLANS, THE ABOVE SCALES MAY BE USED.

J.U.L.I.E.
JOINT UTILITY LOCATION INFORMATION FOR EXCAVATION
1-800-892-0123
OR 811

PROJECT ENGINEER: JOE KANNEL, P.E.
UNIT CHIEF: DARCY CARPENTER

CONTRACT NO. 66A95

GENERAL NOTES

THE THICKNESS OF HMA SHOWN ON THE PLANS IS THE NOMINAL THICKNESS. DEVIATIONS FROM THE NOMINAL THICKNESS WILL BE PERMITTED WHEN SUCH DEVIATIONS OCCUR DUE TO IRREGULARITIES IN THE EXISTING SURFACE OR BASE ON WHICH THE HMA IS PLACED.

THE HMA SURFACE OF ALL MAILBOX TURNOUTS, PRIVATE ENTRANCES, COMMERCIAL ENTRANCES, AND SIDE ROADS SHALL BE MADE NEATLY, IN A WORKMANLIKE MANNER, AND SHALL ACCURATELY CONFORM TO THE SHAPES AND DIMENSIONS SHOWN ON THE PLAN DETAILS. IF REQUIRED BY THE ENGINEER, THE CONTRACTOR SHALL SAW CUT THE HMA SURFACE TO CONFORM TO THE SHAPES AND DIMENSIONS SHOWN ON THE PLAN DETAILS. THIS WORK WILL BE INCLUDED IN THE COST OF THE HMA SURFACE.

THE ENGINEER WILL BE THE SOLE JUDGE CONCERNING CURING TIME FOR THE VARIOUS HMA LIFTS.

SEEDING WILL NOT BE PERMITTED AT ANY TIME WHEN THE GROUND IS FROZEN, WET, OR IN AN UNTILLABLE CONDITION. LOCATIONS TO BE SEEDED WILL BE DETERMINED BY THE ENGINEER.

THE FINISHED EARTHWORK SHALL HAVE A VEGETATION SUSTAINING SOIL COVERING THE TOP FOUR INCHES (100 MILLIMETERS) IN AREAS TO BE SEEDED OR SODDED. THE VEGETATION SUSTAINING SOIL REQUIRED WILL NOT BE PAID FOR SEPARATELY BUT WILL BE INCLUDED IN THE COST OF FURNISHED EXCAVATION.

ALL EXCAVATED MATERIAL, WHICH INCLUDES DIGGING OR GRADING OF ANY SOIL OR FILL MATERIAL, WITH THE EXCEPTION OF AGGREGATE FILLS, MUST BE INCORPORATED WITHIN THE IDOT RIGHT OF WAY DUE TO ENVIRONMENTAL DOCUMENTATION REQUIREMENTS.

ON EXISTING PAVEMENT WHICH MAY BE SUPERELEVATED, THE NEW HMA PAVEMENT SHALL BE BUILT WITH THE SAME SUPERELEVATION UNLESS NEW SUPERELEVATION RATES ARE GIVEN ON THE PLANS.

ANY REFERENCE TO A STANDARD IN THESE PLANS SHALL BE INTERPRETED TO MEAN THE EDITION AS INDICATED BY THE SUBNUMBER SHOWN IN THE LIST OF STANDARDS OR THE COPY INCLUDED IN THESE PLANS.

THE FOLLOWING RATES OF APPLICATION HAVE BEEN USED IN CALCULATING PLAN QUANTITIES:

GRANULAR MATERIALS	2.05	TONS / CU YD
HMA RESURFACING	112	LBS / SQ YD / IN
SHORT TERM PAVEMENT MARKING	10	FT / 100 FT OF APPLICATION
MIX FOR CRACKS, JTS & FLGWYS	0.0003	TONS / SQ YD
LEVEL BINDER (HAND METHOD)	0.0005	TONS / SQ YD
SUPPLEMENTAL WATERING	3	GAL / SQ YD / APPLICATION
CALCIUM CHLORIDE	2	LB / SQ YD / APPLICATION
AGGREGATE DITCH CHECKS	5	TONS AGGREGATE

THE CONTRACTOR SHALL CONTACT JULIE AT LEAST 48 HOURS PRIOR TO EXCAVATION TO DETERMINE WHICH UTILITIES ARE IN THE AREA.

COMMITMENTS:

STATE OF ILLINOIS
DEPARTMENT OF TRANSPORTATION
DISTRICT THREE

PREPARED BY: Don Bunnell
DISTRICT STUDIES & PLANS ENGINEER

DATE: 6-11-14

EXAMINED BY: Harold J. ...
DISTRICT CONSTRUCTION ENGINEER

Wayne Phillips
DISTRICT MATERIALS ENGINEER

Bruce A. ...
DISTRICT OPERATIONS ENGINEER

FILE NAME	USER NAME = carpenterdj	DESIGNED -	REVISED -	STATE OF ILLINOIS DEPARTMENT OF TRANSPORTATION	GENERAL NOTES	F.A.P. RTE.	SECTION	COUNTY	TOTAL SHEETS	SHEET NO.
ci:\pw_work\p\idat\carpenterdj\20140331\366A95-shit-cover.dgn	DRAWN -	REVISED -	332			(6,K-150)RS-3	KANKAKEE	16	2	
PLOT SCALE = 100.0000' / in.	CHECKED -	REVISED -	CONTRACT NO. 66A95							
PLOT DATE = 6/10/2014	DATE -	REVISED -	ILLINOIS FED. AID PROJECT							
					SCALE:	SHEET NO.	OF	SHEETS	STA.	TO STA.

CODE NO.	ITEM	UNIT	TOTAL QUANTITY	CONSTR. CODE	
				ROADWAY 0005	RURAL
20400800	FURNISHED EXCAVATION	CU YD	18	18	
25000200	SEEDING, CLASS 2	ACRE	0.14	0.14	
25000400	NITROGEN FERTILIZER NUTRIENT	POUND	13	13	
25000500	PHOSPHORUS FERTILIZER NUTRIENT	POUND	13	13	
25000600	POTASSIUM FERTILIZER NUTRIENT	POUND	13	13	
25100630	EROSION CONTROL BLANKET	SQ YD	645	645	
40200800	AGGREGATE SURFACE COURSE, TYPE B	TON	31	31	
40600400	MIXTURE FOR CRACKS, JOINTS, AND FLANGEWAYS	TON	20	20	
40600537	LEVELING BINDER (HAND METHOD), IL-9, 5FG, N70	TON	33	33	
40600637	LEVELING BINDER (MACHINE METHOD), IL-9, 5FG, N70	TON	2808	2808	
40600990	TEMPORARY RAMP	SQ YD	365	365	
40603340	HOT-MIX ASPHALT SURFACE COURSE, MIX "D", N70	TON	5616	5616	
40800050	INCIDENTAL HOT-MIX ASPHALT SURFACING	TON	909	909	
44000158	HOT-MIX ASPHALT SURFACE REMOVAL, 2 1/4"	SQ YD	70214	70214	

* SPECIALTY ITEMS

FILE NAME :	USER NAME :	DESIGNED :	REVISED :	STATE OF ILLINOIS DEPARTMENT OF TRANSPORTATION	SUMMARY OF QUANTITIES	F.A.P. RTE.	SECTION	COUNTY	TOTAL SHEETS	SHEET NO.	
c:\pwwork\pwwork\carpentendj\40240331\366A95-shr-cover.dgn		DRAWN :	REVISED :			332	16K-15dRS-3	KANKAKEE	16	3	
PLOT SCALE = 1/8" = 1' / 1/4"		CHECKED :	REVISED :			CONTRACT NO. 66A95					
PLOT DATE = 6/19/2014		DATE :	REVISED :			ILLINOIS FED. AID PROJECT					

405 01 100

CODE NO.	ITEM	UNIT	TOTAL QUANTITY	CONSTR. CODE	
				ROADWAY	100% STATE
				0005	RURAL
78006180	PREFORMED THERMOPLASTIC PAVEMENT MARKING - LINE 24"	FOOT	36	36	
78009004	MODIFIED URETHANE PAVEMENT MARKING - LINE 4"	FOOT	64365	64365	
78009006	MODIFIED URETHANE PAVEMENT MARKING - LINE 6"	FOOT	5497	5497	
78009008	MODIFIED URETHANE PAVEMENT MARKING - LINE 8"	FOOT	789	789	
78009012	MODIFIED URETHANE PAVEMENT MARKING - LINE 12"	FOOT	348	348	
78100100	RAISED REFLECTIVE PAVEMENT MARKER	EACH	392	392	
78300200	RAISED REFLECTIVE PAVEMENT MARKER REMOVAL	EACH	392	392	
X4060110	BITUMINOUS MATERIALS (PRIME COAT)	POUND	47395	47395	
Z0030850	TEMPORARY INFORMATION SIGNING	SQ FT	42	42	
Z0034105	MATERIAL TRANSFER DEVICE	TON	8424	8424	

10
 • SPECIALTY ITEMS

FILE NAME =	USER NAME = oerpanterdj	DESIGNED -	REVISED -	STATE OF ILLINOIS DEPARTMENT OF TRANSPORTATION	SUMMARY OF QUANTITIES	F.A.P. RTE.	SECTION	COUNTY	TOTAL SHEETS	SHEET NO.
c:\pwork\pvidot\oerpanterdj\0240331\366A95-shs-cover.dgn	DRAWN -	REVISED -	332			(6X-15)RS-3	KANKAKEE	16	5	
PLOT SCALE = 100.0000 1/16"	CHECKED -	REVISED -	CONTRACT NO. 66A95							
#MODELNAME#	DATE -	REVISED -	ILLINOIS FED. AID PROJECT							
				SCALE:	SHEET OF SHEETS	STA. TO STA.				

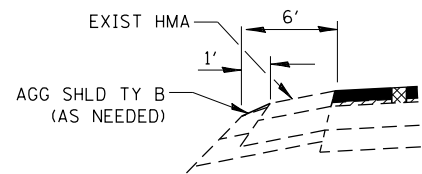

CONTINUOUS MAILBOX TURNOUT
LEFT SIDE ONLY
STA. 586+66 TO STA. 601+00
STA. 622+09 TO STA. 648+85

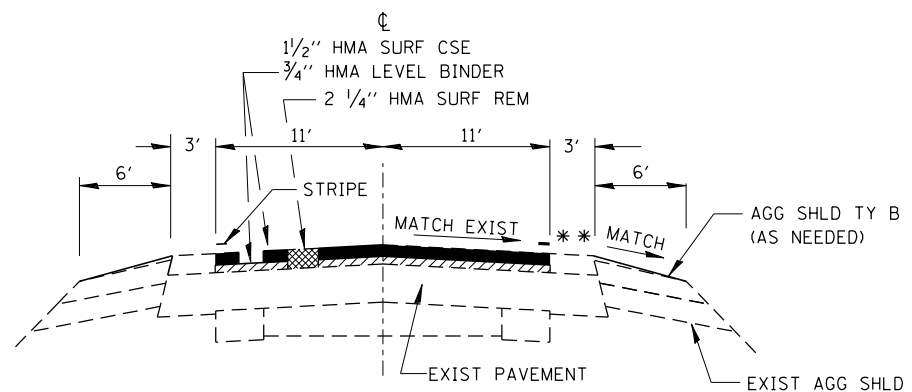

TYPICAL SECTION
STA. 481+38.38 TO STA. 603+29
STA. 622+09 TO STA. 732+50

* OR MATCH EXIST. SUPERELEVATION SLOPE
** SEE RIGHT TURN LANE DETAIL STA. 600+99 TO STA. 603+29

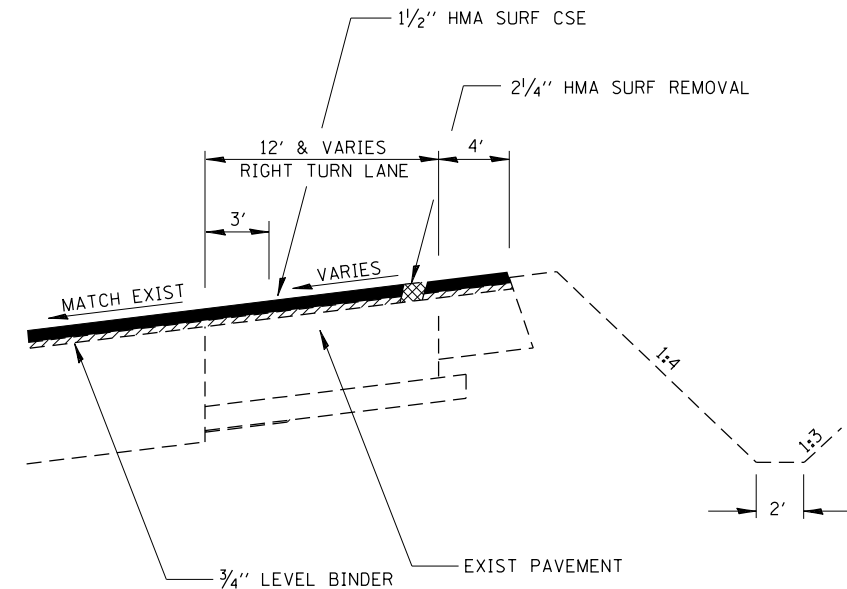

RIGHT TURN LANE DETAIL
STA. 600+99 TO STA. 608+41

MIX DESIGN					
MIX	PG GRADE **	DESIGN AIR VOIDS	MIX COMPOSITION	FRICTION AGG	DENSITY CONTROL
HOT-MIX ASPHALT SURFACE COURSE	PG 64-22	4.0% @N70	IL 9.5	MIXTURE D	CORRELATION
LEVELING BINDER	PG 64-22	4.0% @N70	IL 9.5 FG		CORRELATION

** WHEN RAP/RAS ABR EXCEEDS 20%, THE HIGH AND LOW VIRGIN ASPHALT BINDER GRADES SHALL EACH BE REDUCED BY ONE GRADE (EXAMPLE: 25% ABR WOULD REQUIRE A VIRGIN ASPHALT BINDER GRADE OF PG 64-22 TO BE REDUCED TO PG 58-28).

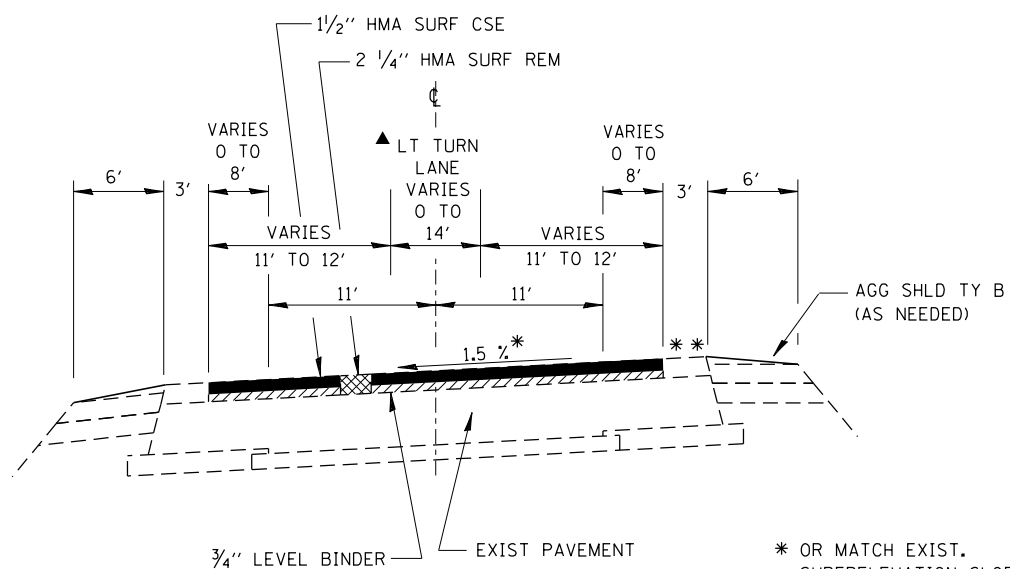

TYPICAL SECTION
STA. 603+29 TO STA. 622+09

* OR MATCH EXIST. SUPERELEVATION SLOPE
** SEE RIGHT TURN LANE DETAIL STA. 603+29 TO STA. 608+41
▲ LEFT TURN LANE STA. 610+79 TO STA. 621+09

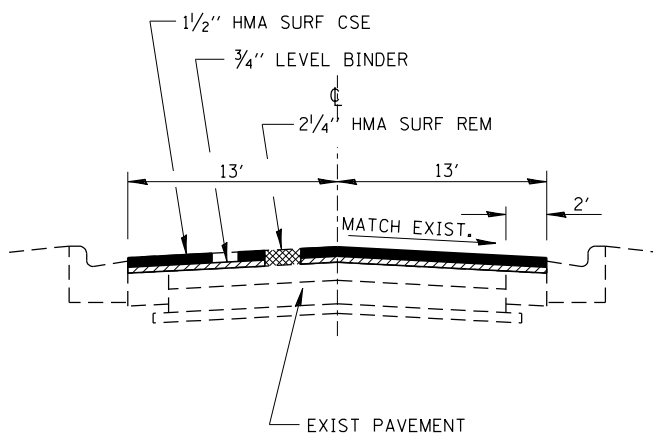

TYPICAL SECTION
STA. 732+50 TO STA. 738+99.7

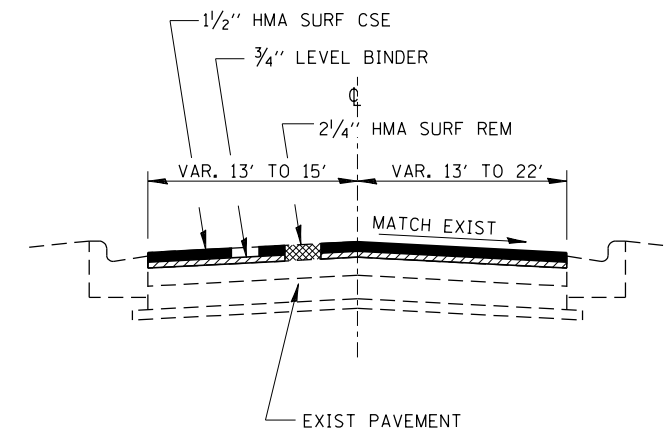

TYPICAL SECTION
STA. 738+99.7 TO STA. 740+37.8

FILE NAME =	USER NAME = carpenterdj	DESIGNED -	REVISED -
ei:\pwork\pwork\carpenterdj\d0248331\0366A95-shd-details.dgn		DRAWN -	REVISED -
	PLOT SCALE = 1/31.233' / in.	CHECKED -	REVISED -
	PLOT DATE = 6/10/2014	DATE -	REVISED -

STATE OF ILLINOIS
DEPARTMENT OF TRANSPORTATION

TYPICAL SECTIONS			
SCALE:	SHEET	OF SHEETS	STA. TO STA.

F.A.P. RTE.	SECTION	COUNTY	TOTAL SHEETS	SHEET NO.
332	(6,K-15d)RS-3	KANKAKEE	16	6
CONTRACT NO. 66A95				
ILLINOIS FED. AID PROJECT				

PAVEMENT MARKING SCHEDULE													
LOCATION	LENGTH	URETHANE PVMT MARK 4"		URETHANE PVMT MARK 6"	URETHANE PVMT MARK 8"	URETHANE PVMT MARK 12"		PREFORMED THERMO PVMT MARK 24"	PREFORMED THERMO PVMT MARK LETTERS & SYMB	RAISED REFLECT PVMT MARK REM	RAISED REFLECT PVMT MARK	SHORT TERM PVMT MARK	WORK ZONE PVMT MARK REM
		WHITE FOOT	YELLOW FOOT	YELLOW FOOT	WHITE FOOT	WHITE FOOT	YELLOW FOOT	WHITE FOOT	SQ FT	EACH	EACH	FOOT	SQ FT
481+38.38 TO 600+98.57	11960.19	23920.38		2990						151	151	3588	398
600+98.57 TO 622+26.19	2127.62	4255.24	5774		788.5	26	322	36	78	91	91	638	71
622+26.19 TO 732+49.78	11023.59	22047.18	5335	2477						139	139	3307	367
732+49.78 TO 740+37.83	788.05	1576.1	1457	30						11	11	236	26
SUB TOTAL		51798.9	12566			26	322						
TOTAL		64365		5497	789		348	36	78	392	392	7769	862

TEMPORARY PAVEMENT MARKING SCHEDULE									
LOCATION	LENGTH	TEMP PVMT MARK 4"		TEMP PVMT MARK 6"	TEMP PVMT MARK 8"	TEMP PVMT MARK 12"		TEMP PVMT MARK 24"	TEMP PVMT MARK LETTERS & SYMB
		WHITE FOOT	YELLOW FOOT	YELLOW FOOT	WHITE FOOT	WHITE FOOT	YELLOW FOOT	WHITE FOOT	SQ FT
481+38.38 TO 600+98.57	11960.19	23920.38		2990					
600+98.57 TO 622+26.19	2127.62	4255.24	5774		789	26	322	36	94
622+26.19 TO 732+49.78	11023.59	22047.18	5335	2477					
732+49.78 TO 740+37.83	788.05	1576.1	1457	30					
SUB TOTAL		51798.9	12566	5497		26	322	36	
PROJECT TOTAL		64365		5497	789		348	36	94

MAINLINE SCHEDULE										
LOCATION	LENGTH	PVMT AREA	HMA SURF CSE	LEVEL BINDER (MM)	HMA SURF REM 2 1/4"	TEMP RAMP	BIT MAT (PR CT)	MIX FOR CRACKS, JOINTS & FLGWYS	LEVEL BINDER (HM)	AGG SHLD TY B
STA TO STA	FOOT	SQ YD	TON	TON	SQ YD	SQ YD	POUNDS	TON	TON	TON
481+38.38 TO 600+99	11960.62	29237.1	2455.9	1228.0	29237.1	12.2	19735	8.77	14.62	454.1
600+99 TO 603+29	230	856.1	71.9	36.0	856.1		578	0.26	0.43	8.7
603+29 TO 608+41	512	2161.8	181.6	90.8	2161.8		1459	0.65	1.08	19.4
608+41 TO 609+79	138	582.7	48.9	24.5	582.7		393	0.17	0.29	5.2
609+79 TO 610+79	100	333.3	28.0	14.0	333.3		225	0.1	0.17	3.8
610+79 TO 613+24	245	816.7	68.6	34.3	816.7		551	0.25	0.41	9.3
613+24 TO 617+59	435	1836.7	154.3	77.1	1836.7		1240	0.55	0.92	16.5
617+59 TO 621+10	351	1170.0	98.3	49.1	1170.0		790	0.35	0.59	13.3
621+10 TO 622+10	100	322.2	27.1	13.5	322.2		217	0.1	0.16	3.8
622+10 TO 731+50	10940	26742.2	2246.3	1123.2	26742.2		18051	8.02	13.37	415.3
731+50 TO 732+50	100	244.4	20.5	10.3	244.4		165	0.07	0.12	3.8
HISTORICAL MARKER	145	193.3	16.2	8.1	193.3		130			5.5
732+50 TO 739+00	650	1877.8	157.7	78.9	1877.8		1268	0.56	0.94	
739+00 TO 740+37.83	137.83	482.4	40.5	20.3	482.4	20.6	326	0.14	0.24	
TOTAL			5616	2808	66857	33	45128	20	33	959

SIDEROAD AND ENTRANCE SCHEDULE										
STA	SIDE	SIDEROAD OR DESCRIPTION	EXIST MAT	WIDTH	AREA	INC HMA SURF	BIT MAT (PR CT)	TEMP RAMP	HMA SURF REM 2 1/4"	AGG SURF CSE
				FOOT	SQ YD	TON	POUND	SQ YD	SQ YD	TON
482+90	RT	PE	HMA	32.8	48	6.0	32.4		48.0	
484+44	RT	PE	AGG	32.8	48	6.0				0.8
490+70	LT	FE		16						
493+08	RT	FE		18						
505+05	RT	FE		16						
506+66	LT	8500 E RD	HMA	52.5	218	27.5	147.2	29.2	218.0	
506+66	RT	8250 E RD	HMA	42.6	185	23.3	124.9	23.7	185.0	
508+25	LT	PE	HMA	62	80	10.1	54.0		80.0	
519+87	LT	FE		22						
519+87	RT	FE		18						
520+79	RT	MBTO	HMA		35					
520+79	RT	PE	HMA/AGG	36	51	6.4	34.4		51.0	0.9
525+94	RT	PE	HMA/AGG	49	66	8.3	44.6		66.0	1.2
526+29	LT	FE		16						
546+17	LT	FE		18.7						
548+94	RT	FE		18						
551+36	RT	PE	HMA/AGG	29.5	67	8.4	45.2		67.0	0.7
551+36	RT	MBTO	HMA		35					
559+88	LT	9500 E RD	HMA	39.4	174	21.9	117.5	21.9	174.0	
559+88	RT	9250 E RD	HMA	42.7	185	23.3	124.9	23.7	185.0	
571+83	RT	PE	HMA/AGG	49	35	4.4	23.6		35.0	1.2
571+88	LT	MBTO	HMA	32.8	48					
571+88	LT	PE	HMA/AGG	49	66	8.3	44.6		66.0	1.2
578+65	LT	FE		13						
578+65	RT	FE		15.4						
586+66	LT	10000 E RD	HMA	36.1	163	20.5	110.0	20.1	163.0	
586+84 TO 602+17	LT	MBTO	HMA		949					
589+24	LT	PE	AGG	26.2	13	1.6				0.6
590+50	LT	PE	AGG	26.2	13	1.6				0.6
591+47	LT	PE	AGG	29.5	15	1.9				0.7
592+53	LT	PE	AGG	19.7	11	1.4				0.5
593+54	RT	FE		15.1						
593+79	LT	PE	AGG	23	12	1.5				0.5
594+84	LT	PE	AGG	26.2	13	1.6				0.6
595+68	LT	PE	AGG	23	12	1.5				0.5
596+16	LT	PE	AGG	23	12	1.5				0.5
597+61	LT	PE	AGG	23	12	1.5				0.5
598+48	LT	PE	HMA	19.7	11	1.4	7.4		11.0	
599+71	LT	PE	AGG	23	12	1.5				0.5
601+00	LT	PE	HMA	29.5	15	1.9	10.1		15.0	
608+42	RT	CH 2	HMA	65.6	262	33.0	176.9	36.4	262.0	
613+84	RT	CH 33	HMA	59	240	30.2	162.0	32.8	240.0	
620+27	LT	PE	AGG	23	37	4.7				0.5
620+16 TO 662+04	LT	MBTO	HMA		2760	347.8				
620+91	LT	PE	AGG	32.8	16	2.0				0.8
621+46	RT	PE	AGG	29.5	15	1.9				0.7
623+20	LT	PE	AGG	29.5	15	1.9				0.7
626+50	LT	PE	AGG	26.2	13	1.6				0.6
628+00	LT	PE	AGG	26.2	13	1.6				0.6
628+67	LT	PE	AGG	29.5	15	1.9				0.7
629+00	LT	PE	AGG	26.2	13	1.6				0.6
630+50	LT	PE	AGG	29.5	15	1.9				0.7
630+72	LT	PE	AGG	32.8	16	2.0				0.8
632+62	LT	PE	AGG	23	12	1.5				0.5
632+90	LT	PE	AGG	23	12	1.5				0.5
634+26	LT	PE	AGG	29.5	15	1.9				0.7
635+30	RT	FE								
635+60	LT	PE	AGG	29.5	15	1.9				0.7
636+95	LT	PE	HMA	23	12	1.5	8.1		12.0	
		SUBTOTAL				634	1268	188	1878	21

SIDEROAD AND ENTRANCE SCHEDULE (CONTINUED)										
STA	SIDE	SIDEROAD OR DESCRIPTION	WIDTH	AREA	INC HMA SURF	BIT MAT (PR CT)	TEMP RAMP	HMA SURF REM 2 1/4"	AGG SURF CSE	
			FOOT	SQ YD	TON	POUND	SQ YD	SQ YD	TON	
638+15	LT	PE	26	40	5.0					0.6
639+08	LT	PE	33	48	6.0					0.8
640+80	LT	PE	26							
641+80	LT	FE	18							
642+51	LT	PE	26							
644+66	LT	FE	19							
646+80	LT	PE	33	48	6.0					0.8
648+85	LT	PE	30	44	5.5					0.7
650+65	RT	PE	30	44	5.5					0.7
655+03	RT	PE	33	48	6.0	32.4			48	
657+61	RT	PE	52	69	8.7					1.2
659+22	RT	PE	30	44	5.5	29.7			44	
662+27	LT	1500 N RD	46	196	24.7	132.3	25.6		196	
662+27	RT	1500 N RD	43	186	23.4		23.9			1.0
667+10	LT	FE	12							
667+10	RT	FE	13							
668+50	LT	PE	33							
668+50	LT	MBTO	0	11						
670+60	LT	PE	28	42	5.3					0.7
675+61	LT	FE	15							
675+61	RT	FE	16							
679+02	LT	PE	33	153	19.3	103.3			153	
679+02	LT	MBTO	0	11						
680+16	LT	CE	39	54	6.8					0.9
680+16	LT	MBTO	0	11						
688+21	RT	PE	26	40	5.0					0.6
689+01	LT	FE	26							
689+33	RT	CE	46	62	7.8					1.1
693+56	RT	CE	49	66	8.3	44.6			66	
703+98	RT	FE	18							
703+98	LT	INDIANA ST	39	173	21.8	116.8	21.7		173	
707+88	LT	PE	49	66	8.3					1.2
721+42	LT	RIVER SOUTH RD	75	293	36.9	197.8	41.7		293	
721+42	RT	FE	18							
724+33	RT	HISTORICAL MARKER	16	199	25.1	134.3	8.9		199	
727+12	RT	CE	39	54	6.8	36.5			54	
728+40	RT	CE	62	80	10.1	54.0			80	
731+00	RT	CE	56							
732+99	RT	ALLEY	26							
734+92	RT	HARVARD ST	39	173	21.8	116.8	21.7		173	
		SUBTOTAL			275	999	144		1479	10
		TOTAL			909	2267	332		3357	31

FOLDER 1-16				CONTRACT NO. 66A95	
ILL RTE 1	WEST OF IL 114 IN MOMENCE TO 0.7 MI E OF IL 1 (S)			KANKAKEE COUNTY	
GPS POINT NUMBER OR INDEX NUMBER	DESCRIPTION	EXISTING MONUMENT TYPE	EXISTING MONUMENT TYPE	EXISTING MONUMENT TYPE	RESPONSIBILITY
170201	W QTR COR SEC 36-31-13E OF THE 3RD PM UNVERIFIED CORNER. BRASS DISK SET DURING LAST RESURFACING SHOULD NOT HAVE BEEN SET. RESET WITH PK NAIL.	BRASS PLUG	PK NAIL	NO	2
	RE IS TO CONTACT PLATS AND PLANS TO SET PK NAIL AFTER RESURFACE				
<p>THIS NOTE TO BE INCLUDED IN PLANS: LISTED MONUMENT LOCATIONS HAVE BEEN RECORDED BY GPS. PRE CONSTRUCTION TIES BY THE R.E. ARE NOT REQUIRED. IF AN UNLISTED MONUMENT IS FOUND, IT MUST BE TIED BY THE R.E. AND BROUGHT TO THE ATTENTION OF THE PLATS AND PLANS MANAGER. AFTER RESURFACING, THE R.E. IS TO CONTACT THE PLATS AND PLANS MANAGER TO ESTABLISH LOCATIONS FOR PERMANENT SURVEY MARKER CORING.</p> <p>RESPONSIBILITY: 1) RESIDENT TO RE-ESTABLISH MONUMENT (PAY ITEM REQUIRED. PERMANENT SURVEY MARKER, TYPE 1) 2) PLATS AND PLANS TO RE-ESTABLISH MONUMENT</p>					

DELINEATOR SCHEDULE		
LOCATIONS	LENGTH	EACH
603+29 TO 618+99 RT	1570	24
707+85 TO 716+97 LT	912	16
TOTAL		40

SEEDING SCHEDULE								
SIDEROAD OR DESCRIPTION	STATION	SIDE	SEEDING	FURN	EROSION	NIT	PHOS	POT
			CL 2	EXC	CONTROL	FERT	FERT	FERT
			ACRE	CU YD	BLANKET	NUT	NUT	NUT
					SQ YD	LB	LB	LB
8500 E RD	506+59.45	LT	0.01	1.5	52	0.9	0.9	0.9
8250 E RD	506+59.45	RT	0.01	1.5	52	0.9	0.9	0.9
9500 E RD	559+87.53	LT	0.01	0.8	28	0.9	0.9	0.9
9250 E RD	559+87.53	RT	0.01	0.8	28	0.9	0.9	0.9
CH 2	608+39.9	RT	0.02	3.1	110	1.8	1.8	1.8
CH 33	613+91.08	RT	0.02	2.4	87	1.8	1.8	1.8
1500 N RD	662+27.04	LT	0.01	0.8	28	0.9	0.9	0.9
1500 N RD	662+27.04	RT	0.01	1.5	52	0.9	0.9	0.9
INDIANA ST	703+96.98	LT	0.01	1.5	52	0.9	0.9	0.9
RIVER SOUTH RD	721+25.99	LT	0.01	1.5	52	0.9	0.9	0.9
HUBBARD TRAIL	724+40.95	RT	0.01	1.5	52	0.9	0.9	0.9
HARVARD ST	735+00.66	RT	0.01	1.5	52	0.9	0.9	0.9
TOTAL			0.14	18.4	645	12.6	12.6	12.6

DETAIL

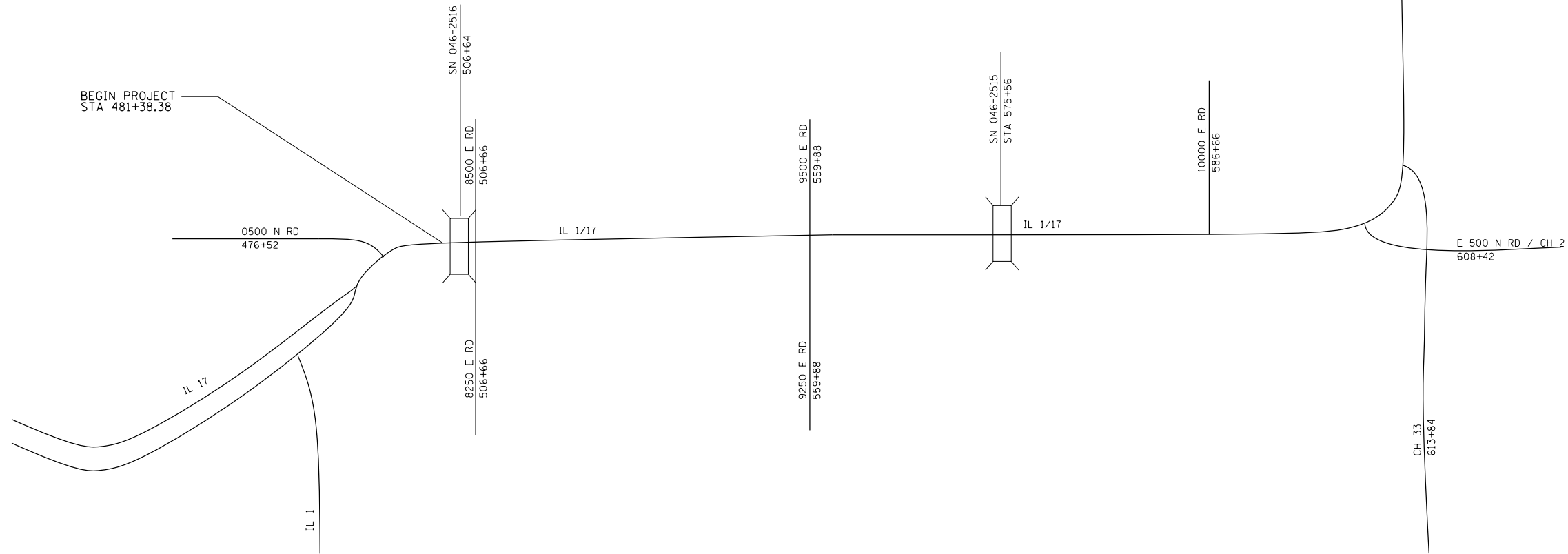
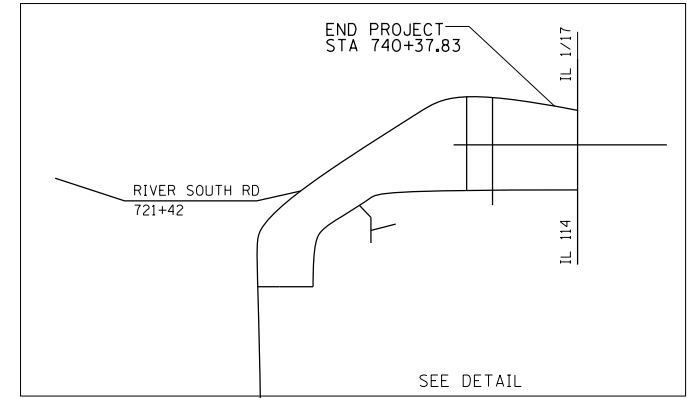
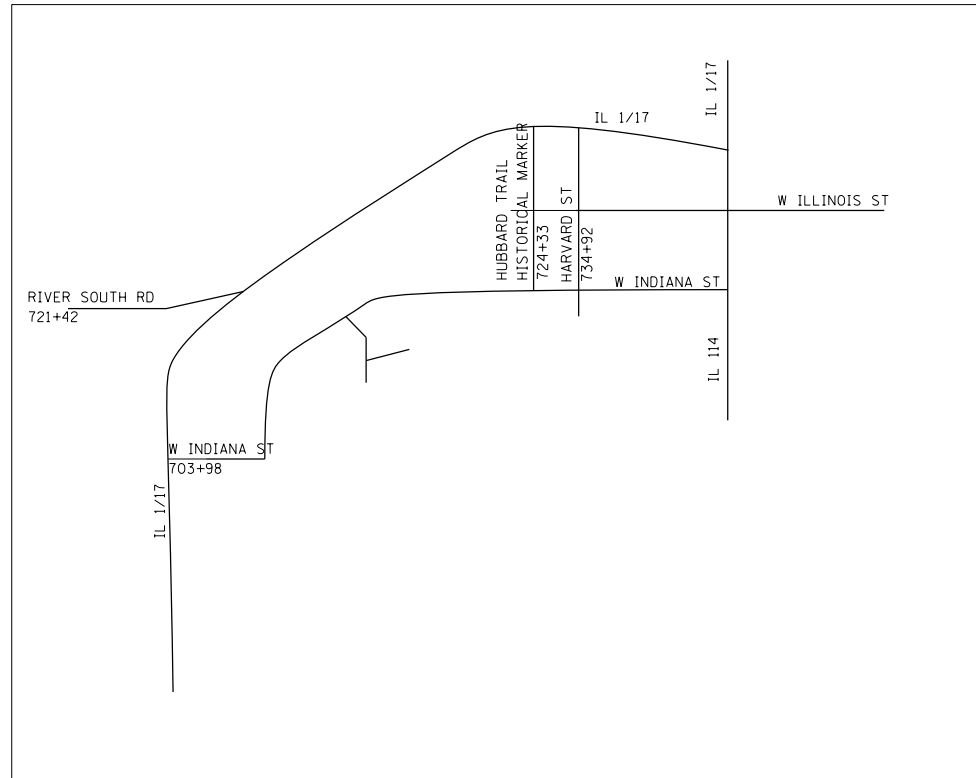

FILE NAME =	USER NAME = carpenterdj	DESIGNED -	REVISED -
c:\pw\work\p\dot\carpenterdj\d0248331\0366A95-shd-details.dgn		DRAWN -	REVISED -
	PLOT SCALE = 131.233 ' / in.	CHECKED -	REVISED -
	PLOT DATE = 6/10/2014	DATE -	REVISED -

STATE OF ILLINOIS
DEPARTMENT OF TRANSPORTATION

PROJECT LAYOUT

SCALE: SHEET OF SHEETS STA. TO STA.

F.A.P. RTE.	SECTION	COUNTY	TOTAL SHEETS	SHEET NO.
332	(6,K-15d)RS-3	KANKAKEE	16	10
CONTRACT NO. 66A95			ILLINOIS FED. AID PROJECT	

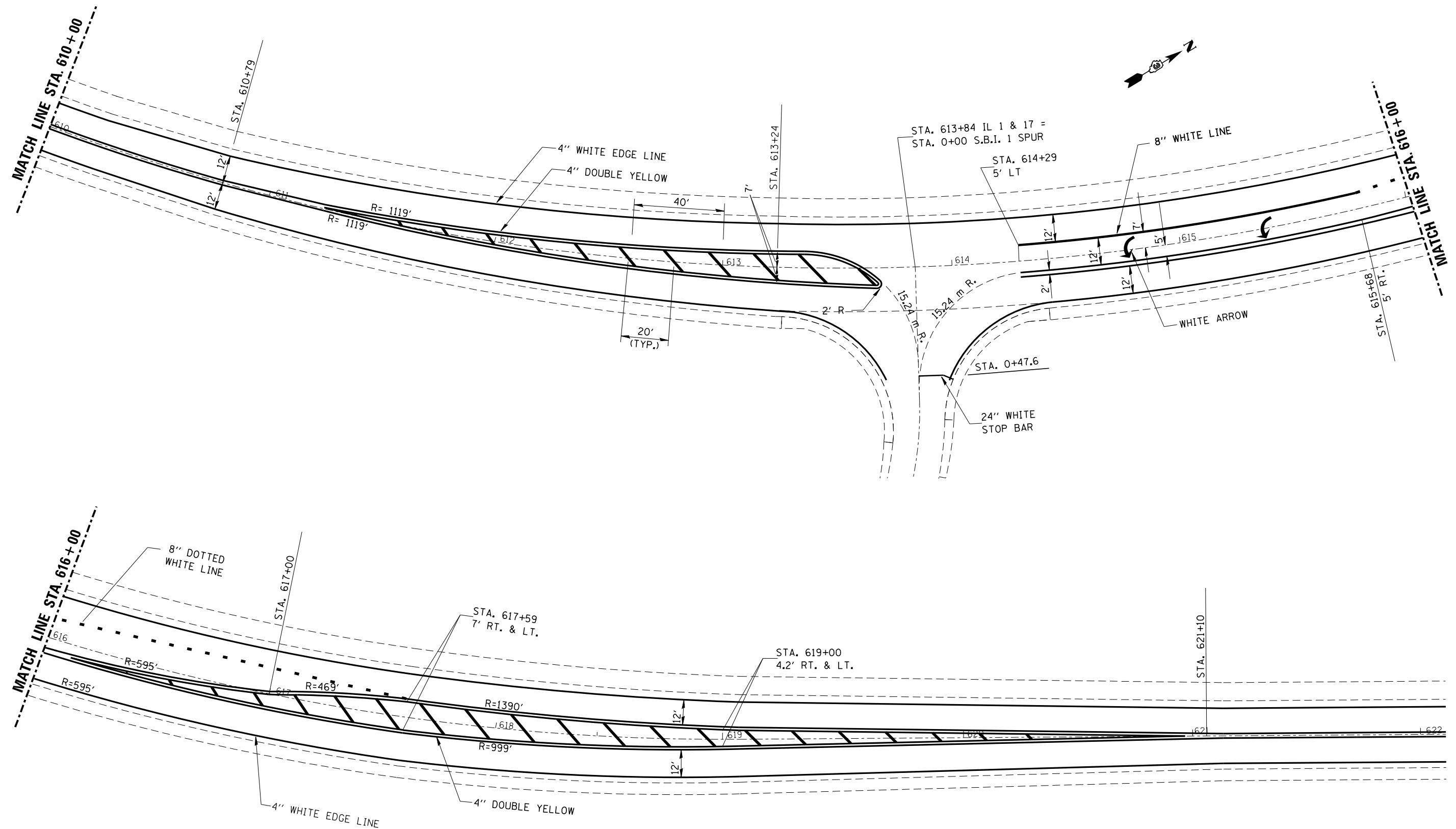

FILE NAME =	USER NAME = carpenterdj	DESIGNED -	REVISED -
c:\pwork\pwork\carpenterdj\d0248331\0366A95-sheets.dgn		DRAWN -	REVISED -
	PLOT SCALE = 42.651' / in.	CHECKED -	REVISED -
	PLOT DATE = 6/10/2014	DATE -	REVISED -

**STATE OF ILLINOIS
DEPARTMENT OF TRANSPORTATION**

**PAVEMENT MARKING DETAILS
STA 610+00 TO STA 622+00**

SCALE: SHEET OF SHEETS STA. TO STA.

F.A.P. RTE.	SECTION	COUNTY	TOTAL SHEETS	SHEET NO.
332	(6,K-15d)RS-3	KANKAKEE	16	11
ILLINOIS FED. AID PROJECT			CONTRACT NO. 66A95	

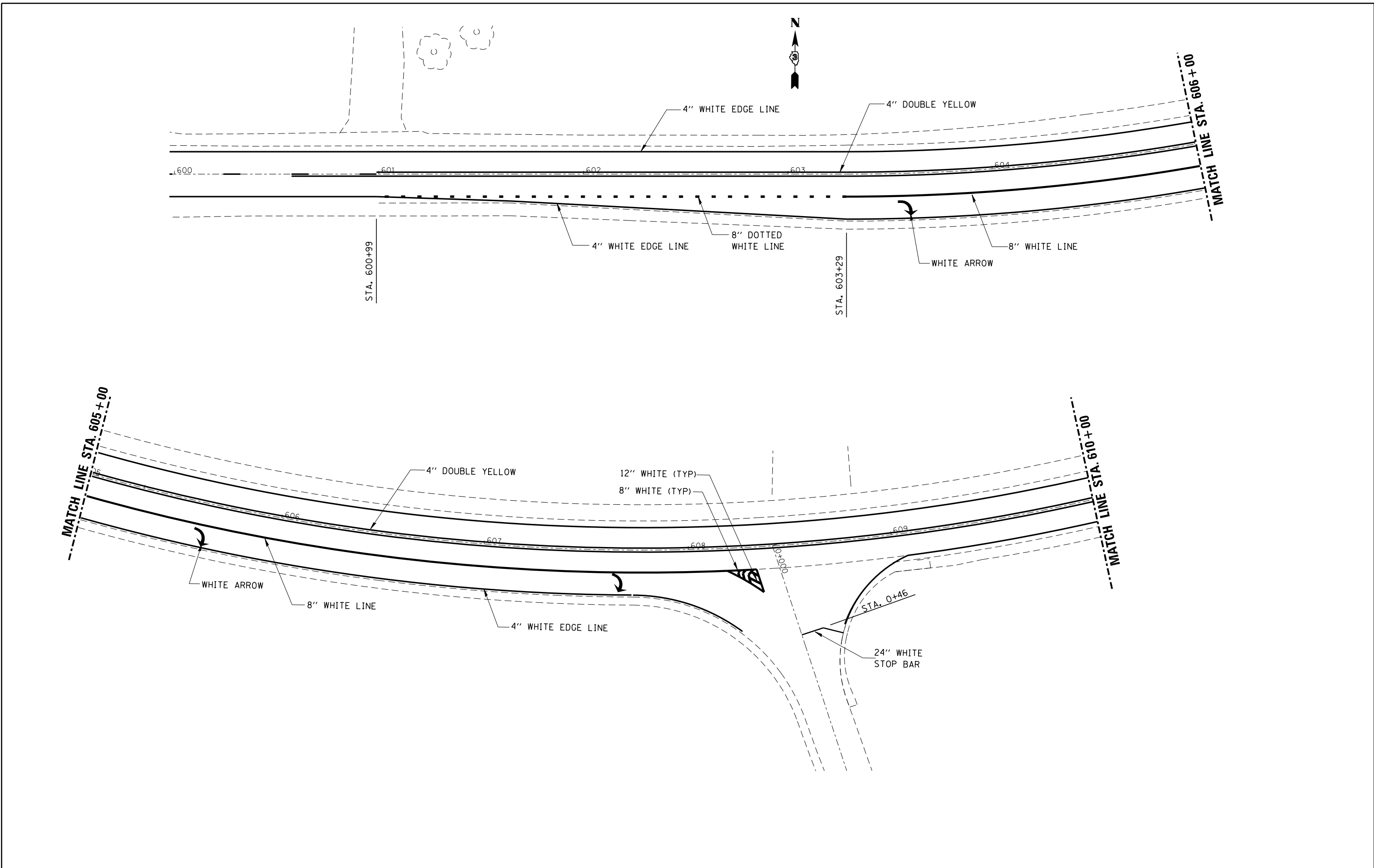

FILE NAME =	USER NAME = carpenterdj	DESIGNED -	REVISED -
c:\pwork\pwork\carpenterdj\0248331\0366A95-sheets.dgn		DRAWN -	REVISED -
	PLOT SCALE = 42.651' / in.	CHECKED -	REVISED -
	PLOT DATE = 6/10/2014	DATE -	REVISED -

**STATE OF ILLINOIS
DEPARTMENT OF TRANSPORTATION**

**PAVEMENT MARKING DETAILS
STA 600+00 TO STA 610+00**

SCALE: SHEET OF SHEETS STA. TO STA.

F.A.P. RTE.	SECTION	COUNTY	TOTAL SHEETS	SHEET NO.
332	(6,K-15d)RS-3	KANKAKEE	16	12
CONTRACT NO. 66A95				
ILLINOIS FED. AID PROJECT				

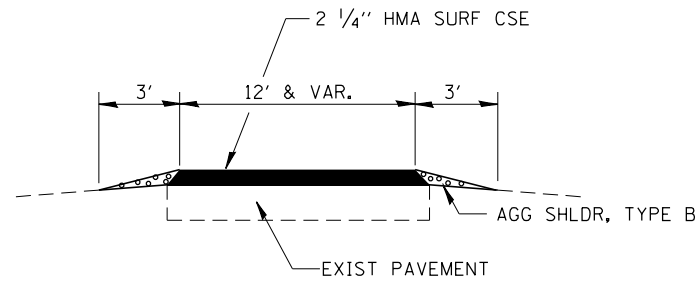

SEC. C-C

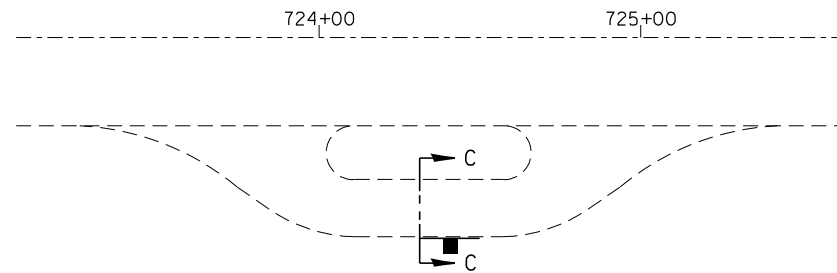

**TURNOUT FOR HISTORICAL MARKER
STA. 724 + 33 , 43' RT.**

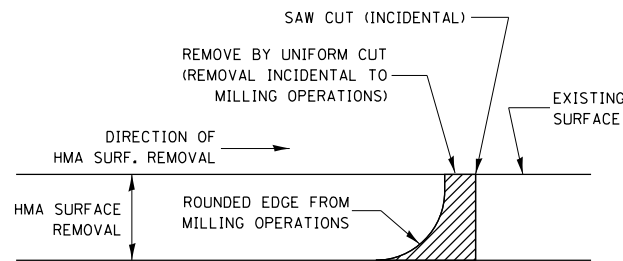

NOTE:
WHEN MILLING OPERATIONS PRODUCE A ROUNDED EDGE,
THEN A SAW CUT SHALL BE USED TO MANUFACTURE
A PERPENDICULAR EDGE AS SHOWN IN THE DETAIL.
THE ENGINEER SHALL BE THE SOLE JUDGE
CONCERNING THE USE OF THIS DETAIL

HMA DETAIL AT BUTT JOINTS

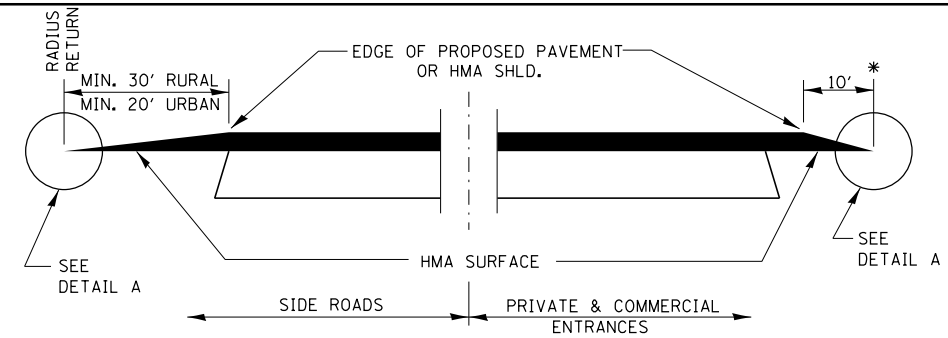

**SECTION A-A
DETAILS AT ENTRANCES & SIDE ROADS**

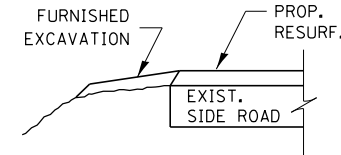

SECTION B-B

THE COST OF REMOVAL AT EXISTING HMA OR P.C.C. LOCATIONS SHALL BE PAID FOR PER SQ. YD. BY THE APPROPRIATE PAY ITEM. REMOVAL AT THE EXISTING AGG. LOCATIONS SHALL BE INCIDENTAL TO THE HMA. A-3 LOCATIONS SHALL BE FEATHER TAPERED.

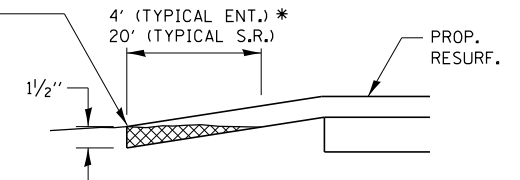

DETAIL A

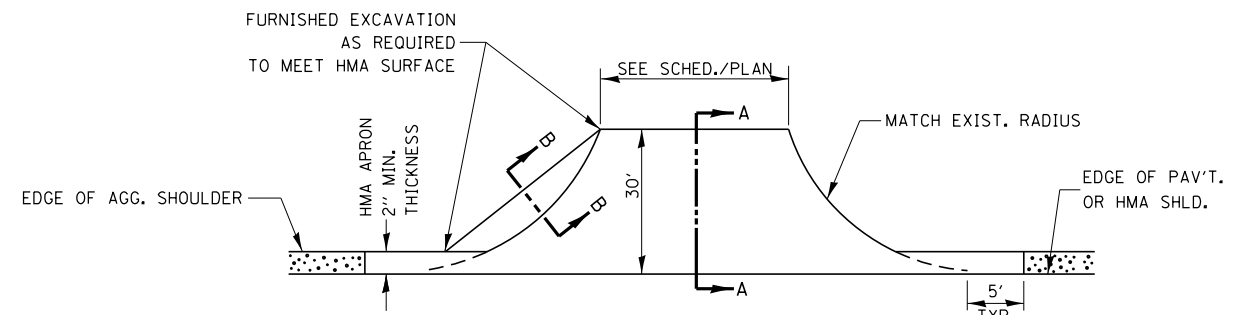

AGG. SHOULDER IS NOT TO BE PLACED AROUND SIDE ROAD RADII

PROP. HMA SHLD. SHALL NOT BE CONSTRUCTED THRU HMA SIDEROADS.

PLAN AT SIDE ROADS

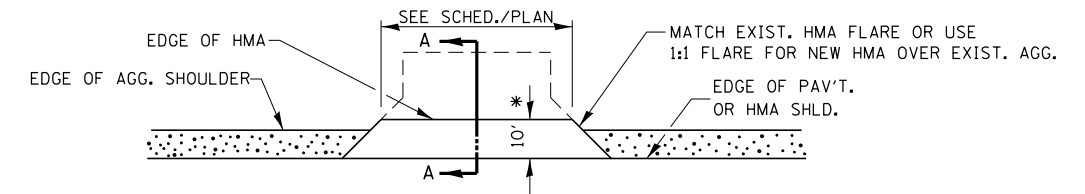

PLAN AT PRIVATE & COMMERCIAL ENTRANCES

(DO NOT RESURFACE FIELD ENTRANCES)

* PROPOSED HMA RESURFACING AT PUBLIC EDUCATIONAL FACILITY ENTRANCES SHALL BE EXTENDED TO THE RIGHT-OF-WAY LIMITS.

FILE NAME =	USER NAME = carpenterdj	DESIGNED -	REVISED -
ei:\pw\work\p\midot\carpenterdj\d0248331\0366A95-shd-details.dgn		DRAWN -	REVISED -
		CHECKED -	REVISED -
		DATE -	REVISED -

**STATE OF ILLINOIS
DEPARTMENT OF TRANSPORTATION**

DETAILS	
SCALE:	SHEET OF SHEETS STA. TO STA.

F.A.P. RTE.	SECTION	COUNTY	TOTAL SHEETS	SHEET NO.
332	(6,K-15d)RS-3	KANKAKEE	16	13
CONTRACT NO. 66A95				
ILLINOIS FED. AID PROJECT				

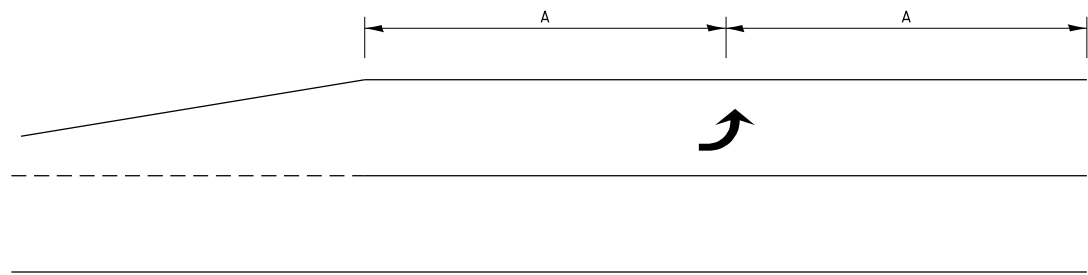

99' AND UNDER

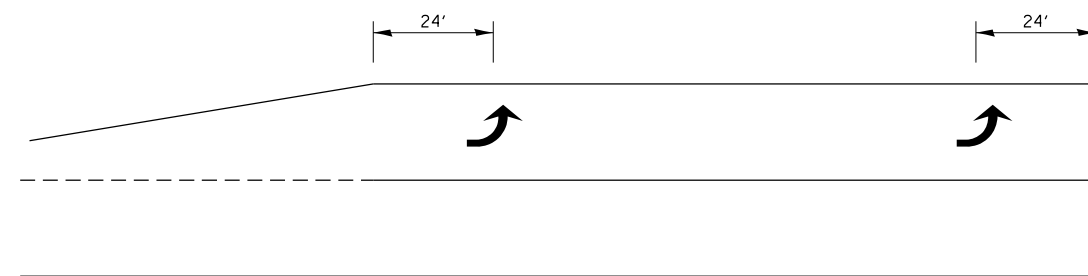

100' TO 149'

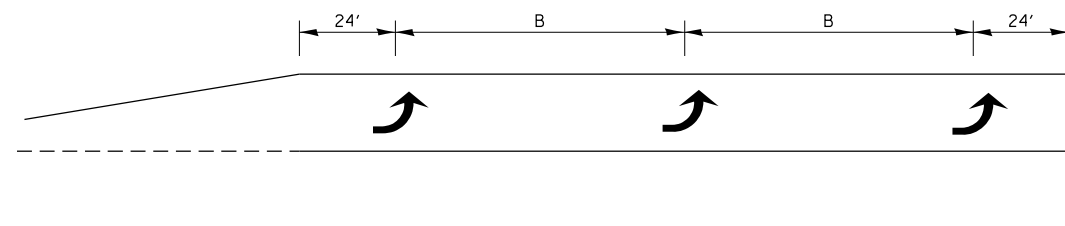

150' AND LONGER

**TYPICAL PLACEMENT OF ARROWS
IN TURN LANES**

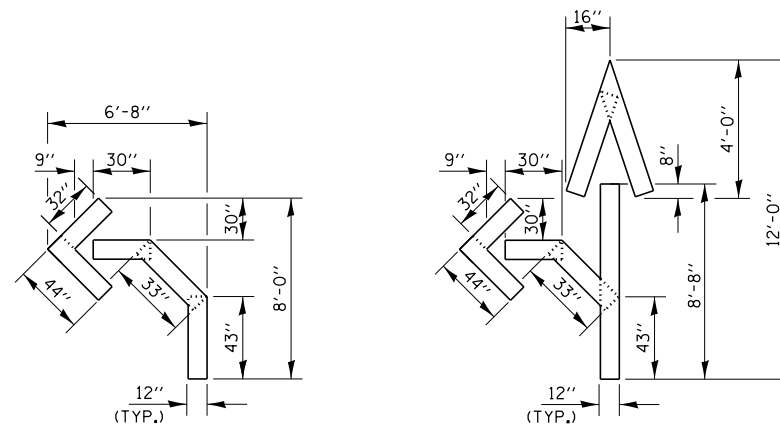

QUANTITY
12" LINE = 16 LIN. FT.
OR 4" LINE = 48 LIN. FT.

QUANTITY
12" LINE = 29 LIN. FT.
OR 4" LINE = 87 LIN. FT.

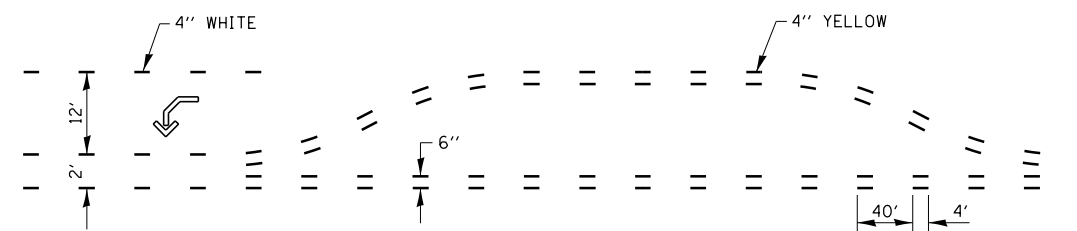

**SHORT-TERM PAVEMENT MARKING
FOR MEDIANS AND ARROWS**

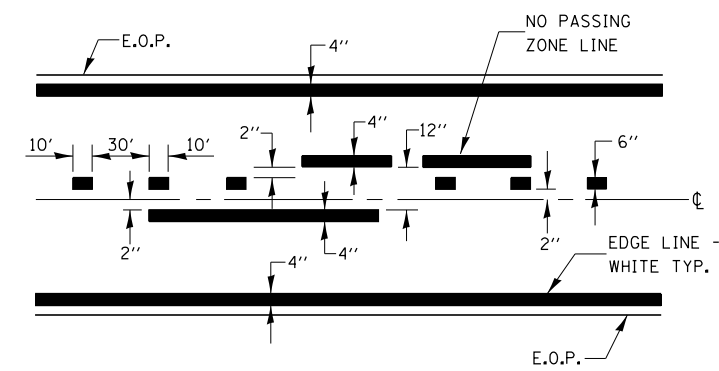

CENTERLINE & NO PASSING
ZONE LINES - YELLOW (SEE TYPICAL SECTIONS)

PAVEMENT MARKING

FILE NAME =	USER NAME = carpenterdj	DESIGNED -	REVISED -
ei:\pw_work\p\midot\carpenterdj\d0248331\0366A95-shr-details.dgn		DRAWN -	REVISED -
		CHECKED -	REVISED -
		DATE -	REVISED -

**STATE OF ILLINOIS
DEPARTMENT OF TRANSPORTATION**

DETAILS			
SCALE:	SHEET	OF SHEETS	STA. TO STA.

F.A.P. RTE.	SECTION	COUNTY	TOTAL SHEETS	SHEET NO.
332	(6,K-15d)RS-3	KANKAKEE	16	14
CONTRACT NO. 66A95				
ILLINOIS FED. AID PROJECT				

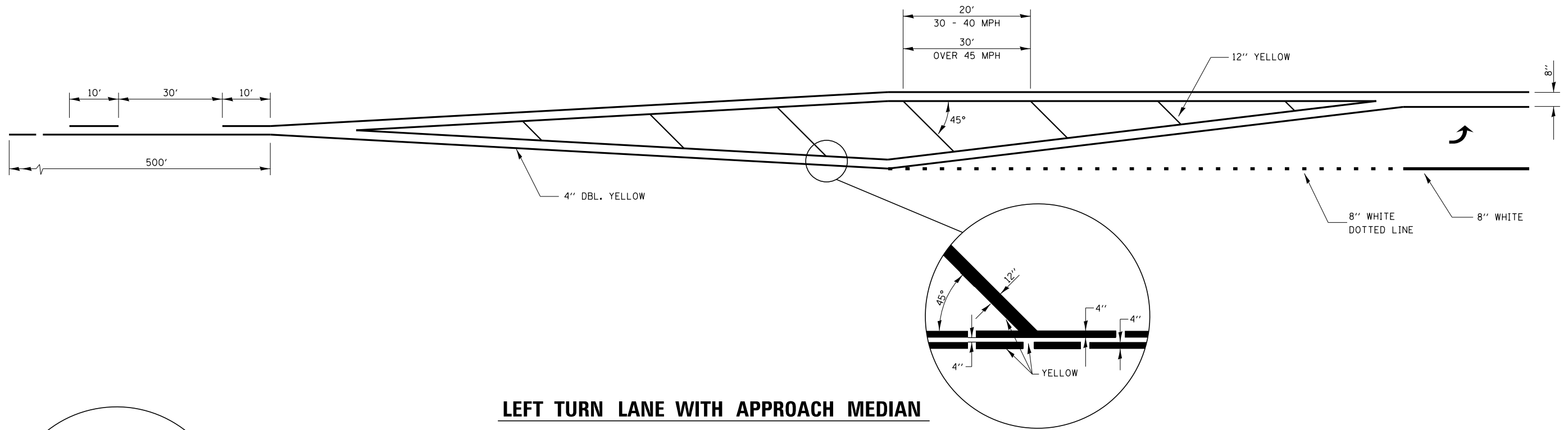

LEFT TURN LANE WITH APPROACH MEDIAN

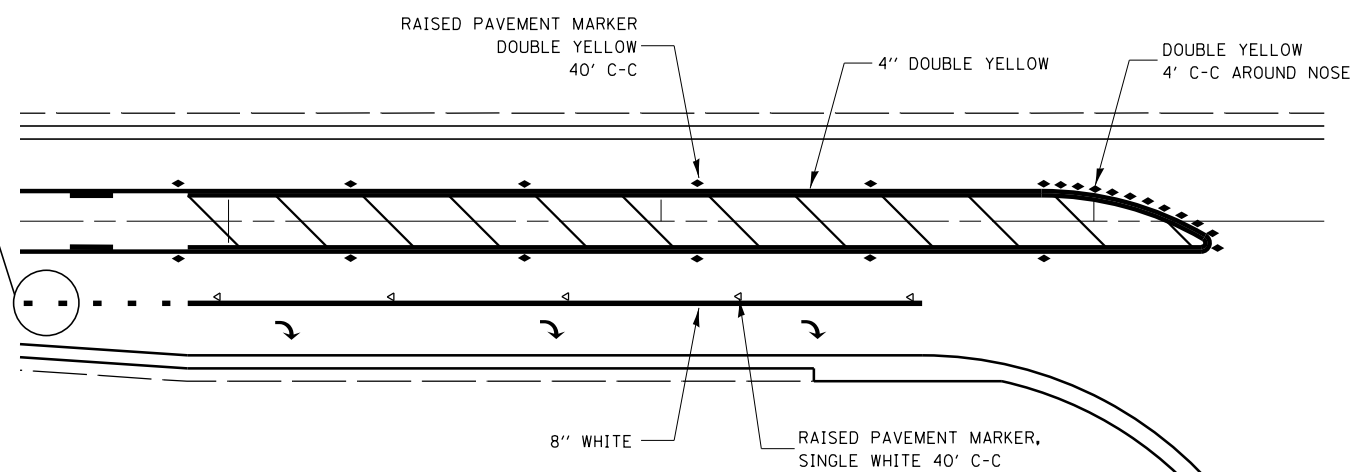
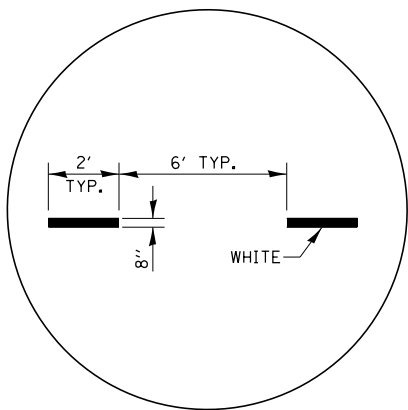

**RAISED REFLECTIVE AND PAVEMENT MARKERS
RIGHT TURN LANE**

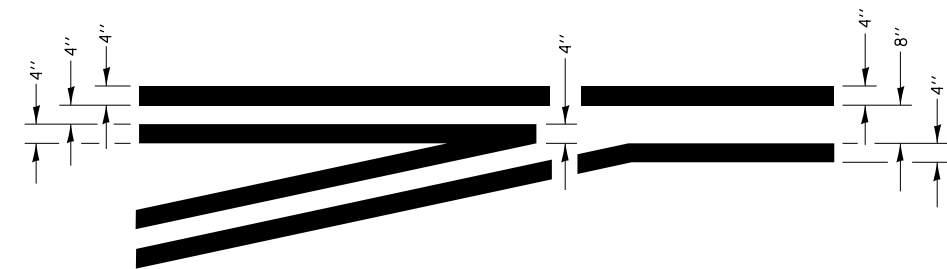

**TYPICAL APPLICATION
LEFT TURN LANES**

FILE NAME =	USER NAME = carpenterdj	DESIGNED -	REVISED -
ei:\pw\work\p\idot\carpenterdj\d0248331\0366A95-shr-details.dgn		DRAWN -	REVISED -
	PLOT SCALE = 328.083 ' / in.	CHECKED -	REVISED -
	PLOT DATE = 6/10/2014	DATE -	REVISED -

**STATE OF ILLINOIS
DEPARTMENT OF TRANSPORTATION**

DETAILS			
SCALE:	SHEET	OF SHEETS	STA. TO STA.

F.A.P. RTE.	SECTION	COUNTY	TOTAL SHEETS	SHEET NO.
332	(6,K-15d)RS-3	KANKAKEE	16	15
CONTRACT NO. 66A95				
ILLINOIS FED. AID PROJECT				

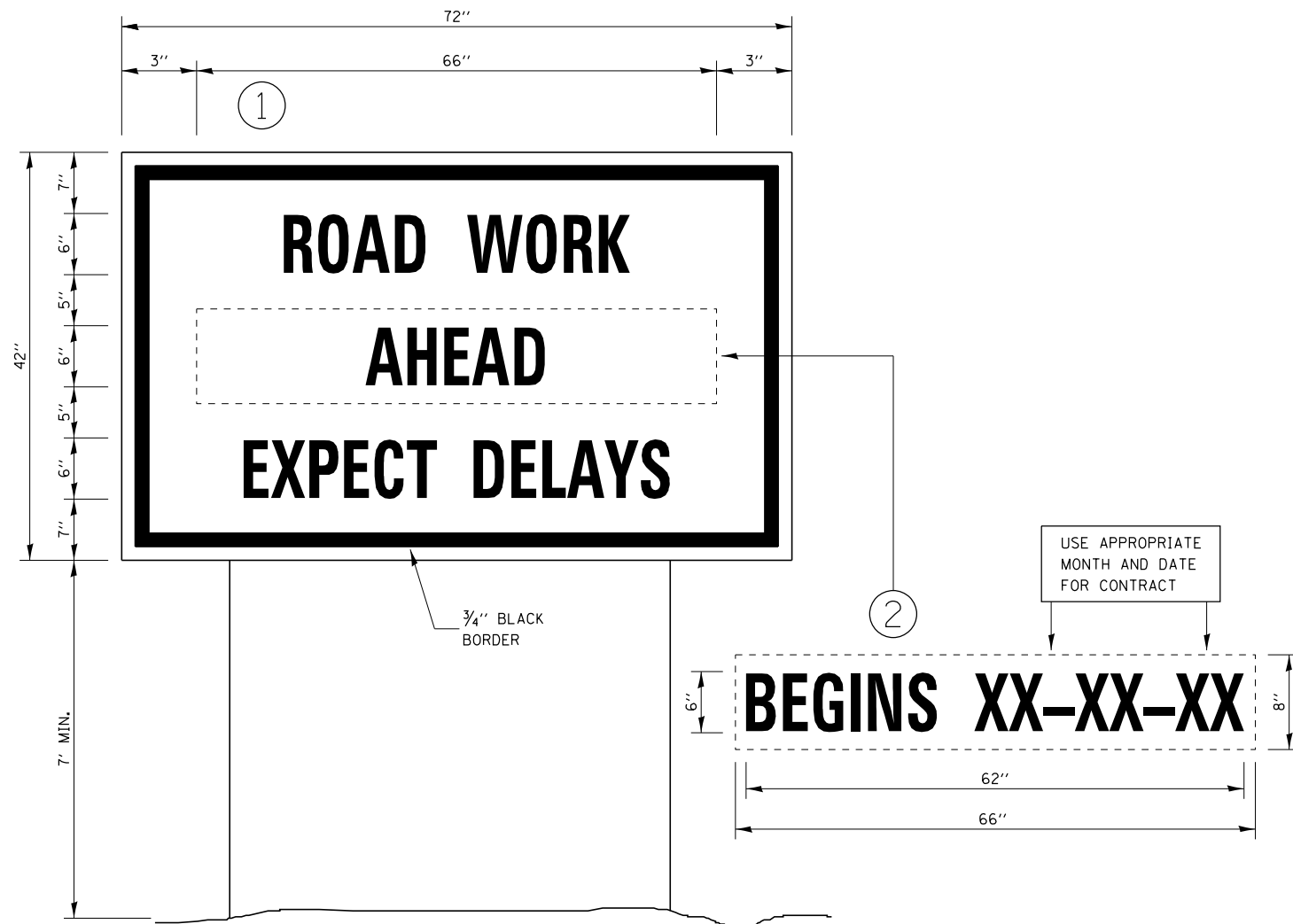

TEMPORARY INFORMATION SIGNING

NOTES:

1. USE 6" D BLACK LETTERING ON FLOURESENT ORANGE BACKGROUND.
2. ERECT SIGNS AT LOCATIONS IN ADVANCE OF THE "ROAD CONSTRUCTION AHEAD" SIGNS AS DIRECTED BY THE ENGINEER.
3. ERECT SIGN ① WITH INSTALLED PANEL ② A MINIMUM OF ONE WEEK PRIOR TO THE START OF THE LANE CLOSURE.
4. REMOVE PANEL ② ON THAT DATE.
5. SEE SPECIAL PROVISION "TEMPORARY INFORMATION SIGNING" FOR ADDITIONAL INFORMATION.
6. WILL BE PAID FOR PER SQ FT AS "TEMPORARY INFORMATION SIGNING". EACH SIGN = 21 SQ FT AND THE DATE PANEL ② WILL NOT BE MEASURED SEPARATELY FOR PAYMENT.

FILE NAME =	USER NAME = carpenterdj	DESIGNED -	REVISED -	STATE OF ILLINOIS DEPARTMENT OF TRANSPORTATION	DETAILS			F.A.P. RTE.	SECTION	COUNTY	TOTAL SHEETS	SHEET NO.
ci:\pw\work\p\idot\carpenterdj\d0248331\0366A95-shd-details.dgn	DRAWN -	REVISED -	332					(6,K-15d)RS-3	KANKAKEE	16	16	
PLOT SCALE = 328.083 ' / in.	CHECKED -	REVISED -	CONTRACT NO. 66A95									
PLOT DATE = 6/10/2014	DATE -	REVISED -	SCALE:		SHEET	OF	SHEETS	STA.	TO	STA.	ILLINOIS FED. AID PROJECT	