

PLAN	SURVEYED	DATE
	PLOTTED	BY
	GRADES CHECKED	
	ALIGNMENT CHECKED	
	STRUCTURE NOTATIONS OK'D	
	NO. _____	
	FILE NAME	

PROFILE	SURVEYED	DATE
	PLOTTED	BY
	GRADES CHECKED	
	ALIGNMENT CHECKED	
	STRUCTURE NOTATIONS OK'D	
	NO. _____	
	FILE NAME	

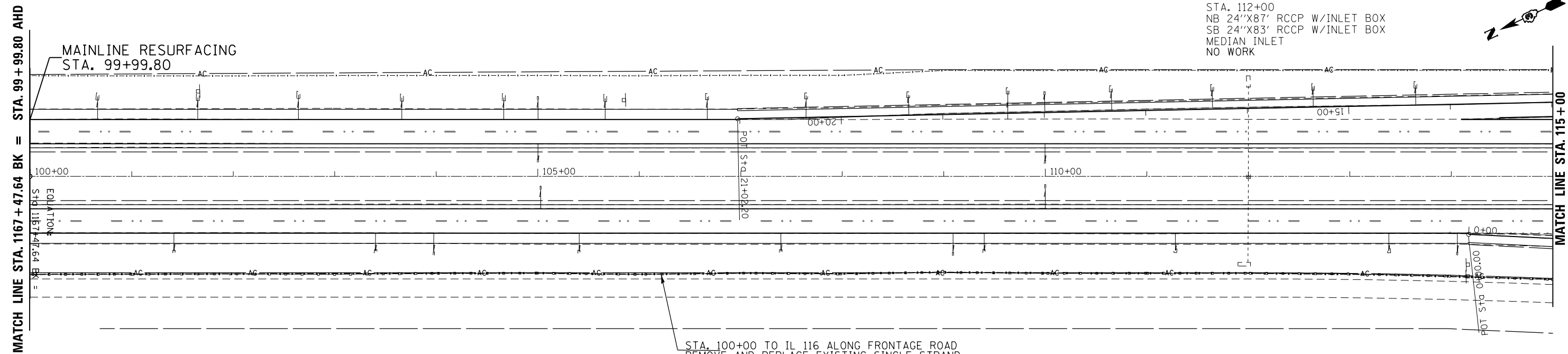

STA. 112+00
NB 24"x87' RCCP W/INLET BOX
SB 24"x83' RCCP W/INLET BOX
MEDIAN INLET
NO WORK

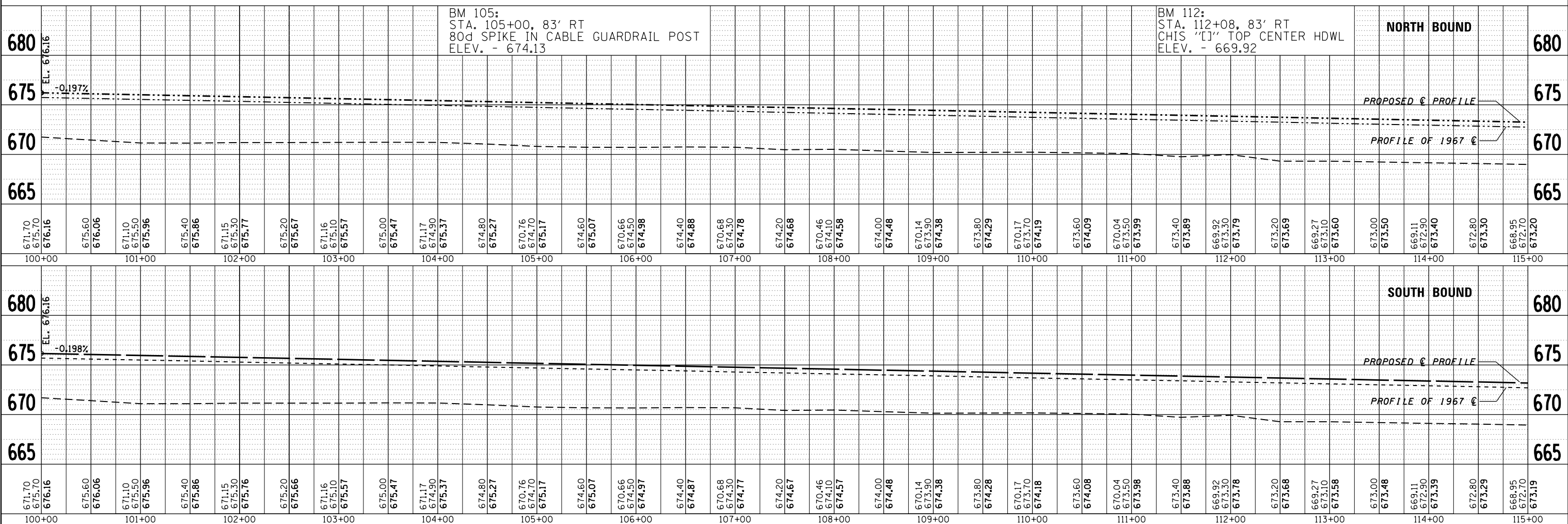
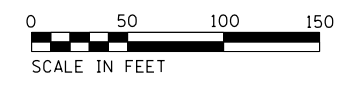

BM 105:
STA. 105+00, 83' RT
80d SPIKE IN CABLE GUARDRAIL POST
ELEV. - 674.13

BM 112:
STA. 112+08, 83' RT
CHIS "[I]" TOP CENTER HDWL
ELEV. - 669.92

FILE NAME =	USER NAME = duncanbd	DESIGNED -	REVISED -	STATE OF ILLINOIS DEPARTMENT OF TRANSPORTATION	PLAN AND PROFILE			F.A.I. R.T.E.	SECTION	COUNTY	TOTAL SHEETS	SHEET NO.
c:\pwork\pwork\duncanbd\0315542\036603-3-plansheets.dgn		CHECKED -	REVISED -		57	(38-3)RS-2	IROQUOIS	186	24			
PLOT SCALE = 100.0000' / in.		DRAWN -	REVISED -		CONTRACT NO. 66C53							
PLOT DATE = 6/10/2014		CHECKED -	REVISED -		FED. ROAD DIST. NO. ILLINOIS FED. AID PROJECT							

SCALE: 1"=50' SHEET NO. 2 OF 31 SHEETS STA. 100+00 TO STA. 115+00