

LEGEND

- WORK AREA
- SIGN
- TYPE III BARRICADE
- TRAFFIC SIGNAL
- DETECTOR LOOPS
- IMPACT ATTENUATOR
- DRUM WITH STEADY BURNING BI-DIRECTIONAL LIGHT
- TEMPORARY CONCRETE BARRIER
- TEMPORARY RUMBLE STRIP
- DOUBLE VERTICAL PANEL
- CRYSTAL, BIDIRECTIONAL BARRIER WALL/GUARDRAIL MARKER

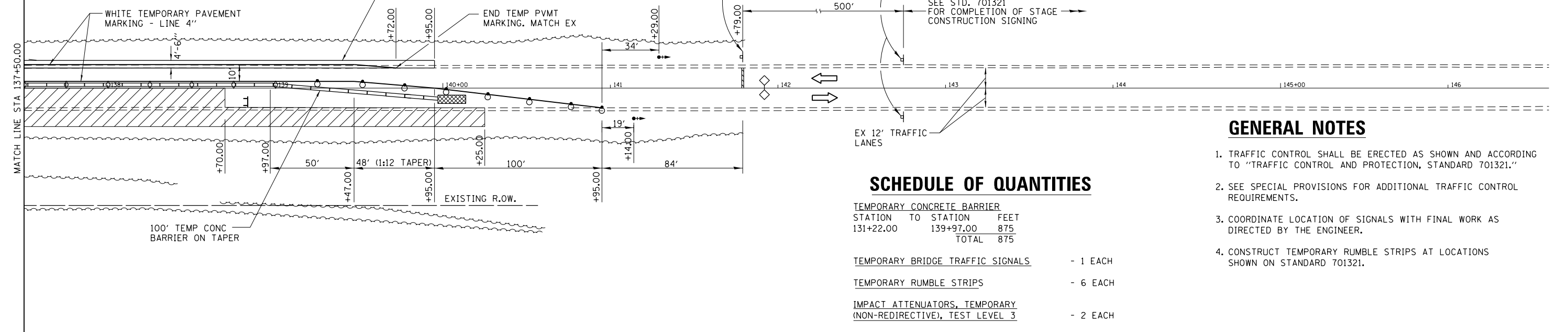

SCHEDULE OF QUANTITIES

TEMPORARY CONCRETE BARRIER	
STATION TO STATION	FEET
131+22.00	139+97.00
	875
	TOTAL
	875
TEMPORARY BRIDGE TRAFFIC SIGNALS	- 1 EACH
TEMPORARY RUMBLE STRIPS	- 6 EACH
IMPACT ATTENUATORS, TEMPORARY (NON-REDIRECTIVE), TEST LEVEL 3	- 2 EACH

GENERAL NOTES

1. TRAFFIC CONTROL SHALL BE ERECTED AS SHOWN AND ACCORDING TO "TRAFFIC CONTROL AND PROTECTION, STANDARD 701321."
2. SEE SPECIAL PROVISIONS FOR ADDITIONAL TRAFFIC CONTROL REQUIREMENTS.
3. COORDINATE LOCATION OF SIGNALS WITH FINAL WORK AS DIRECTED BY THE ENGINEER.
4. CONSTRUCT TEMPORARY RUMBLE STRIPS AT LOCATIONS SHOWN ON STANDARD 701321.

FILE NAME =	USER NAME = steffenmk	DESIGNED - CMM	REVISED -
ei:\pw_work\p\dot\steffenmk\d0122332\072419-sh-t-staging.dgn		DRAWN - TKW	REVISED -
	PLOT SCALE = 60.000' / in.	CHECKED - MTM	REVISED -
	PLOT DATE = 6/12/2014	DATE - 6/12/2014	REVISED -

STATE OF ILLINOIS
DEPARTMENT OF TRANSPORTATION

STAGE CONSTRUCTION
STAGE 1

SCALE: 1"=30' SHEET NO. 1 OF 2 SHEETS STA. 128+25.00 TO STA. 147+00.00

F.A.P. RTE.	SECTION	COUNTY	TOTAL SHEETS	SHEET NO.
332	(12,B2)B-1	WABASH	68	15
CONTRACT NO. 74219			ILLINOIS FED. AID PROJECT	