

Notes:
 See sheet 15 of 32 for Sections C-C & D-D and View E-E.
 $a_3(E)$ and $a_4(E)$ bar spacings measured along C.Rdwy.
 Bars indicated thus 25x2-#4 etc. indicates 25 lines of bars with 2 lengths per line.

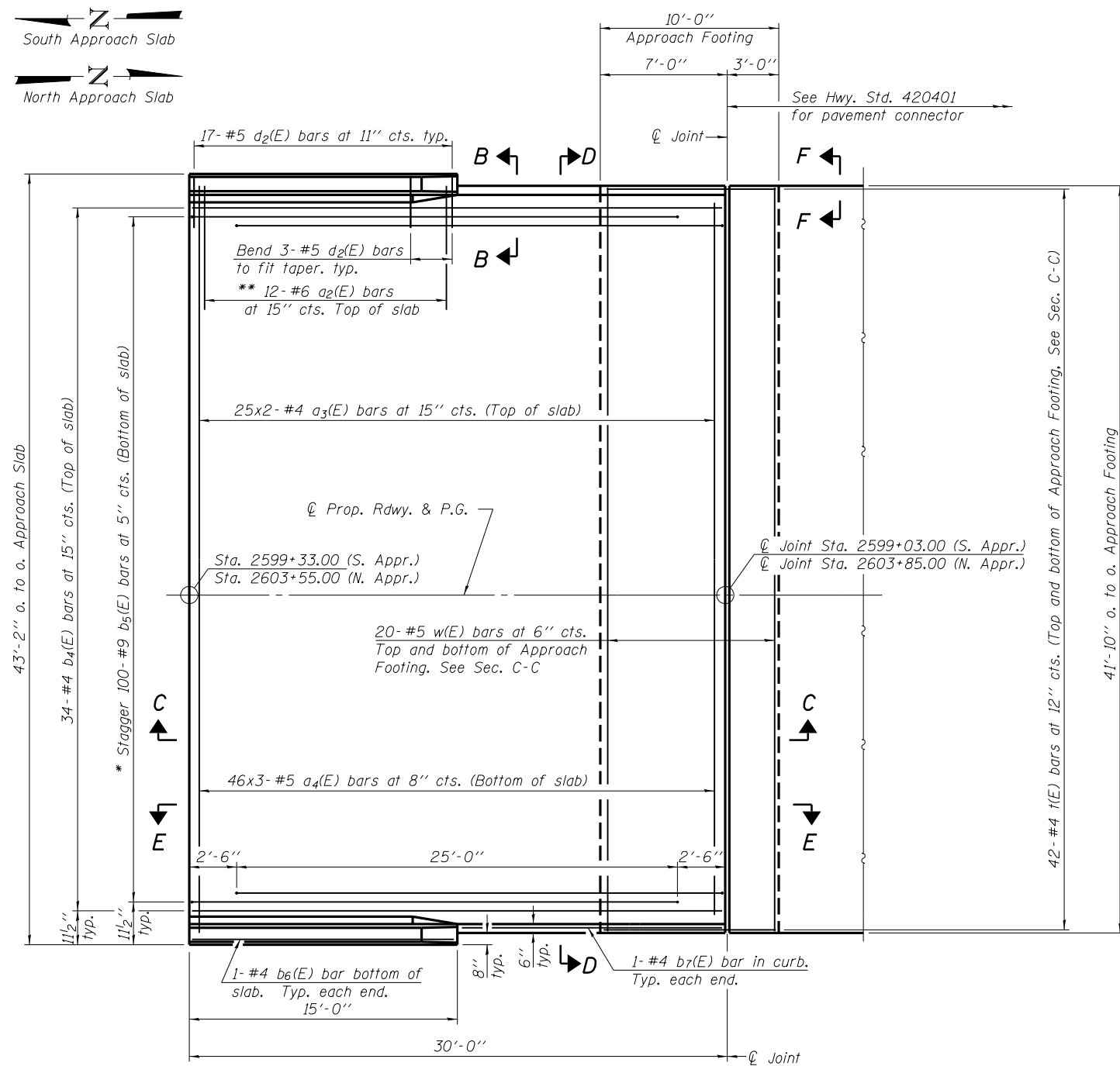

PLAN

(North Approach shown - South Approach Similar)

- * Tilt #9 $b_5(E)$ bars as required to maintain clearance.
- ** Space between $a_3(E)$ bars, typ. ea. parapet.

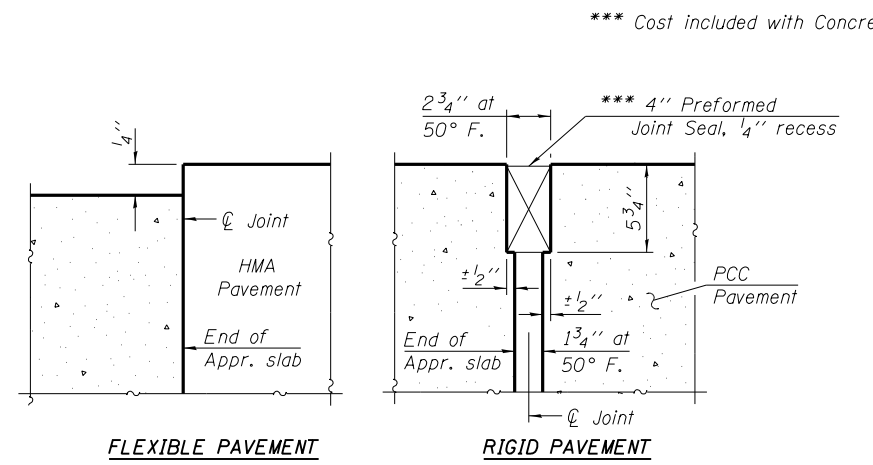

DETAIL A

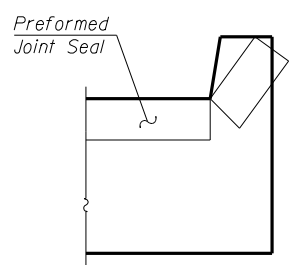
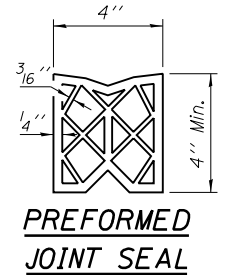

VIEW F-F

Angle Preformed Joint Seal at 45° at curbs when req'd for drainage.

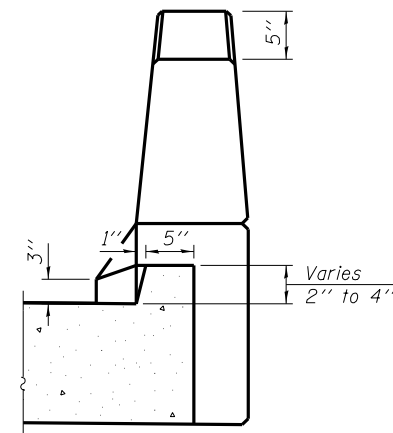

VIEW B-B

MIN. BAR LAPS
 #4 bars = 1'-10"
 #5 bars = 2'-0"

BA-0 7-1-10

(Sheet 1 of 2)

FILE NAME = c:\pwork\p\dot\left\wchd\655362001\039077-78215.dgn	DESIGNED - S.M.S.	REVISED -	STATE OF ILLINOIS DEPARTMENT OF TRANSPORTATION	BRIDGE APPROACH SLAB DETAILS STRUCTURE NO. 039-0077	FAP	SECTION	COUNTY	TOTAL SHEETS	SHEET NO.	
3085 STEVENSON DRIVE, SUITE 201 SPRINGFIELD, ILLINOIS 62703 217.546.3400 www.hireengineering.com	CHECKED - C.C.S.	REVISED -			42	13B-1	JACKSON	112	48	
184.000099 ILLINOIS PROFESSIONAL DESIGN FIRM LS / PE / SE CORPORATION	DRAWN - D.A.B.	REVISED -			IL 13/127 OVER BEAUCOUP CR.	CONTRACT NO. 78215				
PLOT SCALE =	CHECKED - M.D.C.	REVISED -			SHEET NO. 14 OF 32 SHEETS		ILLINOIS FED. AID PROJECT			