

STATE OF ILLINOIS
DEPARTMENT OF TRANSPORTATION
DIVISION OF HIGHWAYS

F.A.P. RTE.	SECTION	COUNTY	TOTAL SHEETS	SHEET NO.
881	34(RS-5),35(RS-3),36(RS-4)	JOHNSON	16	1
		ILLINOIS	CONTRACT NO. 78348	

FOR INDEX OF SHEETS, SEE SHEET NO. 3

STATION EQUATIONS
 1120+61.6 BK = 1120+70.0 AH
 1150+10.7 BK = 1150+15.0 AH
 1184+79.0 BK = 1184+81.9 AH
 1249+72.6 BK = 1249+70.9 AH
 1368+53.7 BK = 1377+35.9 AH
 1385+67.4 BK = 1385+67.6 AH
 1423+42.06 BK = 1423+38.88 AH
 1476+96.2 BK = 1476+90.0 AH
 1509+67.45 BK = 1509+73.12 AH
 1537+94.9 BK = 1537+93.4 AH
 1578+24.3 BK = 1586+92.7 AH

OMISSION STATION
 1555+54.29 TO 1557+50.98

PROPOSED HIGHWAY PLANS

FAP ROUTE 881 (US 45)
SECTION 34(RS-5),35(RS-3),36(RS-4)

RESURFACING 3P
JOHNSON COUNTY

D-99-018-13



US 45 (FAP 881)
TRAFFIC DATA

	(2014)	(2034)
PV =	1,905	2,575
SU =	150	205
MU =	175	230
ADT =	2,230	3,010

TOWNSHIPS

BLOOMFIELD, TUNNEL HILL, BURNSIDE
 T.12S-R.3E, T.11S-R.3E, T.11S-R.4E

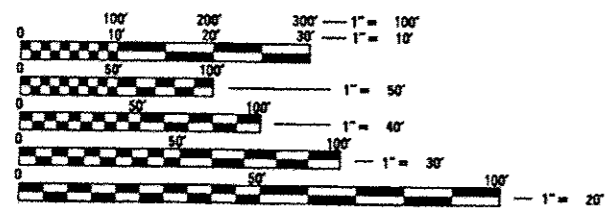

FULL SIZE PLANS HAVE BEEN PREPARED USING STANDARD ENGINEERING SCALES. REDUCED SIZED PLANS WILL NOT CONFORM TO STANDARD SCALES. IN MAKING MEASUREMENTS ON REDUCED PLANS, THE ABOVE SCALES MAY BE USED.

J.U.L.I.E.
 JOINT UTILITY LOCATION INFORMATION FOR EXCAVATION
 1-800-892-0123
 OR 811

PROJECT ENGINEER: JOHN A. BRANDON
 PROJECT MANAGER: CHARLES STEIN

CONTRACT NO. 78348

END PROJECT
 FAP 881 (US 45)
 STA. 1589+17

GROSS LENGTH = 61,458 FT. = 11.64 MILE
 OMISSIONS = 197 FT. = 0.04 MILE
 NET LENGTH = 61,261 FT. = 11.60 MILE

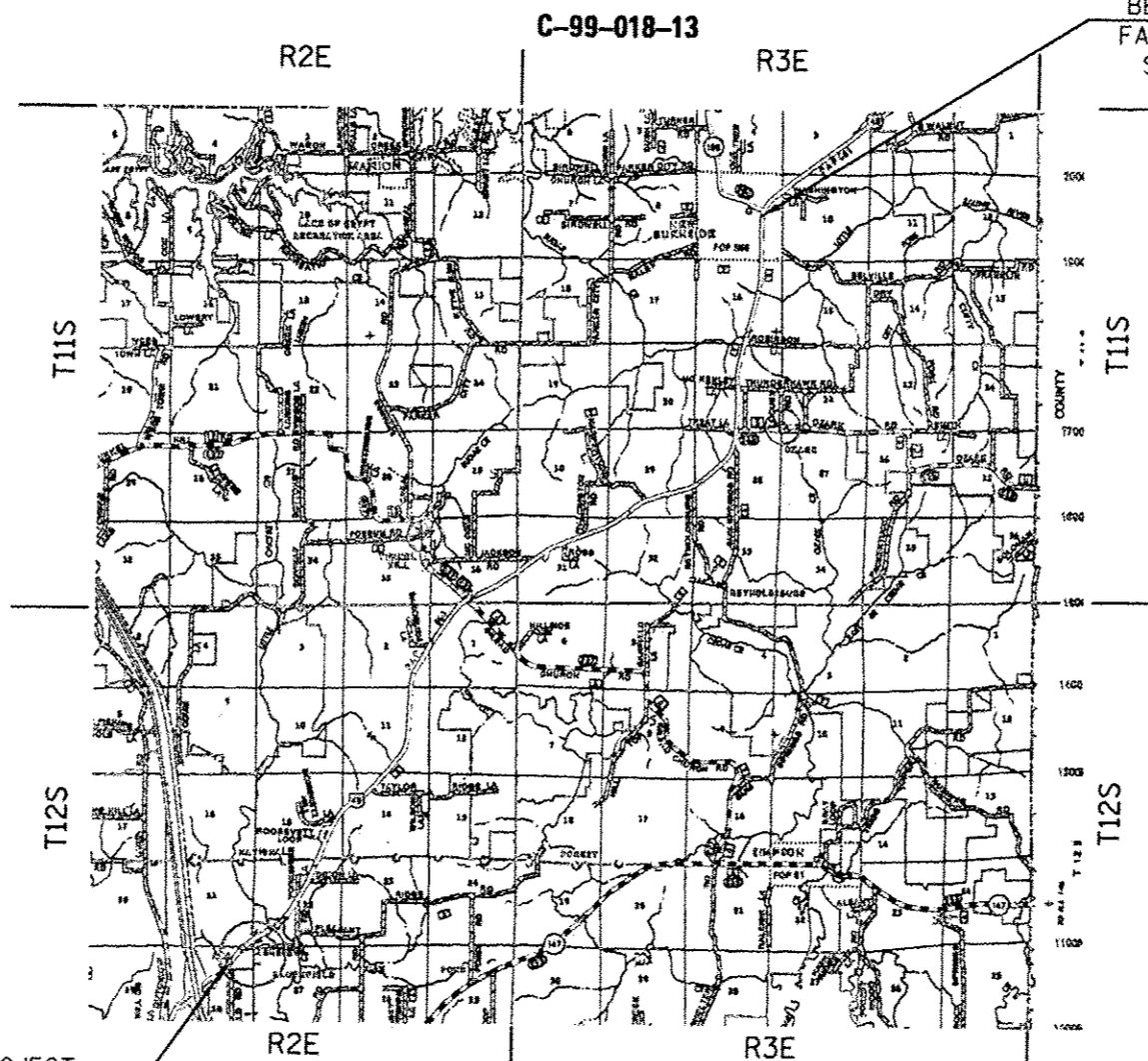

BEGIN PROJECT
 FAP 881 (US 45)
 STA. 957+00

STATE OF ILLINOIS
 DEPARTMENT OF TRANSPORTATION
 DIVISION OF HIGHWAYS

SUBMITTED June 13 2014
Jeffrey L. Kern
 DEPUTY DIRECTOR OF HIGHWAYS, REGION ENGINEER

July 18 2014
John D. Baranzelli, P.E.
 ENGINEER OF DESIGN AND ENVIRONMENT

July 18 2014
Omer Osman, P.E.
 DIRECTOR OF HIGHWAYS, CHIEF ENGINEER

PRINTED BY THE AUTHORITY
 OF THE STATE OF ILLINOIS