

STATE OF ILLINOIS  
DEPARTMENT OF TRANSPORTATION

F.A.P. RTE.	SECTION	COUNTY	TOTAL SHEETS	SHEET NO.
658	(G) RS-7	MASDN	27	1
		ILLINOIS	CONTRACT NO. 72J17	

FOR INDEX OF SHEETS, SEE SHEET NO. 2

HIGHWAY STANDARDS

000001-06	701201-04
001006	701301-04
442201-03	701306-03
667101-02	701311-03
701001-02	701901-05
701006-05	781001-04

PROPOSED  
HIGHWAY PLANS

FAP ROUTE 658 (IL 29)  
SECTION (G) RS-7  
PROJECT: ACF-0658(027)  
3P RESURFACING  
MASON COUNTY

C-96-055-16

FAP 658 (IL 29)  
FUNCTIONAL CLASS - MINOR ARTERIAL  
ADT (2015) - 1,550  
SU - 100  
MU - 200



LOCATION OF SECTION INDICATED THUS: - [rectangle symbol] -

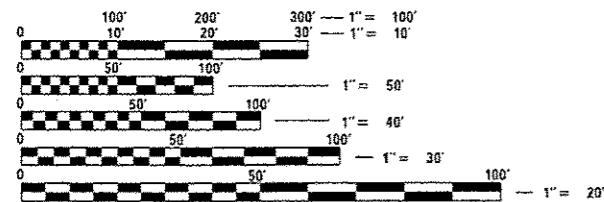

FULL SIZE PLANS HAVE BEEN PREPARED USING STANDARD ENGINEERING SCALES. REDUCED SIZED PLANS WILL NOT CONFORM TO STANDARD SCALES. IN MAKING MEASUREMENTS ON REDUCED PLANS, THE ABOVE SCALES MAY BE USED.

J.U.L.I.E.  
JOINT UTILITY LOCATION INFORMATION FOR EXCAVATION  
1-800-892-0123  
OR 811

PROJECT ENGINEER - JAY EDWARDS (217) 785-0597  
PROJECT MANAGER - GLENN STARKE (217) 524-0066

CONTRACT NO. 72J17

END PROJECT  
STA 510 + 96.64

STATION EQUATION  
288 + 14.49 BK  
288 + 20.11 AH

BEGIN PROJECT  
STA 287 + 68.48

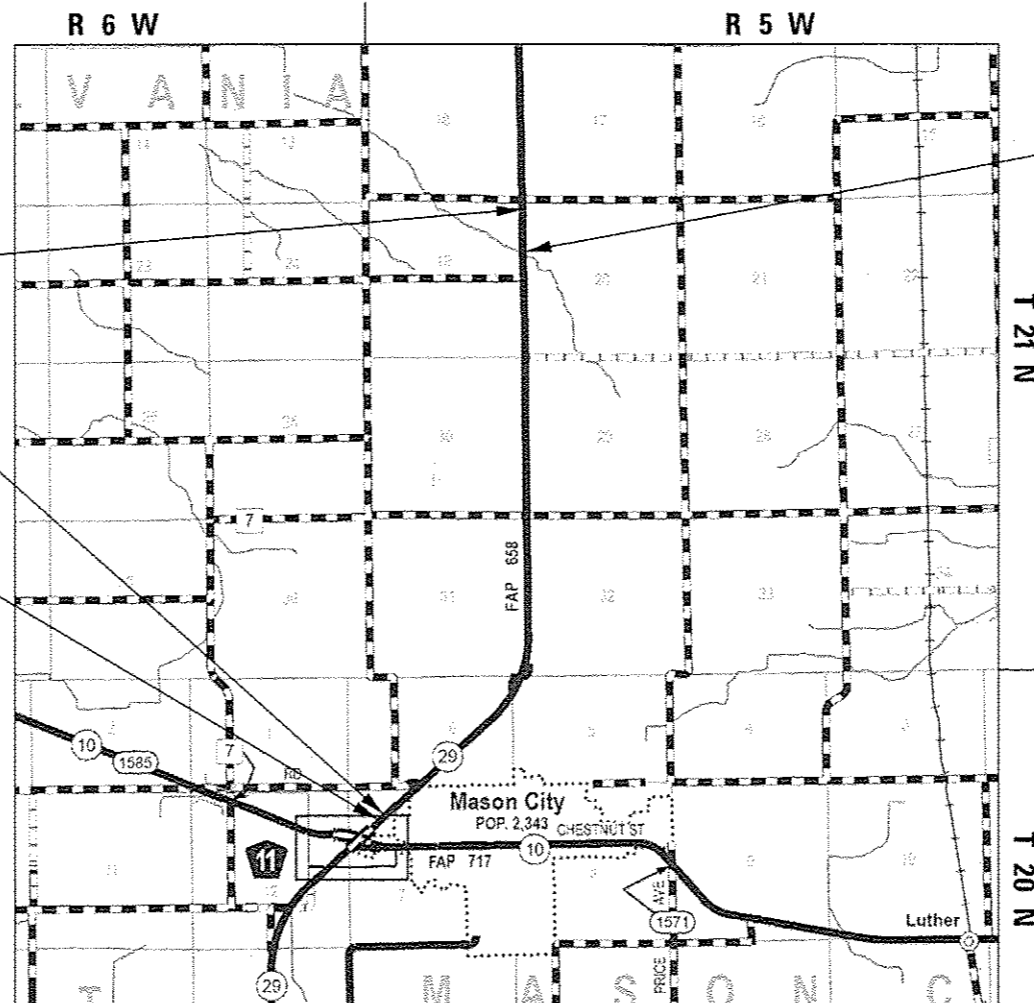

S.N. 063-7003  
STA 495 + 09.00

GROSS LENGTH = 22,322.54 FT. = 4.244 MILE  
NET LENGTH = 22,322.54 FT. = 4.244 MILE

STATE OF ILLINOIS  
DEPARTMENT OF TRANSPORTATION

SUBMITTED *June 24 2016*

*[Signature]* REGIONAL ENGINEER

*Aug 12 2016*  
*Matthew M. Addis P.E.*  
ENGINEER OF DESIGN AND ENVIRONMENT

*Aug 12 2016*  
*[Signature]* 2  
DIRECTOR OF PROGRAM DEVELOPMENT

PRINTED BY THE AUTHORITY  
OF THE STATE OF ILLINOIS

**GENERAL NOTES**

1. ANY REFERENCE TO A STANDARD IN THESE PLANS SHALL BE INTERPRETED TO MEAN THE EDITION AS INDICATED BY THE SUB NUMBER LISTED IN THE INDEX OF SHEETS OR THE COPY OF THE STANDARD INCLUDED IN THESE PLANS.
2. IN ADDITION TO FIELD SURVEYS, PLAN DIMENSIONS AND DETAILS RELATIVE TO THE EXISTING FACILITIES HAVE BEEN TAKEN FROM EXISTING PLANS AND ARE SUBJECT TO CONSTRUCTION VARIATIONS. IT SHALL BE THE CONTRACTOR'S RESPONSIBILITY TO VERIFY SUCH DIMENSIONS AND DETAILS IN THE FIELD. SUCH VARIATIONS SHALL NOT BE A CAUSE FOR ADDITIONAL COMPENSATION DUE TO A CHANGE IN THE SCOPE OF WORK, HOWEVER, THE CONTRACTOR WILL BE PAID FOR THE QUANTITY ACTUALLY FURNISHED AT THE UNIT PRICE BID FOR THE WORK.
3. ACCESS TO ALL ENTRANCES AND SIDE ROADS SHALL BE MAINTAINED AT ALL TIMES.
4. THE CONTRACTOR SHALL BE RESPONSIBLE FOR PROTECTING UTILITY PROPERTY FROM CONSTRUCTION OPERATIONS, AS OUTLINED IN ARTICLE 107.31 OF THE STANDARD SPECIFICATIONS. THE J.U.L.I.E. NUMBER IS 1-800-892-0123. A MINIMUM OF 48 HOURS ADVANCE NOTICE IS REQUIRED.
5. THE THICKNESS OF BITUMINOUS MIXTURES SHOWN ON THE PLANS IS THE NOMINAL THICKNESS. DEVIATIONS FROM THE NOMINAL THICKNESS WILL BE PERMITTED WHEN SUCH DEVIATIONS OCCUR DUE TO IRREGULARITIES IN THE EXISTING SURFACE OR BASE ON WHICH THE BITUMINOUS MIXTURE IS PLACED.
6. ALL SAW CUTS, NECESSARY TO COMPLETE THE WORK DETAILED IN THESE PLANS, SHALL BE INCLUDED IN THE COST FOR THE VARIOUS PAY ITEMS INVOLVED.
7. UNLESS DIRECTED BY THE ENGINEER, PAVEMENT MARKING LINES SHALL NOT BE LAID DIRECTLY OVER A LONGITUDINAL CRACK OR JOINT NOR OVER A TAR OR ASPHALT PAINTED LINE. THE EDGE OF A CENTERLINE OR LANE LINE SHALL BE OFFSET A MINIMUM DISTANCE OF 2" FROM A LONGITUDINAL CRACK OR JOINT. EDGE LINES SHALL BE APPROXIMATELY 2" FROM THE EDGE LINE OF PAVEMENT. SEE SECTION 780 OF THE STANDARD SPECIFICATIONS FOR TRAFFIC CONTROL ITEMS.
8. THE FOLLOWING RATES OF APPLICATION HAVE BEEN USED TO CALCULATE THE PLAN QUANTITIES:  

BITUMINOUS CONCRETE SURFACE	0.056 TON/SQ. YD. PER 1"
AGGREGATE MATERIAL	2.05 TON/CU. YD.
STONE DUMPED RIPRAP	1.75 TON/CU. YD.
9. THE EXISTING ROAD SIGNS THAT INTERFERE WITH CONSTRUCTION WILL BE REMOVED OR RELOCATED AS DIRECTED BY THE ENGINEER. AFTER THE CONSTRUCTION IS COMPLETED, THE CONTRACTOR WILL REINSTALL THE SIGNS AS DIRECTED BY THE ENGINEER. THIS WORK WILL NOT BE PAID SEPARATELY BUT SHALL BE CONSIDERED INCLUDED IN THE CONTRACT, AND NO COMPENSATION WILL BE ALLOWED.
10. WHERE SECTION OR SUB-SECTION MARKERS ARE ENCOUNTERED, THE ENGINEER SHALL BE NOTIFIED BEFORE SUCH MONUMENTS ARE REMOVED. THE CONTRACTOR SHALL PROTECT AND CAREFULLY PRESERVE ALL PROPERTY MARKERS AND MONUMENTS UNTIL THE OWNER, AN AUTHORIZED AGENT OR LAND SURVEYOR HAS WITNESSED OR OTHERWISE REFERENCED THEIR LOCATION.
11. LIMITS OF CONSTRUCTION ALONG SIDE ROADS SHALL BE VERIFIED AND APPROVED BY THE ENGINEER BEFORE WORK BEGINS. LIMITS MAY BE ADJUSTED FROM PROPOSED PLAN LAYOUT IF ENGINEER DEEMS NECESSARY.
12. NO PASSING ZONES TO BE FIELD VERIFIED BY THE BUREAU OF OPERATIONS. THE RESIDENT ENGINEER SHALL NOTIFY THE BUREAU OF OPERATIONS AT LEAST 14 DAYS PRIOR TO PLACEMENT OF FINAL PERMANENT PAVEMENT MARKING. (PH: 217-782-7314)

**COMMITMENTS**

1. THE RESIDENT ENGINEER SHALL CONTACT STUDIES & PLANS CONCERNING ANY MAJOR PLAN CHANGE TO MAKE SURE NO PREVIOUS COMMITMENTS (NOT LISTED) WERE MADE AFFECTING THE DESIGN AND ALLOW AN IMPROVED DESIGN FOR FUTURE PROJECTS.

**INDEX OF SHEETS**

- |         |                           |
|---------|---------------------------|
| 1       | COVER SHEET               |
| 2       | GENERAL NOTES             |
| 3 - 5   | SUMMARY OF QUANTITIES     |
| 6 - 7   | SCHEDULES                 |
| 8 - 10  | TYPICAL SECTIONS          |
| 11 - 18 | PLAN SHEETS               |
| 19      | SUPERELEVATION DETAILS    |
| 20 - 21 | ENTRANCE DETAILS          |
| 22      | BUTT JOINT DETAILS        |
| 23      | CULVERT RIPRAP DETAIL     |
| 24 - 27 | CULVERT RIPRAP X-SECTIONS |

**MIXTURE REQUIREMENTS**

The following mixture requirements are applicable for this project:

Location(s):	IL 29 MAINLINE
Mixture Uses:	Surface
PG:	PG 64-22
Design Air Voids:	4.0% @ N50
Mixture Composition:	IL 9.5
Friction Aggregate:	Mix "C"
Quality Management:	QCP
Sublot Size:	1,000 Tons

Location(s):	IL 29 MAINLINE
Mixture Uses:	Leveling Binder
PG:	PG 64-22
Design Air Voids:	4.0% @ N50
Mixture Composition:	IL 9.5 FG
Friction Aggregate:	N/A
Quality Management:	QCP
Sublot Size:	1,000 Tons

Location(s):	ENTRANCES / SIDEROADS
Mixture Uses:	Incidental Surfacing
PG:	PG 64-22
Design Air Voids:	4.0% @ N50
Mixture Composition:	IL 9.5
Friction Aggregate:	Mix C
Quality Management:	OC / OA
Sublot Size:	N/A

Location(s):	IL 29 MAINLINE
Mixture Uses:	Pavement Patching
PG:	PG 64-22
Design Air Voids:	4.0% @ N50
Mixture Composition:	IL 19.0
Friction Aggregate:	N/A
Quality Management:	OC / OA
Sublot Size:	N/A

MIXTURE NOTE: DENSITY FOR IL 9.5 FG LEVELING BINDER WILL BE PAID IN QCP FORMULA AT 100%. CORES FOR LEVELING BINDER SHALL BE TAKEN AT REQUIRED INTERVALS FOR INFORMATION ONLY.

<b>DISTRICT SIX</b>	
EXAMINED	<u>JUNE 9th</u> 20 <u>16</u>
<i>John C. Wynn</i>	
OPERATIONS ENGINEER	
EXAMINED	<u>June 6</u> 20 <u>16</u>
<i>Ron Dubois</i>	
PROJECT IMPLEMENTATION ENGINEER	
EXAMINED	<u>June 15</u> 20 <u>16</u>
<i>Jeffrey P. Myer</i>	
PROGRAM DEVELOPMENT ENGINEER	

80% FED. / 20% STATE  
 CONSTR. CODE  
 6-60113-0000  
 STP 80/20  
 ROADWAY  
 0005  
 RURAL

CODE NO.	ITEM	UNIT	TOTAL QUANTITY	
20200100	EARTH EXCAVATION	CU YD	58	58
20800150	TRENCH BACKFILL	CU YD	7	7
21400100	GRADING AND SHAPING DITCHES	FOOT	1340	1340
25000200	SEEDING, CLASS 2	ACRE	0.5	0.5
25000400	NITROGEN FERTILIZER NUTRIENT	POUND	42	42
25000500	PHOSPHORUS FERTILIZER NUTRIENT	POUND	42	42
25000600	POTASSIUM FERTILIZER NUTRIENT	POUND	42	42
25100125	MULCH, METHOD 3	ACRE	0.5	0.5
28100807	STONE DUMPED RIPRAP, CLASS A4	TON	72	72
28200200	FILTER FABRIC	SQ YD	83	83
40600290	BITUMINOUS MATERIALS (TACK COAT)	POUND	40727	40727
40600627	LEVELING BINDER (MACHINE METHOD), IL-9.5FG, N50	TON	2497	2497
40600982	HOT-MIX ASPHALT SURFACE REMOVAL - BUTT JOINT	SQ YD	1334	1334
40600990	TEMPORARY RAMP	SQ YD	27	27

14

80% FED. / 20% STATE

CONSTR. CODE  
6-60113-0000  
STP 80/20  
ROADWAY  
0005  
RURAL

CODE NO.	ITEM	UNIT	TOTAL QUANTITY	
40603310	HOT-MIX ASPHALT SURFACE COURSE, MIX "C", N50	TON	5000	5000
40800050	INCIDENTAL HOT-MIX ASPHALT SURFACING	TON	105	105
44000155	HOT-MIX ASPHALT SURFACE REMOVAL, 1 1/2"	SO YD	59447	59447
44200144	PAVEMENT PATCHING, TYPE II, 12 INCH	SO YD	300	300
44200148	PAVEMENT PATCHING, TYPE III, 12 INCH	SO YD	40	40
48102100	AGGREGATE WEDGE SHOULDER, TYPE B	TON	2260	2260
50105220	PIPE CULVERT REMOVAL	FOOT	70	70
54200223	PIPE CULVERTS, CLASS D, TYPE 1 18"	FOOT	70	70
54215553	METAL END SECTIONS 18"	EACH	4	4
66700205	PERMANENT SURVEY MARKERS, TYPE I	EACH	3	3
67000400	ENGINEER'S FIELD OFFICE, TYPE A	CAL MO	8	8
67100100	MOBILIZATION	LSUM	1	1
70100450	TRAFFIC CONTROL AND PROTECTION, STANDARD 701201	LSUM	1	1
70100460	TRAFFIC CONTROL AND PROTECTION, STANDARD 701306	LSUM	1	1

14

80% FED. / 20% STATE

CONSTR. CODE  
6-60113-0000  
STP 80/20  
ROADWAY  
0005  
RURAL

CODE NO.	ITEM	UNIT	TOTAL QUANTITY	
70300100	SHORT TERM PAVEMENT MARKING	FOOT	6711	6711
70300150	SHORT TERM PAVEMENT MARKING REMOVAL	SO FT	746	746
* 78001120	PAINT PAVEMENT MARKING - LINE 5"	FOOT	58577	58577
* 78100100	RAISED REFLECTIVE PAVEMENT MARKER	EACH	280	280
φ Z0076600	TRAINEES	Hour	1000	1000
78300200	RAISED REFLECTIVE PAVEMENT MARKER REMOVAL	EACH	280	280
φ Z0076604	TRAINEES TRAINING PROGRAM GRADUATE	Hour	1000	1000
• Z0005300	BOX CULVERTS TO BE CLEANED	EACH	2	2

6

φ 0042

\*Specialty Items

FILE NAME *	USER NAME * starkego	DESIGNED -	REVISED -	<b>STATE OF ILLINOIS DEPARTMENT OF TRANSPORTATION</b>	<b>SUMMARY OF QUANTITIES</b>				F.A.P. RTE.	SECTION	COUNTY	TOTAL SHEETS	SHEET NO.
p:\11084810\INTEG.ILLINOIS.GOV\PI001\Documents\DOT Offices\District 6\Projects\0672\DRAWING\600\Sheets\0672J17-sht-500.dwg		CHECKED -	REVISED -		658	(0) RS-7	MASON	27	5				
PLOT SCALE * 100.0000 / 1"		DATE -	REVISED -		SCALE: SHEET 3 OF 3 SHEETS STA. TO STA.				CONTRACT NO. 72J17				
Default	PLOT DATE * 6/24/2016								ILLINOIS FED. AID PROJECT				

PAVING SCHEDULE											
LOCATION			LENGTH	AREA	HMA SURFACE REMOVAL - 1.5"	HMA SURFACE REMOVAL - BUTT JOINT	BITUMINOUS MATERIALS (TACK COAT)	LEVELING BINDER (MACHINE METHOD), IL 9.5 FG, N50	HMA SURFACE COURSE, MIX "C", N50	AGGREGATE WEDGE SHOULDERS, TYPE B	TEMPORARY RAMP
STATION	TO	STATION	FT	SQ YD	SQ YD	SQ YD	POUND	TON	TON	SQ YD	
STA 287+68.48	TO	STA 287+83.48	15.00	40.0		40.0	18.0		3.4	1.5	13.3
STA 287+83.48	TO	STA 288+14.48	31.00	82.7	82.7		55.8	3.5	6.9	3.1	
STATION EQUATION STA 288+14.48 BK = STA 288+20.11 AH											
STA 288+20.11	TO	STA 334+36.51	4616.40	12310.4	12310.4		8309.5	517.0	1034.1	467.3	
STA 334+36.51	TO	STA 335+74.91	138.40	369.1	369.1		249.1	15.5	31.0	14.0	
STA 335+74.91	TO	STA 367+77.42	3202.51	8540.0	8540.0		5764.5	358.7	717.4	324.2	
STA 367+77.42	TO	STA 369+15.82	138.40	369.1	369.1		249.1	15.5	31.0	14.0	
STA 369+15.82	TO	STA 390+86.00	2170.18	5787.1	5787.1		3906.3	243.1	486.1	219.7	
STA 390+86.00	TO	STA 407+23.70	1637.70	4367.2	4367.2		2947.9	183.4	366.8	165.8	
STA 407+23.70	TO	STA 436+15.07	2891.37	7710.3	7710.3		5204.5	323.8	647.7	292.7	
STA 436+15.07	TO	STA 451+31.53	1516.46	4043.9	4043.9		2729.6	169.8	339.7	153.5	
STA 451+31.53	TO	STA 476+71.60	2540.07	6773.5	6773.5		4572.1	284.5	569.0	257.1	
STA 476+71.60	TO	STA 501+22.50	2450.90	6535.7	6535.7		4411.6	274.5	549.0	248.1	
STA 501+22.50	TO	STA 510+81.64	959.14	2557.7	2557.7		1726.5	107.4	214.8	97.1	
STA 510+81.64	TO	STA 510+96.64	15.00	40.0		40.0	18.0		3.4	1.5	13.3
TOTAL =					59446.7	80.0	40162.6	2496.8	5000.2	2259.8	26.7

PAVEMENT MARKING SCHEDULE											
LOCATION			LENGTH	NO PASSING ZONES	PAINT PAVEMENT MARKING - LINE 5"			RAISED REFLECTIVE PAVEMENT MARKER	RAISED REFLECTIVE PAVEMENT MARKER REMOVAL	SHORT TERM PAVEMENT MARKING	SHORT TERM PAVEMENT MARKING REMOVAL
STATION	TO	STATION	FT		SKIP DASH	SOLID					
						YELLOW	WHITE				
				FT	FT	FT	EACH	EACH	FT	SQ FT	
STA 287+68.48	TO	STA 289+69.00	200.5	LT NPZ	60.0	200.5	401.0	3	3	21	2.3
STA 289+69.00	TO	STA 350+47.00	6078.0		1520.0		12156.0	76	76	608	67.6
STA 350+47.00	TO	STA 358+75.00	828.0	RT NPZ	210.0	828.0	1656.0	10	10	83	9.2
STA 358+75.00	TO	STA 359+95.00	120.0		30.0		240.0	2	2	12	1.3
STA 359+95.00	TO	STA 365+75.00	580.0	LT NPZ	150.0	580.0	1160.0	7	7	58	6.4
STA 365+75.00	TO	STA 380+40.00	1465.0		370.0		2930.0	18	18	147	16.3
STA 380+40.00	TO	STA 389+85.00	945.0	RT NPZ	240.0	945.0	1890.0	12	12	95	10.6
STA 389+85.00	TO	STA 391+55.00	170.0	DUAL NPZ		340.0	340.0	2	2	17	1.9
STA 391+55.00	TO	STA 399+55.00	800.0	LT NPZ	200.0	800.0	1600.0	10	10	80	8.9
STA 399+55.00	TO	STA 428+25.00	2870.0		720.0		5740.0	36	36	287	31.9
STA 428+25.00	TO	STA 435+00.00	675.0	RT NPZ	170.0	675.0	1350.0	8	8	68	7.6
STA 435+00.00	TO	STA 437+80.00	280.0		70.0		560.0	4	4	28	3.1
STA 437+80.00	TO	STA 445+00.00	720.0	LT NPZ	180.0	720.0	1440.0	9	9	72	8.0
STA 445+00.00	TO	STA 450+25.00	525.0		140.0		1050.0	7	7	53	5.9
STA 450+25.00	TO	STA 459+20.00	895.0	RT NPZ	230.0	895.0	1790.0	11	11	90	10.0
STA 459+20.00	TO	STA 460+80.00	160.0	DUAL NPZ		320.0	320.0	2	2	16	1.8
STA 460+80.00	TO	STA 467+80.00	700.0	LT NPZ	180.0	700.0	1400.0	9	9	70	7.8
STA 467+80.00	TO	STA 497+50.00	2970.0		750.0		5940.0	37	37	297	33.0
STA 497+50.00	TO	STA 507+70.00	1020.0	RT NPZ	260.0	1020.0	2040.0	13	13	102	11.3
STA 507+70.00	TO	STA 510+96.64	326.6	LT NPZ	90.0	326.6	653.3	4	4	33	3.7
SUBTOTAL =					5570.0	8350.2	44656.3			2237 X 3 APP	
TOTAL =					58576.5			280	280	6711	248.6

PERMANANT SURVEY MARKERS, TYPE 1										
IL 29 NORTH OF CITY SECTION CORNERS NAD83/07adj										
POINT #	NORTHING	EASTING	DESCRIPTION	MONUMENT	STATION	OFFSET	CHAIN	CORNER		TIFF
280	1306725.322	2427971.038	SECTION CORNER	MAG SPIKE	486+01.31	0.84 RT	IL29A	E 1/4 COR SEC 19,T21N,R5W,3RD PM		1
328	1301447.066	2428045.197	SECTION CORNER	MAG SPIKE	433+22.45	3.00 RT	IL29A	E 1/4 COR SEC 30,T21N,R5W,3RD PM		1
329	1304083.838	2428020.976	SECTION CORNER	MAG SPIKE	459+59.34	0.25 RT	IL29A	NE COR SEC 30,T21N,R5W,3RD PM		1
TOTAL =										3

ENTRANCE SCHEDULE									
LOCATION		TYPE OF ENTRANCE	EX MATERIAL TYPE	WIDTH	LENGTH	PR. THICKNESS	HMA SURFACE REMOVAL - BUTT JOINT	BITUMINOUS MATERIALS (TACK COAT)	INCIDENTAL HMA SURFACING
LT/RT	STATION	FE/PE/CE/MB/SR	EARTH/AGG/BIT/PCC	FT	FT	IN	SQ YD	POUND	TON
LT	STA 304+29.00	SR	BIT	87	10	1.5	80.8	36.4	6.8
RT	STA 304+29.00	SR	BIT	106	10	1.5	97.3	43.8	8.2
RT	STA 344+82.00	SR	BIT	123	30	1.5	237.9	107.1	20.0
LT	STA 348+02.00	SR	BIT	76	9	1.5	54.3	24.5	4.6
LT	STA 353+27.00	SR/MB	BIT	108	11	1.5	102.8	46.3	8.6
RT	STA 353+27.00	SR	BIT	51	19	1.5	60.8	27.4	5.1
LT	STA 389+55.00	MB	BIT	59	5	1.5	23.4	10.6	2.0
RT	STA 389+55.00	PE	BIT	52	11	1.5	46.1	20.8	3.9
LT	STA 406+75.00	SR	BIT	63	10	1.5	56.8	25.6	4.8
RT	STA 406+75.00	SR	BIT	75	25	1.5	131.8	59.3	11.1
RT	STA 453+37.00	PE	BIT	55	11	1.5	55.9	25.2	4.7
LT	STA 453+46.00	MB	BIT	56	4	1.5	21.7	9.8	1.8
RT	STA 459+64.00	SR	BIT	65	11	1.5	61.7	27.8	5.2
LT	STA 486+22.00	SR	BIT	63	32	1.5	125.3	56.4	10.5
LT	STA 491+53.00	CE/MB	BIT	109	11	1.5	96.9	43.6	8.1
TOTAL =							1253.5	564.1	105.3

SEEDING SCHEDULE											
LOCATION				LENGTH	WIDTH	AREA	NITROGEN FERTILIZER NUTRIENT	PHOSPHOROUS FERTILIZER NUTRIENT	POTASSIUM FERTILIZER NUTRIENT	SEEDING, CLASS 2	MULCH METHOD 3
STATION	TO	STATION		FT	FT	SQ FT	POUND	POUND	POUND	ACRE	ACRE
STA 385+77.00	TO	STA 386+72.00	RT	95.00	15	1425	3	3	3	0.03	0.03
STA 401+32.00	TO	STA 406+52.00	RT	520.00	15	7800	16	16	16	0.18	0.18
STA 401+37.00	TO	STA 406+49.00	LT	512.00	15	7680	16	16	16	0.18	0.18
STA 451+04.00	TO	STA 453+17.00	RT	213.00	15	3195	7	7	7	0.07	0.07
TOTAL =							42	42	42	0.46	0.46

BOX CULVERT CLEANING SCHEDULE		
LOCATION	SIZE	BOX CULVERTS TO BE CLEANED
STATION	FT	EACH
STA 295+00.00	3X2	1
STA 495+09.00	DOUBLE 5X8	1
TOTAL =		2

RIPRAP SCHEDULE								
LOCATION				THICKNESS	AREA	FILTER FABRIC	STONE DUMPED RIPRAP, CLASS A4	EARTH EXCAVATION
STATION	TO	STATION		FT	SQ YD	SQ YD	TON	CU YD
STA 494+67.00	TO	STA 495+35.00	RT	2	82.7	82.7	72.3	58.0
TOTAL =						82.7	72.3	58.0

GRADING AND SHAPING DITCHES SCHEDULE				
LOCATION				GRADING AND SHAPING DITCHES
STATION	TO	STATION		FT
STA 385+77.00	TO	STA 386+72.00	RT	95.0
STA 401+32.00	TO	STA 406+52.00	RT	520.0
STA 401+37.00	TO	STA 406+49.00	LT	512.0
STA 451+04.00	TO	STA 453+17.00	RT	213.0
TOTAL =				1340.0

PIPE CULVERT SCHEDULE						
LOCATION		LENGTH	PIPE CULVERT REMOVAL	PIPE CULVERTS, CLASS D, TYPE 1 - 18"	METAL END SECTIONS, 18"	TRENCH BACKFILL
STATION	OFFSET	FT	FT	FT	EACH	CU YD
STA 386+82.00	29' RT	20	20	20	2	1.7
STA 406+75.00	36' RT	50	50	50	2	5.6
TOTAL =			70	70	4	7.2

PAVEMENT PATCHING SCHEDULE				
LOCATION			PAVEMENT PATCHING, TYPE II, 12"	PAVEMENT PATCHING, TYPE III, 12"
STATION	TO	STATION	SQ YD	SQ YD
STA 287+68.48	TO	STA 510+96.64	300.0	40.0
TOTAL =			300.0	40.0





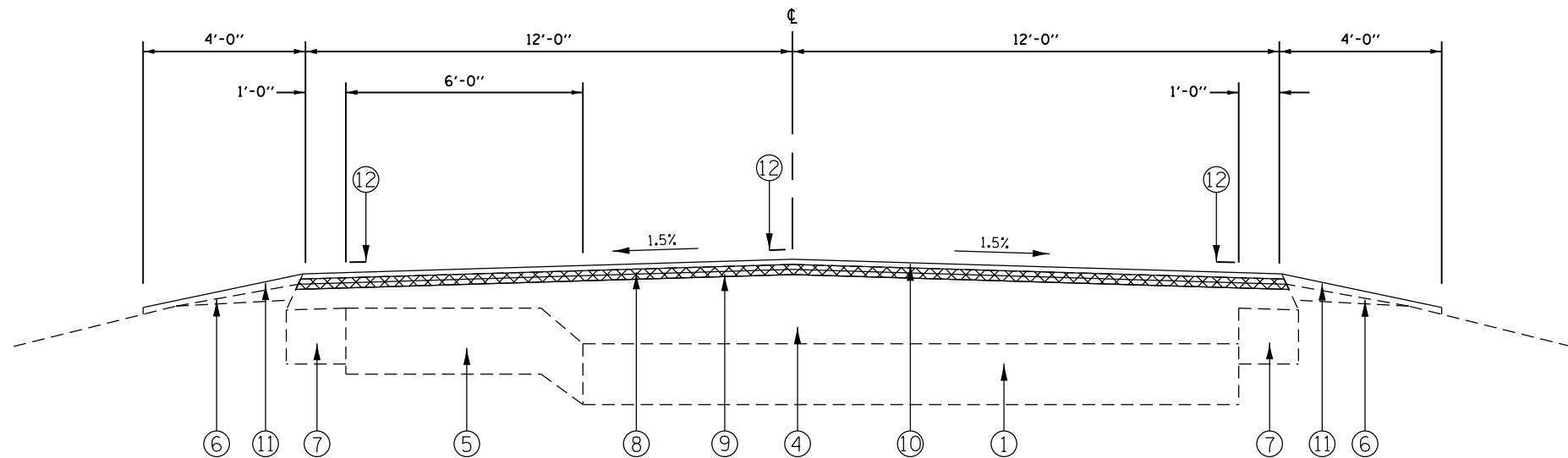

STA 368+07.80 TO STA 369+15.82 (SE TRANS)  
 STA 369+15.82 TO STA 380+50.00 (NC)

- ① EX. P.C.C. PAVEMENT, 16"
- ② EX. P.C.C. BASE COURSE, 8"
- ③ EX. AGG. SUBBASE AND BASE COURSE, MIN. 6"
- ④ EX. BITUMINOUS OVERLAY \*
- ⑤ EX. P.C.C. BASE COURSE WIDENING
- ⑥ EX. AGG. SHOULDER
- ⑦ EX. BITUMINOUS SHOULDER, 8"
- ⑧ PR. HMA SURFACE REMOVAL, 1 1/2"
- ⑨ PR. HMA LEVELING BINDER, N50, 3/4"
- ⑩ PR. HMA SURFACE COURSE, MIX C N50, 1 1/2"
- ⑪ PR. AGG. WEDGE SHOULDER, TYPE B
- ⑫ PR. PAVEMENT MARKING, 5"

• NOTE: STA 287+68.48 TO STA 368+07.80, 4 1/2"  
 STA 368+07.80 TO STA 380+50.00, 4 1/2" (LT 6') TO 9 1/4" (RT 16')  
 STA 380+50.00 TO STA 510+96.64, 9 1/4"

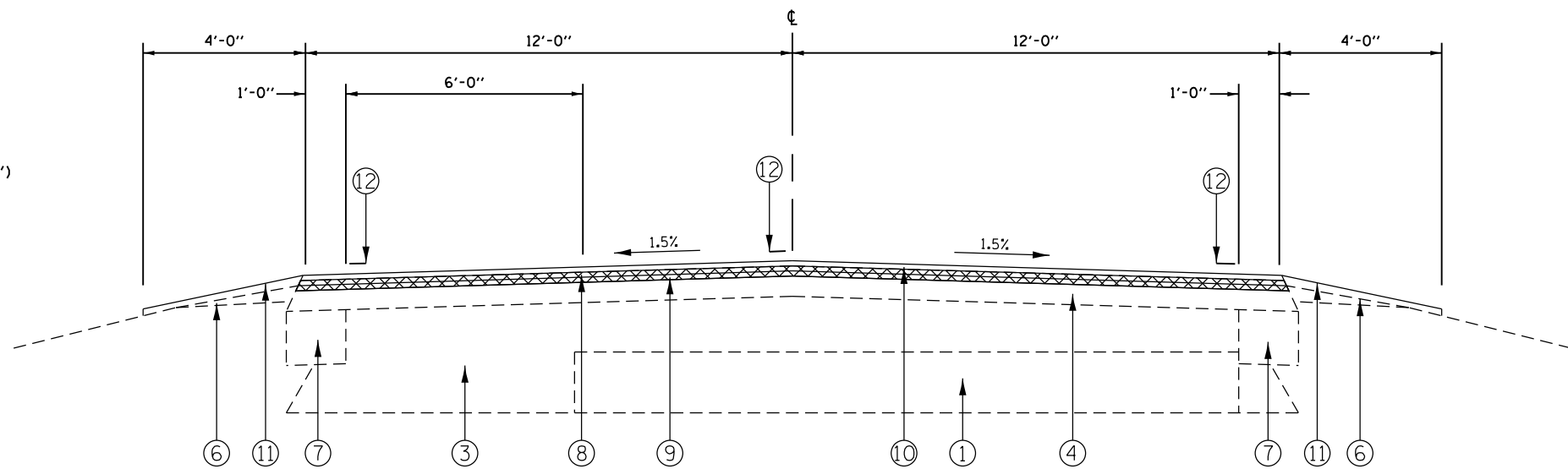

STA 380+50.00 TO STA 392+00.00 (NC)  
 STA 402+43.00 TO STA 437+95.00 (NC)  
 STA 442+55.00 TO STA 452+75.00 (NC)  
 STA 454+10.00 TO STA 455+50.00 (NC)  
 STA 460+38.00 TO STA 460+64.00 (NC)  
 STA 473+23.00 TO STA 473+87.00 (NC)  
 STA 486+00.00 TO STA 486+54.00 (NC)  
 STA 496+00.00 TO STA 501+00.00 (NC)  
 STA 502+41.00 TO STA 503+37.00 (NC)

FILE NAME =	USER NAME = starkegc	DESIGNED -	REVISED -	<b>STATE OF ILLINOIS DEPARTMENT OF TRANSPORTATION</b>	<b>TYPICAL SECTIONS</b>	F.A.P. RTE.	SECTION	COUNTY	TOTAL SHEETS	SHEET NO.
pw:\IL\084EBIDINTEG.illinois.gov\PIDOT\Documents\IDOT Offices\District 6\Projects\0672\DRAWING\AD\Sheets\0672J17-sh:typical	PLotted	CHECKED -	REVISED -			658	(G) RS-7	MASON	27	9
Default	PLOT SCALE = 4.0000' / in.	DATE -	REVISED -			CONTRACT NO. 72J17			ILLINOIS FED. AID PROJECT	
	PLOT DATE = 6/24/2016					SCALE:	SHEET 2 OF 3 SHEETS	STA.	TO STA.	

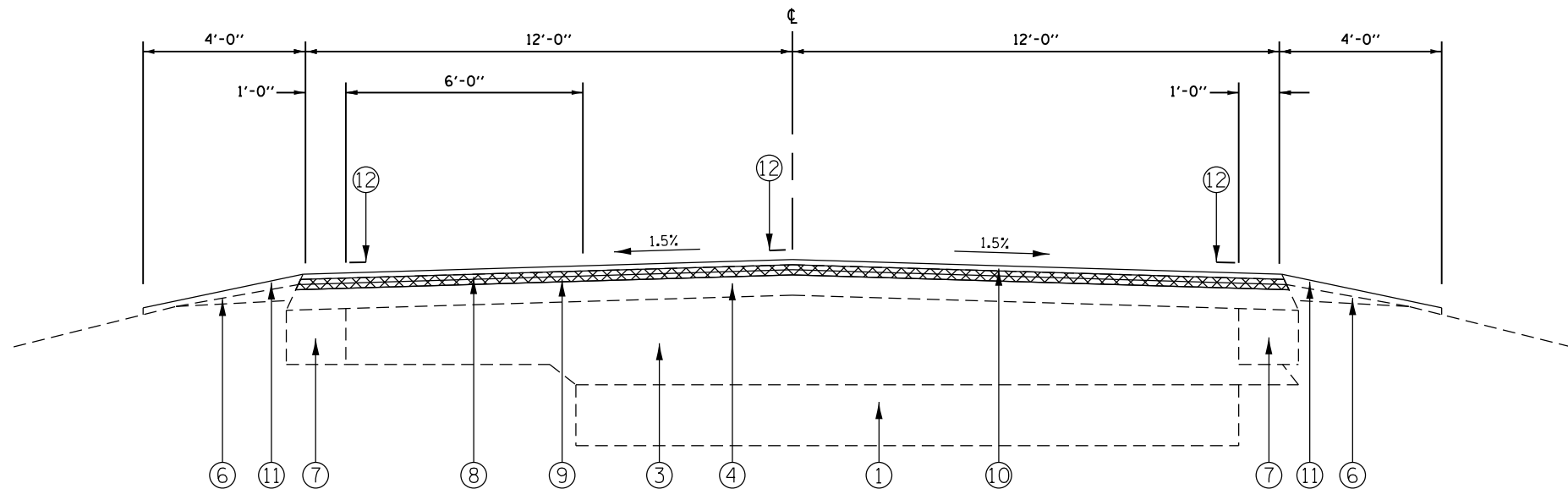

STA 392+00.00 TO STA 392+50.00 (NC)  
 STA 401+50.00 TO STA 402+43.00 (NC)  
 STA 437+95.00 TO STA 442+55.00 (NC)  
 STA 452+75.00 TO STA 454+10.00 (NC)  
 STA 460+64.00 TO STA 461+25.00 (NC)  
 STA 472+50.00 TO STA 473+23.00 (NC)  
 STA 486+54.00 TO STA 487+00.00 (NC)  
 STA 494+00.00 TO STA 494+85.00 (NC)  
 STA 501+00.00 TO STA 502+41.00 (NC)

- ① EX. P.C.C. PAVEMENT, 16"
- ② EX. P.C.C. BASE COURSE, 8"
- ③ EX. AGG. SUBBASE AND BASE COURSE, MIN. 6"
- ④ EX. BITUMINOUS OVERLAY \*
- ⑤ EX. P.C.C. BASE COURSE WIDENING
- ⑥ EX. AGG. SHOULDER
- ⑦ EX. BITUMINOUS SHOULDER, 8"
- ⑧ PR. HMA SURFACE REMOVAL, 1 1/2"
- ⑨ PR. HMA LEVELING BINDER, N50, 3/4"
- ⑩ PR. HMA SURFACE COURSE, MIX C N50, 1 1/2"
- ⑪ PR. AGG. WEDGE SHOULDER, TYPE B
- ⑫ PR. PAVEMENT MARKING, 5"

• NOTE: STA 287+68.48 TO STA 368+07.80, 4 1/2"  
 STA 368+07.80 TO STA 380+50.00, 4 1/2" (LT 6') TO 9 1/4" (RT 16')  
 STA 380+50.00 TO STA 510+96.64, 9 1/4"

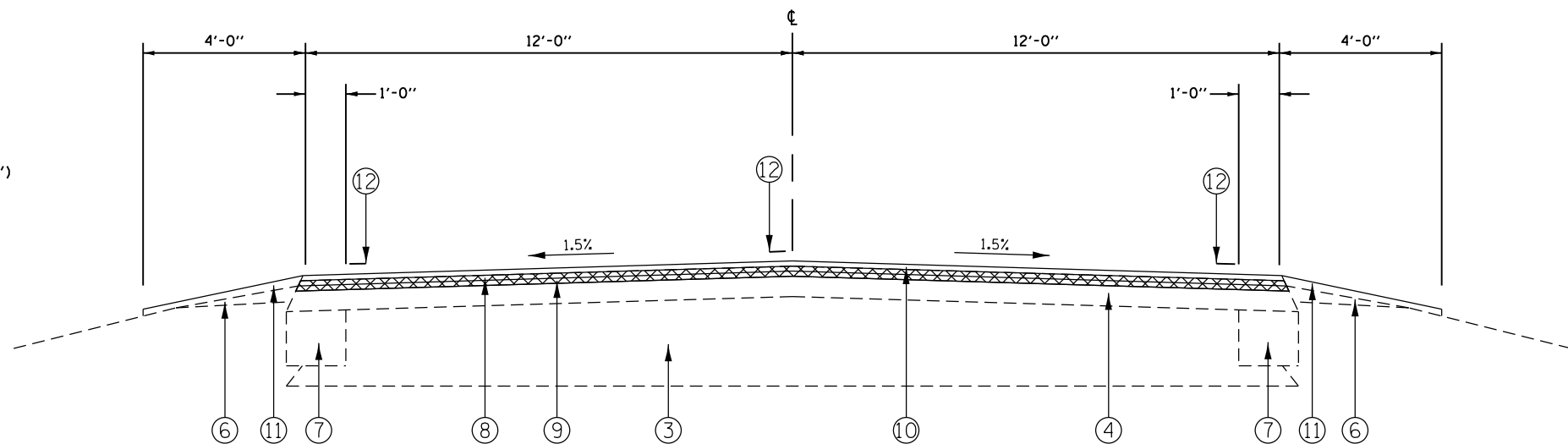

STA 392+50.00 TO STA 401+50.00 (NC)  
 STA 455+50.00 TO STA 460+38.00 (NC)  
 STA 461+25.00 TO STA 472+50.00 (NC)  
 STA 473+87.00 TO STA 486+00.00 (NC)  
 STA 487+00.00 TO STA 494+00.00 (NC)  
 STA 494+85.00 TO STA 496+00.00 (NC)  
 STA 503+37.00 TO STA 510+96.64 (NC)

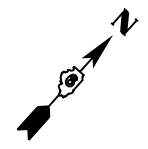
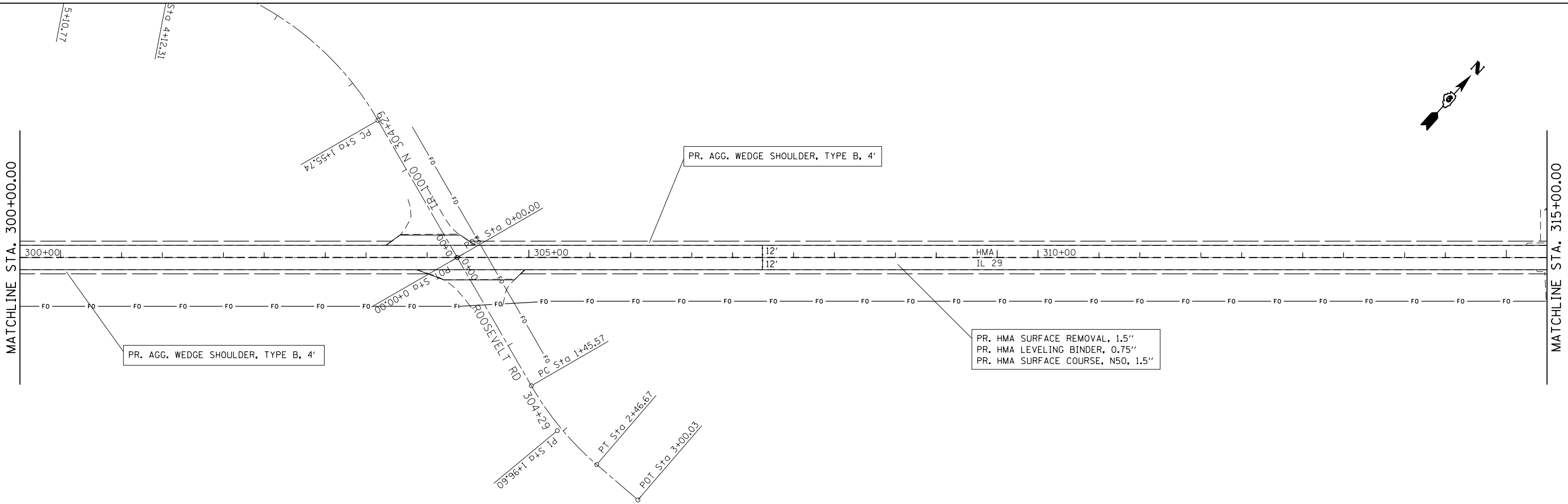
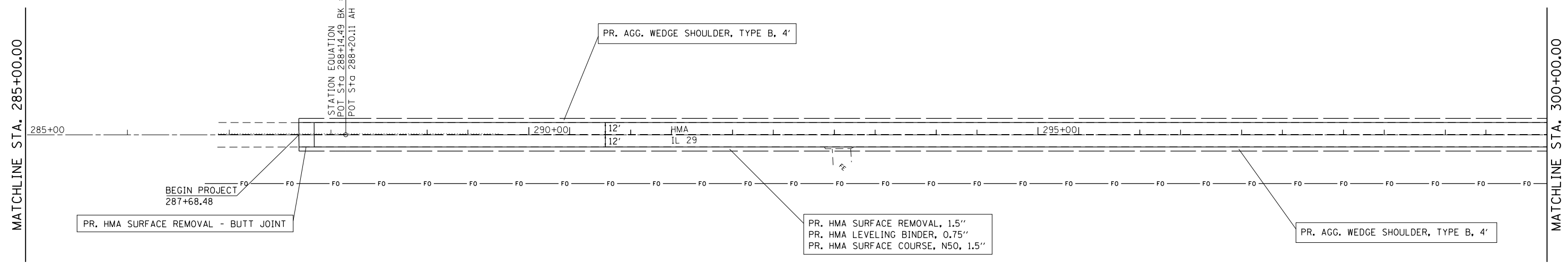
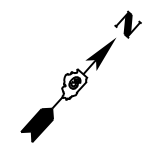

FILE NAME =	USER NAME = starkegc	DESIGNED -	REVISED -
pw:\IL\084EBIDINTEG\illinois.gov\PWIDOT\Documents\DOT Offices\District 6\Projects\0672\Drawings\AD\Drawings\0672\17-shr-Plan\0672.dwg		CHECKED -	REVISED -
Default	PLOT DATE = 6/24/2016	DATE -	REVISED -

**STATE OF ILLINOIS  
DEPARTMENT OF TRANSPORTATION**

<b>PLAN SHEETS</b>			
SCALE:	SHEET 1	OF 8 SHEETS	STA. TO STA.

F.A.P. RTE.	SECTION	COUNTY	TOTAL SHEETS	SHEET NO.
658	(G) RS-7	MASON	27	11
CONTRACT NO. 72J17				
ILLINOIS FED. AID PROJECT				

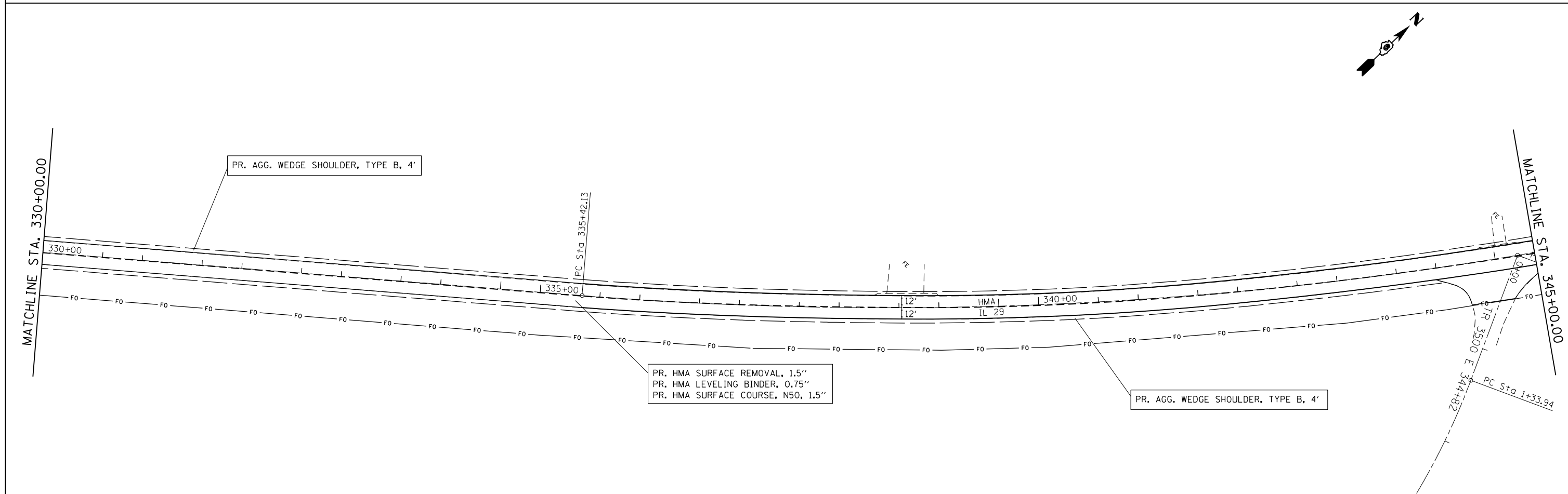
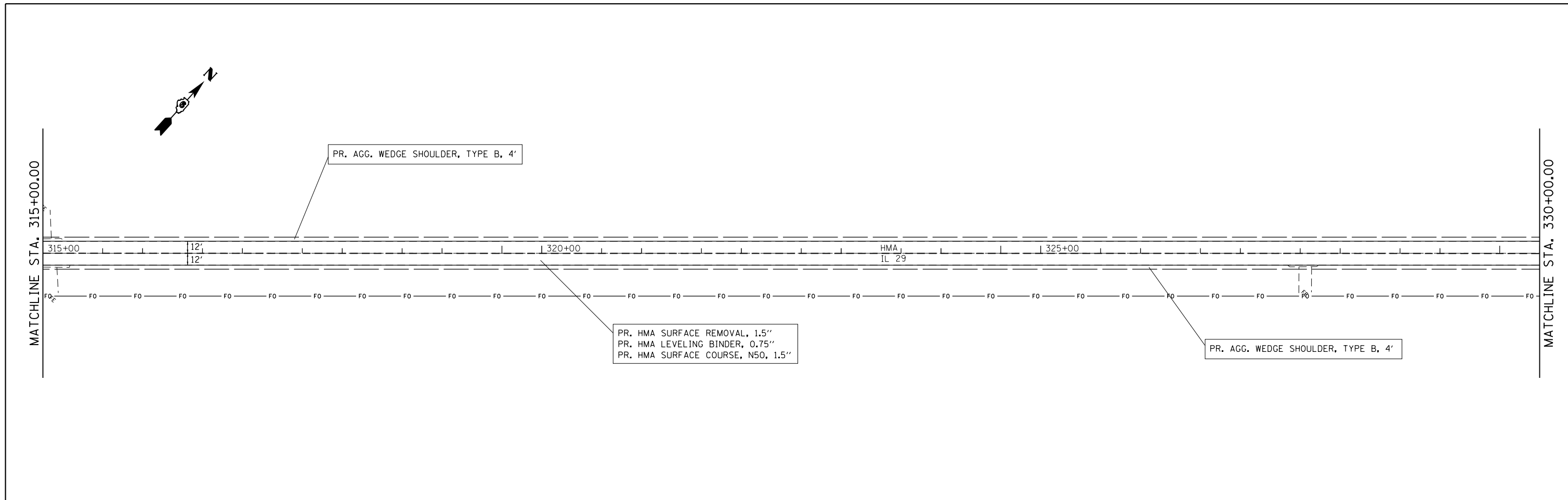

FILE NAME =	USER NAME = starkegc	DESIGNED -	REVISED -	<b>STATE OF ILLINOIS DEPARTMENT OF TRANSPORTATION</b>	<b>PLAN SHEETS</b>			F.A.P. RTE.	SECTION	COUNTY	TOTAL SHEETS	SHEET NO.
pw:\IL\084EBIDINTEG.illinois.gov\PIWIDOT\Documents\IDOT Offices\District 6\Projects\0672\Drawings\AD\Drawings\0672\17-sht-Plan.dwg		CHECKED -	REVISED -		658	(G) RS-7	MASON	27	12			
Default	PLOT SCALE = 100.0000' / in.	DATE -	REVISED -		SCALE: SHEET 2 OF 8 SHEETS STA. TO STA.			CONTRACT NO. 72J17				
	PLOT DATE = 6/24/2016							ILLINOIS FED. AID PROJECT				

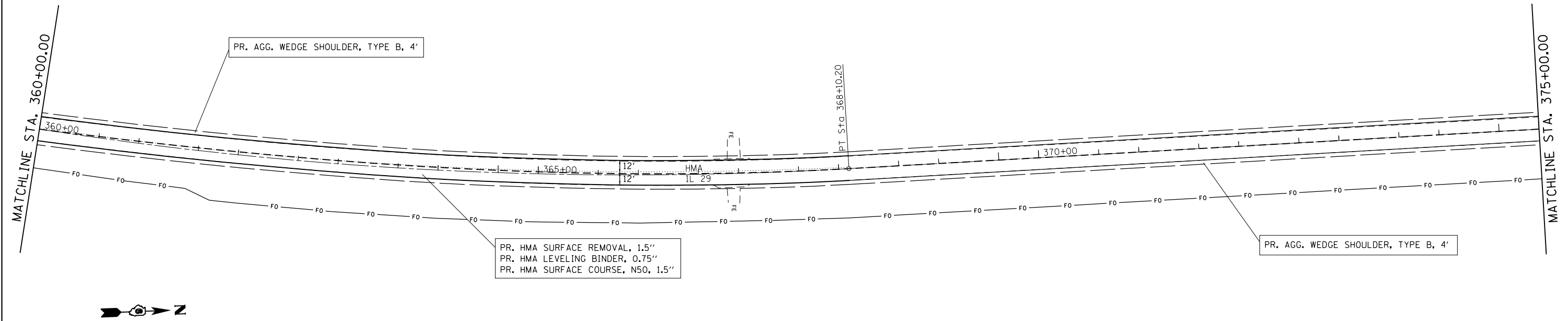
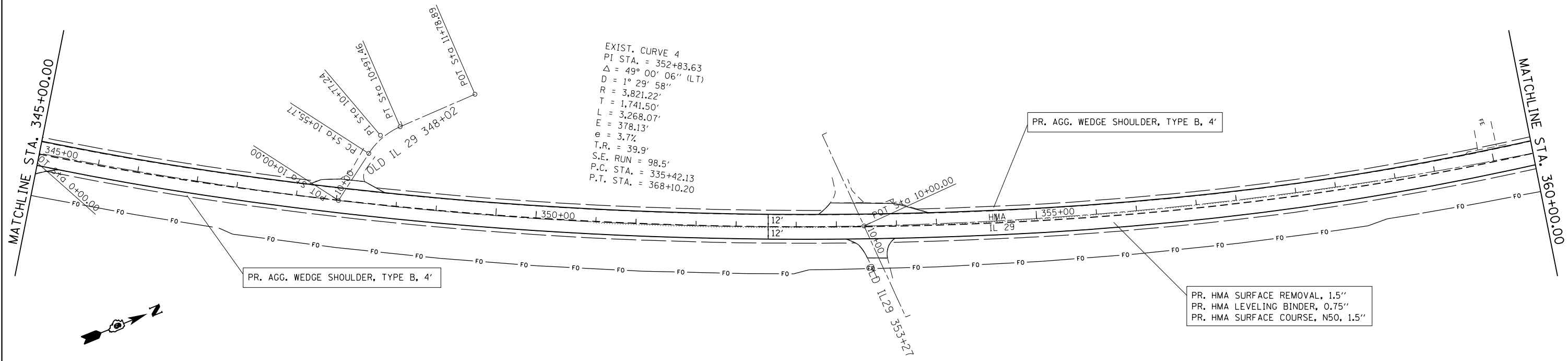

FILE NAME =	USER NAME = starkegc	DESIGNED -	REVISED -	<b>STATE OF ILLINOIS DEPARTMENT OF TRANSPORTATION</b>	<b>PLAN SHEETS</b>			F.A.P. RTE.	SECTION	COUNTY	TOTAL SHEETS	SHEET NO.
pw:\IL\084EBIDINTEG.illinois.gov\PI\DOT\Documents\DOT Offices\District 6\Projects\0672\DRAWING\AD\Sheets\0672J17-sht-Plan.dwg		DRAWN -	REVISED -		658	(G) RS-7	MASON	27	13	CONTRACT NO. 72J17		
Default	PLOT SCALE = 100.0000' / in.	CHECKED -	REVISED -		SCALE:	SHEET 3	OF 8 SHEETS	STA.	TO STA.	ILLINOIS FED. AID PROJECT		
	PLOT DATE = 6/24/2016	DATE -	REVISED -									

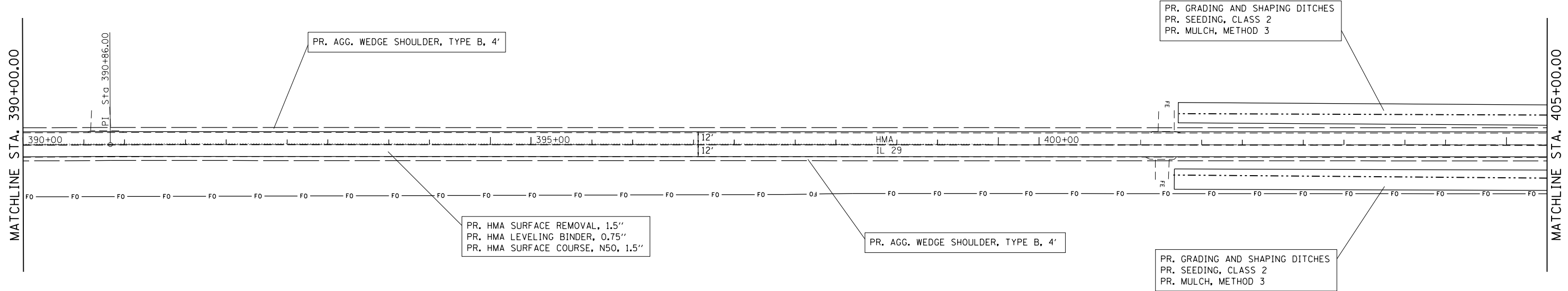
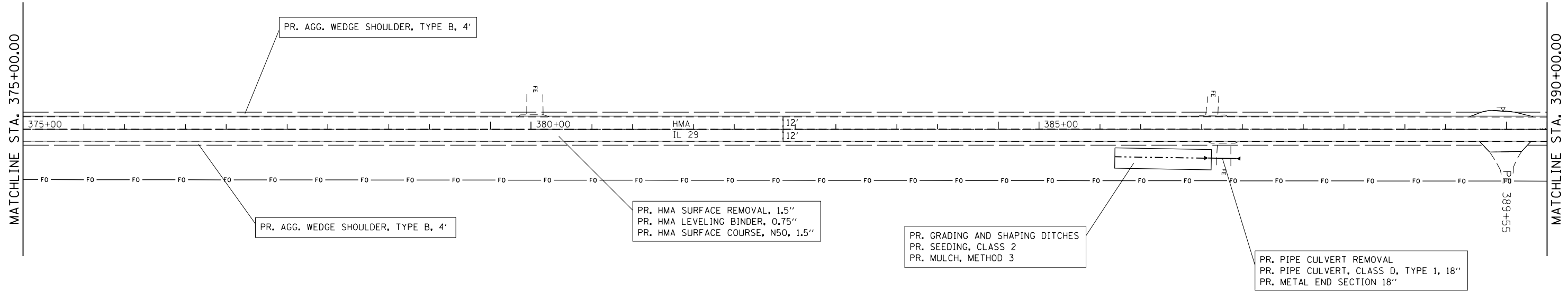

FILE NAME =	USER NAME = starkegc	DESIGNED -	REVISED -
pw:\IL084EBIDINTEG\illinois.gov\PI\DOT\Documents\IDOT Offices\District 6\Projects\0672\DRAWING\LEADSheets\0672J17-shr-Plan.dwg		REVISION	REVISED -
	PLOT SCALE = 100.0000' / in.	CHECKED -	REVISED -
Default	PLOT DATE = 6/24/2016	DATE -	REVISED -

**STATE OF ILLINOIS  
DEPARTMENT OF TRANSPORTATION**

**PLAN SHEETS**

SCALE: SHEET 4 OF 8 SHEETS STA. TO STA.

F.A.P. RTE.	SECTION	COUNTY	TOTAL SHEETS	SHEET NO.
658	(G) RS-7	MASON	27	14
CONTRACT NO. 72J17				
ILLINOIS FED. AID PROJECT				

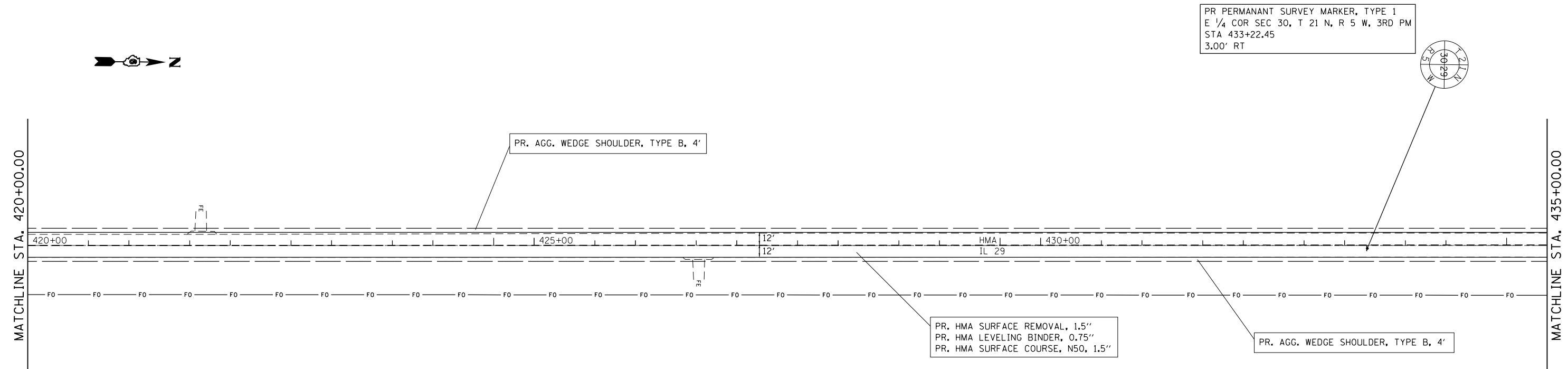
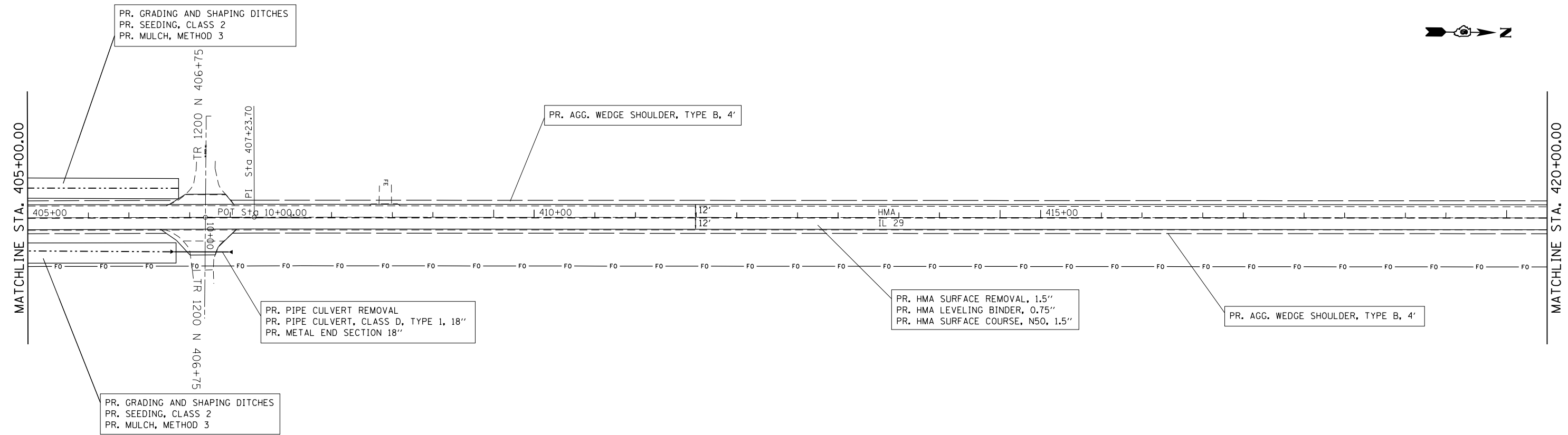

FILE NAME =	USER NAME = starkegc	DESIGNED -	REVISED -
pw:\IL\084EBIDINTEG\illinois.gov\PWIDOT\Documents\IDOT Offices\District 6\Projects\D672\DRAWING\LEADSheets\D672J17-shr-Plan1.dwg		CHECKED -	REVISED -
Default	PLOT SCALE = 100.0000' / in.	DATE -	REVISED -
	PLOT DATE = 6/24/2016		

**STATE OF ILLINOIS  
DEPARTMENT OF TRANSPORTATION**

**PLAN SHEETS**

SCALE: SHEET 5 OF 8 SHEETS STA. TO STA.

F.A.P. RTE.	SECTION	COUNTY	TOTAL SHEETS	SHEET NO.
658	(G) RS-7	MASON	27	15
CONTRACT NO. 72J17				
ILLINOIS FED. AID PROJECT				

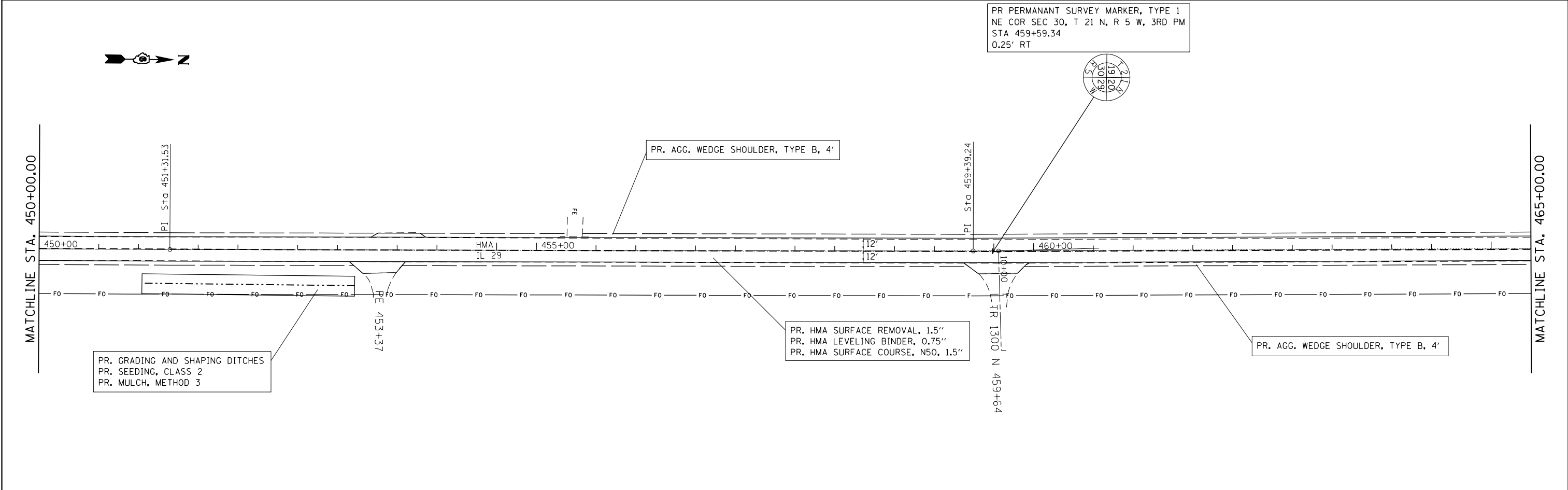
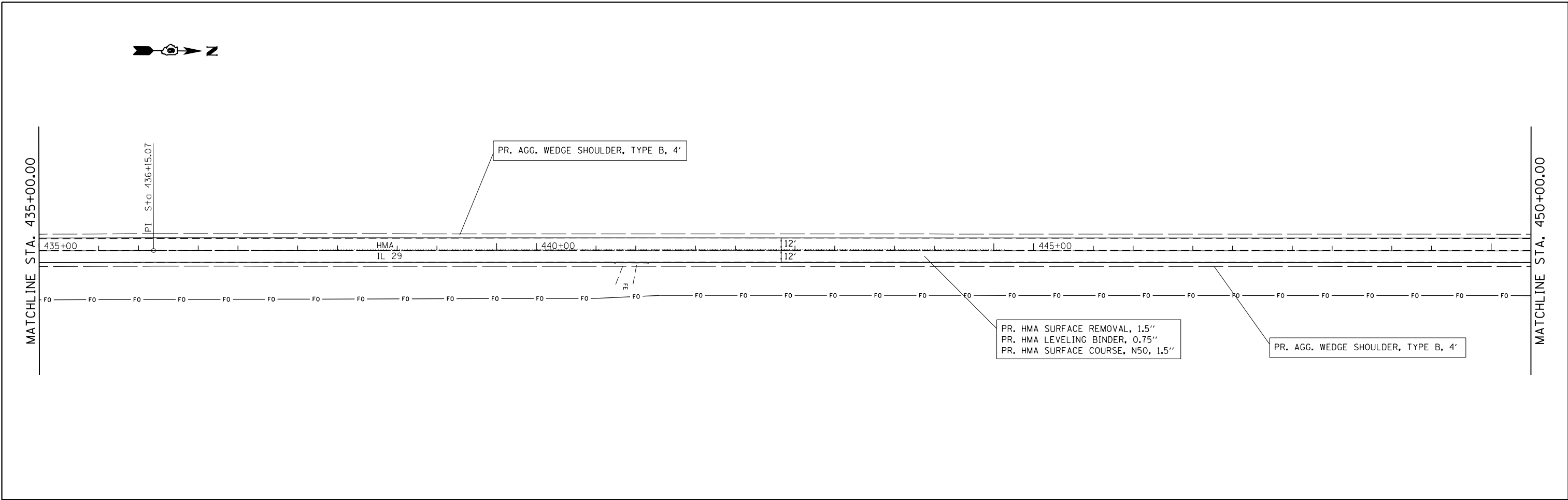

FILE NAME =	USER NAME = starkegc	DESIGNED -	REVISED -	<b>STATE OF ILLINOIS DEPARTMENT OF TRANSPORTATION</b>	<b>PLAN SHEETS</b>			F.A.P. RTE.	SECTION	COUNTY	TOTAL SHEETS	SHEET NO.
pw:\IL\084EBIDINTEG.illinois.gov\PWIDOT\Documents\DOT Offices\District 6\Projects\0672\DRAWING\LEADSheets\0672J17-sht-Plan1.dwg		REVISIONS	REVISIONS		658	(G) RS-7	MASON	27	16	CONTRACT NO. 72J17		
Default	PLOT SCALE = 100.0000' / in.	CHECKED -	REVISIONS		SCALE:	SHEET 6 OF 8 SHEETS	STA.	TO STA.	ILLINOIS FED. AID PROJECT			
	PLOT DATE = 6/24/2016	DATE -	REVISIONS									



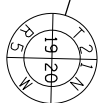
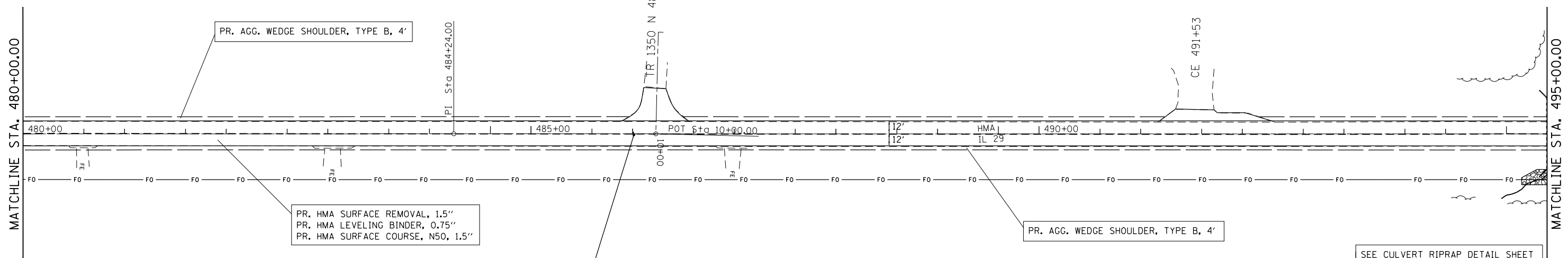
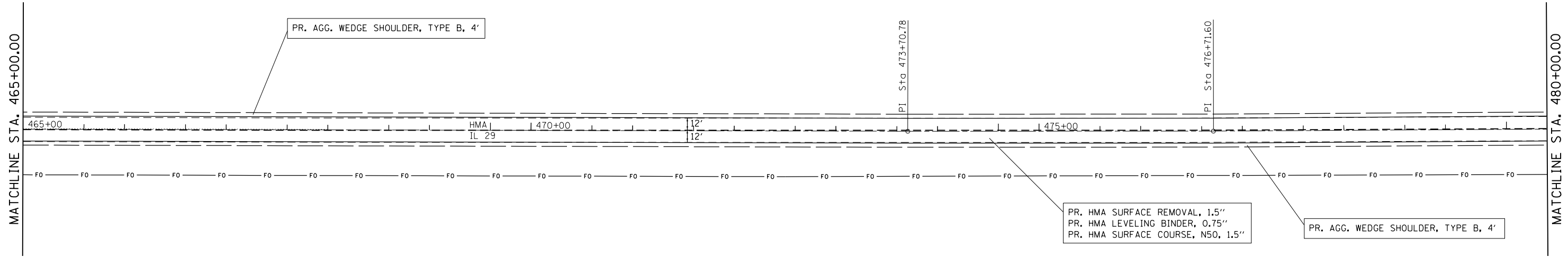

PR PERMANANT SURVEY MARKER, TYPE 1  
 E 1/4 COR SEC 19, T 21 N, R 5 W, 3RD PM  
 STA 486+01.31  
 0.84' RT

FILE NAME =	USER NAME = starkegc	DESIGNED -	REVISED -
pw:\IL084EBIDINTEG.illinois.gov\PIWIDOT\Documents\IDOT Offices\District 6\Projects\0672\DRAWING\ADSheets\0672J17-sht-Plan.dwg		REVISIONS	REVISIONS
Default	PLOT SCALE = 100.0000' / in.	CHECKED -	REVISED -
	PLOT DATE = 6/24/2016	DATE -	REVISED -

**STATE OF ILLINOIS  
 DEPARTMENT OF TRANSPORTATION**

**PLAN SHEETS**

SCALE: SHEET 7 OF 8 SHEETS STA. TO STA.

F.A.P. RTE.	SECTION	COUNTY	TOTAL SHEETS	SHEET NO.
658	(G) RS-7	MASON	27	17
CONTRACT NO. 72J17				
ILLINOIS FED. AID PROJECT				

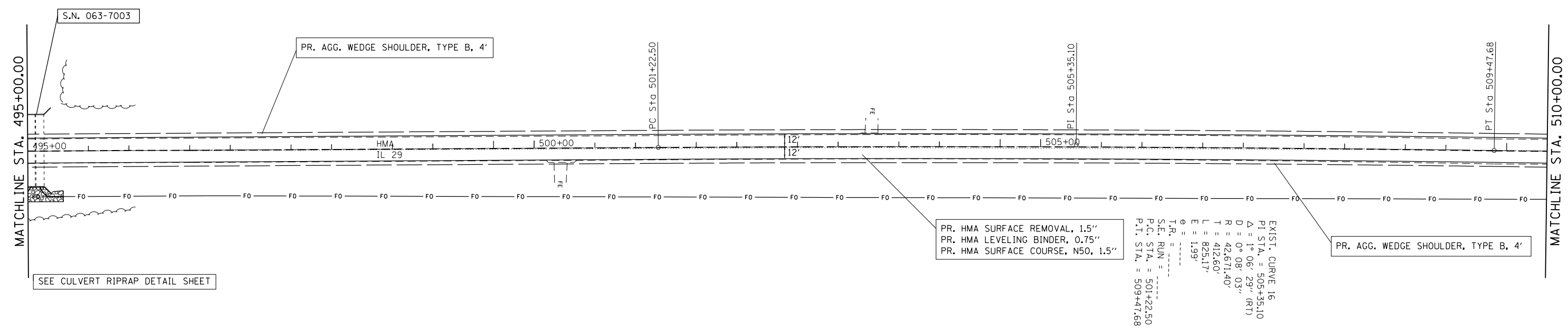

EXIST. CURVE 16  
 P.I. STA. = 505+35.10  
 $\Delta = 1^\circ 06' 29''$  (RT)  
 $D = 0^\circ 08' 03''$   
 $R = 42,671.40'$   
 $T = 412.60'$   
 $L = 825.17'$   
 $E = 1.99'$   
 $\theta = \dots$   
 T.R. = \dots  
 S.E. RUN = \dots  
 P.C. STA. = 501+22.50  
 P.T. STA. = 509+47.68

SEE CULVERT RIPRAP DETAIL SHEET

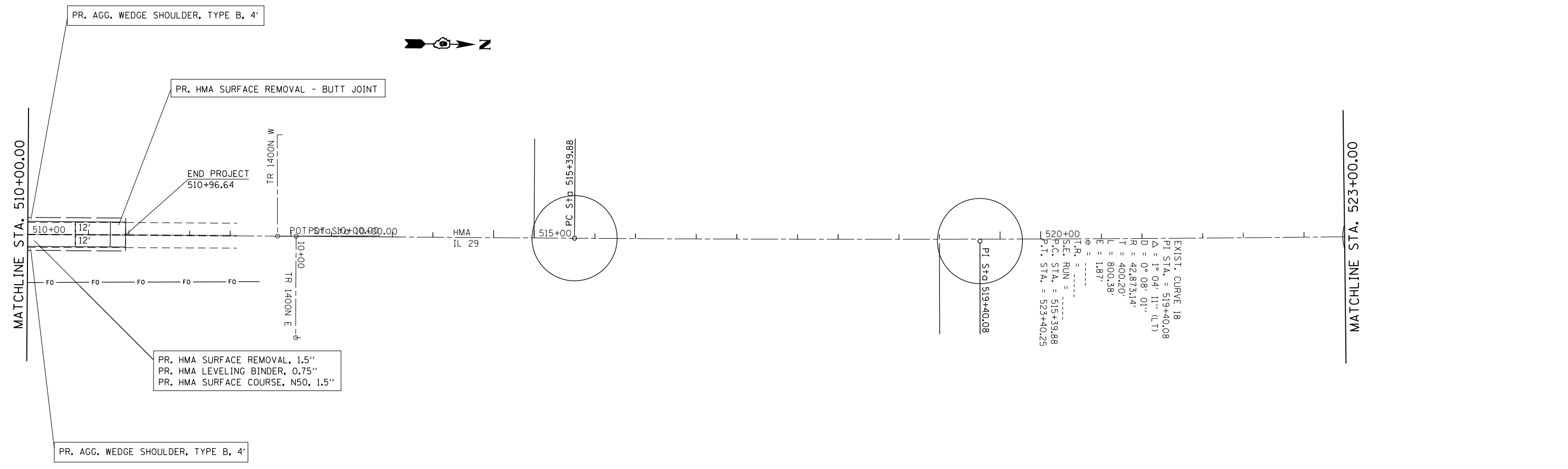

EXIST. CURVE 18  
 P.I. STA. = 519+40.08  
 $\Delta = 1^\circ 04' 11''$  (LT)  
 $D = 0^\circ 08' 01''$   
 $R = 42,873.14'$   
 $T = 400.20'$   
 $L = 800.38'$   
 $E = 1.87'$   
 $\theta = \dots$   
 T.R. = \dots  
 S.E. RUN = \dots  
 P.C. STA. = 515+39.88  
 P.T. STA. = 523+40.25

FILE NAME =	USER NAME = storkegc	DESIGNED -	REVISED -	<b>STATE OF ILLINOIS DEPARTMENT OF TRANSPORTATION</b>	<b>PLAN SHEETS</b>			F.A.P. RTE.	SECTION	COUNTY	TOTAL SHEETS	SHEET NO.
pw:\IL\084EBIDINTEG.illinois.gov\PI\DOT\Documents\DOT Offices\District 6\Projects\0672\DRAWING\AD\Sheets\0672J17-sht-Plan.dwg	PLOT SCALE = 100.0000' / in.	CHECKED -	REVISED -		658	(G) RS-7	MASON	27	18			
Default	PLOT DATE = 6/24/2016	DATE -	REVISED -		SCALE: SHEET 8 OF 8 SHEETS STA. TO STA.			CONTRACT NO. 72J17				
					ILLINOIS FED. AID PROJECT							

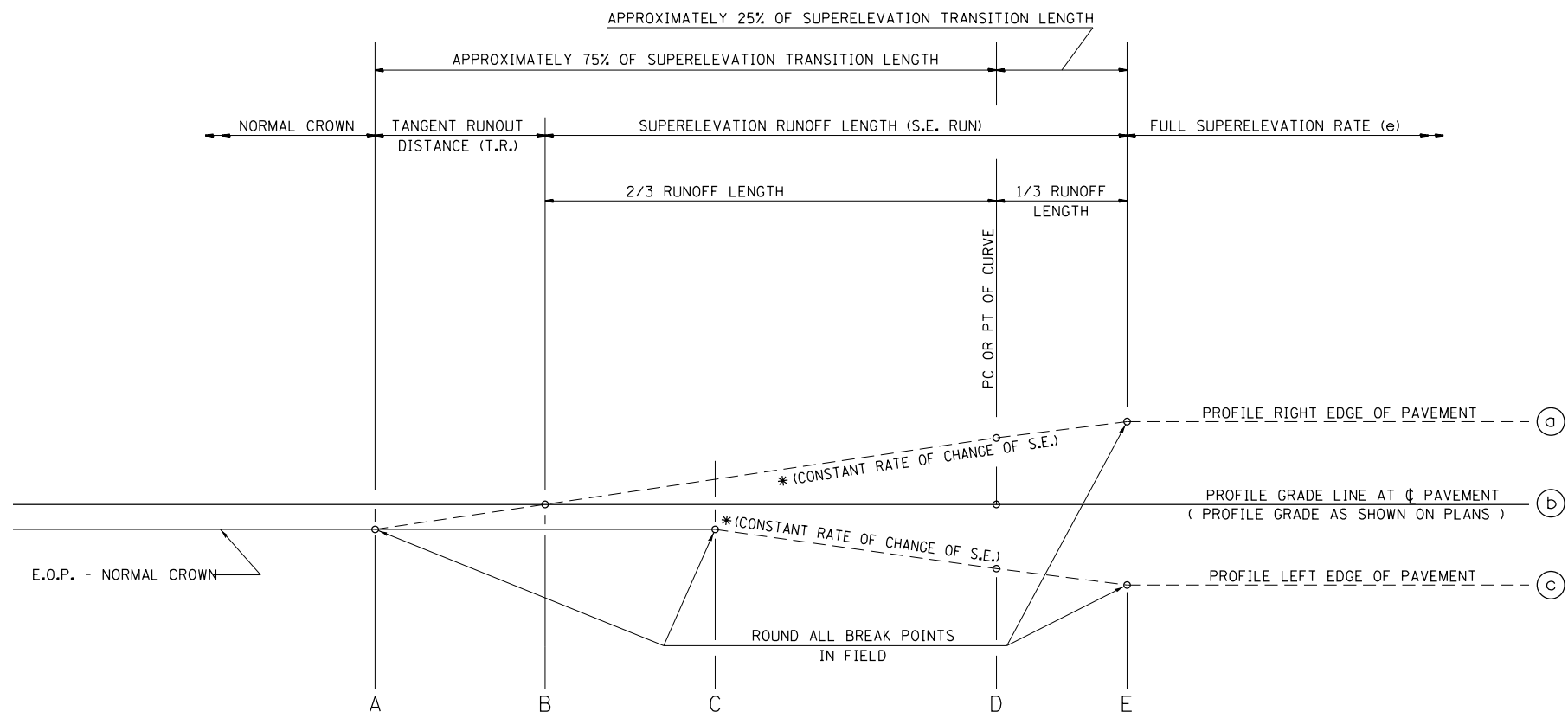

SEE PLANS FOR CURVE DATA INFORMATION  
 CURVE DATA  
 P.I. STA=  
 $\Delta$ =  
 R=  
 T=  
 L=  
 E=  
 e= SUPERELEVATION RATE IN PERCENT  
 T.R.= TANGENT RUNOUT DISTANCE  
 S.E. RUN= SUPERELEVATION RUNOFF LENGTH  
 P.C. STA=  
 P.T. STA=

TYPICAL PROFILE - S.E. TRANSITION

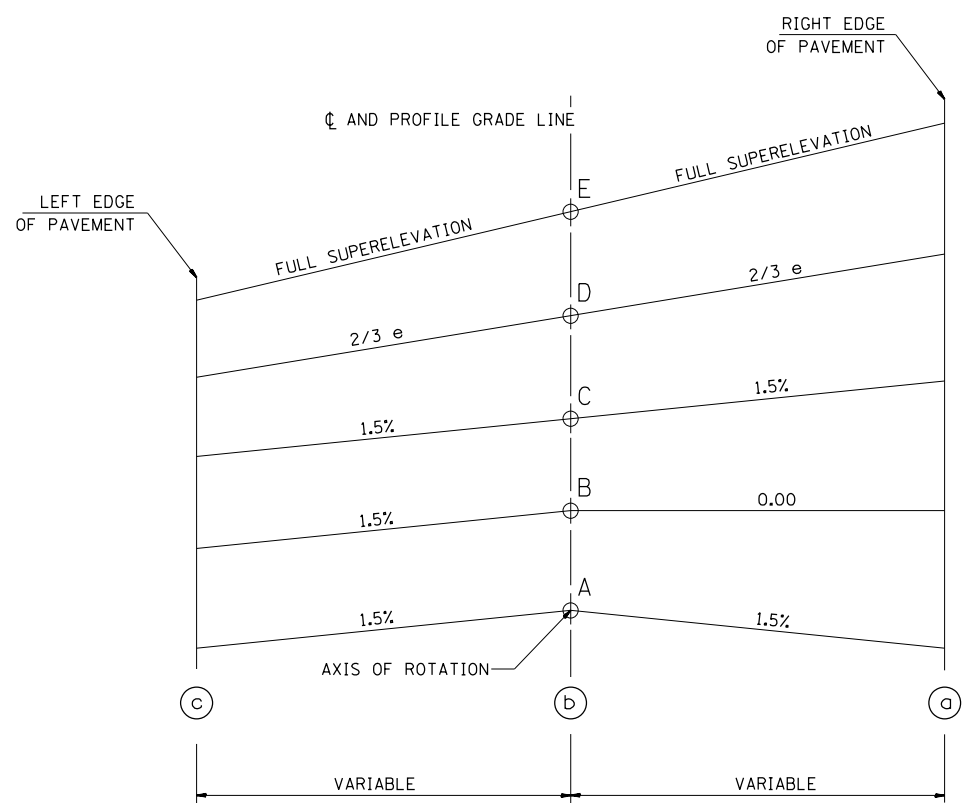

TYPICAL CROSS SECTION - S.E. TRANSITION

CURVE NO.	e	A	B	C	D	E	TRANSITION
4	3.7%	334+36.51	334+76.41	335+16.31	335+42.13	335+74.91	Trans. In
		369+15.82	368+75.92	368+36.02	368+10.20	367+77.42	Trans. Out

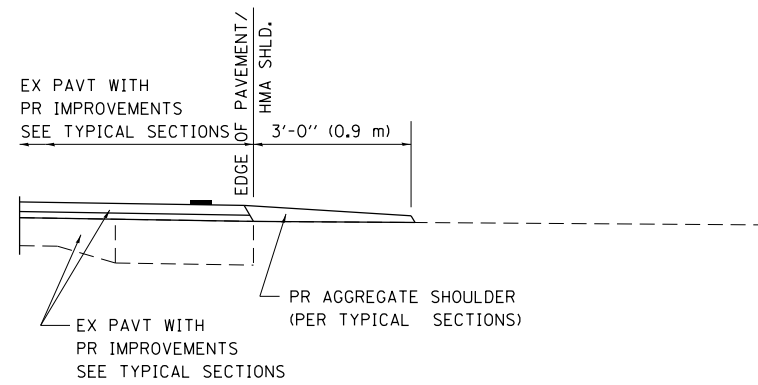

**SECTION A-A FOR EX EARTH/ AGGREGATE FE**

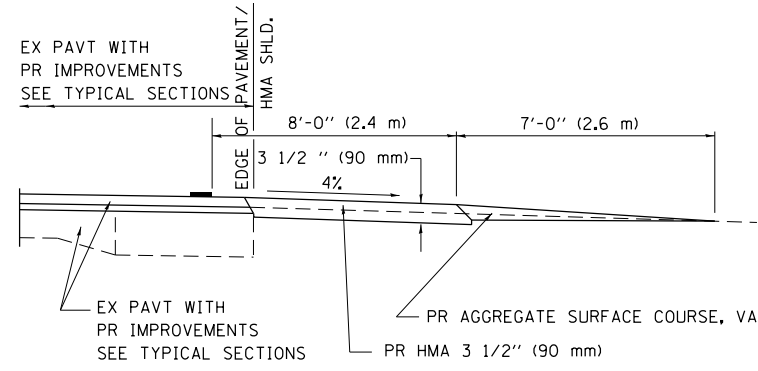

**SECTION A-A FOR EX EARTH/AGGREGATE PE**

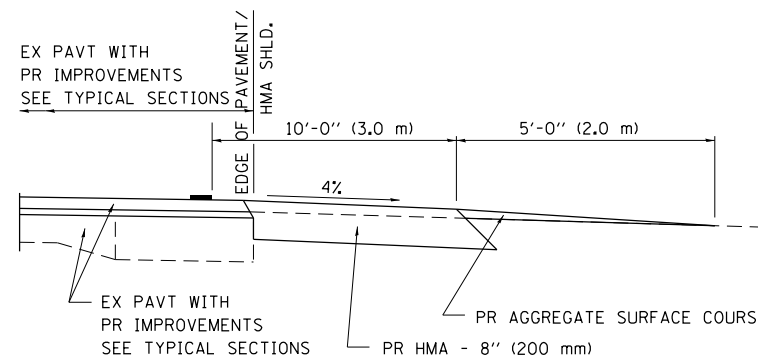

**SECTION A-A FOR EX EARTH/AGGREGATE CE & SIDE ROAD**

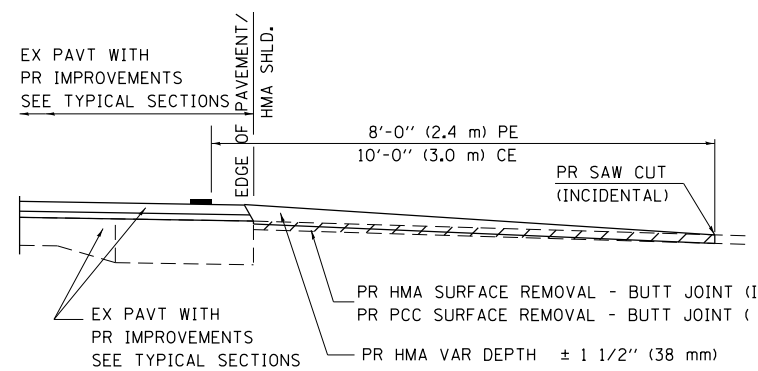

**SECTION A-A FOR EX HMA/ PC CONCRETE PE, CE & SIDE ROAD**

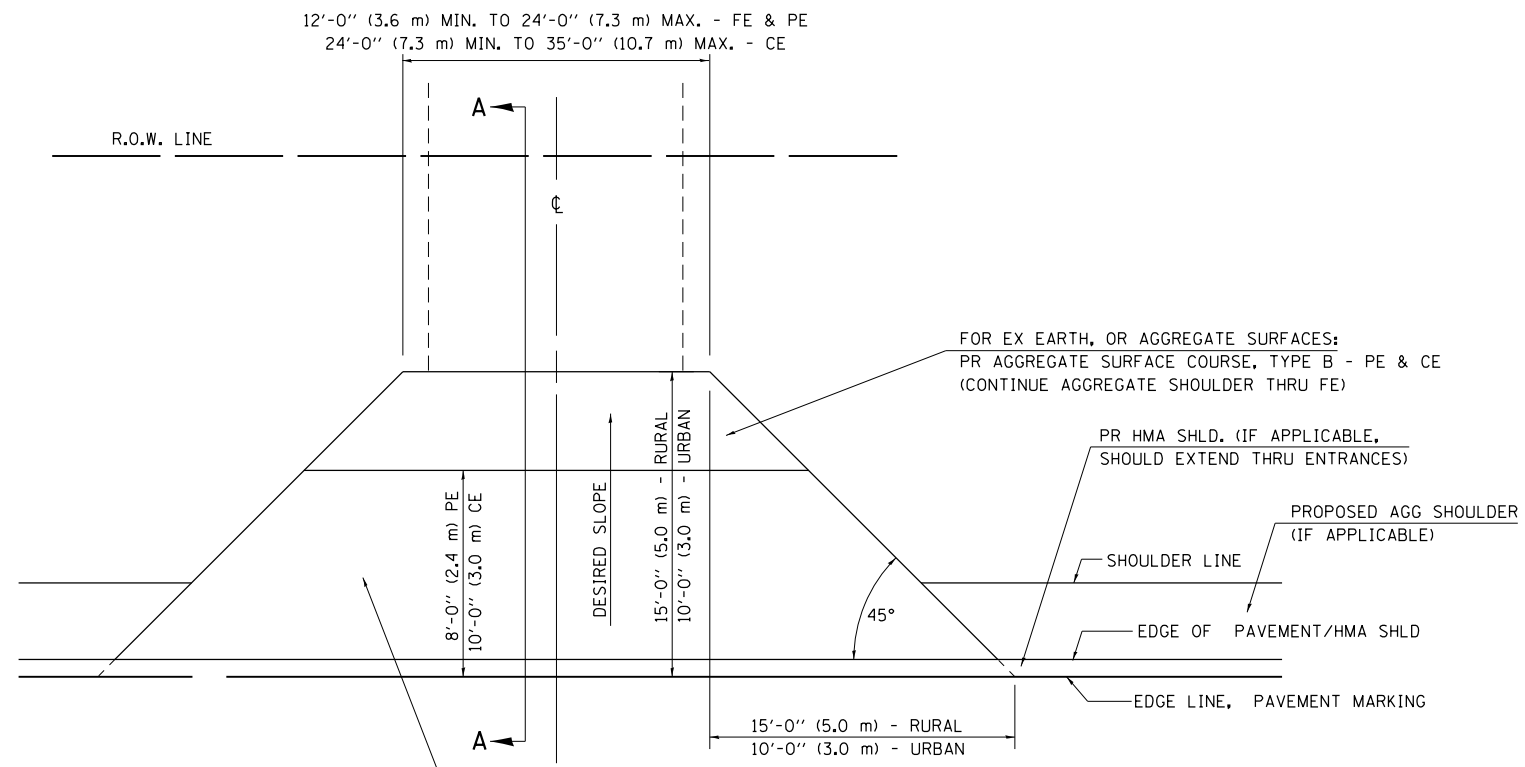

FOR EX EARTH OR AGGREGATE SURFACES:  
 PR HMA SURFACE REMOVAL (IF APPLICABLE)  
 PR AGGREGATE SHOULDER THRU - FE  
 PR HMA CONCRETE 3 1/2" (90 mm) - PE  
 PR HMA CONCRETE 8" (200 mm) - CE

FOR EX HMA CONCRETE SURFACES:  
 PR HMA SURFACE REMOVAL-BUTT JOINT

FOR EX PCC SURFACES:  
 PR PCC SURFACE REMOVAL-BUTT JOINT

**GENERAL NOTES:**

THE RESIDENT ENGINEER WILL DETERMINE THE EXACT TYPE OF IMPROVEMENT TO BE COMPLETED FOR ALL ENTRANCES, SIDEROADS AND MAILBOX TURNOUTS ON THIS PROJECT.

THE PLAN DETAILS AND SCHEDULES SHOULD BE USED AS A GUIDE FOR THE ENGINEER TO IMPLEMENT THE FINAL DESIGN. THE ENGINEER MAY DECIDE TO SALVAGE PORTIONS OF THE EXISTING ENTRANCE PAVEMENT STRUCTURE; THEREFORE, REDUCING PAY ITEM QUANTITIES. NO ADDITIONAL PAYMENT WILL BE ALLOWED FOR THIS REDUCTION IN QUANTITIES.

ANY WORK THE ENGINEER REQUIRES WHICH IS NOT COVERED BY A PAY ITEM CONTAINED IN THE PLANS WILL BE PAID FOR IN ACCORDANCE WITH ARTICLE 109.04 OF THE STANDARD SPECIFICATIONS.

HMA CONCRETE REQUIRED TO CONSTRUCT THE ENTRANCES SHALL BE IN ACCORDANCE WITH THE APPLICABLE PORTIONS OF SECTION 406 AND 408 OF THE STANDARD SPECIFICATIONS AND AS DIRECTED BY THE ENGINEER.

WHEN THE HMA CONCRETE PROPOSED FOR THE IMPROVEMENT IS THICKER THAN 3 INCHES (75 mm) AND REQUIRE PLACEMENT IN MORE THAN ONE LIFT. THE BOTTOM LIFT(S) SHALL MEET THE REQUIREMENTS OF HMA BASE COURSE IN SECTION 406 OF THE STANDARD SPECIFICATIONS AND THE TOP LIFT OF 2 INCHES (50 mm) SHALL MEET THE REQUIREMENTS OF HMA CONCRETE SURFACE COURSE, SUPERPAVE.

THIS WORK WILL BE PAID FOR IN ACCORDANCE WITH SECTIONS 351, 358, 408, 423 AND 440 OF THE STANDARD SPECIFICATIONS.

ALL DIMENSIONS ARE IN INCHES ( MILLIMETERS ) UNLESS OTHERWISE SHOWN.

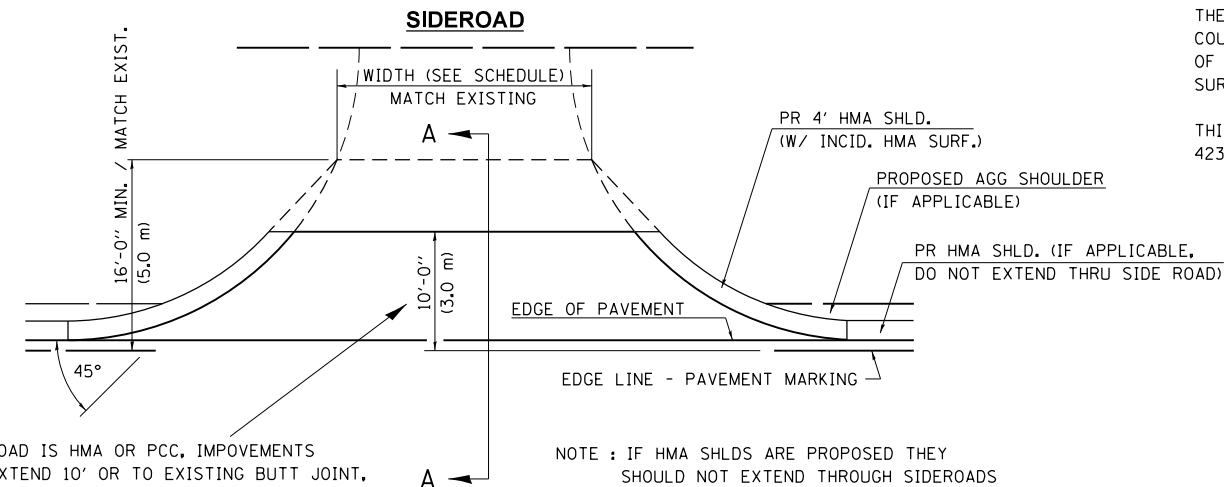

NOTE : IF SIDEROAD IS HMA OR PCC, IMPROVEMENTS SHOULD EXTEND 10' OR TO EXISTING BUTT JOINT, WHICHEVER IS GREATER

NOTE : IF HMA SHLDS ARE PROPOSED THEY SHOULD NOT EXTEND THROUGH SIDEROADS

FILE NAME =	USER NAME = storkgc	DESIGNED -	REVISED - 2/19/03 JCN	<b>STATE OF ILLINOIS DEPARTMENT OF TRANSPORTATION</b>	<b>DIST.6 DETAILS FOR RURAL/URBAN ENT., MAILBOX TURNOUT &amp; SIDEROADS W/O CONC. GUTTER (3P-PROJ.)</b>	F.A.P. R.T.E.	SECTION	COUNTY	TOTAL SHEETS	SHEET NO.	
ENT PPP.DGN		CHECKED - JCN	REVISED - 4/01/04 JCN			658	(G) RS-7	MASON	27	20	
		DATE - FEBRUARY 23, 1999	REVISED -			SCALE: SHEET OF SHEETS STA. TO STA.		CONTRACT NO. 72J17			
						ILLINOIS FED. AID PROJECT					

## DETAILS OF MAILBOX TURNOUTS

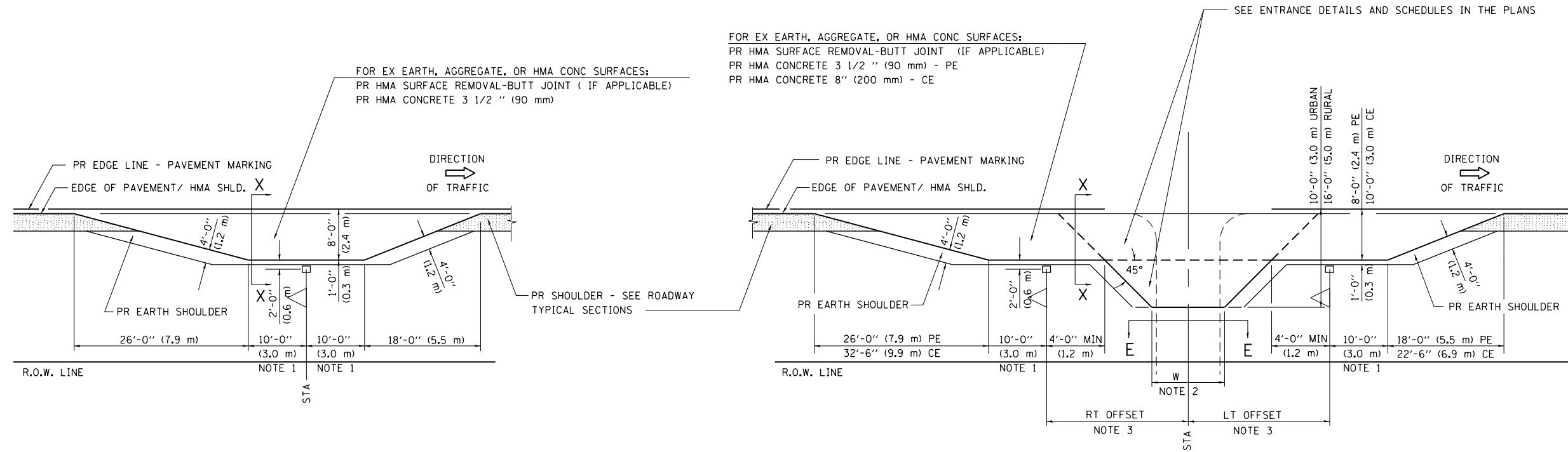

**PLAN - MAILBOX TURNOUTS**

**PLAN - COMBINED MAILBOX TURNOUT WITH TRAILING OR LEADING ENTRANCE**

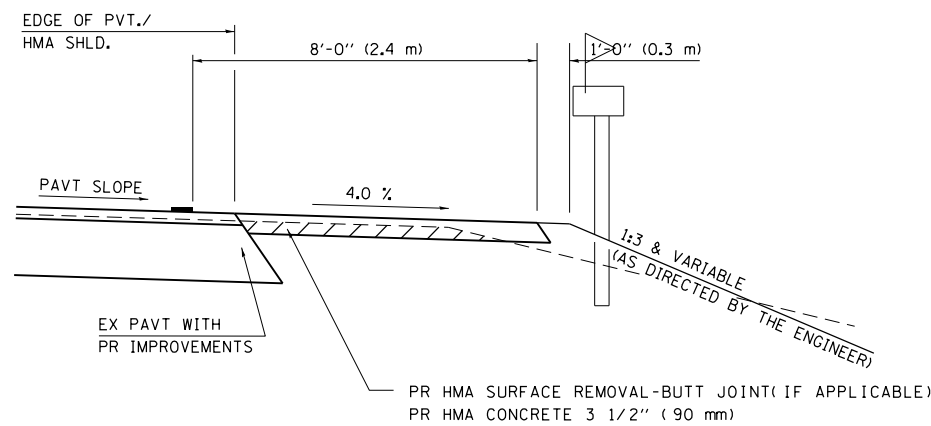

**SECTION X-X THRU MAILBOX TURNOUT  
ALSO APPLIES TO MAILBOX TURNOUTS COMBINED WITH  
EX EARTH, AGGREGATE, OR HMA PE & FE**

( DETAIL APPLIES WHEN M.B. TURNOUT DOES NOT EXIST.  
IF EXISTING, TREAT SAME AS ENTRANCE. )

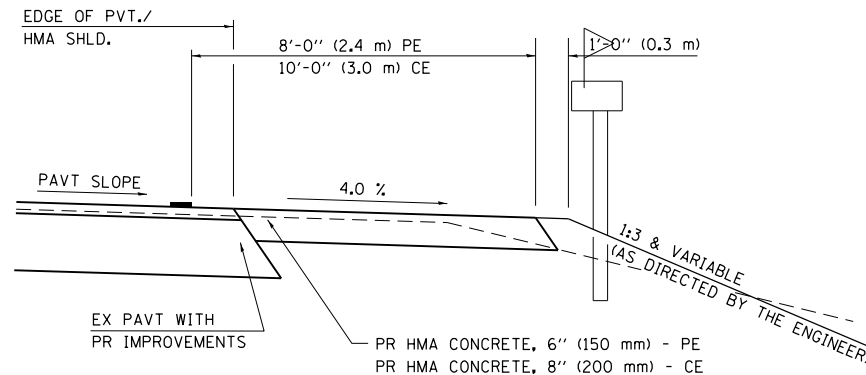

**SECTION X-X THRU MAILBOX TURNOUT  
COMBINED WITH EX HMA CONC & PC CONC PE & CE**

( DETAIL APPLIES WHEN M.B. TURNOUT DOES NOT EXIST.  
IF EXISTING, TREAT SAME AS ENTRANCE. )

- NOTE 1 IF MORE THAN ONE MAILBOX IS PRESENT, DIMENSION FROM CENTER OF END MAILBOX.
- NOTE 2 FOR ENTRANCE LAYOUT DIMENSIONS AND SECTIONS A-A & E-E REFER TO THE SCHEDULES IN THE PLANS.
- NOTE 3 BOTH LT OR RT OFFSETS FOR MAILBOX SHOWN USE OFFSET DIMENSION PER SCHEDULE AND REFER TO LAYOUT SHOWN ON THE PLAN.

ALL DIMENSIONS ARE IN INCHES ( MILLIMETERS )  
UNLESS OTHERWISE SHOWN.

FILE NAME =	USER NAME = starkegc	DESIGNED -	REVISED - 2/19/03 JCN
ENT PPP.DGN		CHECKED - JCN	REVISED - 4/01/04 JCN
		DATE - FEBRUARY 23, 1999	REVISED -

**STATE OF ILLINOIS  
DEPARTMENT OF TRANSPORTATION**

<b>DIST.6 DETAILS FOR RURAL/URBAN ENT., MAILBOX TURNOUT &amp; SIDEROADS W/O CONC. GUTTER (3P-PROJ.)</b>		F.A.P. RTE. 658	SECTION (G) RS-7	COUNTY MASON	TOTAL SHEETS 27	SHEET NO. 21
				CONTRACT NO. 72J17		
SCALE:		SHEET OF SHEETS		STA. TO STA.		ILLINOIS FED. AID PROJECT

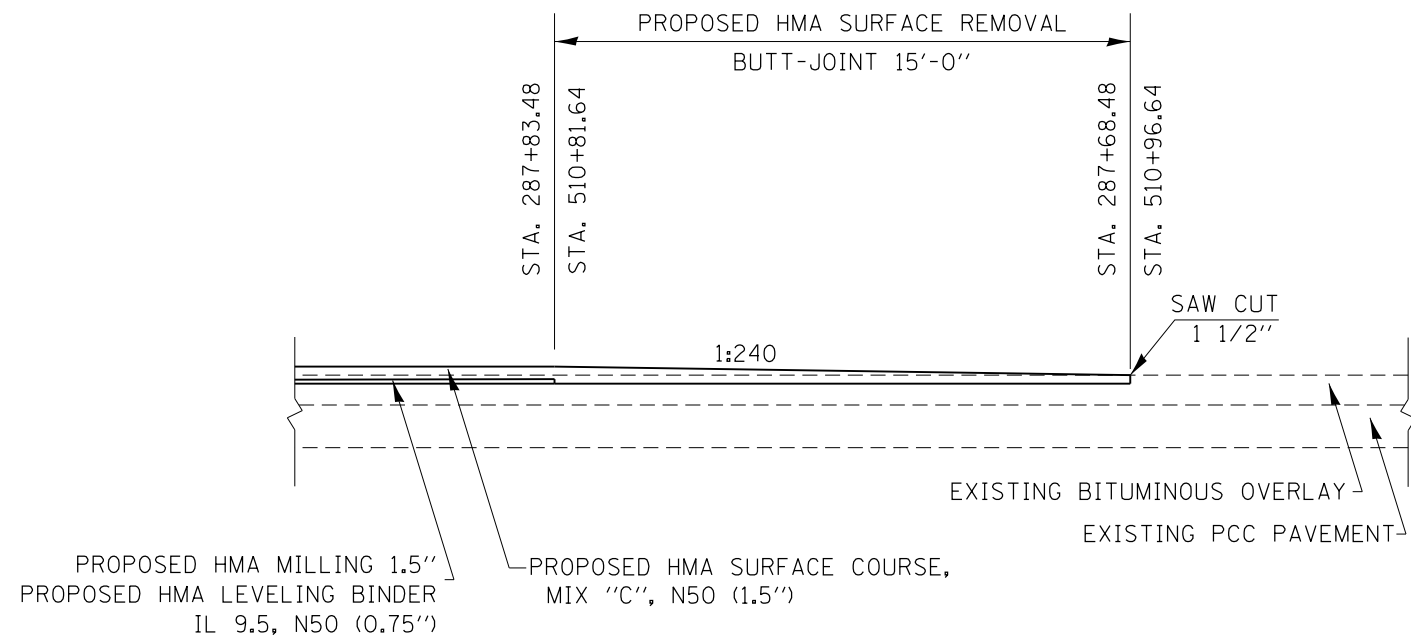

**BUTT-JOINT DETAIL**

STA. 287+68.48 TO STA. 287+83.48  
STA. 510+81.64 TO STA. 510+96.64

FILE NAME =	USER NAME = starkegc	DESIGNED -	REVISED -	<b>STATE OF ILLINOIS DEPARTMENT OF TRANSPORTATION</b>	<b>BUTT JOINT DETAIL FAP 658 (IL 29)</b>			F.A.P. RTE.	SECTION	COUNTY	TOTAL SHEETS	SHEET NO.
pw:\IL\084EBIDINTEG.illinois.gov\PIWIDOT\Documents\IDOT Offices\District 6\Projects\0672\Drawings\AD\Drawings\672J17-shr-detail.dwg	PLotted	CHECKED -	REVISED -					658	(G) RS-7	MASON	27	22
Default	PLOT SCALE = 40.0000' / in.	DATE -	REVISED -		SCALE: SHEET OF SHEETS STA. TO STA.			CONTRACT NO. 72J17				
	PLOT DATE = 6/24/2016	DATE -	REVISED -		ILLINOIS FED. AID PROJECT							

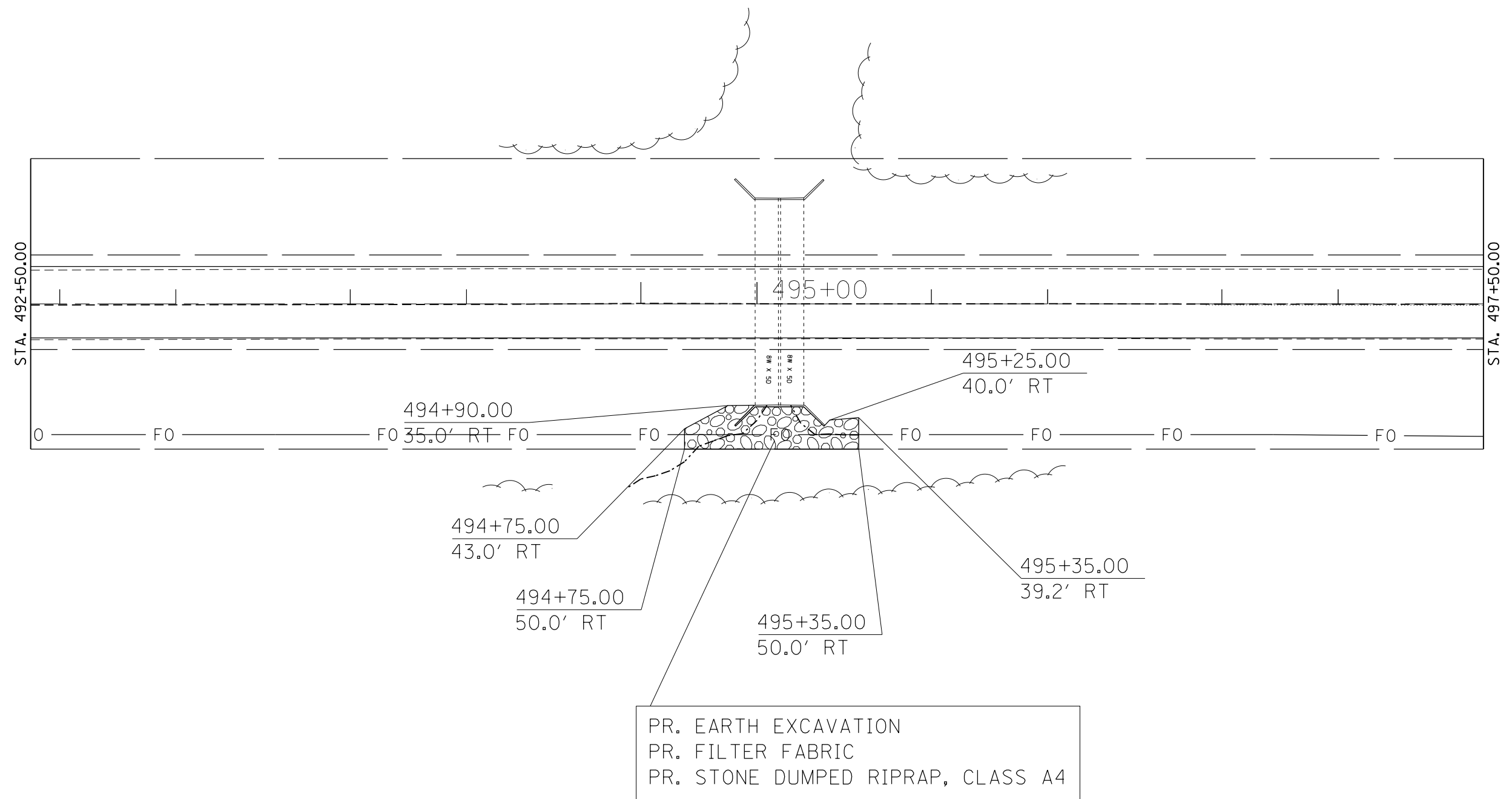

FILE NAME =	USER NAME = starkegc	DESIGNED -	REVISED -
p:\11\084EBIDINTEG.illinois.gov\PIWIDOT\Documents\DOT Offices\District 6\Projects\0672\Drawings\AD\Drawings\0672\17-shr-Plan\Culvert		DRAWN -	REVISED -
	PLOT SCALE = 40.0000' / in.	CHECKED -	REVISED -
	PLOT DATE = 6/24/2016	DATE -	REVISED -

**STATE OF ILLINOIS  
DEPARTMENT OF TRANSPORTATION**

<b>CULVERT RIPRAP DETAIL</b>			
<b>S.N. 063-7003</b>			
SCALE:	SHEET	OF SHEETS	STA. TO STA.

F.A.P. RTE.	SECTION	COUNTY	TOTAL SHEETS	SHEET NO.
658	(G) RS-7	MASON	27	23
CONTRACT NO. 72J17				
ILLINOIS FED. AID PROJECT				

DATE	
BY	
FINAL SURVEY	SURVEYED
NOTE BOOK	PLOTTED
NO.	TEMPLATE
	AREAS
	CHECKED

DATE	
BY	
ORIGINAL SURVEY	SURVEYED
NOTE BOOK	PLOTTED
NO.	TEMPLATE
	AREAS
	CHECKED

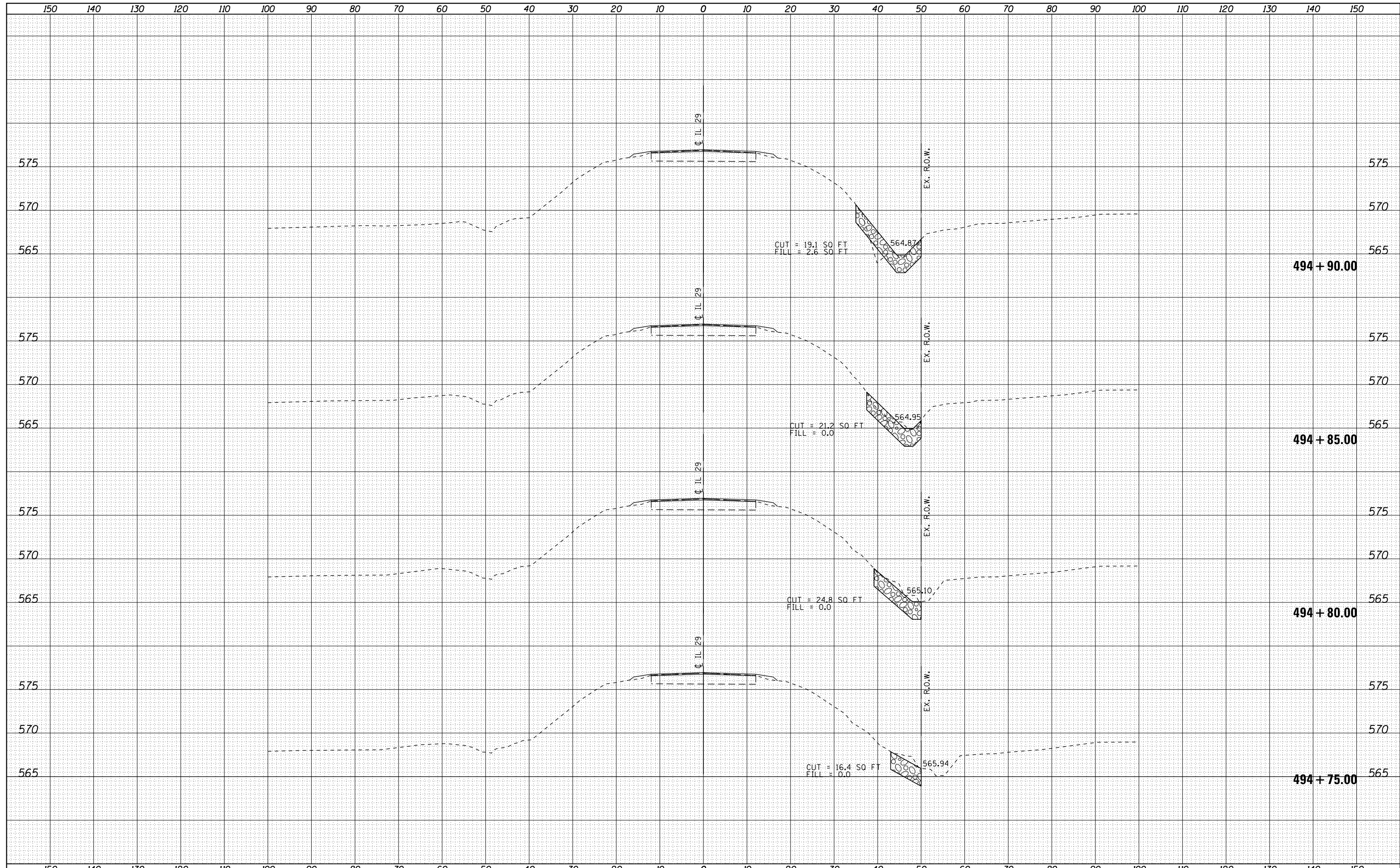

FILE NAME =	USER NAME = starkegc	DESIGNED -	REVISOR -	<b>STATE OF ILLINOIS</b> <b>DEPARTMENT OF TRANSPORTATION</b>	<b>CULVERT RIPRAP</b> <b>CROSS SECTIONS</b>	F.A.P. RTE.	SECTION	COUNTY	TOTAL SHEETS	SHEET NO.
p:\11084EBIDINTEG\Illinois.gov\PIDOT\Documents\IDOT Offices\District 6\Projects\0672J17\CADD\Drawings\0672J17-sht-xsections.dgn	PLotted	REVISOR -	REVISOR -			658	(G) RS-7	MASON	27	24
Culvert9	PLot SCALE = 20.0000' / in.	CHECKED -	REVISOR -			CONTRACT NO. 72J17			ILLINOIS FED. AID PROJECT	
	PLot DATE = 6/24/2016	DATE -	REVISOR -			SCALE:	SHEET	OF	SHEETS	STA. 494+75.00





DATE	
BY	
FINAL SURVEY	SURVEYED
NOTE BOOK	PLOTTED
NO.	TEMPLATE
	AREAS CHECKED

DATE	
BY	
ORIGINAL SURVEY	SURVEYED
NOTE BOOK	PLOTTED
NO.	TEMPLATE
	AREAS CHECKED

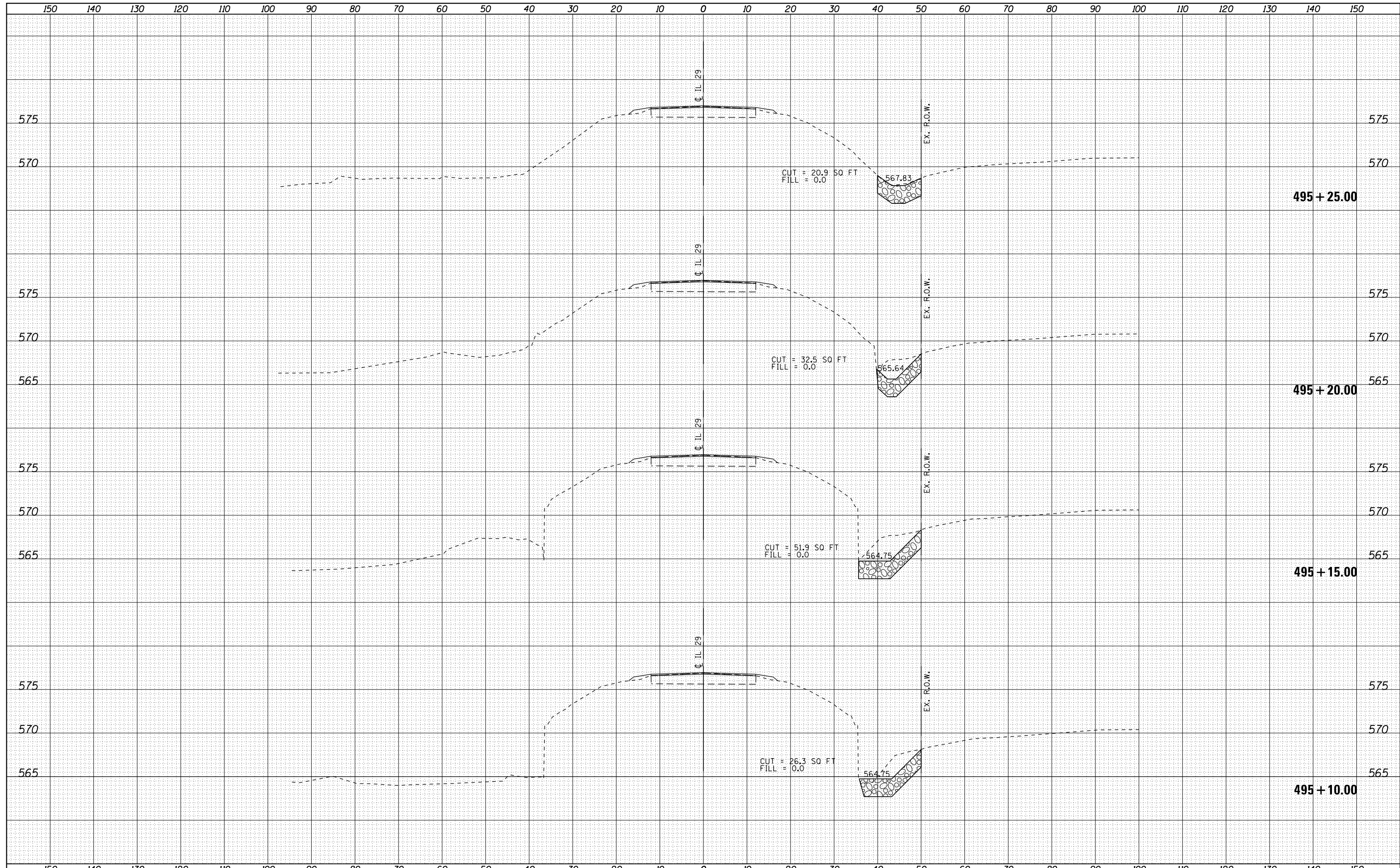

FILE NAME =	USER NAME = starkegc	DESIGNED -	REVISÉ -	<b>STATE OF ILLINOIS</b> <b>DEPARTMENT OF TRANSPORTATION</b>	<b>CULVERT RIPRAP</b> <b>CROSS SECTIONS</b>	F.A.P. RTE.	SECTION	COUNTY	TOTAL SHEETS	SHEET NO.
p:\11084EBIDINTEG\Illinois.gov\PIDOT\Documents\IDOT Offices\District 6\Projects\0672J17\CADD\Drawings\0672J17-sht-xsections.dgn	DRAWN	REVISÉ -	REVISÉ -			658	(G) RS-7	MASON	27	26
Culvert9	PLOT SCALE = 20.0000' / in.	CHECKED -	REVISÉ -			CONTRACT NO. 72J17				
	PLOT DATE = 6/24/2016	DATE -	REVISÉ -			ILLINOIS FED. AID PROJECT				

