

FOR INDEX OF SHEETS, SEE SHEET NO.2
 FOR INDEX OF HIGHWAY STANDARDS, SEE SHEET NO.2

STATE OF ILLINOIS
 DEPARTMENT OF TRANSPORTATION
**PLANS FOR PROPOSED
 FEDERAL AID HIGHWAY**

FA5 ROUTE 299 (KENNEDY ROAD)
 COOK STREET TO WALKER STREET

SECTION NO.: 12-00014-00-SW
 PROJECT NO.: SRTS-4009 (222)
 CITY OF BRAIDWOOD
 WILL COUNTY
 JOB NO.: C-91-047-013

F.A.S. R.T.E.	SECTION	COUNTY	TOTAL SHEETS	SHEET NO.
299	12-00014-00-SW	WILL	21	01
CONTRACT NO. 61D14				
SRTS-4009(220) ILLINOIS FED. AID PROJECT				

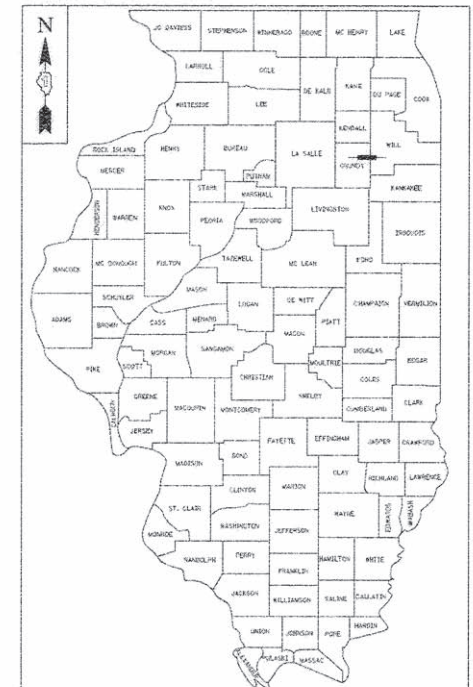

TRAFFIC DATA

KENNEDY RD. - MAJOR CONNECTOR
 POSTED SPEED LIMIT = 30
 2012 ADT = 2700

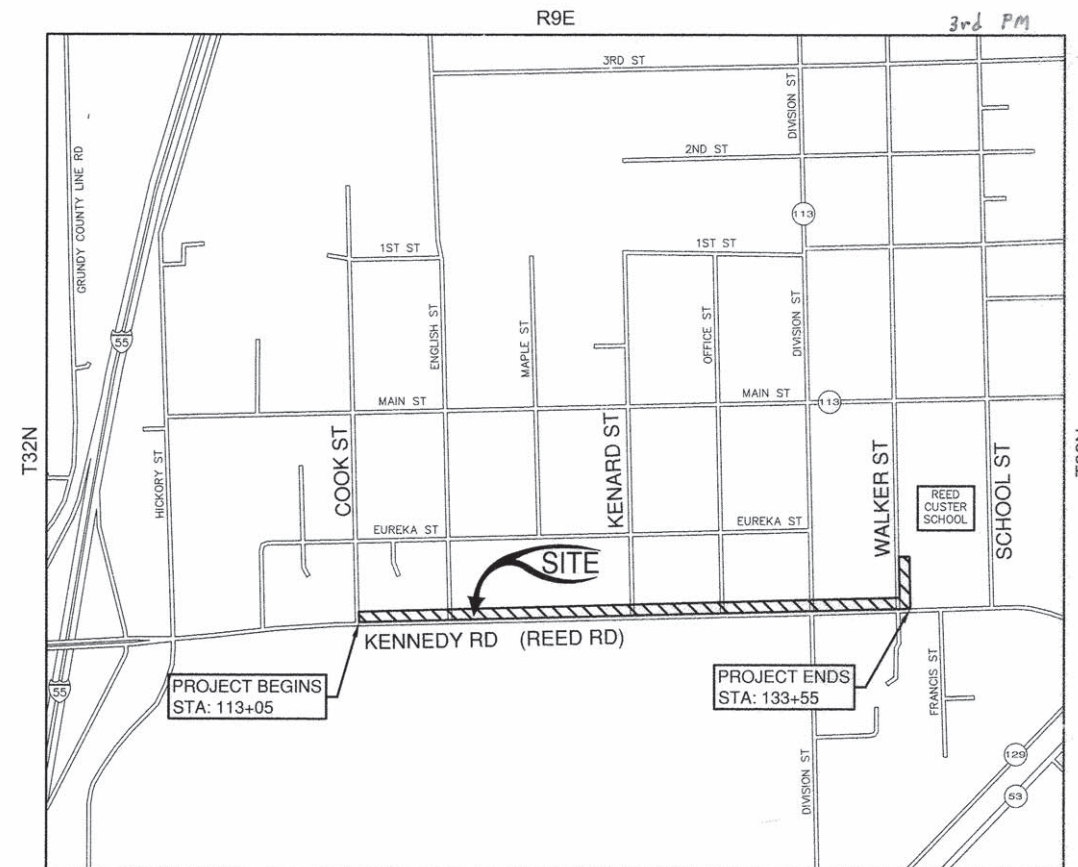

R9E
 LOCATION MAP
 N.T.S.

GROSS PROJECT LENGTH: 4250 FEET = 0.805 MILE
 NET PROJECT LENGTH: 2175 FEET = 0.411 MILE

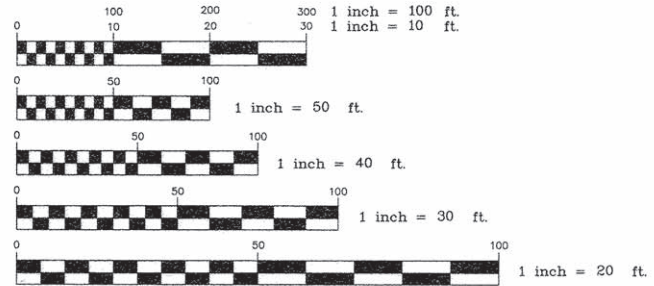

FULL SIZE PLANS HAVE BEEN PREPARED USING STANDARD ENGINEERING SCALES. REDUCED SIZED PLANS WILL NOT CONFORM TO STANDARD SCALES. IN MAKING MEASUREMENTS ON REDUCED PLANS, THE ABOVE SCALES MAY BE USED.

STATE OF ILLINOIS
 DEPARTMENT OF TRANSPORTATION
 DIVISION OF HIGHWAYS

APPROVED: *[Signature]* (DATE) 6/29/2016
 JAMES ALLEN, MAYOR, CITY OF BRAIDWOOD (SIGNATURE)

PASSED: *[Signature]* (DATE) July 5, 2016
 DISTRICT 1 ENGINEER OF LOCAL ROADS & STREETS (SIGNATURE)

RELEASING FOR BID BASED ON LIMITED REVIEW: *[Signature]* (DATE) July 5, 2016
 REGIONAL ENGINEER (SIGNATURE)

JOEL GREER, P.E. #062-062541 (DATE) 6/29/2016
 EXPIRATION DATE OF LICENSE 11/2017



PRINTED BY THE AUTHORITY OF THE STATE OF ILLINOIS

PROGRAM AND OFFICE ENGINEER: CHARLES RIDDLE, P.E. 847-705-4406, SCHAUMBURG, IL.

CONTRACT NO.: 61D14

J.U.L.I.E.
 JOINT UTILITY LOCATION
 INFORMATION FOR EXCAVATION
 1-800-892-0123

M. GINGERICH, GEREUX & ASSOCIATES
 240 N. Industrial Drive
 Bradley, Illinois 60915
 815-939-4921
 FAX: 815-939-9810

REVISIONS		
DATE	BY	DESCRIPTION

ILLINOIS DEPARTMENT OF TRANSPORTATION
 SAFE ROUTE TO SCHOOLS
 KENNEDY ROAD SIDEWALK

COVER SHEET

SCALE: DATE: 02/04/16
 DRAWN BY: CAG
 CHECKED BY:

INDEX OF SHEETS

CIVIL PLANS

- 01 COVER SHEET
- 02 GENERAL NOTES AND STANDARDS - INDEX OF SHEETS
- 03 SUMMERY OF QUANTITIES
- 04 TYPICAL CROSS SECTIONS
- 05 ALIGNMENTS, TIES AND BENCHMARKS
- 06 KENNEDY ROAD PLAN AND PROFILE
STA.112+00-118+00
- 07 KENNEDY ROAD PLAN AND PROFILE
STA.118+00-124+00
- 08 KENNEDY ROAD PLAN AND PROFILE
STA.124+00-130+00
- 09 KENNEDY ROAD PLAN AND PROFILE
STA.130+00-134+00
- 10 S.W.P.P.P.
- 11 EXISTING SIDEWALK REPLACEMENT AREAS
KENNEDY ROAD & WALKER STREET
- 12 STANDARD DETAILS
- 13 DISTRICT 1 DETAILS
- 14-21 CROSS SECTIONS

HIGHWAY STANDARDS

- 000001-06 STANDARD SYMBOLS, ABBREVIATIONS, & PATTERNS
- 280001-07 TEMPORARY EROSION CONTROL SYSTEMS
- 424001-08 PERPENDICULAR CURB RAMPS FOR SIDEWALKS
- 602301-04 INLET, TYPE A
- 602306-03 INLET, TYPE B
- 602601-04 PRECAST REINFORCED CONCRETE FLAT SLAB TOP
- 604001-04 FRAME AND LIDS, TYPE 1
- 604036-03 GRATE, TYPE 8
- 701001-02 OFF-ROAD OPERATIONS, 2L, 2W, MORE THAN 15' (4.5 m) AWAY
- 701006-05 OFF-ROAD OPERATIONS, 2L, 2W, 15' (4.5 m) TO 24" (600 mm) FROM PAVEMENT EDGE
- 701011-04 OFF-ROAD OPERATIONS, 2L, 2W, DAY ONLY
- 701301-04 LANE CLOSURE, 2L, 2W, SHORT TIME OPERATIONS
- 701311-03 LANE CLOSURE, 2L, 2W, MOVING OPERATIONS - DAY ONLY
- 701801-06 SIDEWALK, CORNER OR CROSSWALK CLOSURE
- 701901-05 TRAFFIC CONTROL DEVICES
- 720001-01 SIGN PANEL MOUNTING DETAILS
- 720006-04 SIGN PANEL ERECTION DETAILS
- 729001-01 APPLICATIONS OF TYPES A AND B METAL POSTS (FOR SIGNS & MARKERS)
- 780001-05 TYPICAL PAVEMENT MARKINGS

DISTRICT ONE STANDARD DETAILS

- BD-07 STORM SEWER CONNECTION TO EXISTING SEWER
- TC-13 DISTRICT ONE TYPICAL PAVEMENT MARKINGS

GENERAL NOTES

1. BEFORE STARTING ANY EXCAVATIONS, THE CONTRACTOR SHALL CALL "J.U.L.I.E." AT 811 OR 1(800)892-0123 FOR FIELD LOCATIONS OF BURIED ELECTRICAL, TELEPHONE AND GAS FACILITIES. 48 HOUR NOTIFICATION IS REQUIRED.
2. IT SHALL BE THE CONTRACTOR'S RESPONSIBILITY TO VERIFY ALL DIMENSIONS AND CONDITIONS EXISTING IN THE FIELD PRIOR TO CONSTRUCTION AND ORDERING MATERIALS.
3. THE CONTRACTOR SHALL BE RESPONSIBLE FOR THE PROTECTION OF ALL OVERHEAD, SURFACE, AND UNDERGROUND UTILITIES WITHIN THE PROJECT LIMITS. WHETHER OR NOT THE UTILITIES ARE SHOWN ON THE PLANS. ANY UTILITY THAT IS DAMAGED DURING CONSTRUCTION SHALL BE REPLACED OR RELOCATED BY THE CONTRACTOR AT THE CONTRACTOR'S OWN EXPENSE.
4. THE CONTRACTOR SHALL USE CARE IN GRADING OR EXCAVATING NEAR ANY AND ALL EXISTING ITEMS WHICH WILL NOT BE REMOVED. ANY DAMAGE DONE TO THE EXISTING ITEMS BY THE CONTRACTOR SHALL BE REPAIRED OR REPLACED BY THE CONTRACTOR AT THE CONTRACTOR'S OWN EXPENSE.
5. CONTRACTOR SHALL CONFIRM STORM SEWER SIZE PRIOR TO ORDERING MATERIALS.
6. SAW CUTS WILL NOT BE PAID FOR SEPARATELY, BUT SHALL BE INCLUDED IN THE COST OF THE REMOVAL ITEM, UNLESS OTHERWISE NOTED.
7. CONSTRUCTION EQUIPMENT SHALL BE STAGED ON PAVED SURFACES.
8. CULVERT AND DITCH FLOWS MUST BE MAINTAINED THROUGHOUT THE PROJECT. NORMAL FLOWS SHALL BE ALLOWED TO PASS AT THE RATE IT ENTERS THE JOB SITE. HIGH FLOWS SHALL BE ALLOWED TO PASS WITHOUT CAUSING DAMAGE TO UPSTREAM OR DOWNSTREAM PROPERTIES.
9. ALL SUITABLE EXCESS MATERIALS FROM SEWER TRENCHES, SIDE ROADS, ENTRANCES OR OTHER NECESSARY EXCAVATIONS SHALL BE USED IN THE CONSTRUCTION OF THE IMPROVEMENTS. PLACEMENT AND COMPACTION OF THIS MATERIAL SHALL BE INCLUDED IN THE COST OF EARTH EXCAVATION AND NO ADDITIONAL COMPENSATION WILL BE ALLOWED.
10. THE CONTRACTOR SHALL CONTACT THE CITY OF BRAIDWOOD A MINIMUM OF 72 HOURS PRIOR TO THE PLACEMENT OF ANY TEMPORARY TRAFFIC CONTROL DEVICES.
11. THE CONTRACTOR SHALL BE REQUIRED TO PROVIDE ACCESS TO ABUTTING PROPERTY AT ALL TIMES DURING THE CONSTRUCTION PROJECT.
12. THE CONTRACTOR WILL BE REQUIRED TO KEEP A RECORD OF THE LOCATIONS OF THE BURIED STRUCTURES ACCORDING TO THE STATION AND DISTANCE LEFT OR RIGHT OF THE CENTERLINE OF PAVEMENT. UPON COMPLETION OF THE WORK, THE CONTRACTOR WILL DELIVER THE RECORD TO THE ENGINEER. THIS WORK SHALL BE INCLUDED IN THE COST OF MOBILIZATION.
13. THE CONTRACTOR SHALL MAINTAIN PASSABLE TRAFFIC ACCESS INCLUDING AT CULVERT REPLACEMENT, STORM SEWER, AND OTHER UNDERGROUND UTILITIES DURING WORKING AND NON WORKING HOURS TO BUSINESSES AND RESIDENCES. THIS WORK SHALL BE INCLUDED IN THE COST OF MOBILIZATION.
14. DO NOT SCALE PLANS FOR CONSTRUCTION DIMENSIONS.
15. THE CONTRACTOR SHALL TAKE EXTRA CARE IN GRADING AND EXCAVATION NEAR TREES WHICH ARE NOT MARKED FOR REMOVAL SO AS NOT TO CAUSE INJURY TO THE ROOT SYSTEM OR TRUNKS. MAJOR ROOTS OF A TREE THAT ARE TO REMAIN IN PLACE EXTENDING IN THE EXCAVATION AREAS AT AN ELEVATION THAT WOULD INTERFERE WITH ANY PORTION OF THE PLANNED CONSTRUCTION SHALL BE SEVERED AT A POINT IMMEDIATELY OUTSIDE OF THE EXCAVATION AREA IN A MANNER THAT WILL CAUSE THE LEAST AMOUNT OF SYSTEMIC TO THE REMAINING TREE STRUCTURE. ANY DAMAGE DONE TO THE EXISTING ITEMS BY THE CONTRACTOR AT THE CONTRACTOR'S OWN EXPENSE.
16. RIGHT OF WAY SHALL BE SATISFACTORILY RESTORED. THIS INCLUDES PLACEMENT OF CULVERTS TO THEIR ORIGINAL ELEVATION. ANY CULVERTS DAMAGED AS A RESULT OF CONSTRUCTION MUST BE REPLACED IN KIND. DITCHES MUST BE PROPERLY GRADED AND LANDSCAPED. THE HIGHWAY DRAINAGE SYSTEMS MUST BE RE-ESTABLISHED AFTER THE UTILITY INSTALLATION IS COMPLETED.
17. THE CONTRACTOR SHALL BE RESPONSIBLE FOR CONTACTING THE CITY OF BRAIDWOOD 14 WORKING DAYS PRIOR TO THE START OF CONSTRUCTION IN ORDER TO REVIEW AND COORDINATE CONSTRUCTION SCHEDULES AND PUBLIC SAFETY ISSUES.

	USER NAME =	DESIGNED - JWG	REVISED -	STATE OF ILLINOIS DEPARTMENT OF TRANSPORTATION	GENERAL NOTES AND STANDARDS	F.A.S. R.T.E. 299	SECTION 12-00014-00-SW	COUNTY WILL	TOTAL SHEETS 21	SHEET NO. 2
	PLOT SCALE =	CHECKED - JWG	REVISED -							
	PLOT DATE =	DATE - 02/04/2016	REVISED -		SCALE: N.T.S	SHEET NO. 2 OF 21 SHEETS	STA. N.A.	TO STA. N.A.	CONTRACT NO. 61D14	
						SRTS-4009(220) ILLINOIS FED. AID PROJECT				

CONSTRUCTION TYPE CODE: 0021			
SUMMARY OF QUANTITIES			
ITEM NUMBER	ITEMS	UNIT	QUANTITY
20200100	EARTH EXCAVATION	CU YD	280
25100630	EROSION CONTROL BLANKET	SQ YD	2341
28000400	PERIMETER EROSION BARRIER	FOOT	2036
28000510	INLET FILTERS	EACH	28
35101598	AGGREGATE BASE COURSE, TYPE B 3"	SQ YD	192
35101600	AGGREGATE BASE COURSE, TYPE B 4"	SQ YD	1131
35101700	AGGREGATE BASE COURSE, TYPE B 5"	SQ YD	107
35102100	AGGREGATE BASE COURSE, TYPE B 9"	SQ YD	25
40800050	INCIDENTAL HOT MIX ASPHALT SURFACING	TON	24
42300200	PORTLAND CEMENT CONCRETE DRIVEWAY PAVEMENT, 6 INCH	SQ YD	162
42400200	PORTLAND CEMENT CONCRETE SIDEWALK 5 INCH	SQ FT	10177.5
42400800	DETECTABLE WARNINGS	SQ FT	100
44000200	DRIVEWAY PAVEMENT REMOVAL	SQ YD	297
44000600	SIDEWALK REMOVAL	SQ FT	1860
50104400	CONCRETE HEADWALL REMOVAL	EACH	5
* 54210186	PIPE ELBOW, 18"	EACH	2
55100900	STORM SEWER REMOVAL 18"	FOOT	41
* 550B0070	STORM SEWERS, CLASS B, TYPE 1 15"	FOOT	224
* 550B0090	STORM SEWERS, CLASS B, TYPE 1 18"	FOOT	20
60406000	FRAMES AND LIDS, TYPE 1, OPEN LID	EACH	1
* 60262900	INLETS TO BE RECONSTRUCTED WITH NEW TYPE 1 FRAME, OPEN LID	EACH	1
* 60300105	FRAMES AND GRATES TO BE ADJUSTED	EACH	6
67100100	MOBILIZATION	L SUM	1
70102640	TRAFFIC CONTROL AND PROTECTION, STANDARD 701801	L SUM	1
72400500	RELOCATE SIGN PANEL ASSEMBLY - TYPE A	EACH	5
Δ 78000400	THERMOPLASTIC PAVEMENT MARKING - LINE 6"	FOOT	149
Δ 78000650	THERMOPLASTIC PAVEMENT MARKING - LINE 24"	FOOT	39
* XX009134	PIPE TEE, 15" PIPE WITH 15" RISER	EACH	3
* XX007268	PIPE TEE, 18" PIPE WITH 18" RISER	EACH	8
* X0322916	PROPOSED STORM SEWER CONNECTION TO EXISTING STORM SEWER	EACH	26
* X2500900	SEEDING, CLASS 1 (SPECIAL)	ACRE	0.5
* SEE DETAILS AND SPECIAL PROVISIONS			
Δ SPECIALTY ITEMS			

USER NAME =	DESIGNED - JWG	REVISED - 2016-07-06 IDOT REVIEW
DRAWN - CAG	REVISOR -	
PLOT SCALE =	CHECKED - JWG	REVISED -
PLOT DATE =	DATE - 02/04/2016	REVISED -

STATE OF ILLINOIS
DEPARTMENT OF TRANSPORTATION

SUMMARY OF QUANTITIES

SCALE: N.T.S. SHEET NO. 3 OF 21 SHEETS STA. N.A. TO STA. N.A.

F.A.S. R.T.E. 299	SECTION 12-00014-00-SW	COUNTY WILL	TOTAL SHEETS 21	SHEET NO. 3
CONTRACT NO. 61D14			ILLINOIS FED. AID PROJECT	

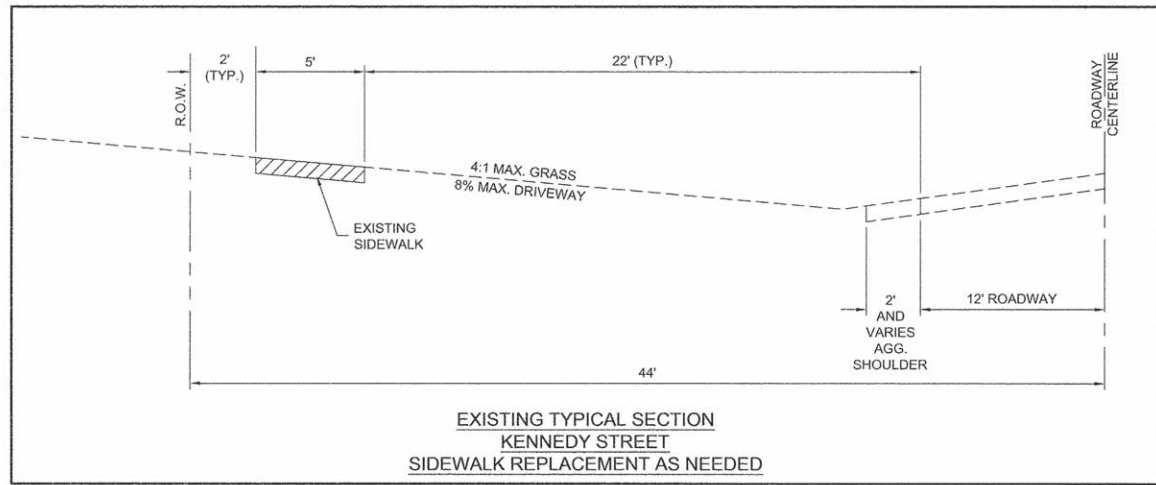
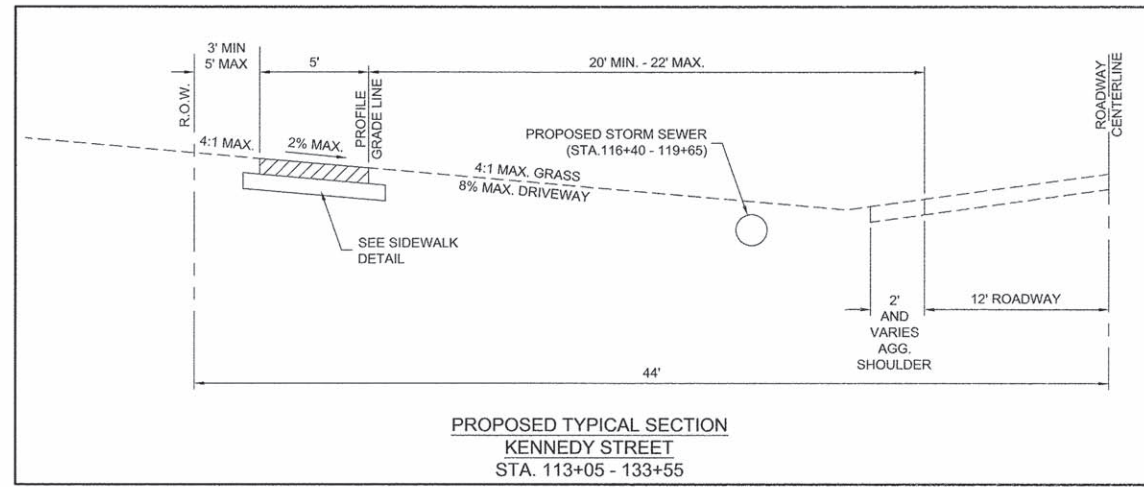
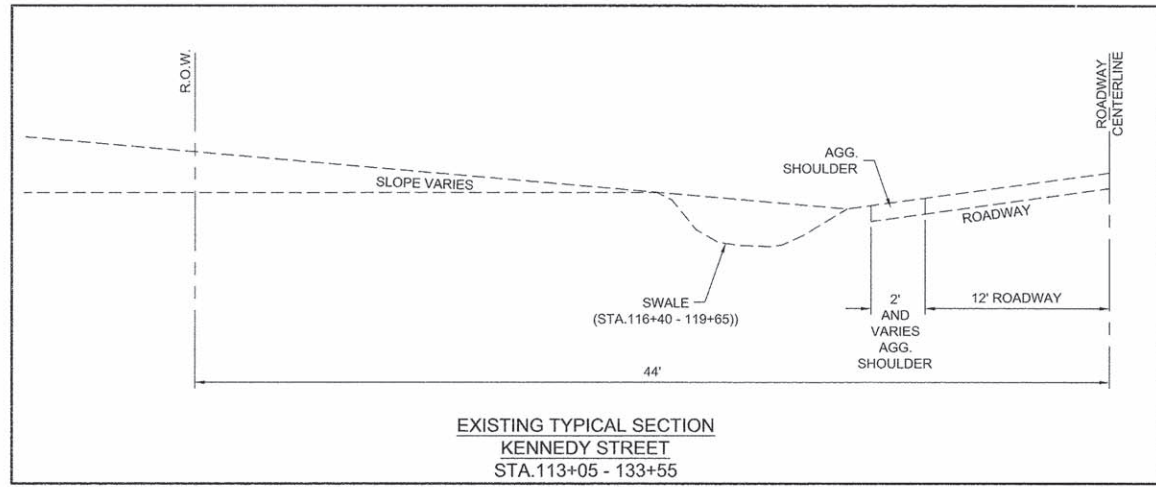

HOT MIX ASPHALT MIXTURE REQUIREMENTS		QUALITY MANAGEMENT PROGRAM (QMP)
MIXTURE TYPE	AIR VOIDS @ Ndes	
INCIDENTAL HMA SURFACE HOT MIX ASPHALT SC MIX "D" N50	4% @ 50 GYR.	

NOTES:
 THE UNIT WEIGHT USED TO CALCULATE ALL HMA SURFACE MIXTURE QUANTITIES IS 112 LBS/SY/IN.
 THE "AC TYPE" FOR POLYMERIZED HMA MIXES SHALL BE "SBS/SBR PG 76-22" AND FOR NON-POLYMERIZED HMA THE "AC TYPE" SHALL BE "PG 64-22" UNLESS MODIFIED BY DISTRICT ONE SPECIAL PROVISIONS.
 FOR USE OF RECYCLED MATERIALS SEE SPECIAL PROVISIONS.
 QUALITY MANAGEMENT PROGRAM (QMP) IDENTIFIES THE PARTICULAR QUALITY CONTROL SPECIFICATION THAT APPLIES TO THE HMA MIXTURE.

EARTHWORK SCHEDULE				
Location	Earth Excavation	Earth Excavation Adjusted for Shrinkage (25%)	Fill	Earthwork Balance Waste (+) or Shortage (-)
	Cubic Yard	Cubic Yard	Cubic Yard	Cubic Yard
Sta. 113+38 to 113+86	6	5	0	5
Sta. 114+01 to 115+16	15	11	0	11
Sta. 115+40 to 116+03	9	7	0	7
Sta. 116+27 to 117+01	7	5	27	-22
Sta. 117+18 to 117+35	2	2	0	2
Sta. 117+60 to 119+19	15	11	53	-42
Sta. 119+30 to 119+83	4	3	20	-17
Sta. 120+06 to 121+60	23	17	0	17
Sta. 121+79 to 122+52	22	17	0	17
Sta. 122+72 to 123+80	16	12	0	12
Sta. 123+92 to 124+54	8	6	0	6
Sta. 124+73 to 125+27	8	6	0	6
Sta. 125+39 to 125+99	14	11	0	11
Sta. 126+18 to 126+45	4	3	0	3
Sta. 126+84 to 127+45	13	10	0	10
Sta. 127+69 to 128+20	8	6	0	6
Sta. 128+37 to 128+96	9	7	0	7
Sta. 129+13 to 129+71	15	11	0	11
Sta. 129+91 to 130+45	10	8	0	8
Sta. 130+63 to 131+17	10	8	0	8
Sta. 131+28 to 131+93	15	11	0	11
Sta. 132+10 to 132+60	10	8	0	8
Sta. 132+70 to 133+09	5	4	0	4
Sta. 133+35 to 133+52	2	2	0	2
East side Office Street	0	0	0	0
West side Division Street	27	20	0	20
Walker Street Intersection	1	1	0	1
Walker Street @ Library Entrance	2	2	0	2
Total	280	214	100	114

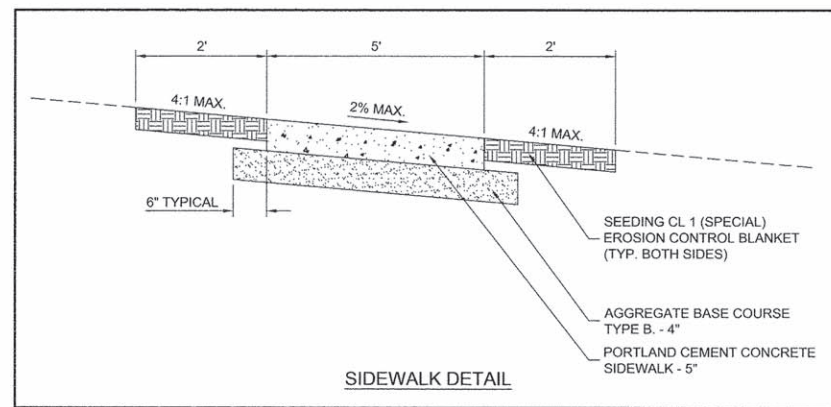
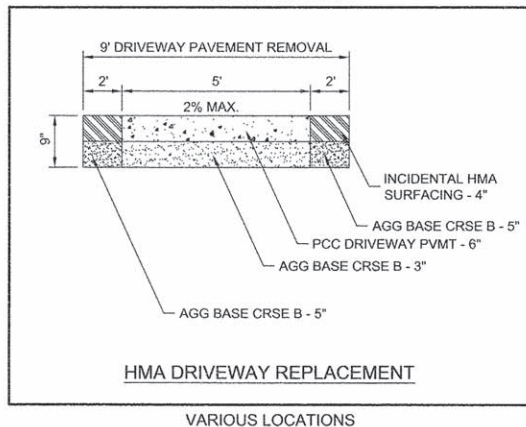
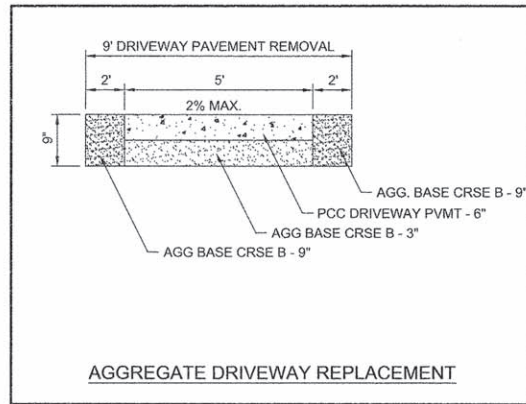

USER NAME =	DESIGNED - JWG	REVISED - 2016-07-06 IDOT REVIEW
PLOT SCALE =	DRAWN - CAG	REVISED -
PLOT DATE =	CHECKED - JWG	REVISED -
	DATE - 02/04/2016	REVISED -

STATE OF ILLINOIS
DEPARTMENT OF TRANSPORTATION

TYPICAL CROSS SECTIONS

SCALE: N.T.S SHEET NO. 4 OF 21 SHEETS STA. N.A. TO STA. N.A.

F.A.S. R.T.E. 299	SECTION 12-00014-00-SW	COUNTY WILL	TOTAL SHEETS 21	SHEET NO. 4
CONTRACT NO. 61D14			ILLINOIS FED. AID PROJECT	

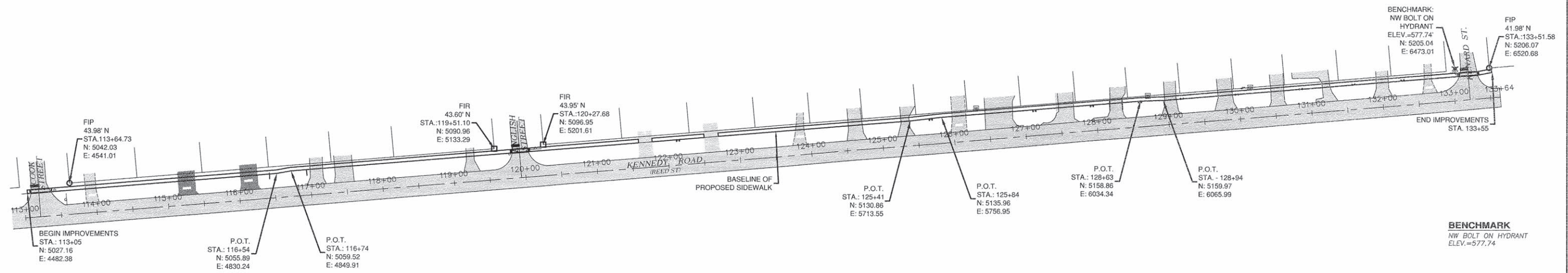

BENCHMARK
NW BOLT ON HYDRANT
ELEV. = 577.74



VERTICAL DATUM NAVD 88

USER NAME = PLOT SCALE = PLOT DATE =	DESIGNED - JWG	REVISED -	STATE OF ILLINOIS DEPARTMENT OF TRANSPORTATION	ALIGNMENTS, TIES AND BENCHMARKS		F.A.S. R.T.E. 299	SECTION 12-00014-00-SW	COUNTY WILL	TOTAL SHEETS 21	SHEET NO. 5	
	CHECKED - JWG	REVISED -		SCALE: 1" = 70'	SHEET NO. 5 OF 21 SHEETS	STA. 113+00 TO STA. 133+64	CONTRACT NO. 61D14				
	DATE - 02/04/2016	REVISED -		SRTS-4009(220) ILLINOIS FED. AID PROJECT							

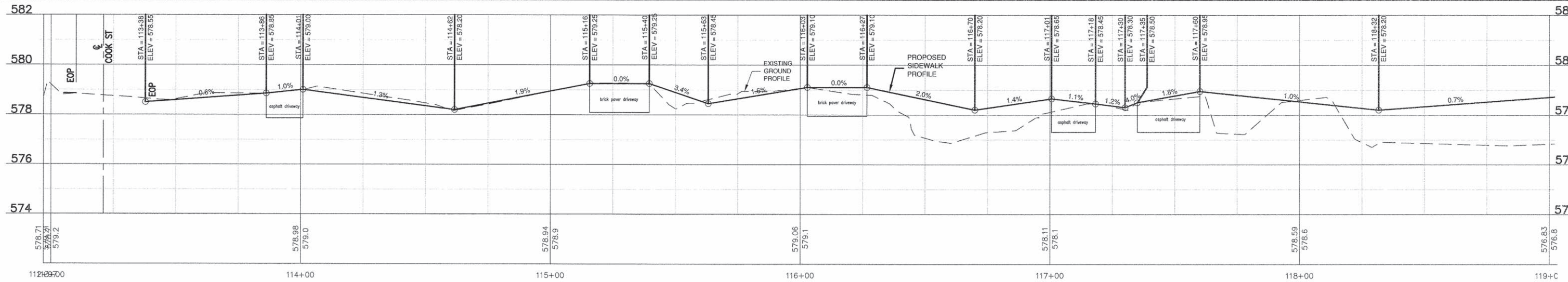
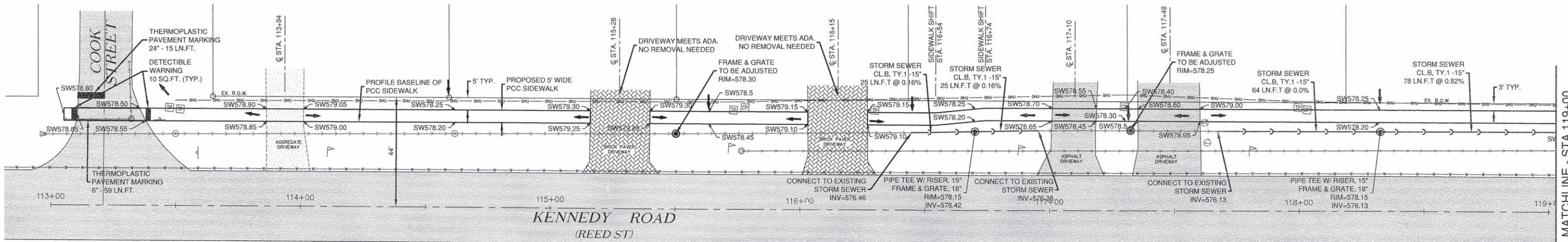
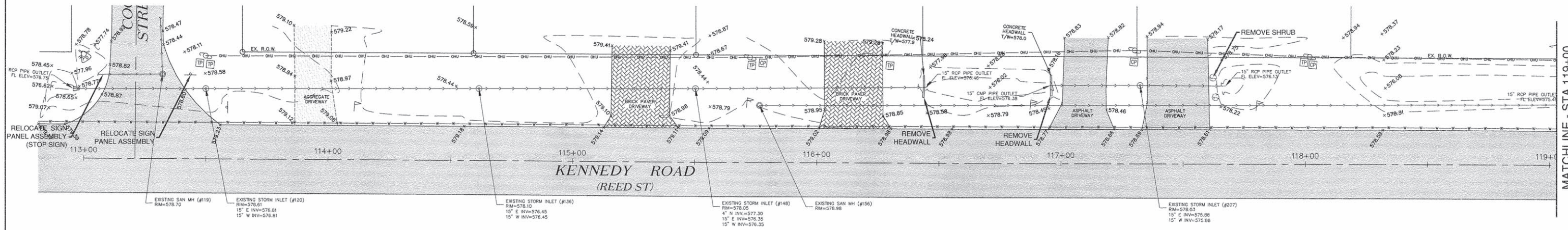

USER NAME =	DESIGNED - JWG	REVISED - 2016-07-06 IDOT REVIEW	STATE OF ILLINOIS DEPARTMENT OF TRANSPORTATION	PLAN AND PROFILE		F.A.S. R.T.E. 299	SECTION 12-00014-00-SW	COUNTY WILL	TOTAL SHEETS 21	SHEET NO. 6
PLOT SCALE =	DRAWN - CAG	REVISED -		SCALE: 1" = 20'		SHEET NO. 6 OF 21 SHEETS		STA. 113+00 TO STA. 119+00		CONTRACT NO. 61D14
PLOT DATE =	CHECKED - JWG	REVISED -		ILLINOIS FED. AID PROJECT						
	DATE - 02/04/2016	REVISED -								

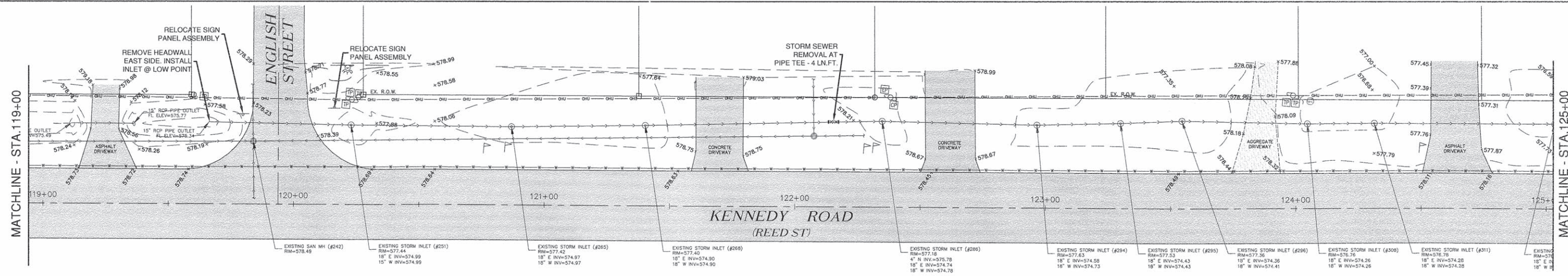

EXISTING CONDITIONS

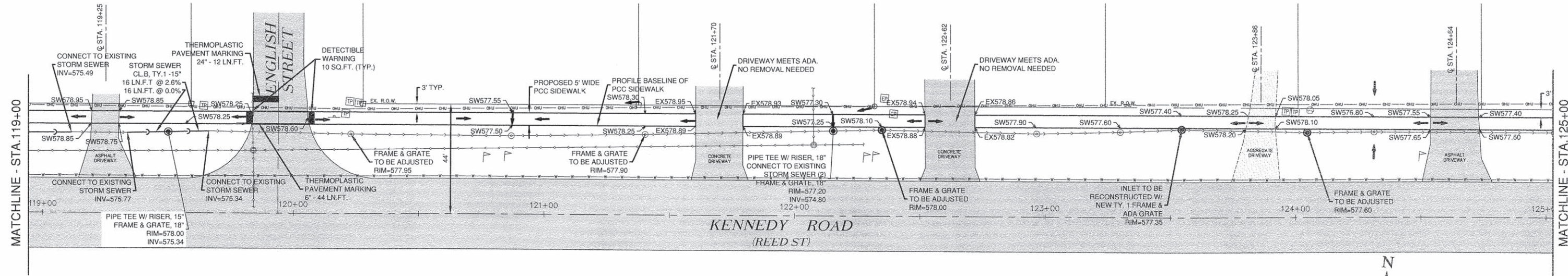

PROPOSED CONDITIONS

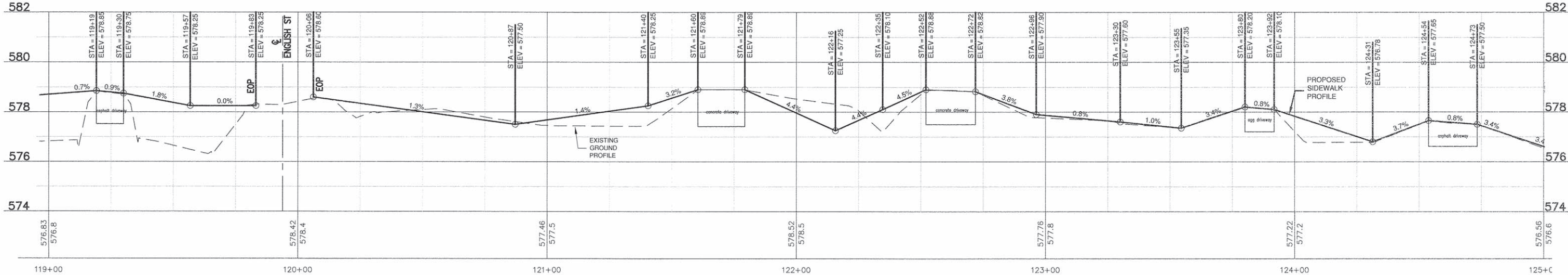

PROFILE V: 1:2
H: 1:20

USER NAME =	DESIGNED - JWJ	REVISED -	STATE OF ILLINOIS DEPARTMENT OF TRANSPORTATION	PLAN AND PROFILE		F.A.S. R.T.E. 299	SECTION 12-00014-00-SW	COUNTY WILL	TOTAL SHEETS 21	SHEET NO. 7		
PLOT SCALE =	CHECKED - JWJ	REVISED -				SCALE: 1" = 20'		SHEET NO. 7 OF 21 SHEETS		STA. 119+00 TO STA. 125+00	CONTRACT NO. 61D14	
PLOT DATE =	DATE - 02/04/2016	REVISED -				SRTS-4009(220)		ILLINOIS FED. AID PROJECT				

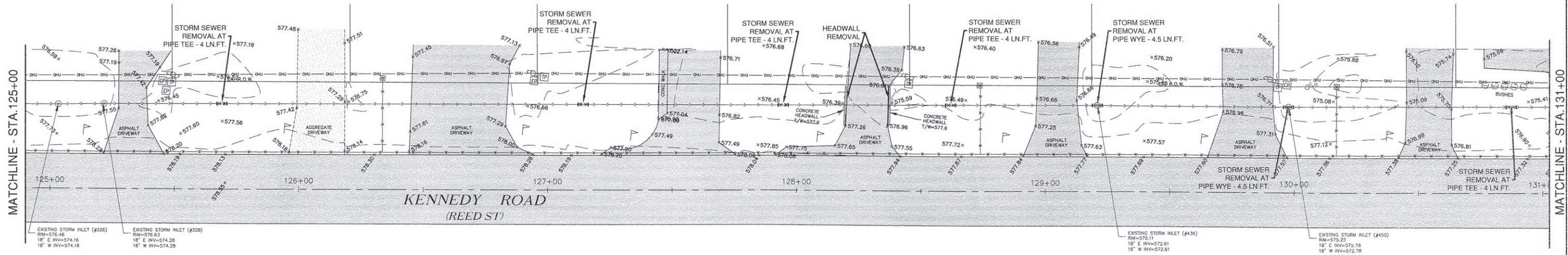

EXISTING CONDITIONS

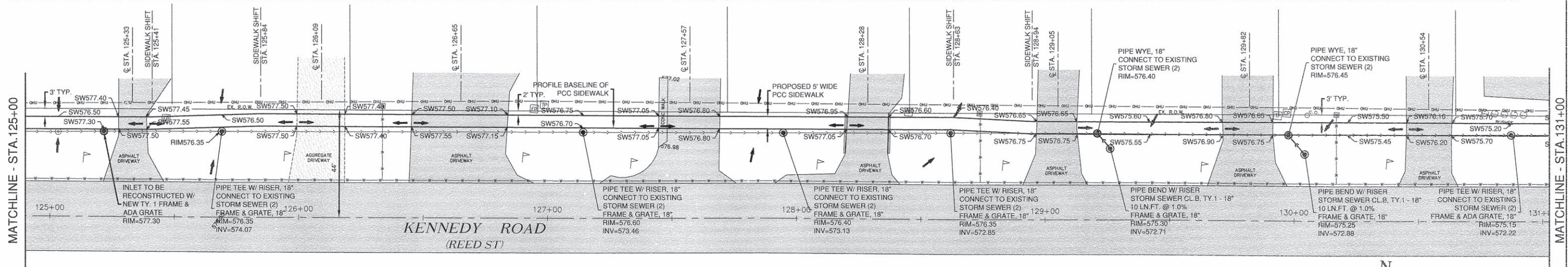

PROPOSED CONDITIONS

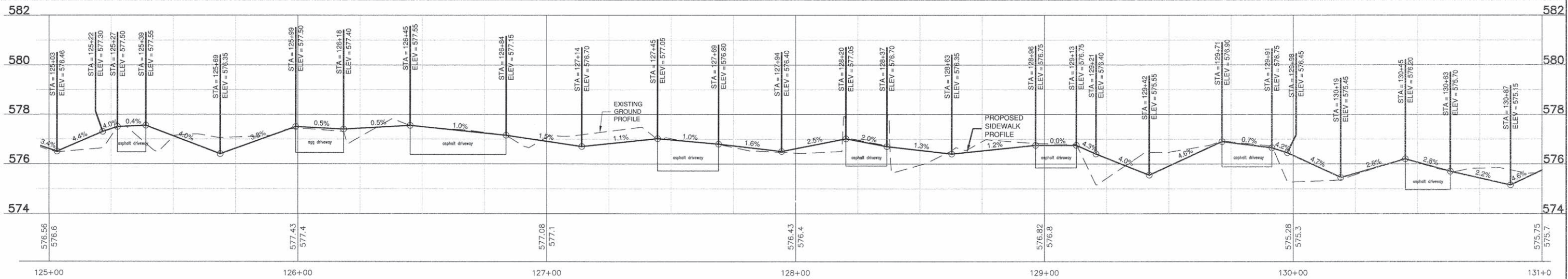

V: 1:2
H: 1:20

USER NAME =	DESIGNED - JWG	REVISED -
PLOT SCALE =	DRAWN - CAG	REVISED -
PLOT DATE =	CHECKED - JWG	REVISED -
	DATE - 02/04/2016	REVISED -

STATE OF ILLINOIS
DEPARTMENT OF TRANSPORTATION

PLAN AND PROFILE

SCALE: 1" = 20' SHEET NO. 8 OF 21 SHEETS STA. 125+00 TO STA. 131+00

F.A.S. R.T.E. 299	SECTION 12-00014-00-SW	COUNTY WILL	TOTAL SHEETS 21	SHEET NO. 8
CONTRACT NO. 61D14			ILLINOIS FED. AID PROJECT	

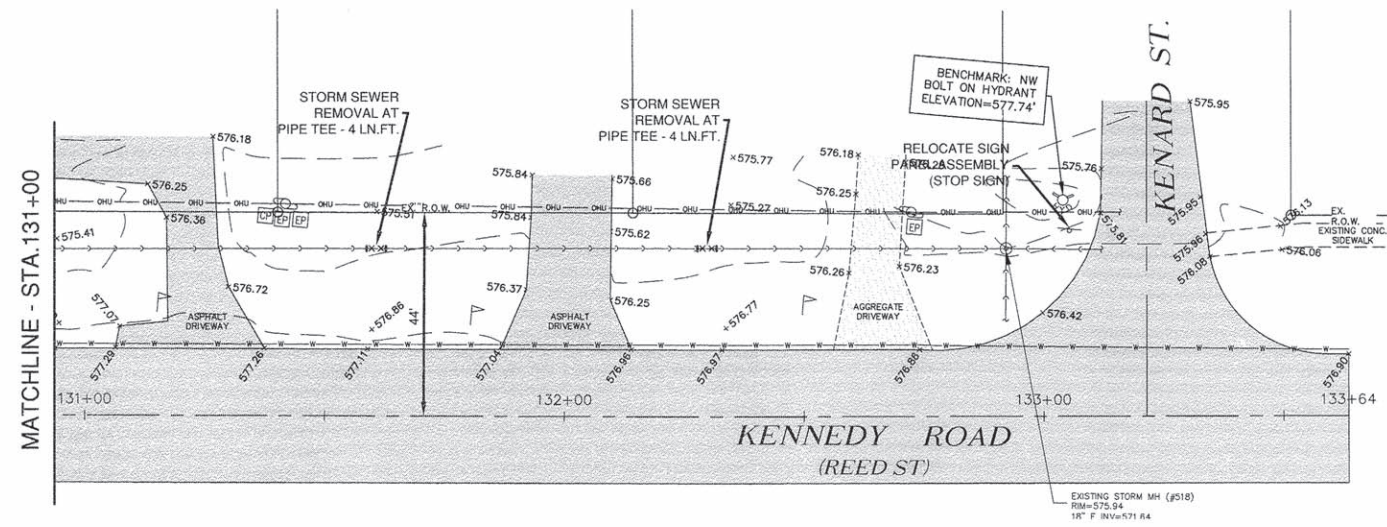

EXISTING CONDITIONS

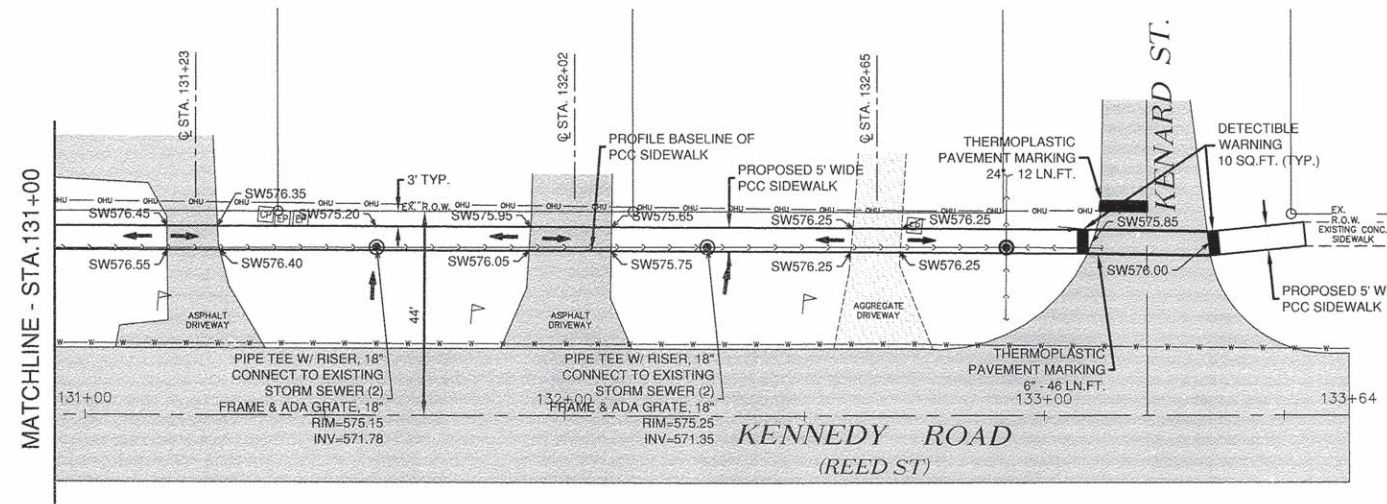

PROPOSED CONDITIONS

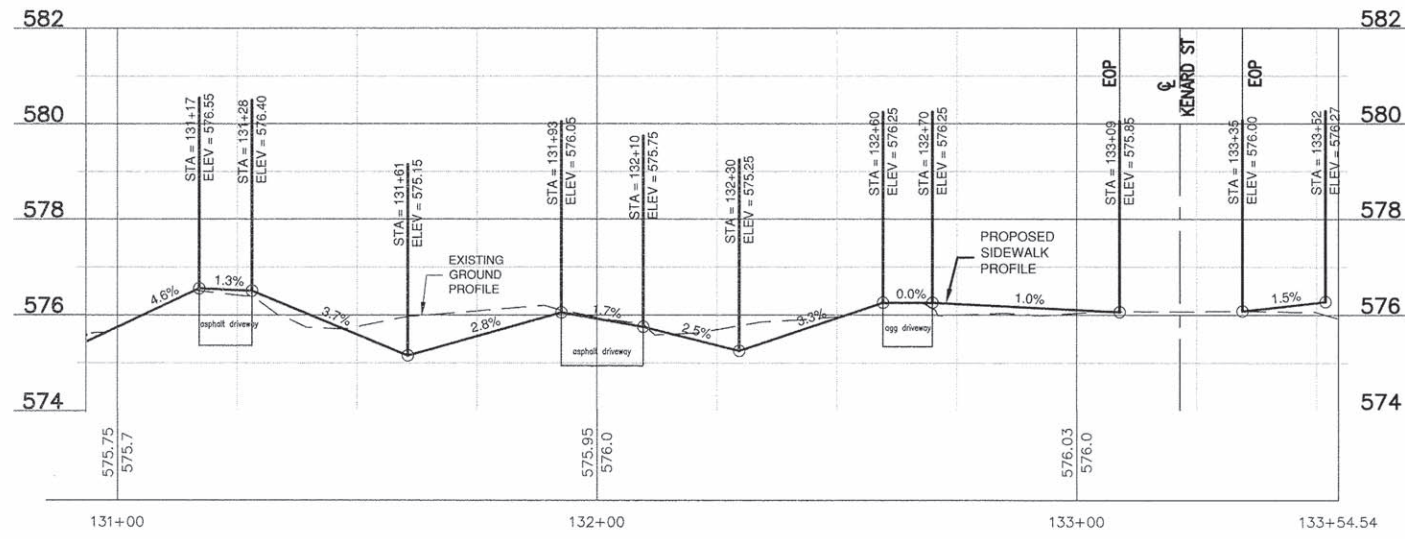

PROFILE V: 1:2 H: 1:20

USER NAME = DESIGNED - JWG DRAWN - CAG CHECKED - JWG DATE - 02/04/2016	REVISIONS REVISIONS - REVISIONS - REVISIONS -	STATE OF ILLINOIS DEPARTMENT OF TRANSPORTATION	PLAN AND PROFILE		F.A.S. R.T.E. 299	SECTION 12-00014-00-SW	COUNTY WILL	TOTAL SHEETS 21	SHEET NO. 9		
	SCALE: 1" = 20'		SHEET NO. 9 OF 21 SHEETS	STA. 131+00 TO STA. 133+55	SRTS-4009(220) ILLINOIS FED. AID PROJECT						
	CONTRACT NO. 61D14										

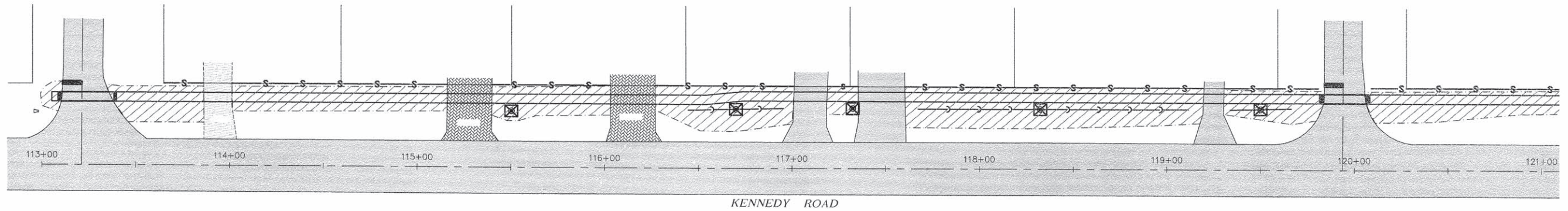

KENNEDY ROAD

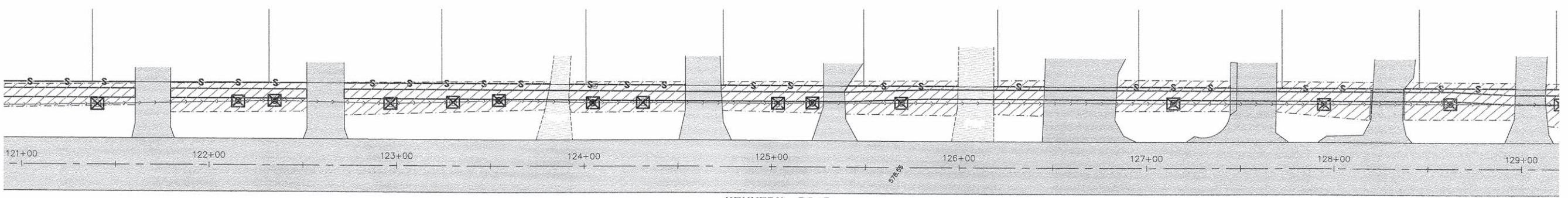

KENNEDY ROAD

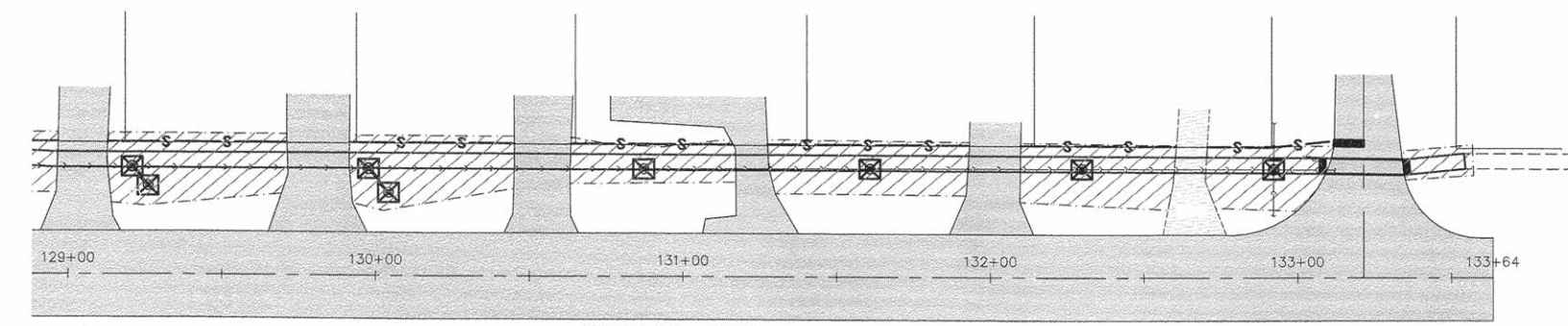

KENNEDY ROAD

STORM WATER, SEDIMENT & EROSION CONTROL / STORM WATER POLLUTION PREVENTION PLAN

1. ACCORDING TO THE LIMITS OF IMPROVEMENTS DESCRIBED ON THIS PLAN SET, THE TOTAL DISTURBED AREA IS LESS THAN ONE ACRE AND MAY NOT REQUIRE AN NPDES CONSTRUCTION STORMWATER PERMIT. HOWEVER, THE OWNER AND CONTRACTOR SHOULD ASSURE BEST MANAGEMENT PRACTICES FOR STORM WATER AND SEDIMENT CONTROL ARE UTILIZED AND MAINTAINED. SPECIAL ATTENTION SHOULD BE PAID TO DISPOSAL OF MATERIALS SUCH AS EXCESS CONCRETE AND CLEANING WHEELS BEFORE LEAVING THE SITE.

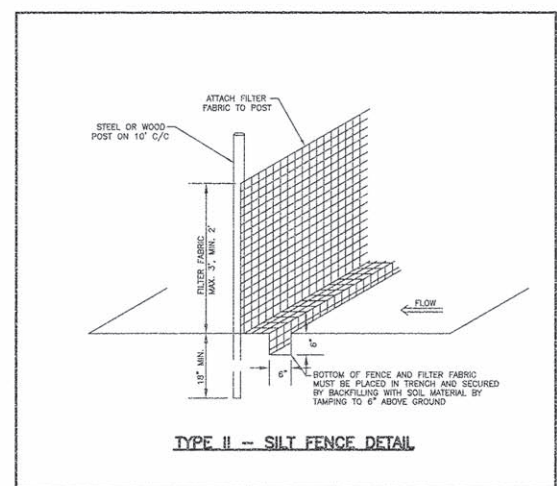
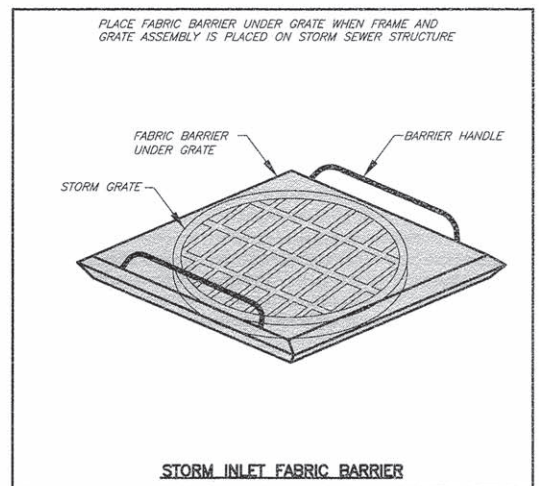
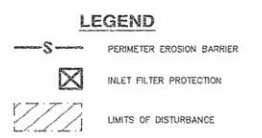

USER NAME =	DESIGNED - JWG	REVISED -
	DRAWN - CAG	REVISED -
PLOT SCALE =	CHECKED - JWG	REVISED -
PLOT DATE =	DATE - 02/04/2016	REVISED -

STATE OF ILLINOIS
DEPARTMENT OF TRANSPORTATION

S.W.P.P.P.

SCALE: 1" = 30' SHEET NO. 10 OF 21 SHEETS STA. 113+00 TO STA. 133+64

F.A.S. R.T.E. 299	SECTION 12-00014-00-SW	COUNTY WILL	TOTAL SHEETS 21	SHEET NO. 10
SRFS-4009(220) ILLINOIS FED. AID PROJECT			CONTRACT NO. 61D14	

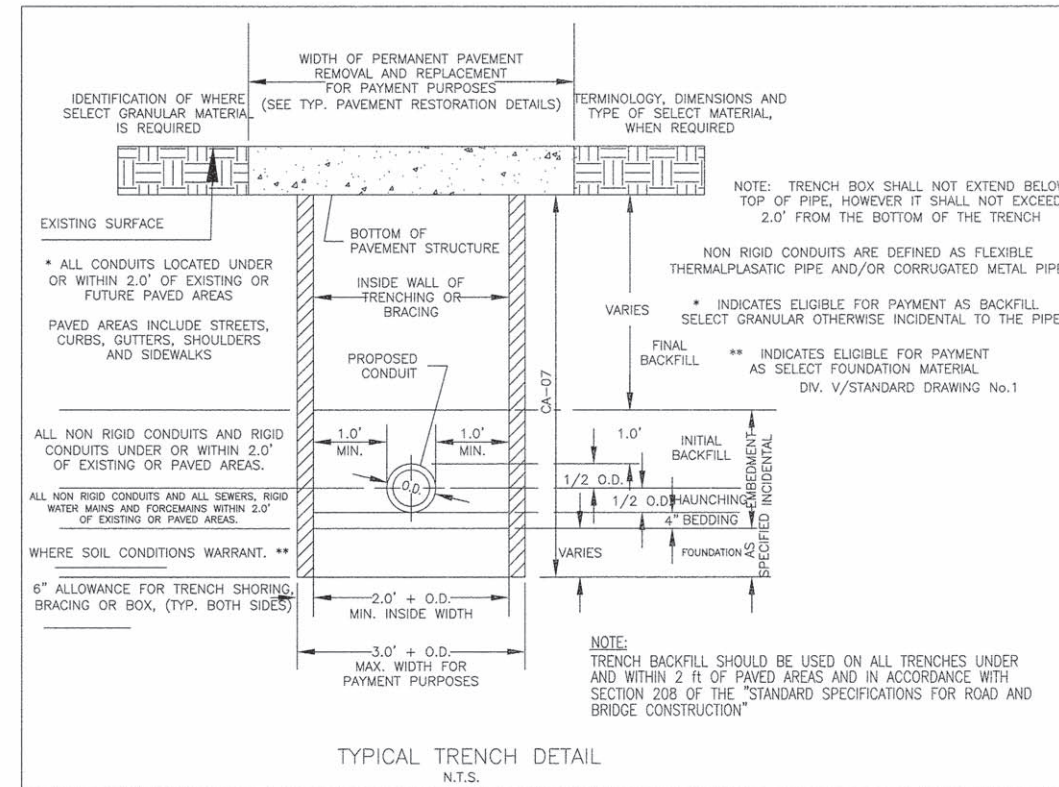
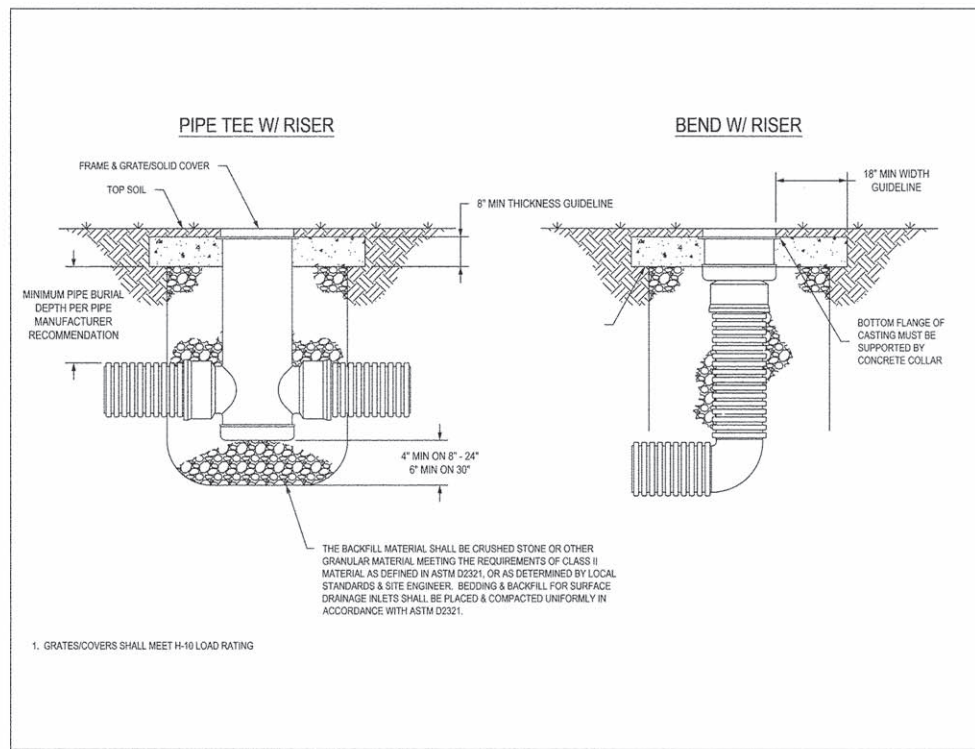

USER NAME =	DESIGNED - JWG	REVISED -
	DRAWN - CAG	REVISED -
PLOT SCALE =	CHECKED - JWG	REVISED -
PLOT DATE =	DATE - 02/04/2016	REVISED -

STATE OF ILLINOIS
DEPARTMENT OF TRANSPORTATION

STANDARD DETAILS

SCALE: N.T.S. SHEET NO. 12 OF 21 SHEETS STA. TO STA.

F.A.S. R.T.E. 299	SECTION 12-00014-00-SW	COUNTY WILL	TOTAL SHEETS 21	SHEET NO. 12
CONTRACT NO. 61D14				
SRTS-4009(220) ILLINOIS FED. AID PROJECT				

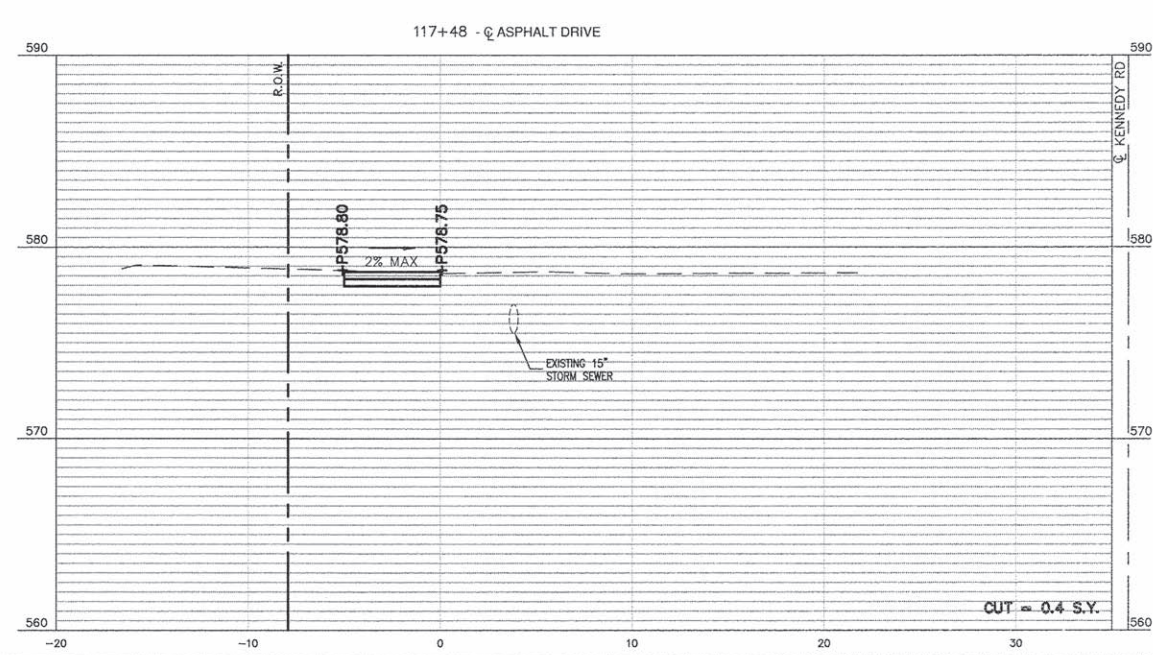
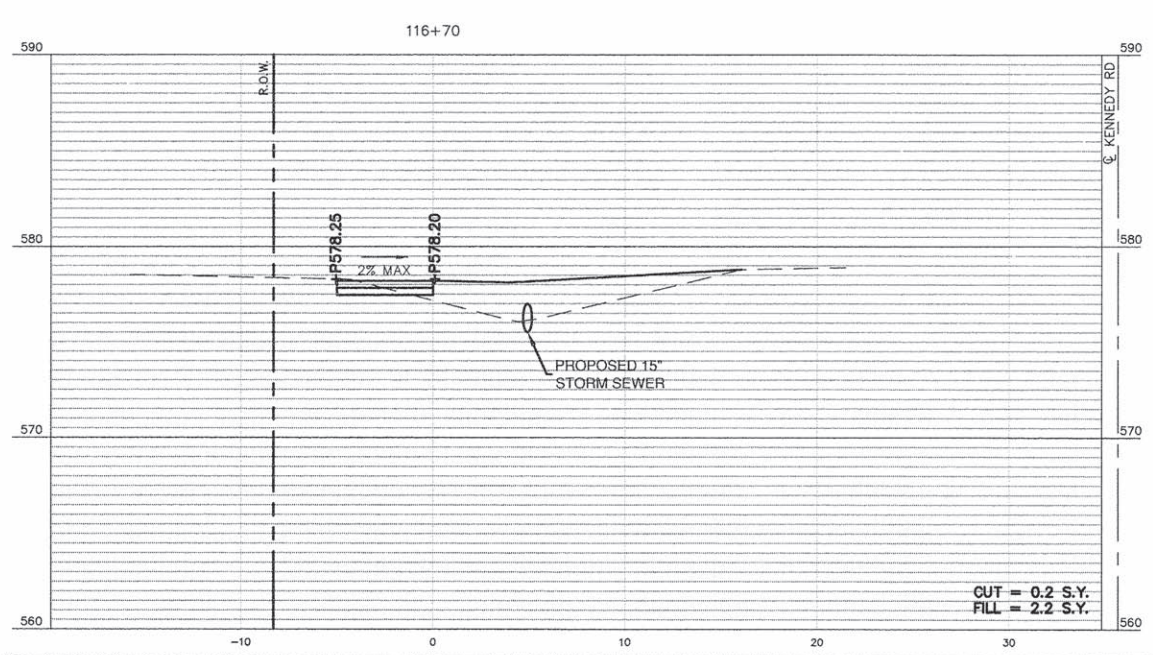
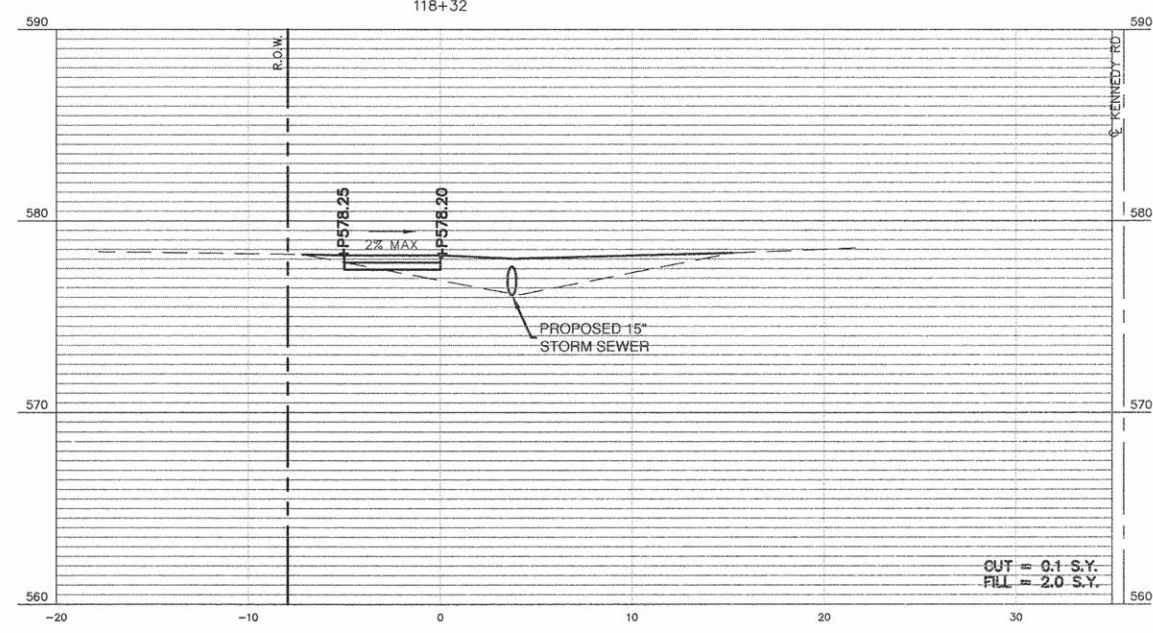
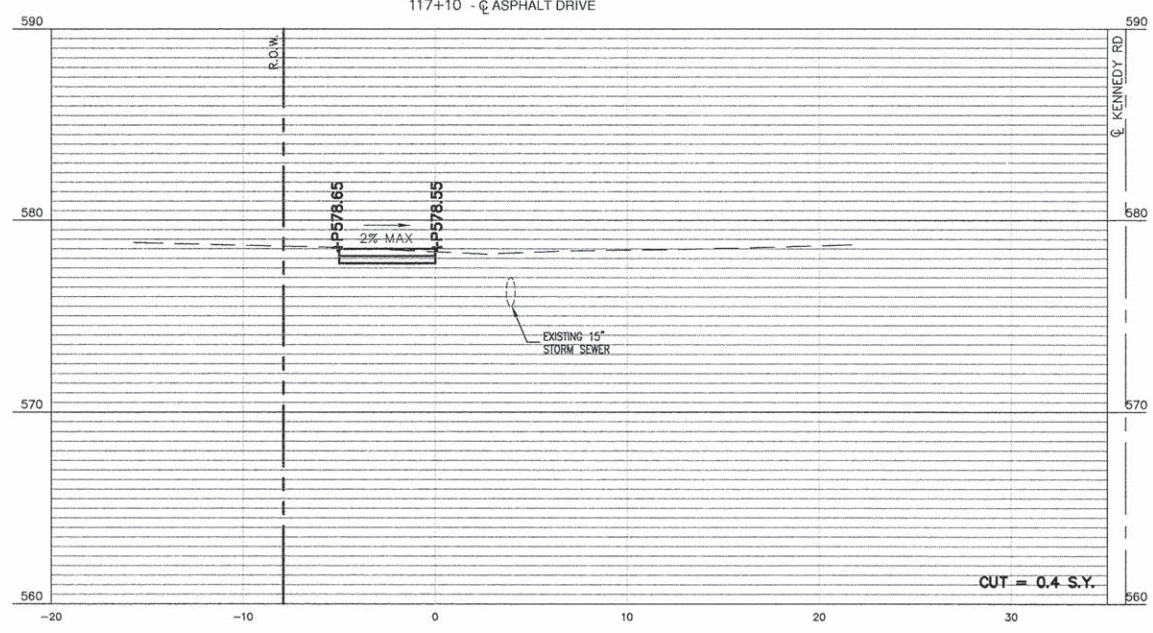
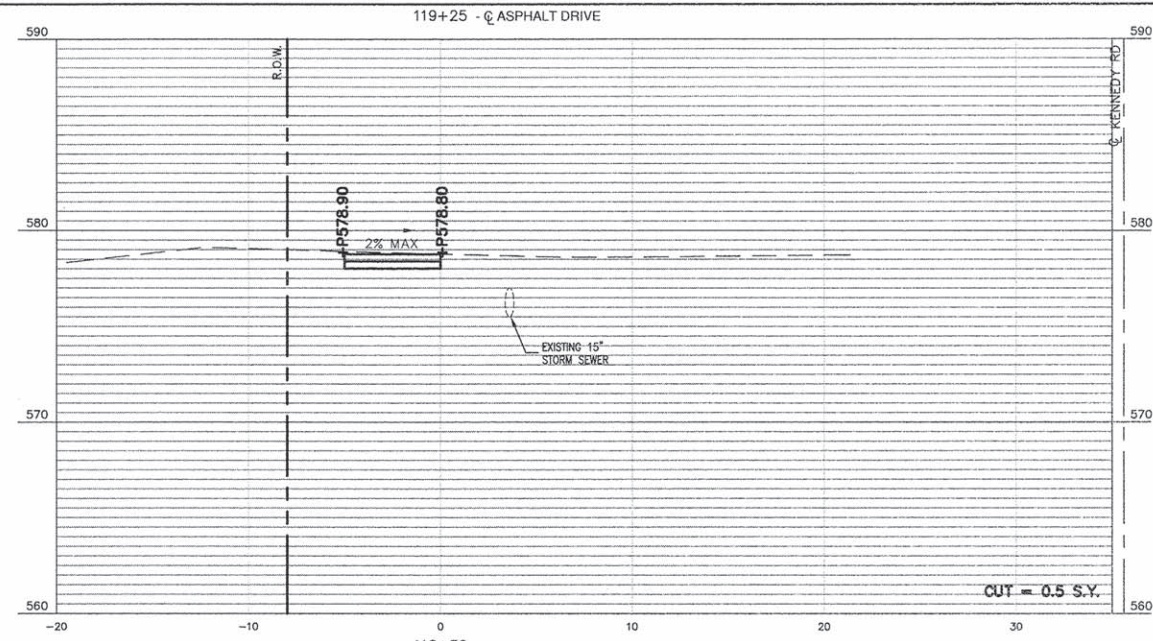
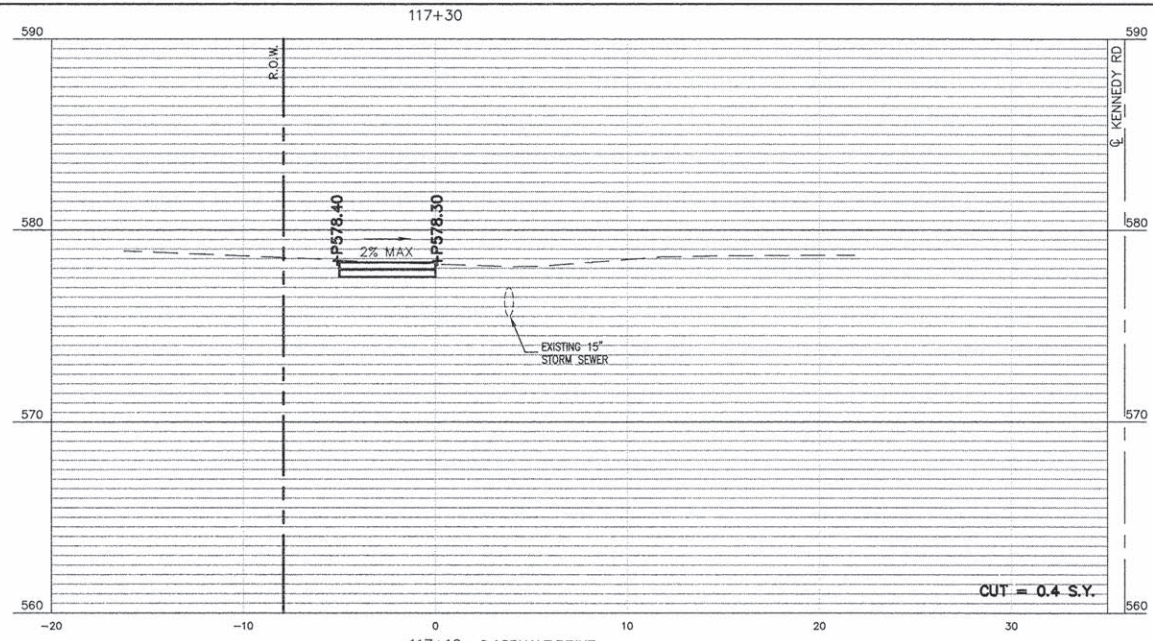

SCALE
V: 1:5
H: 1:5

USER NAME =	DESIGNED - JWG	REVISED -
PLOT SCALE =	DRAWN - CAG	REVISED -
PLOT DATE =	CHECKED - JWG	REVISED -
	DATE - 02/04/2016	REVISED -

STATE OF ILLINOIS
DEPARTMENT OF TRANSPORTATION

CROSS SECTION

SCALE: 1" = 5' SHEET NO. 15 OF 21 SHEETS STA. 116+70 TO STA. 119+25

F.A.S. R.T.E. 299	SECTION 12-00014-00-SW	COUNTY WILL	TOTAL SHEETS 21	SHEET NO. 15
CONTRACT NO. 61014				
SRTS-4009(220) ILLINOIS FED. AID PROJECT				

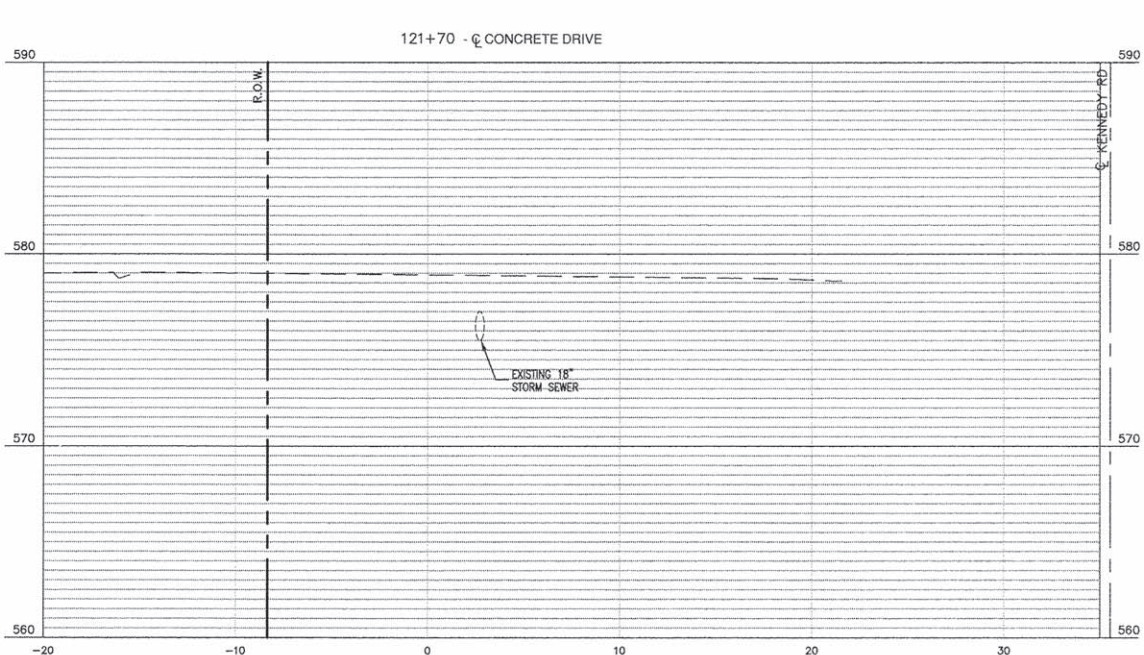
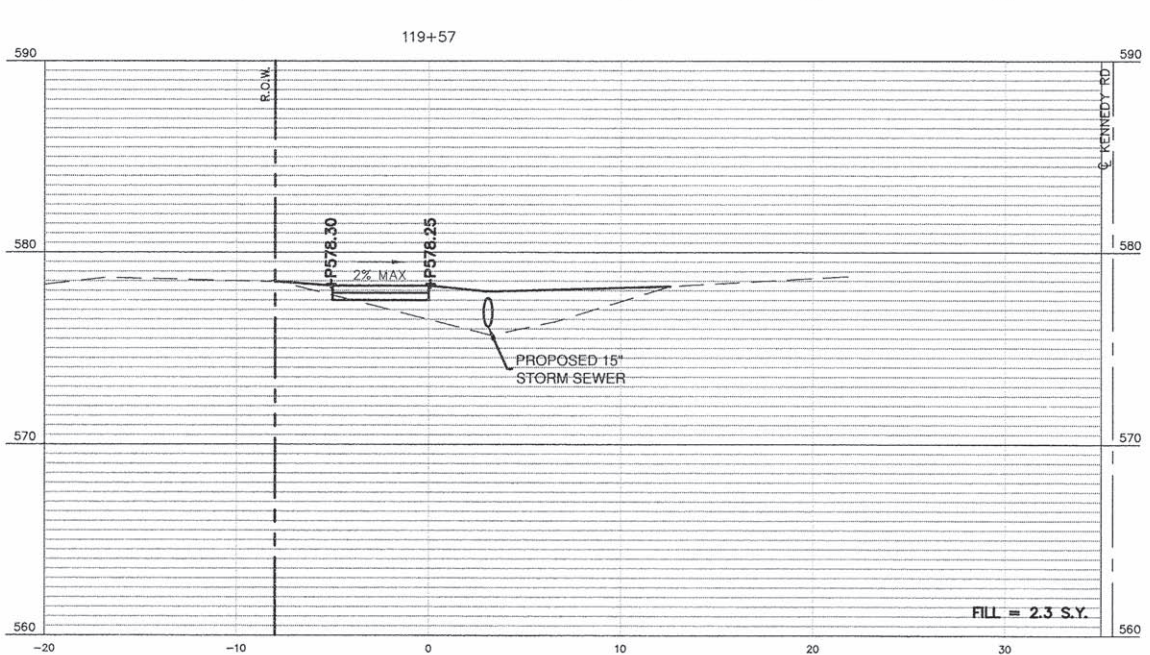
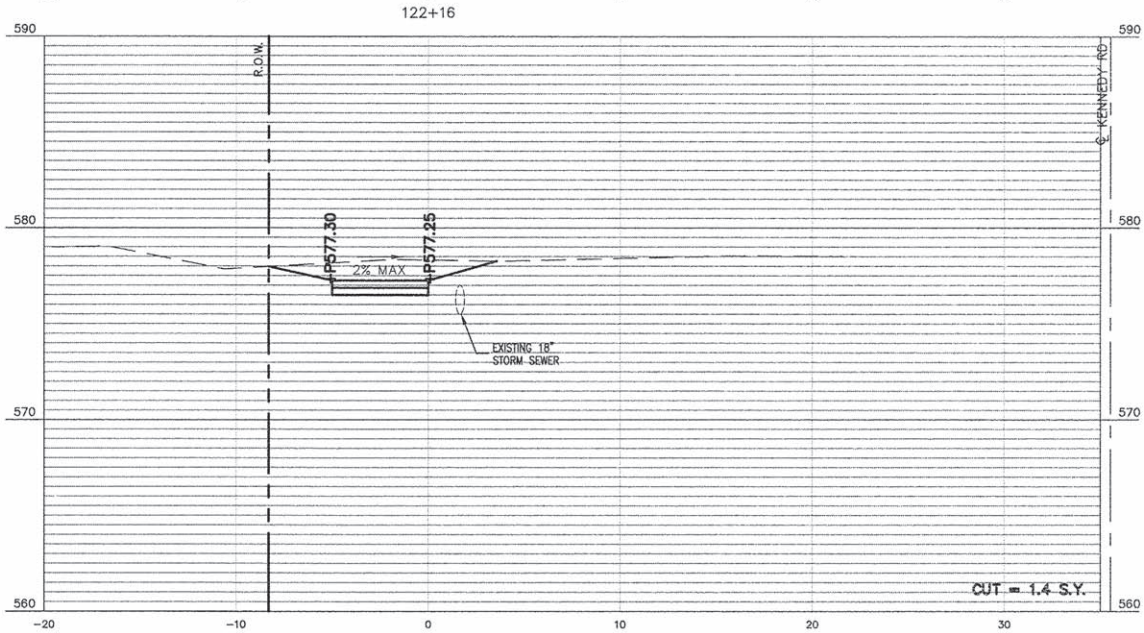
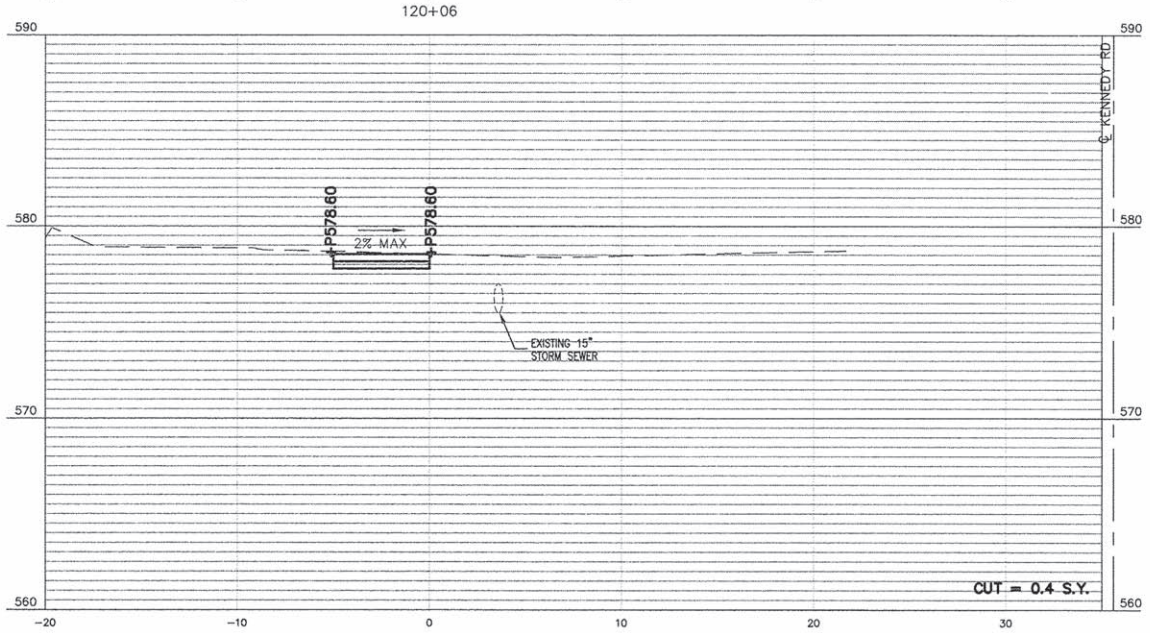
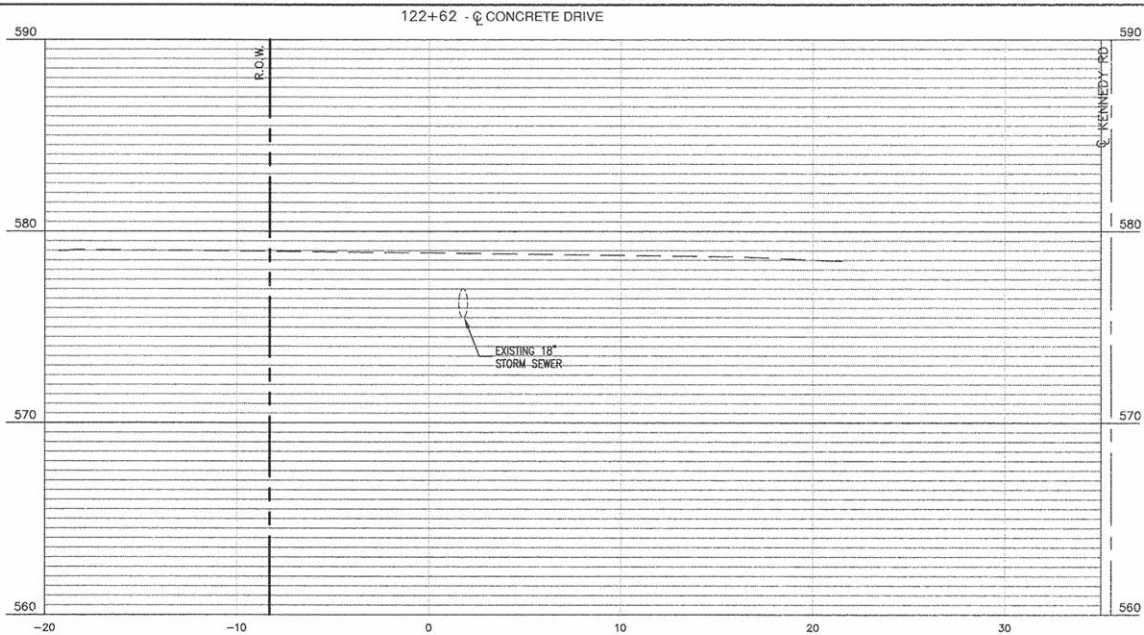
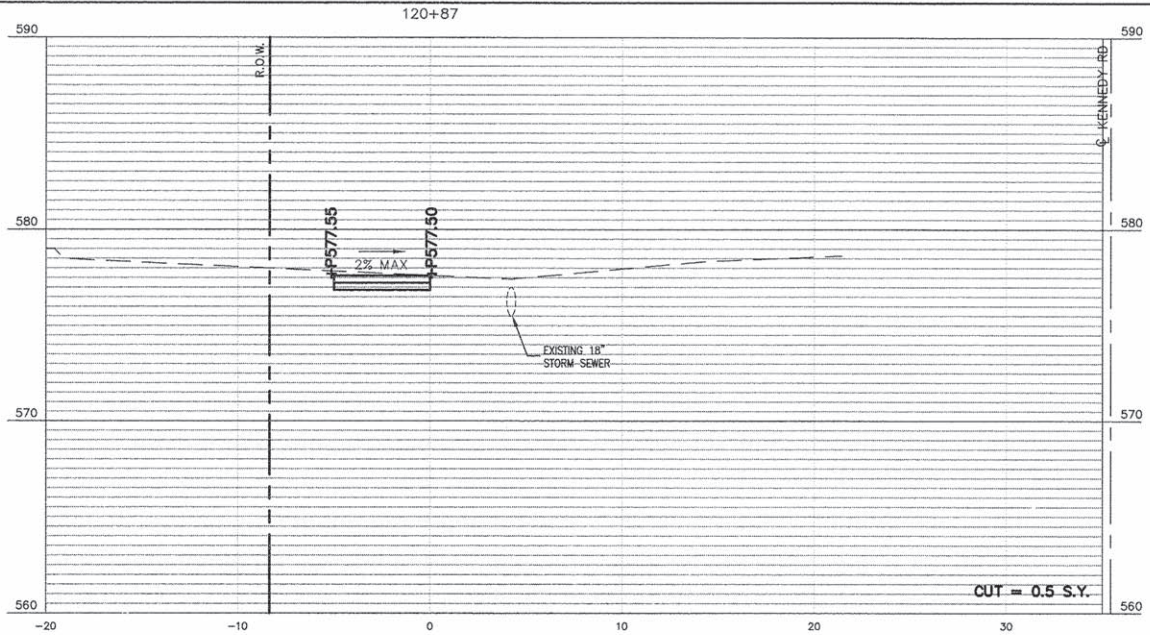

SCALE
V: 1:5
H: 1:5

USER NAME =	DESIGNED - JWG	REVISED -
	DRAWN - CAG	REVISED -
PLOT SCALE =	CHECKED - JWG	REVISED -
PLOT DATE =	DATE - 02/04/2016	REVISED -

STATE OF ILLINOIS
DEPARTMENT OF TRANSPORTATION

CROSS SECTION

SCALE: 1" = 5' SHEET NO. 16 OF 21 SHEETS STA. 119+57 TO STA. 122+62

F.A.S. R.T.E. 299	SECTION 12-00014-00-SW	COUNTY WILL	TOTAL SHEETS 21	SHEET NO. 16
CONTRACT NO. 61D14				
SRTS-4009(220) ILLINOIS FED. AID PROJECT				

X:\projects\11-11-2015\11-11-2015 State Routes\SideView\DWG\SS\SS14-C21 CROSS SECTIONS.dwg, C16, 6/28/2016 3:31:00 PM, gprafelz

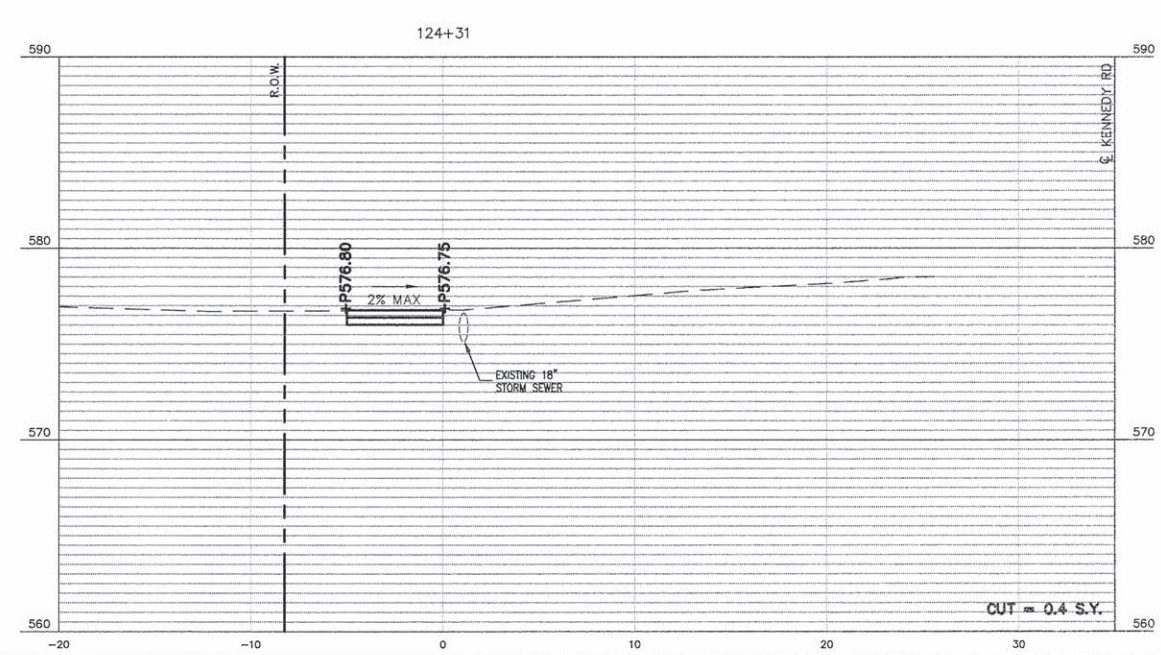
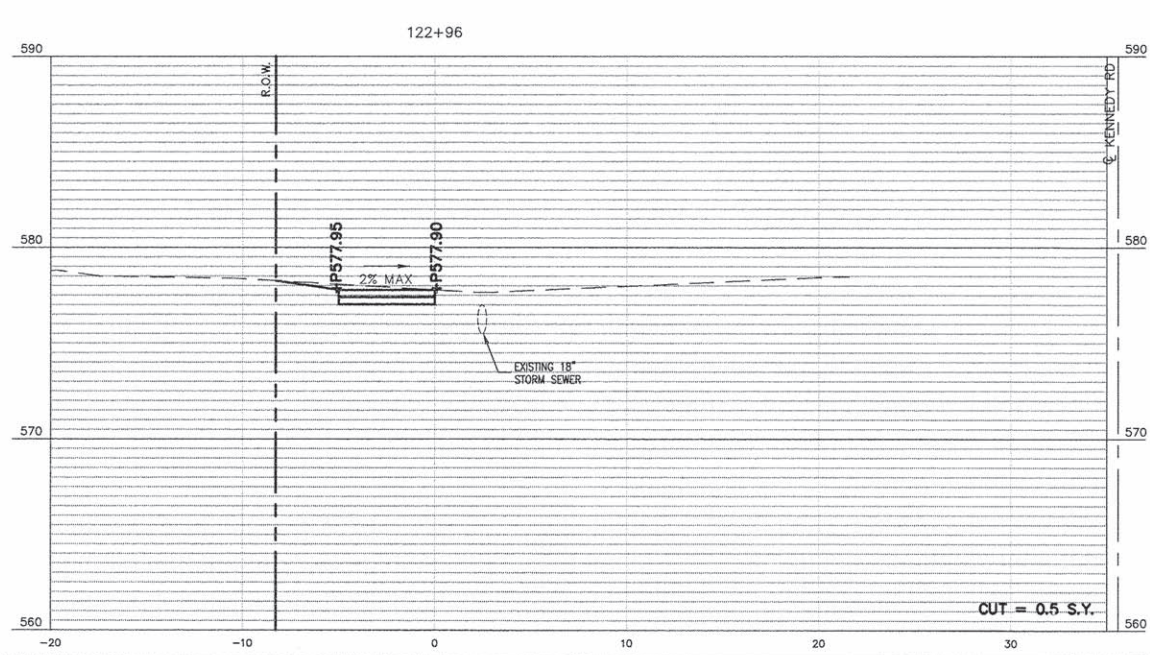
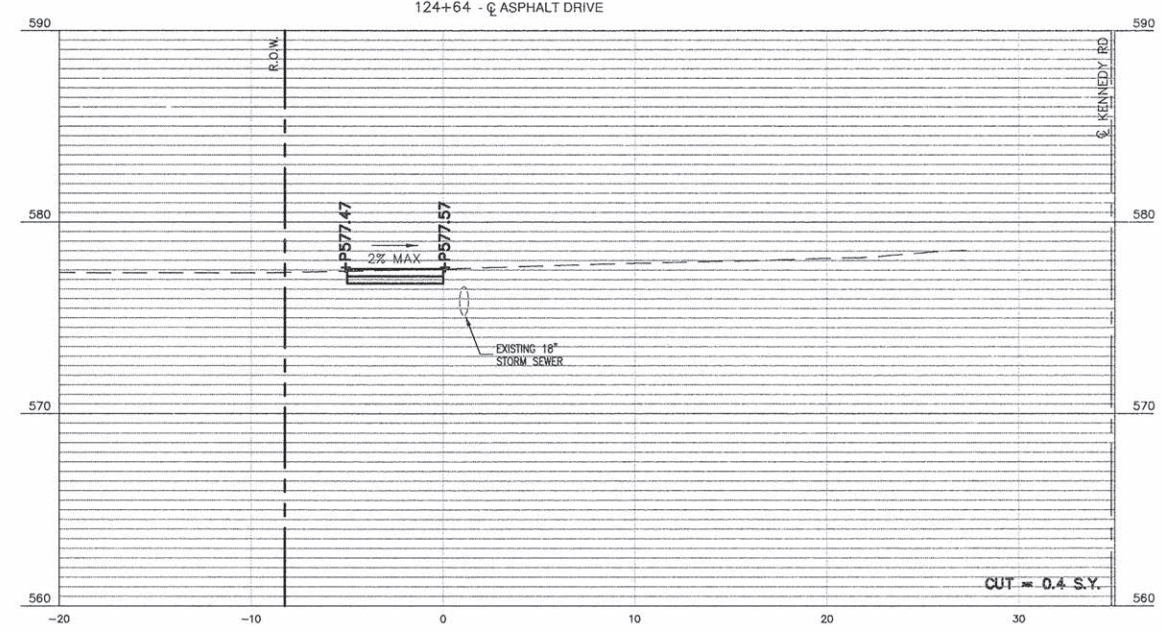
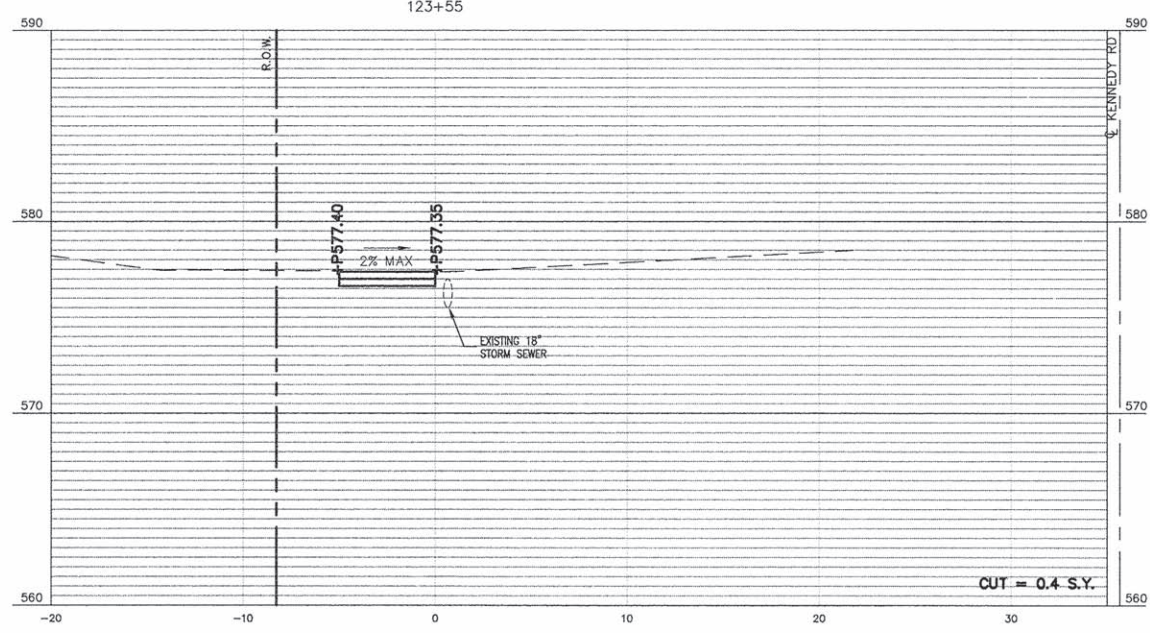
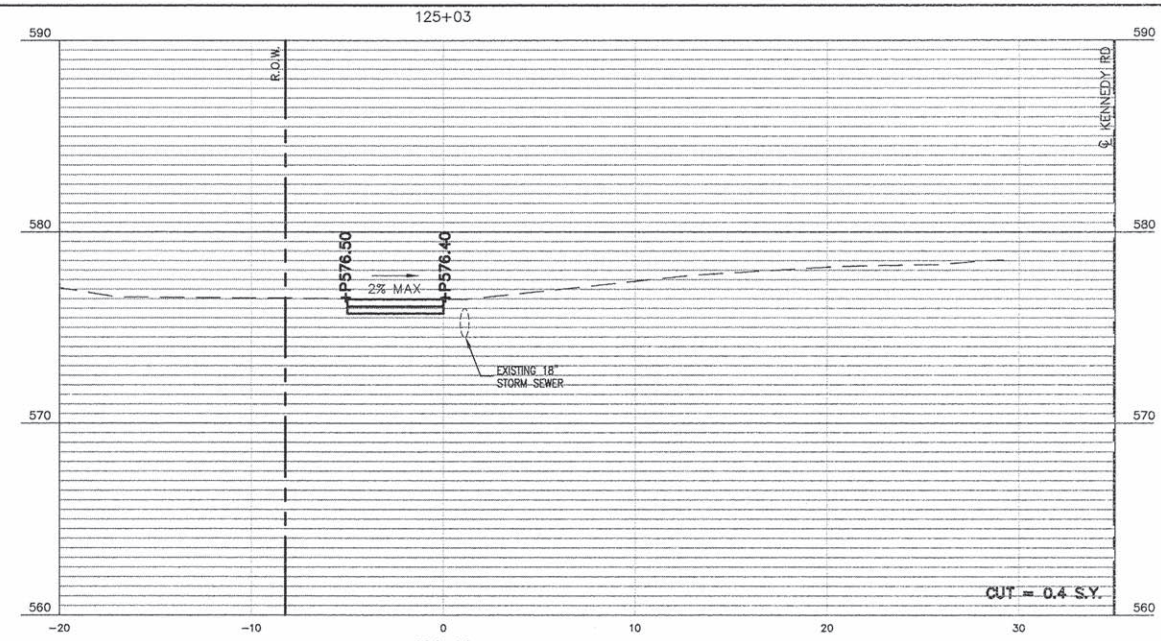
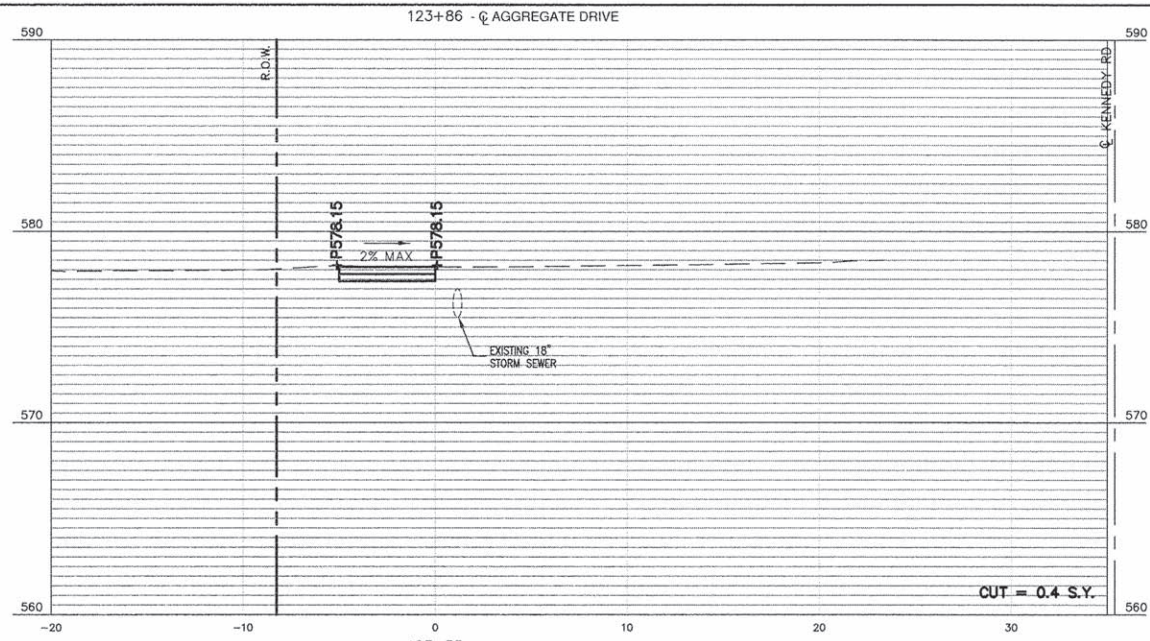

SCALE
V: 1:5
H: 1:5

USER NAME =	DESIGNED - JWG	REVISED -
PLOT SCALE =	DRAWN - CAG	REVISED -
PLOT DATE =	CHECKED - JWG	REVISED -
	DATE - 02/04/2016	REVISED -

STATE OF ILLINOIS
DEPARTMENT OF TRANSPORTATION

CROSS SECTION

SCALE: 1" = 5' SHEET NO. 17 OF 21 SHEETS STA. 122+96 TO STA. 125+03

F.A.S. R.T.E. 299	SECTION 12-00014-00-SW	COUNTY WILL	TOTAL SHEETS 21	SHEET NO. 17
SRTS-4009(220)			ILLINOIS FED. AID PROJECT	
CONTRACT NO. 61D14				

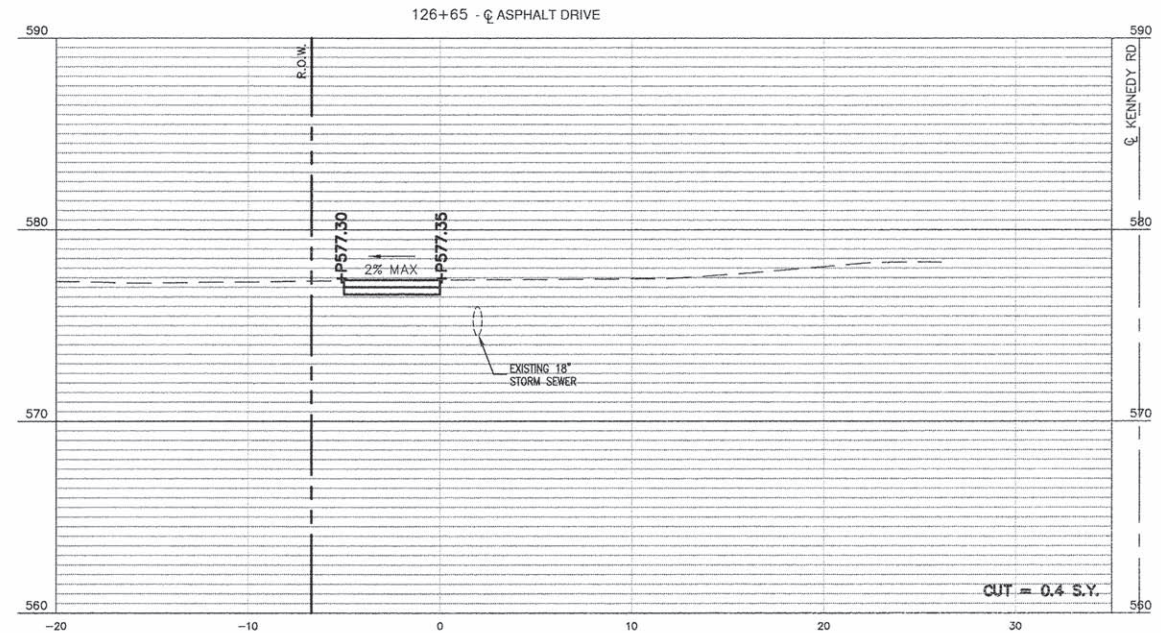
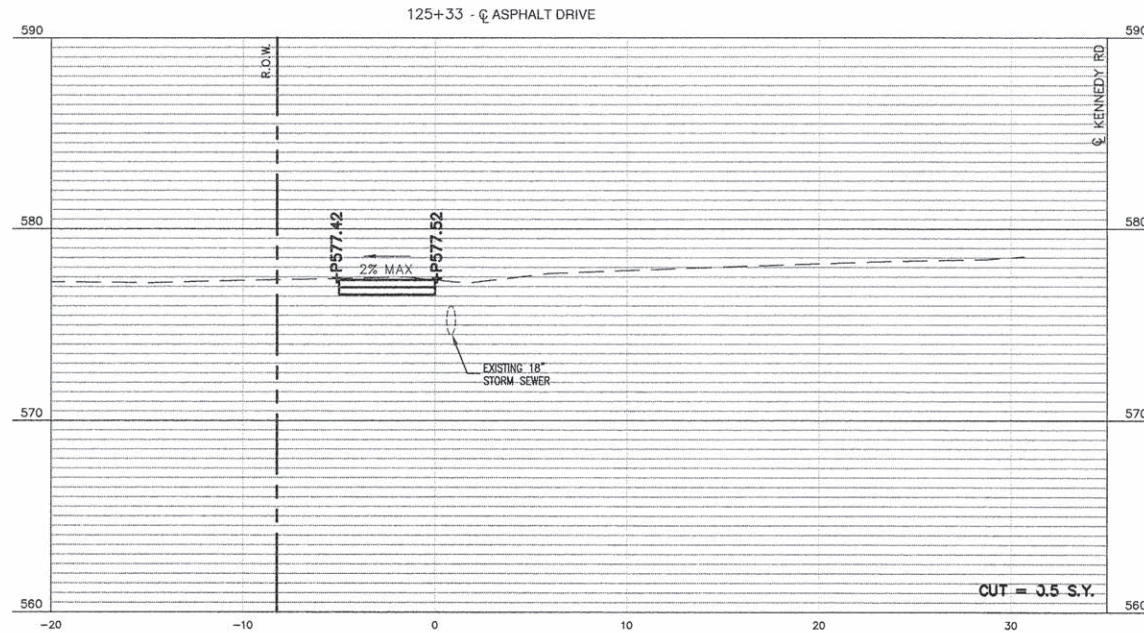
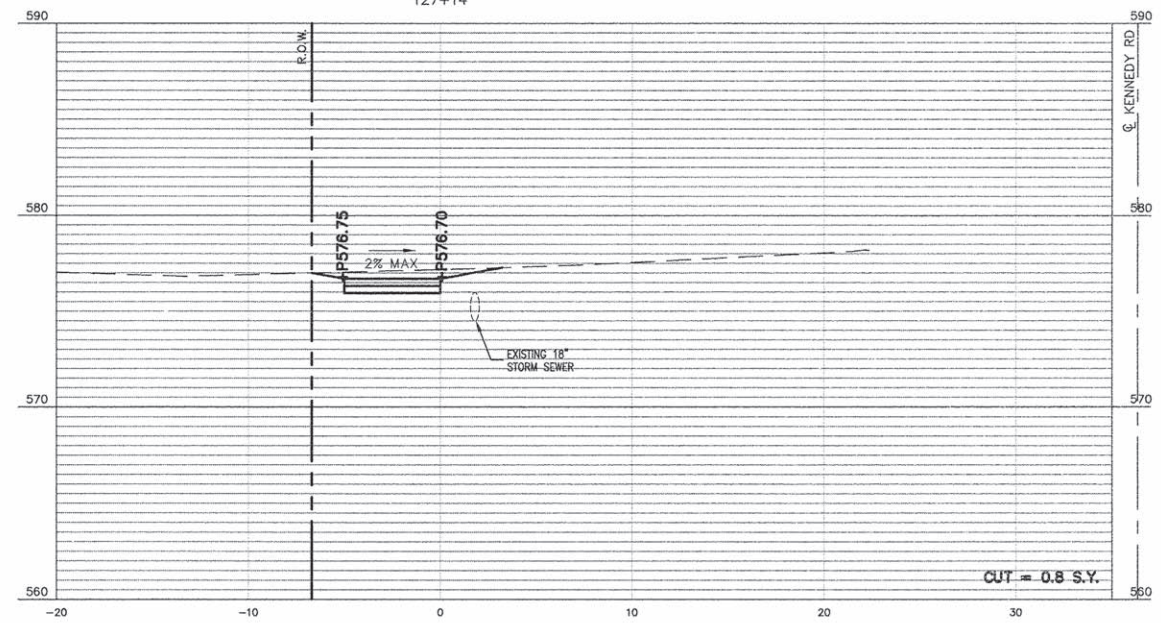
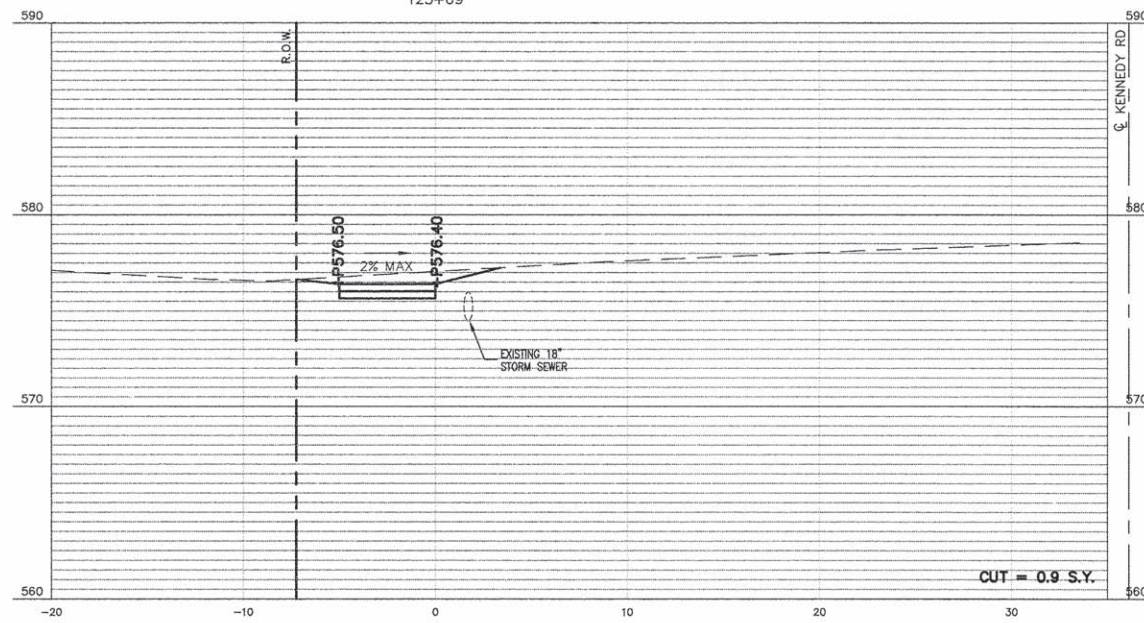
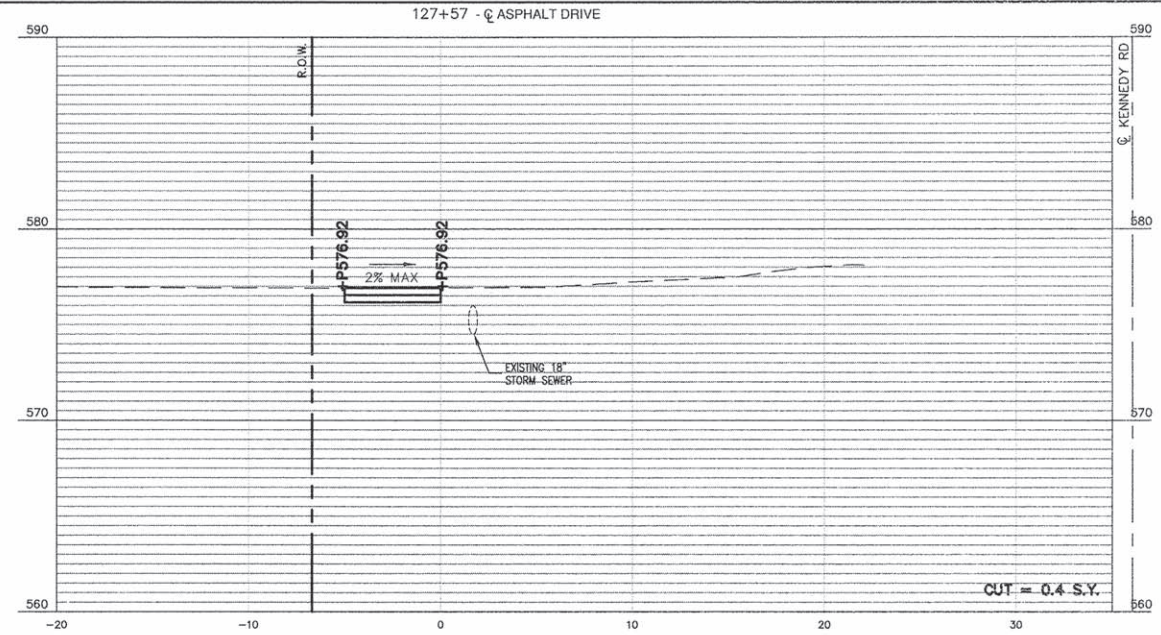
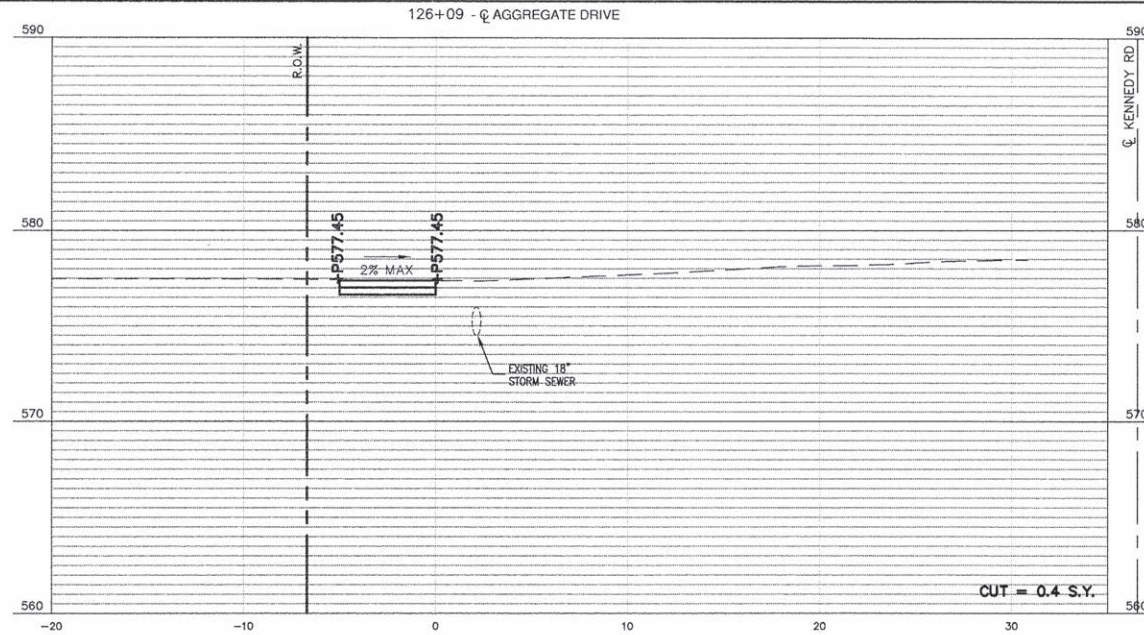

SCALE
V: 1:5
H: 1:5

USER NAME =	DESIGNED - JWJG	REVISED -
PLOT SCALE =	DRAWN - CAG	REVISED -
PLOT DATE =	CHECKED - JWJG	REVISED -
	DATE - 02/04/2016	REVISED -

STATE OF ILLINOIS
DEPARTMENT OF TRANSPORTATION

CROSS SECTION

SCALE: 1" = 5' SHEET NO. 18 OF 21 SHEETS STA. 125+33 TO STA. 127+57

F.A.S. R.T.E.	SECTION	COUNTY	TOTAL SHEETS	SHEET NO.
299	12-00014-00-SW	WILL	21	18
CONTRACT NO. 61D14				
SRTS-4009(220) ILLINOIS FED. AID PROJECT				

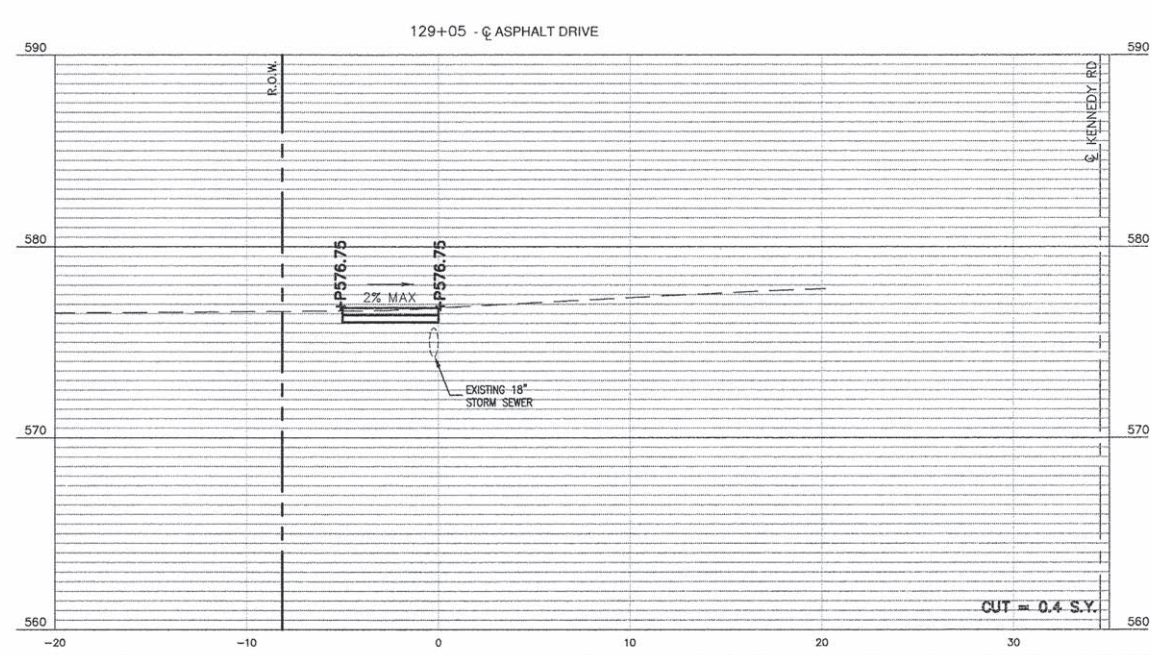
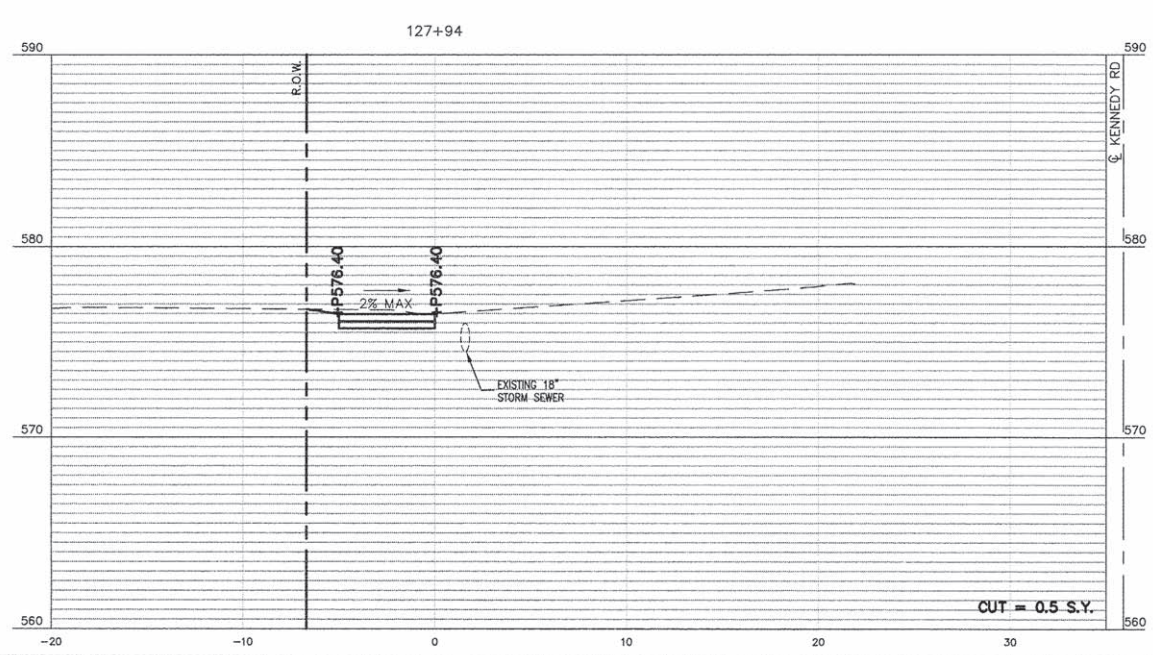
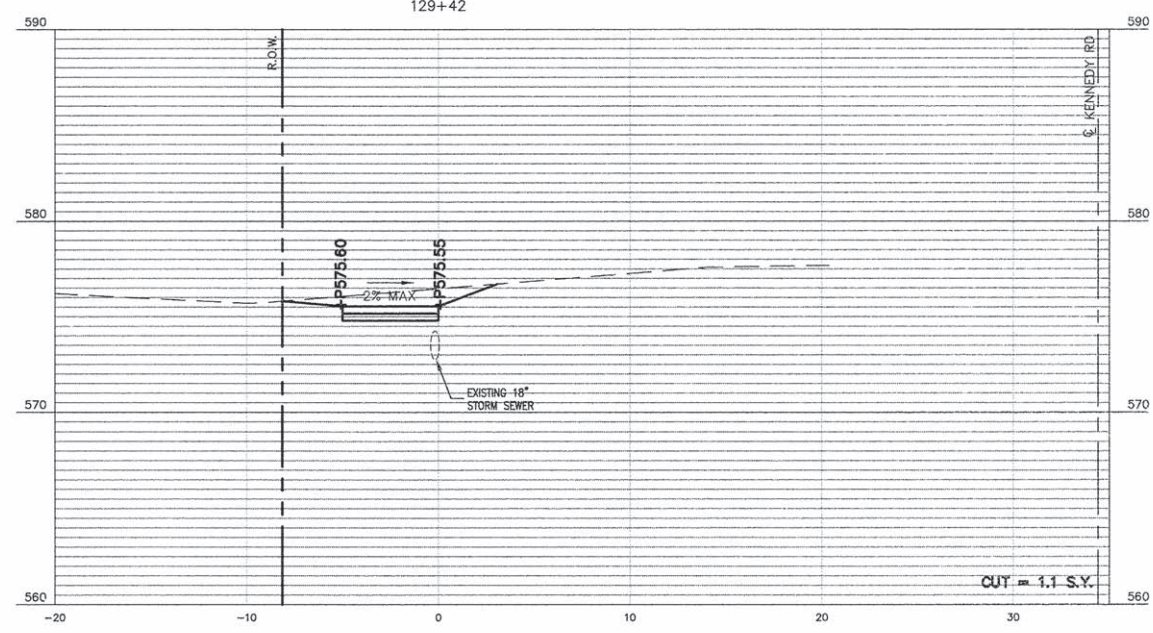
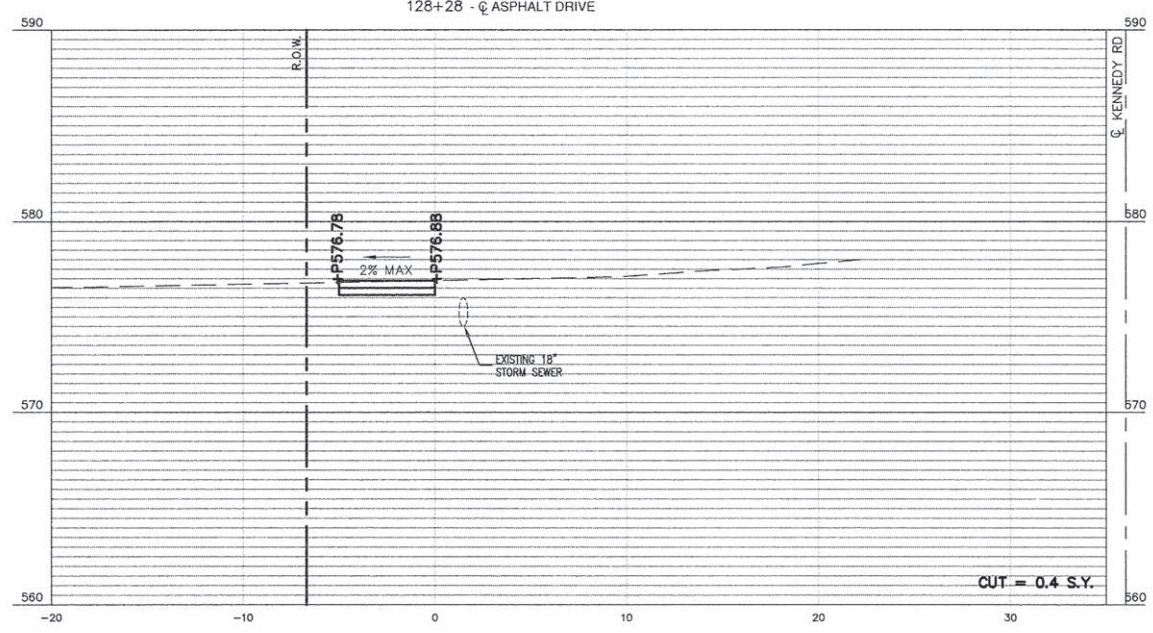
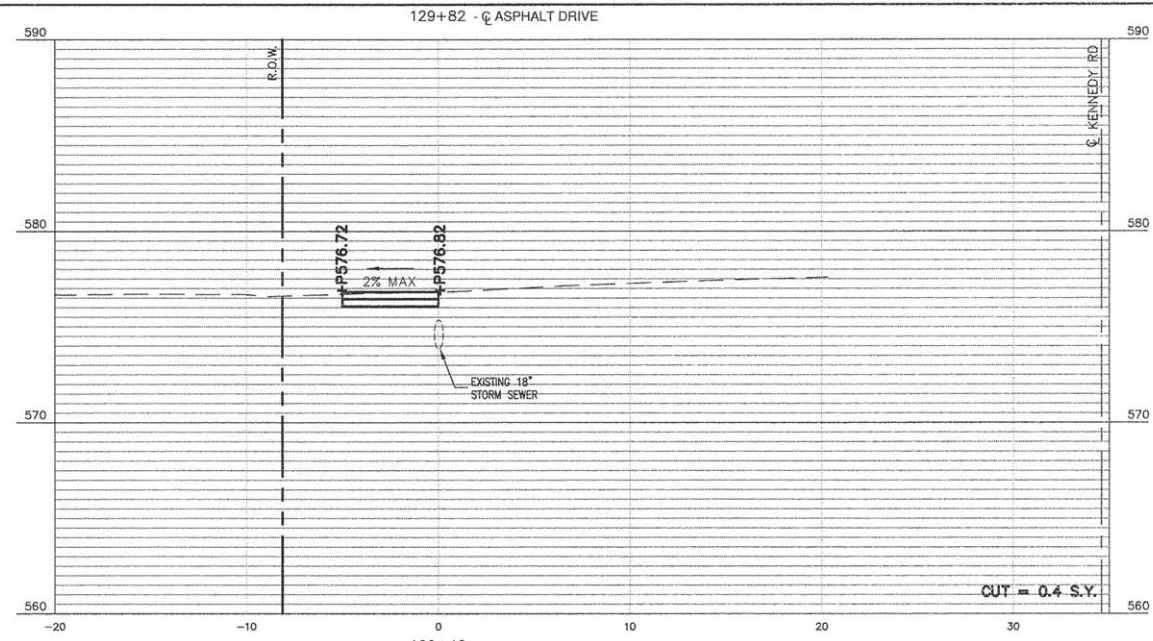
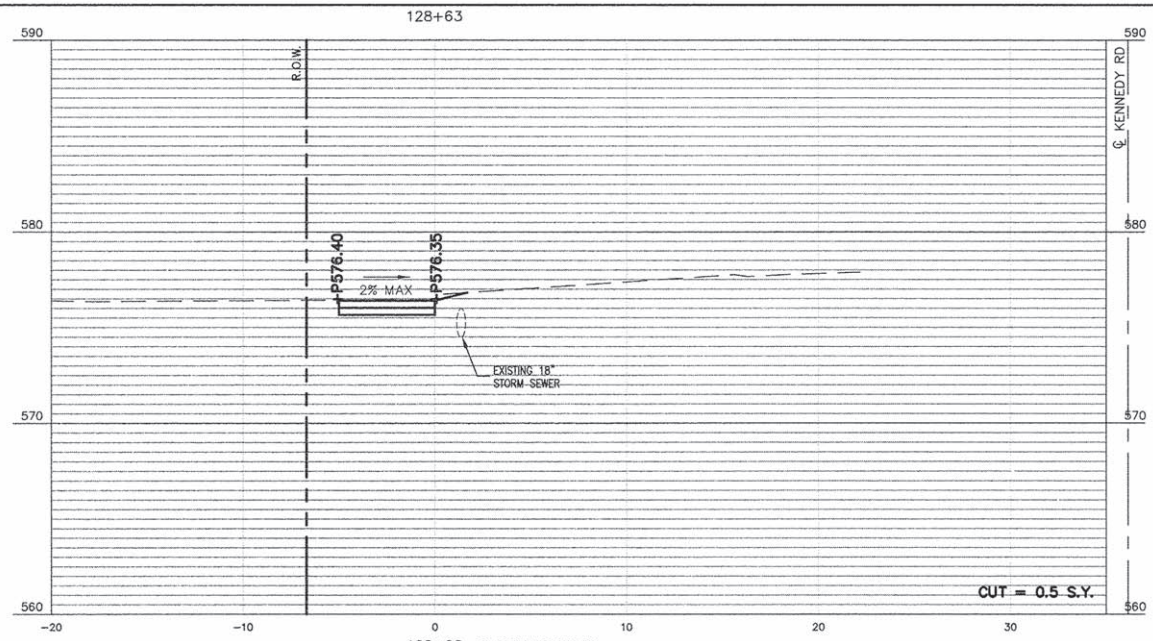

SCALE
V: 1:5
H: 1:5

USER NAME =	DESIGNED - JWG	REVISED -
PLOT SCALE =	DRAWN - CAG	REVISED -
PLOT DATE =	CHECKED - JWG	REVISED -
	DATE - 02/04/2016	REVISED -

STATE OF ILLINOIS
DEPARTMENT OF TRANSPORTATION

CROSS SECTION

SCALE: 1" = 5' SHEET NO. 19 OF 21 SHEETS STA. 127+94 TO STA. 129+82

F.A.S. R.T.E. 299	SECTION 12-00014-00-SW	COUNTY WILL	TOTAL SHEETS 21	SHEET NO. 19
SRTS-4009(220) ILLINOIS FED. AID PROJECT			CONTRACT NO. 61114	

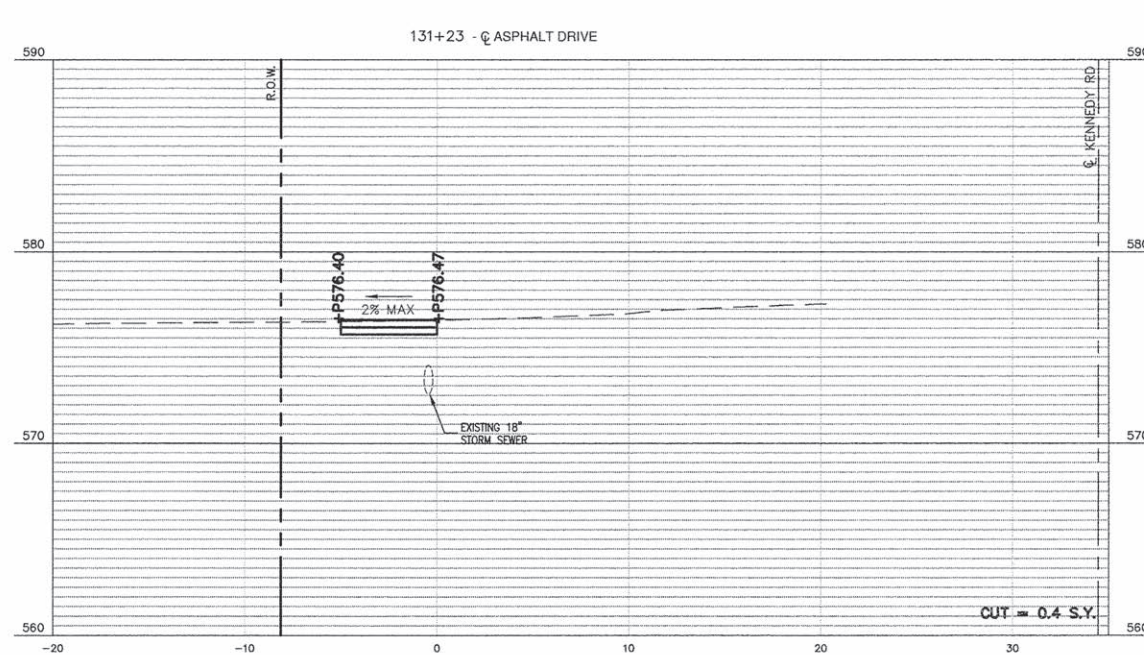
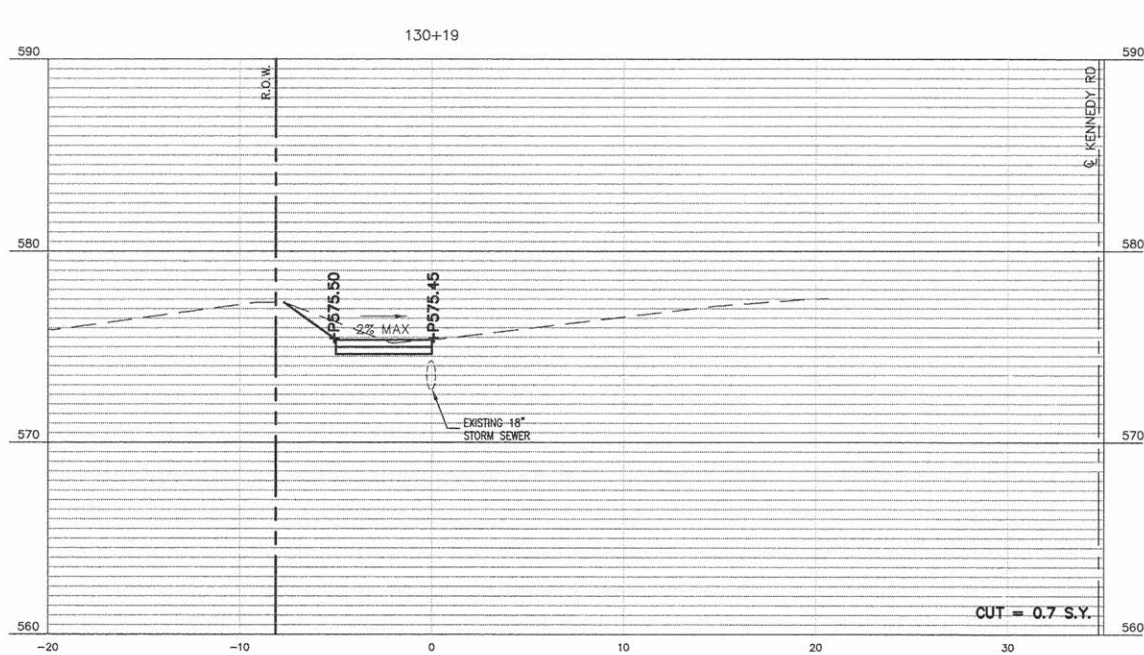
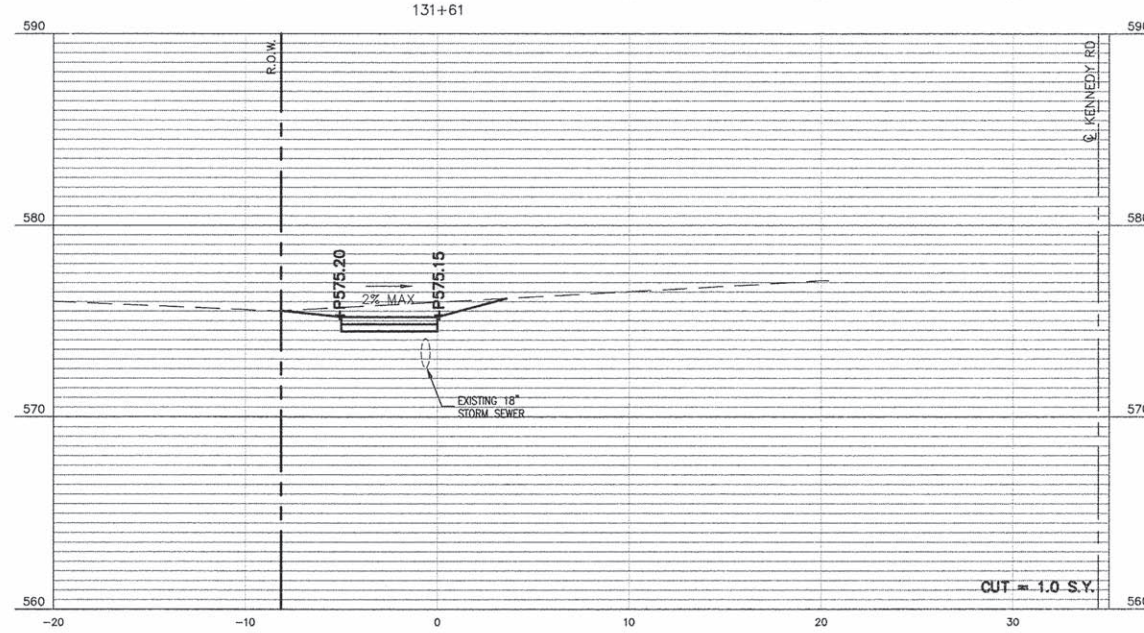
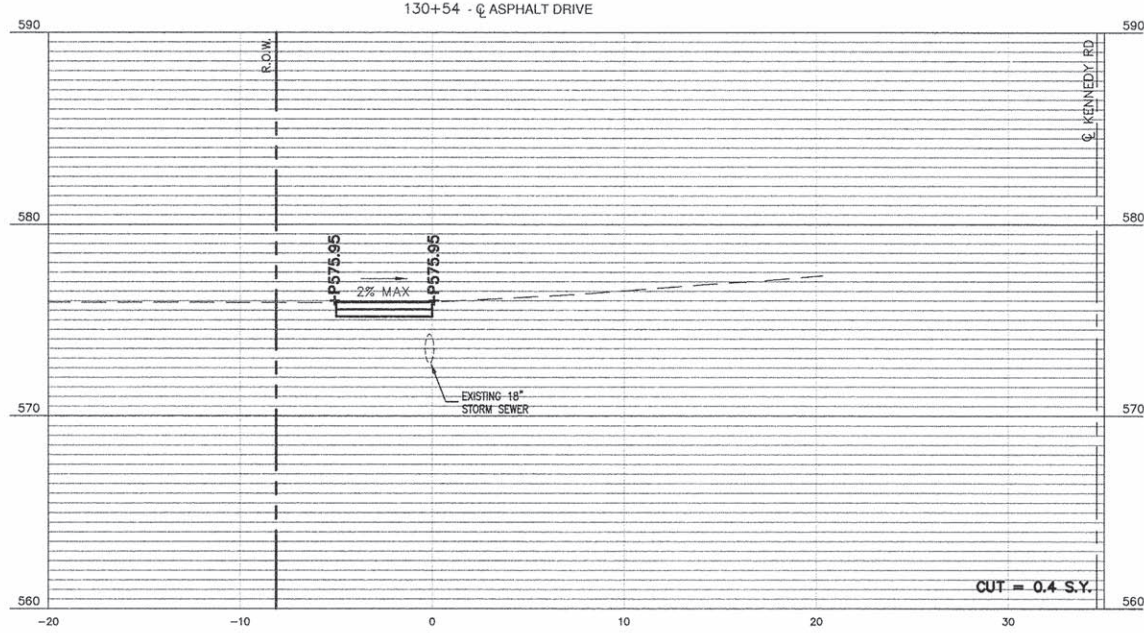
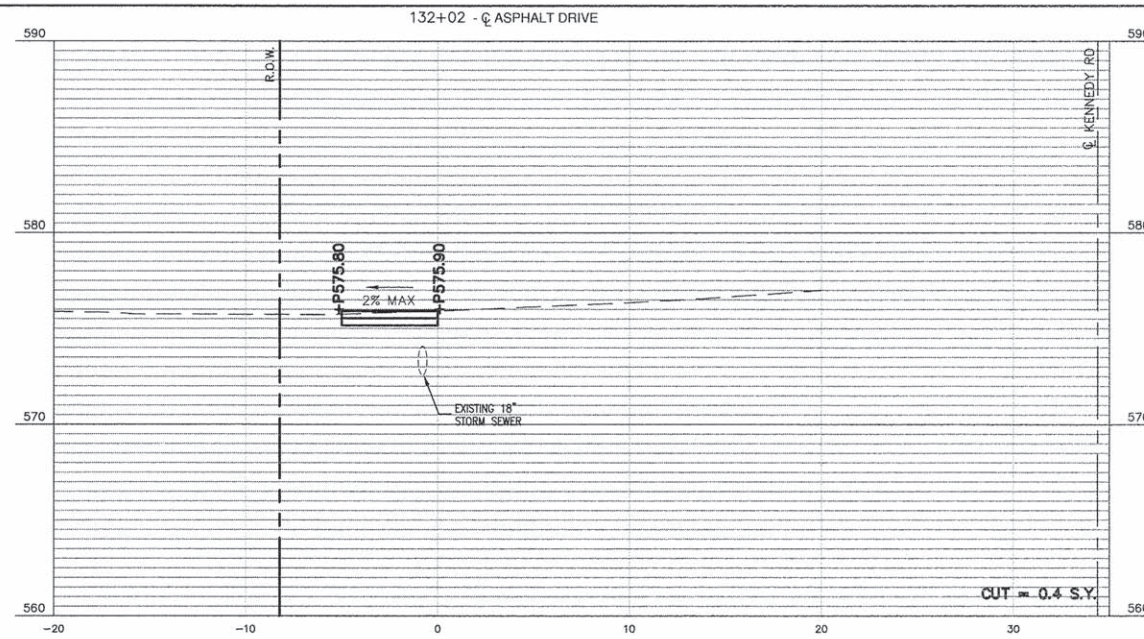
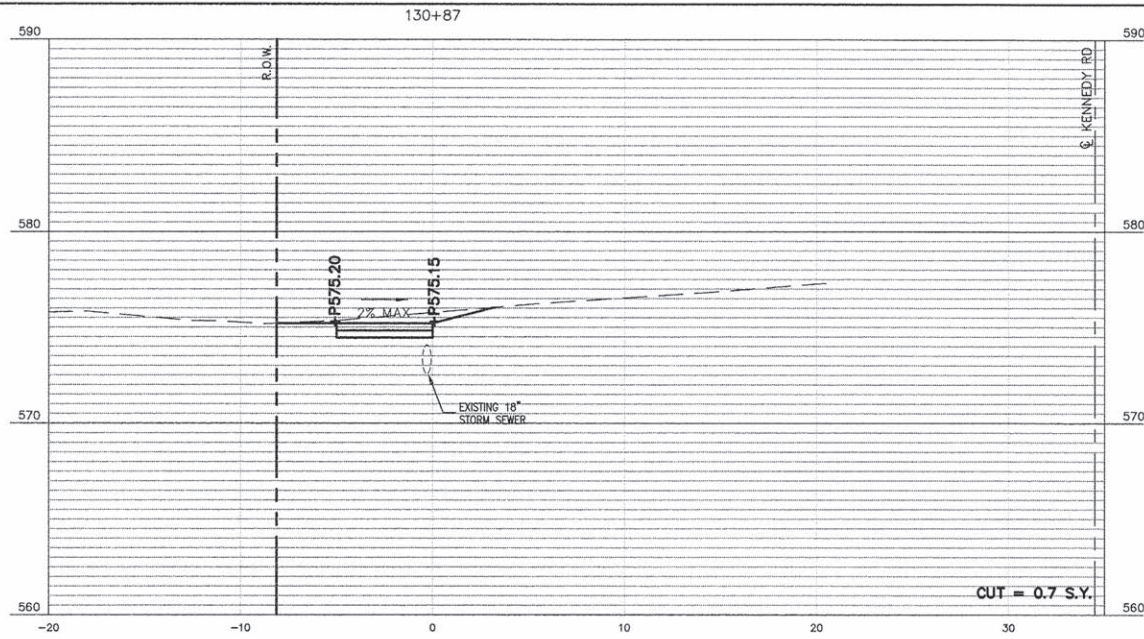

SCALE
V: 1:5
H: 1:5

USER NAME =	DESIGNED - JWG	REVISED -
	DRAWN - CAG	REVISED -
PLOT SCALE =	CHECKED - JWG	REVISED -
PLOT DATE =	DATE - 02/04/2016	REVISED -

STATE OF ILLINOIS
DEPARTMENT OF TRANSPORTATION

CROSS SECTION

SCALE: 1" = 5' SHEET NO. 20 OF 21 SHEETS STA. 130+19 TO STA. 132+02

F.A.S. R.T.E.	SECTION	COUNTY	TOTAL SHEETS	SHEET NO.
299	12-00014-00-SW	WILL	21	20
CONTRACT NO. 61D14				
SRTS-4009(220) ILLINOIS FED. AID PROJECT				

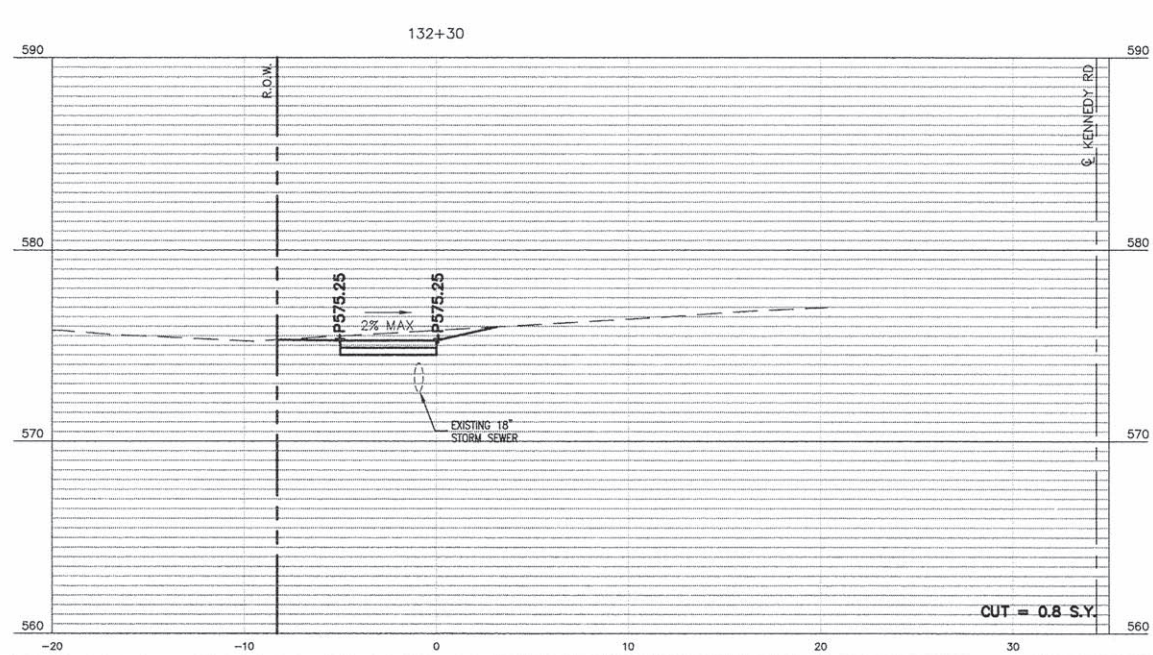
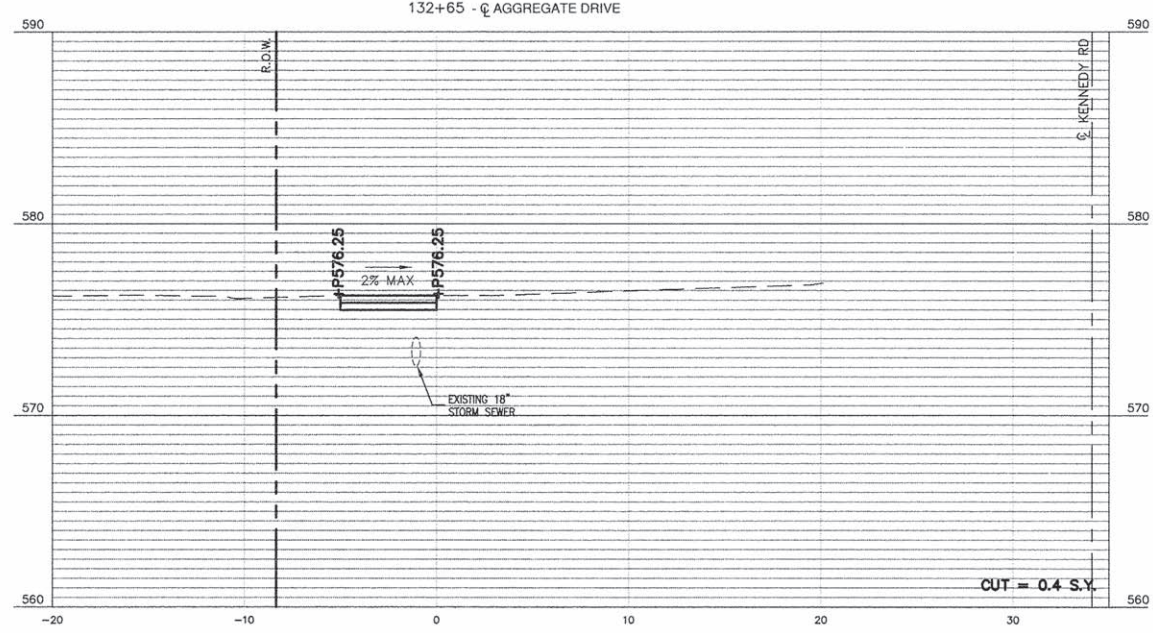
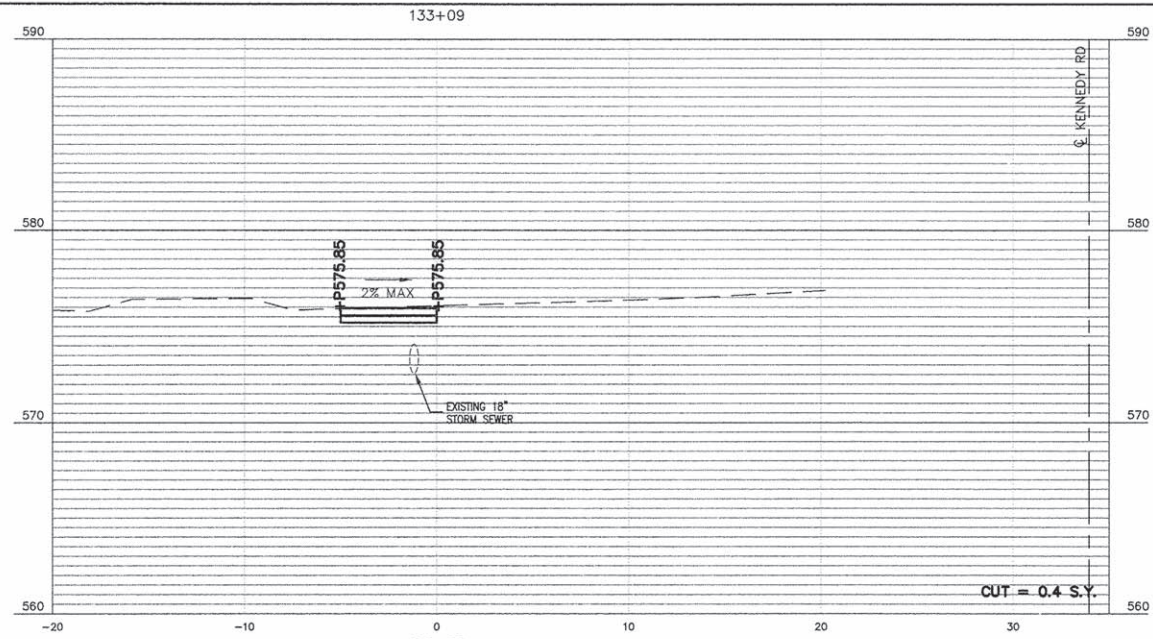

SCALE
V: 1:5
H: 1:5

USER NAME =	DESIGNED - JWG	REVISED -
	DRAWN - CAG	REVISED -
PLOT SCALE =	CHECKED - JWG	REVISED -
PLOT DATE =	DATE - 02/04/2016	REVISED -

STATE OF ILLINOIS
DEPARTMENT OF TRANSPORTATION

CROSS SECTION
SCALE: 1" = 5' SHEET NO. 21 OF 21 SHEETS STA. 132+30 TO STA. 133+09

F.A.S. R.T.E. 299	SECTION 12-00014-00-SW	COUNTY WILL	TOTAL SHEETS 21	SHEET NO. 21
CONTRACT NO. 61014			ILLINOIS FED. AID PROJECT	