

F.A.P. RTE.	SECTION	COUNTY	TOTAL SHEETS	SHEET NO.
337	20R-4	LAKE	232	109A
STA.		TO STA.		
FED. ROAD DIST. NO.		ILLINOIS FED. AID PROJECT		

CONTRACT NO. 60860

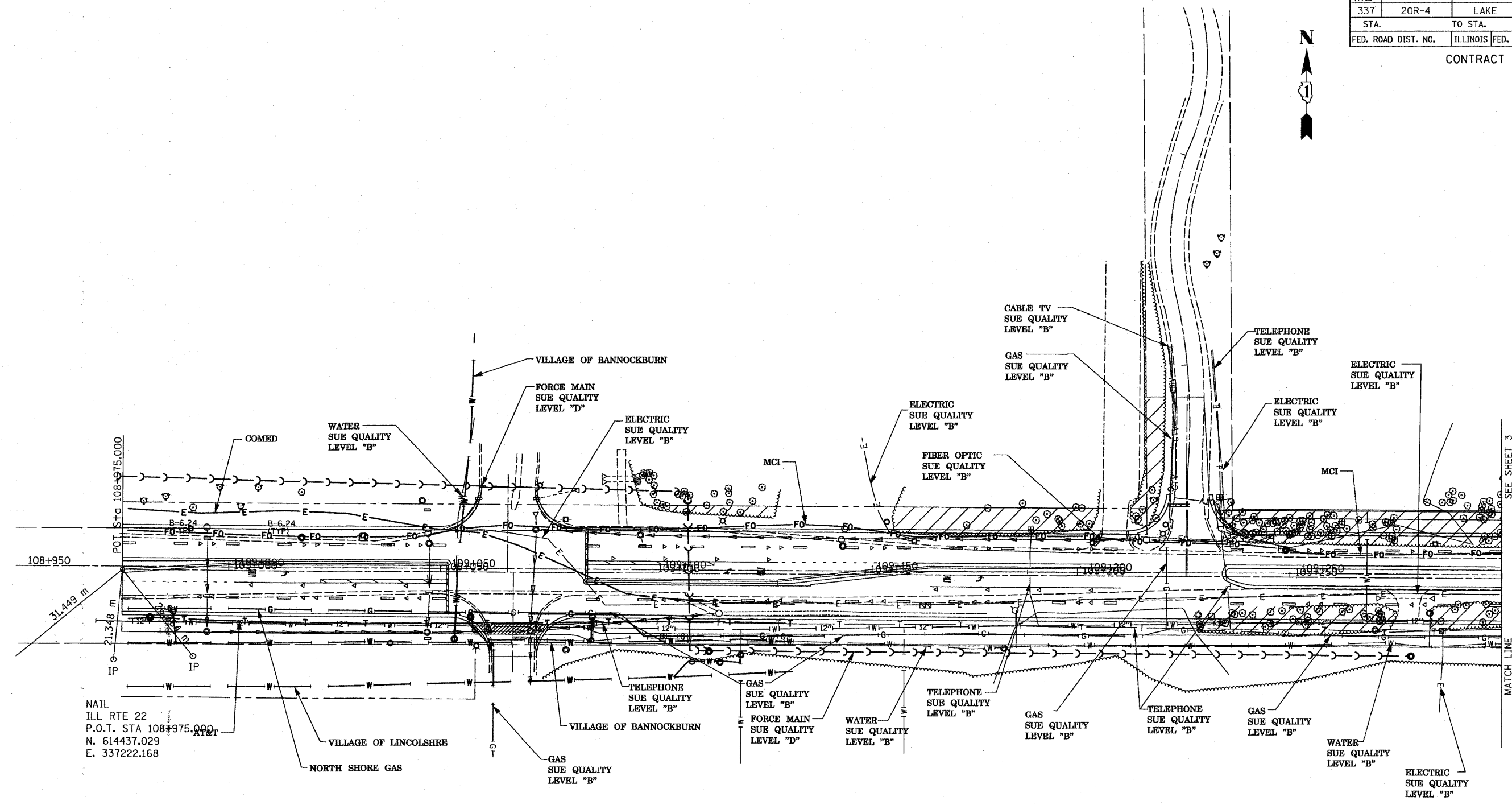

NAIL
ILL RTE 22
P.O.T. STA 108+975.000
N. 614437.029
E. 337222.168

—T—T—	TELEPHONE
—W—W—	WATER
—G—G—	GAS
—CTV—CTV—CTV—	CABLE TELEVISION
—FO—FO—FO—	FIBER OPTIC
—E—E—	ELECTRIC

FOR SUE INFORMATION ONLY



TBE **TBE GROUP, INC.**
 CIVIL ENGINEERING * TRANSPORTATION * ENVIRONMENTAL
 * PLANNING * UTILITY ENGINEERING/LOCATING
 SOUTHERN REGION: FL, GA, SC, NC
 NORTHERN REGION: IL, IN, MI, OH, MD, NJ, NY
 PA, VA, CANADA
 WESTERN REGION: AZ, NV, NM, TX, CA, OR, UT, WA
 SUE Quality Level "B" Completed On: 3/20/02
 Prepared By: JAC QA/QC By: RLC Final QA/QC By: *RLC*
 TBE Project No: IL09500117, IL09510404, IL09510418



205 W. WACKER DRIVE
 SUITE 1020
 CHICAGO, IL 60606
 (312) 704-1970

REVISIONS	
NAME	DATE
NEW UTILITIES IN COLOR	7/28/10

ILLINOIS DEPARTMENT OF TRANSPORTATION
 IL RTE. 22
 FROM EAST OF I-94 TO
 WEST OF US-41
 SCALE 1:500 (METRIC UNIT) DRAWN BY
 DATE CHECKED BY