

STATE OF ILLINOIS
DEPARTMENT OF TRANSPORTATION

Notes:

Hatched area to be poured after superstructure false work has been removed. Quantity of concrete included with Concrete Superstructure.

Limit fill height to Elev. 608.25 without superstructure in place.

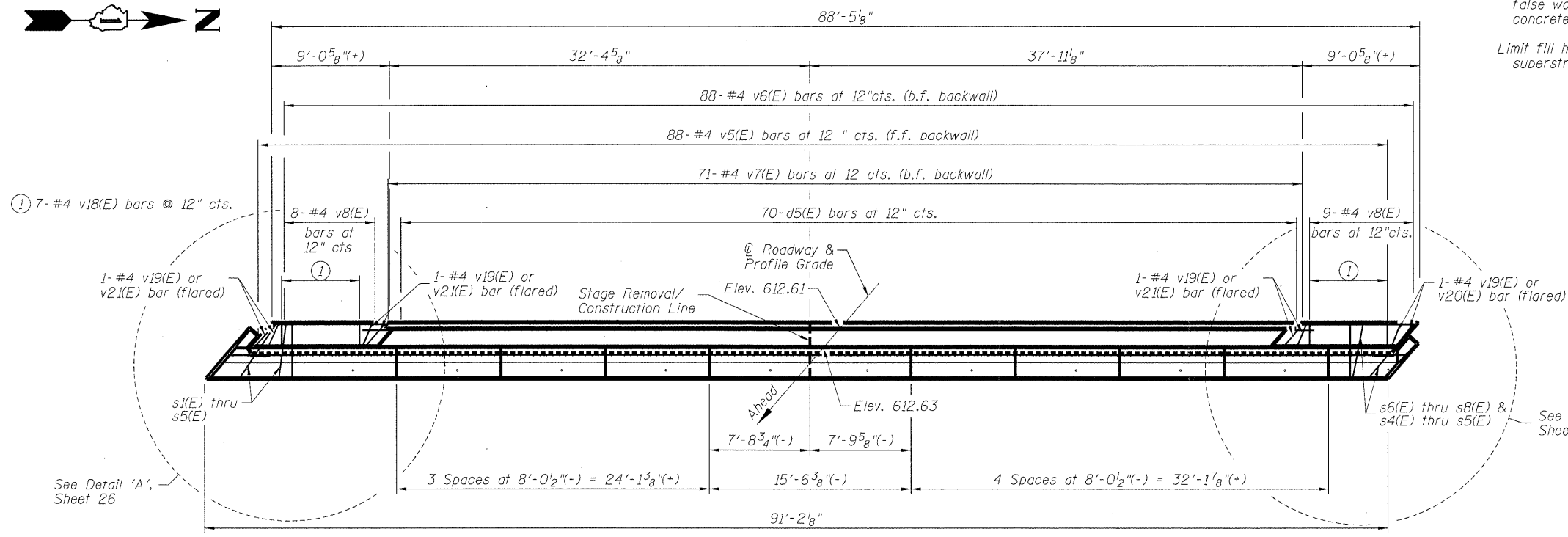

PLAN

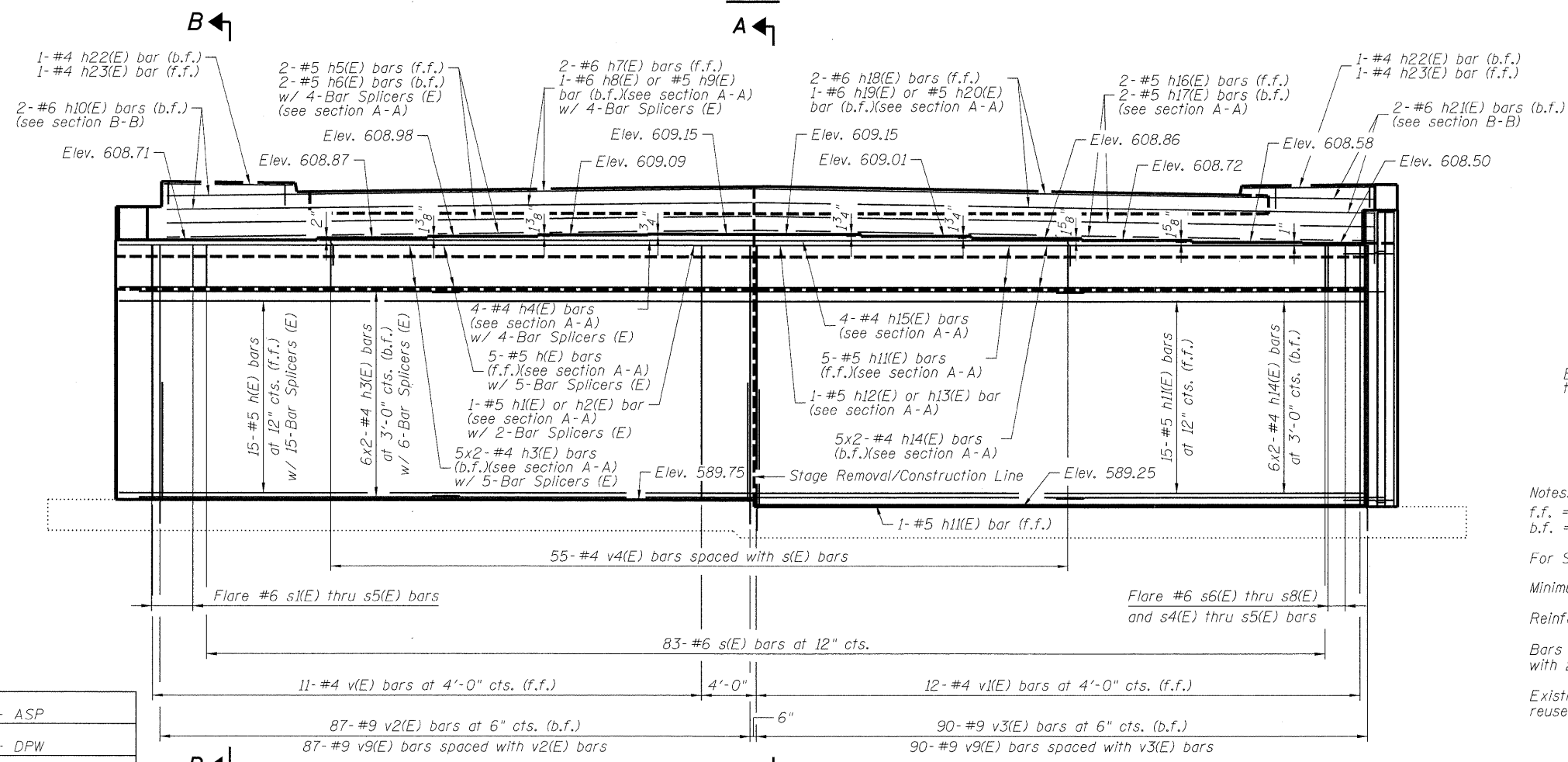

ELEVATION

(Looking Back)

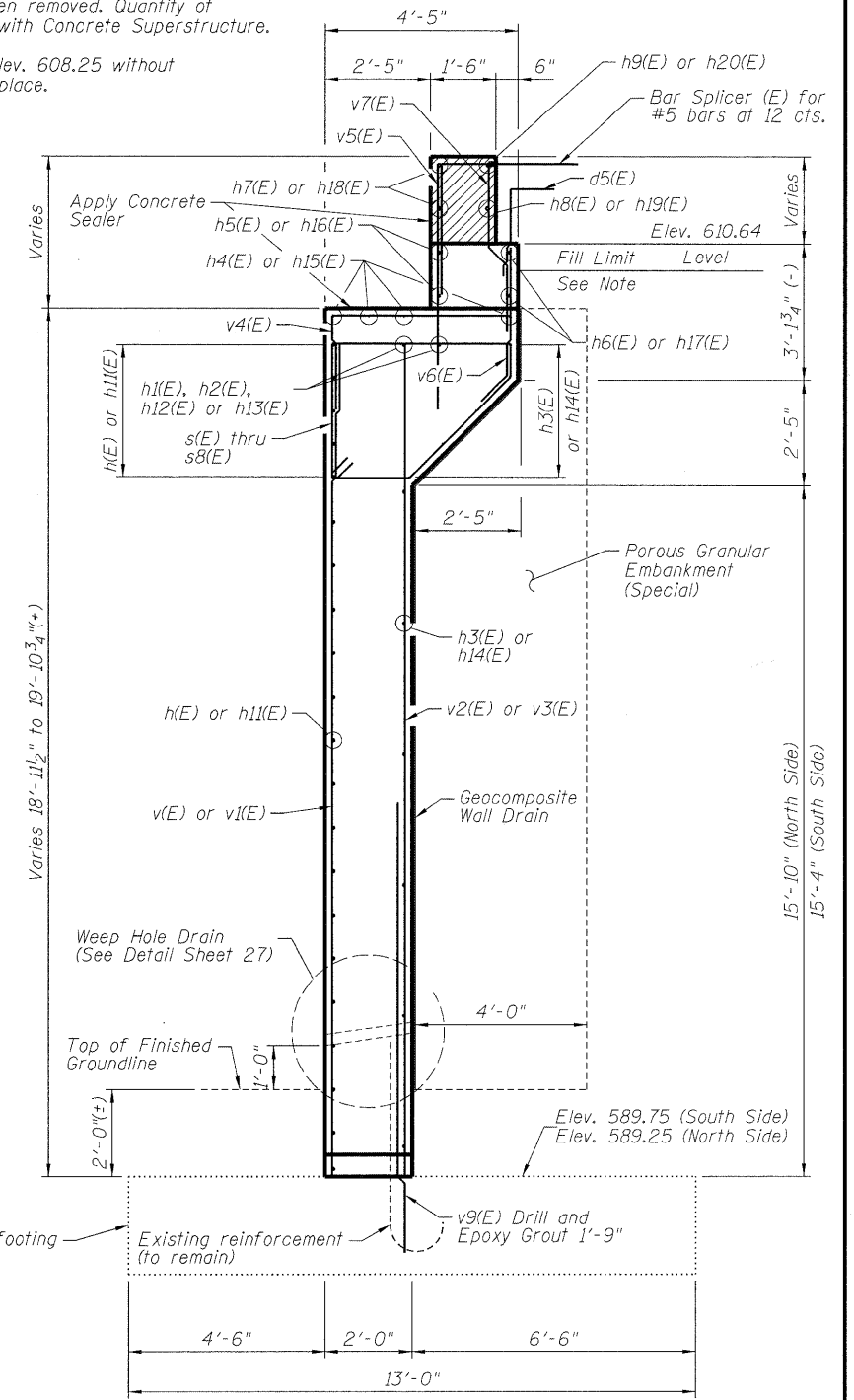

SECTION A-A

Notes:

f.f. = Front Face
b.f. = Back Face

For Section B-B, See sheet 26.

Minimum lap length for #4 bars -2'-0".

Reinforcement bars designated (E) shall be epoxy coated.

Bars indicated thus 6x2 #4 etc. indicated 6 lines of bars with 2 lengths per line.

Existing reinforcement that is to be reused shall be cleaned and straightened.

WEST ABUTMENT I
STRUCTURE NUMBER 016-0610

DESIGNED - ASP
CHECKED - DPW
DRAWN - BEM
CHECKED - ASP

SHEET NO. 25 OF 42 SHEETS	F.A. RTE. 94	SECTION 0101.8B	COUNTY COOK	TOTAL SHEETS 139	SHEET NO. 101
	CONTRACT NO. 60C18				
ILLINOIS FED. AID PROJECT					

DLZ 85 W. Algonquin Rd. Ste. 220
Arlington Heights IL 60005
DLZ Illinois, Inc. (847)-640-0840