

- EXISTING LEGEND**
- PAVEMENT REMOVAL
  - PAVED SHOULDER REMOVAL
  - DRIVEWAY PAVEMENT REMOVAL
  - HOT MIX ASPHALT SURFACE REMOVAL
  - TREE REMOVAL WITH UNIT DIAMETER TRUNK
  - LINEAL REMOVAL ITEM
  - CP-100 CONTROL POINT NUMBER

- NOTES:**
1. SEE ELECTRICAL PLANS FOR LIGHTING REMOVALS.
  2. SEE DRAINAGE PLANS FOR DRAINAGE REMOVALS.

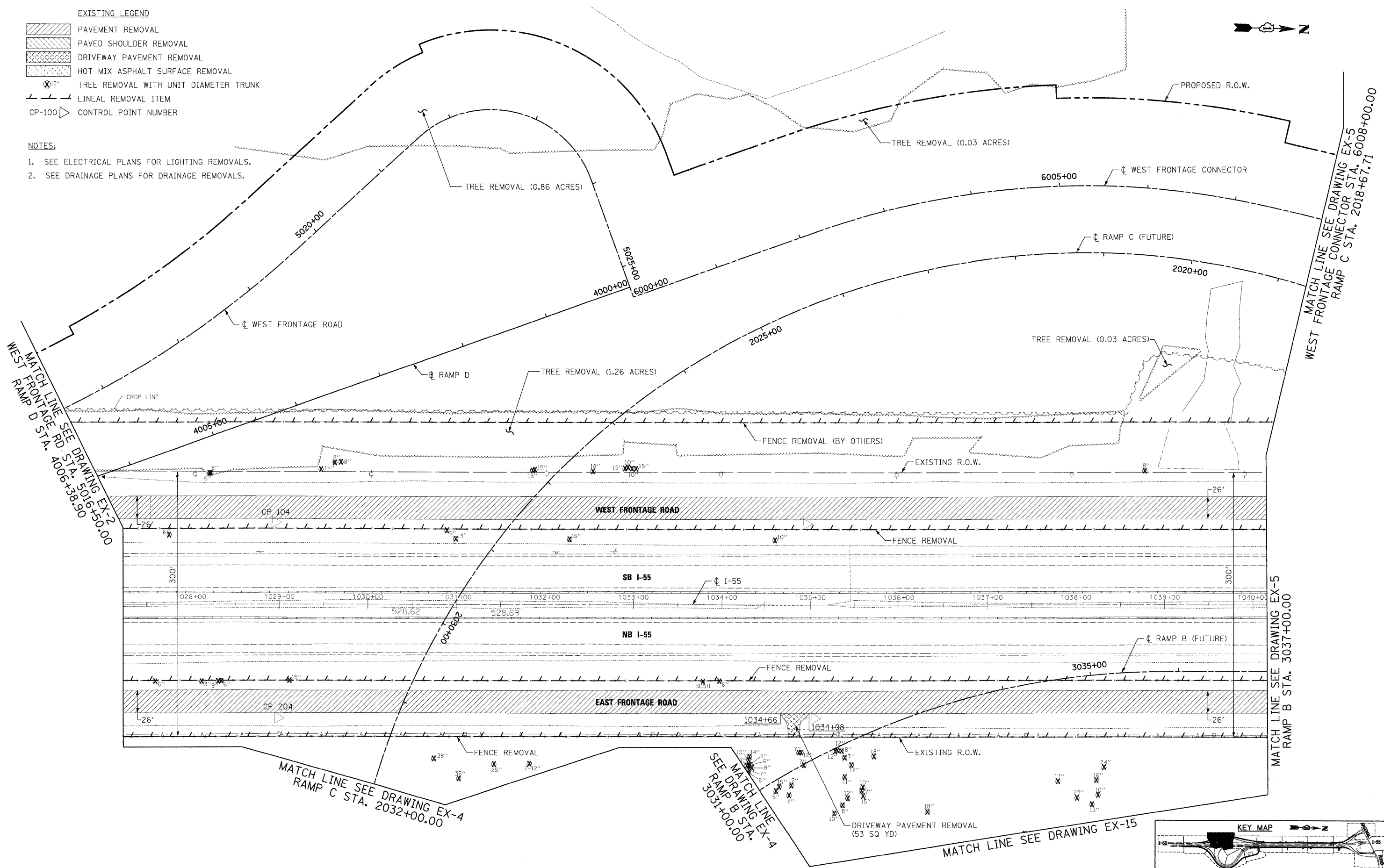

McDonough Associates Inc.  
 Engineers / Architects  
 130 East Randolph Street Chicago, Illinois 60601

FILE NAME = D168C31-5-T-REM03.dgn  
 USER NAME = TK1.jega  
 PLOT SCALE = 1:50  
 PLOT DATE = 12/11/2009

DESIGNED - JTF  
 DRAWN - JTF  
 CHECKED - DLT  
 DATE - 12/18/09

REVISED -  
 REVISED -  
 REVISED -  
 REVISED -

STATE OF ILLINOIS  
 DEPARTMENT OF TRANSPORTATION

EXISTING PLAN AND REMOVALS  
 SCALE: 1"=50' SHEET NO. 3 OF 15 SHEETS STA. TO STA.

F.A.I. RTE.	SECTION	COUNTY	TOTAL SHEETS	SHEET NO.
55	(99-1&2)AC-3	WILL	524	40
CONTRACT NO. 60C31				
FED. ROAD DIST. NO. 1 ILLINOIS FED. AID PROJECT				

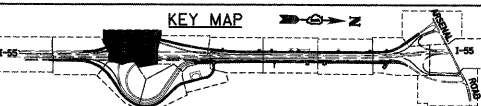

FINAL