

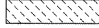





- EXISTING LEGEND
-  PAVEMENT REMOVAL
 -  PAVED SHOULDER REMOVAL
 -  DRIVEWAY PAVEMENT REMOVAL
 -  HOT MIX ASPHALT SURFACE REMOVAL
 -  TREE REMOVAL WITH UNIT DIAMETER TRUNK
 -  LINEAL REMOVAL ITEM
 - CP-100  CONTROL POINT NUMBER

- NOTES:
- SEE ELECTRICAL PLANS FOR LIGHTING REMOVALS.
 - SEE DRAINAGE PLANS FOR DRAINAGE REMOVALS.

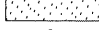

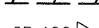
McDonough Associates Inc.
Engineers / Architects
130 East Randolph Street, Chicago, Illinois 60601

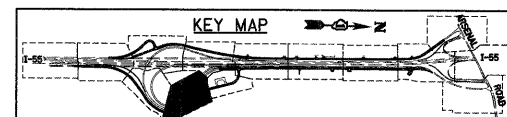
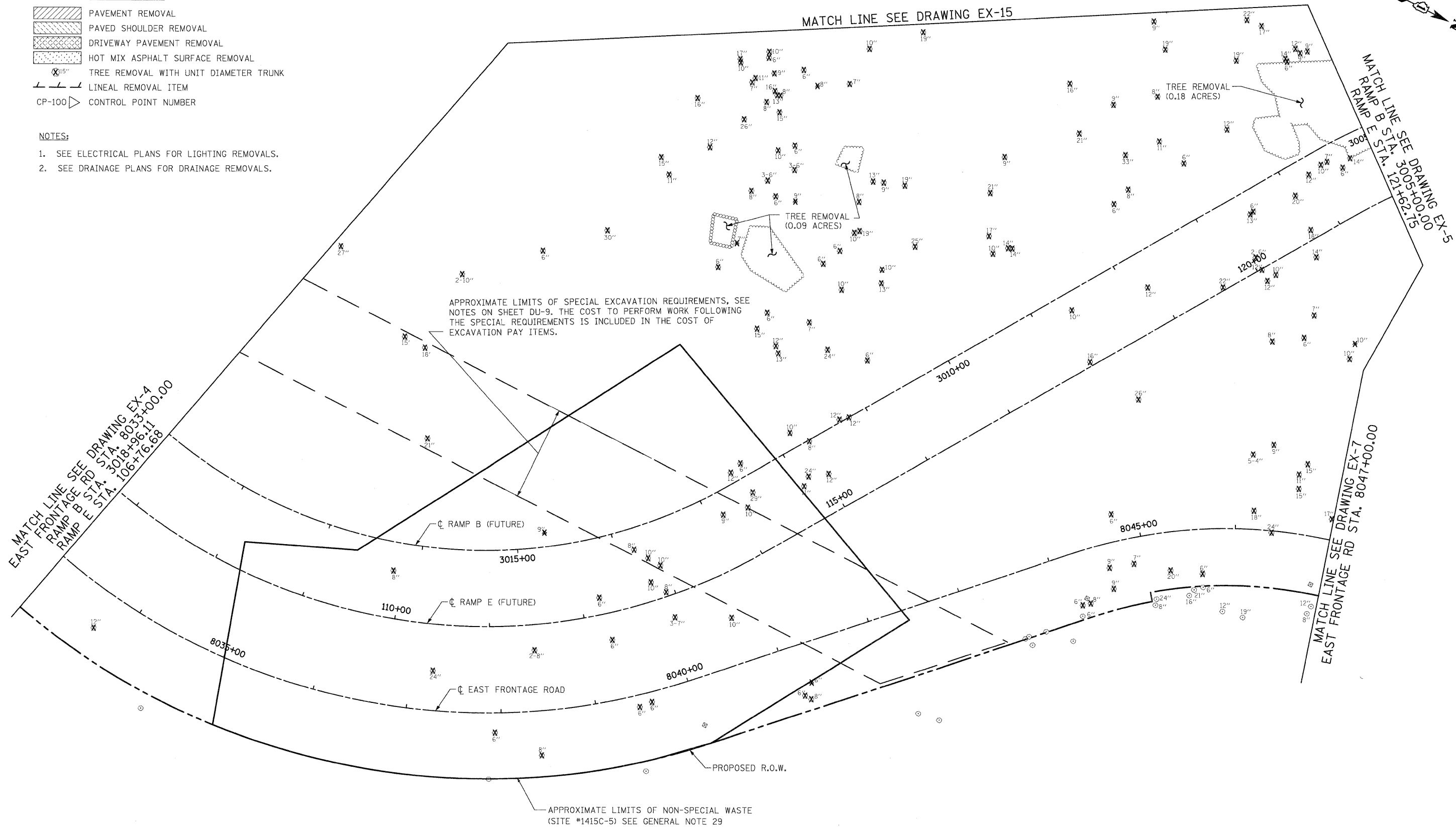
FILE NAME = D162C31-SHT-REM26.dgn	USER NAME = TKluegel	DESIGNED - JTF	REVISED -
		DRAWN - JTF	REVISED -
		CHECKED - DLT	REVISED -
		DATE - 12/18/09	REVISED -
PLOT SCALE = 1:50			
PLOT DATE = 12/11/2009			

STATE OF ILLINOIS
DEPARTMENT OF TRANSPORTATION

EXISTING PLAN AND REMOVALS

SCALE: 1"=50' SHEET NO. 6 OF 15 SHEETS STA. TO STA.

F.A.I. RTE.	SECTION	COUNTY	TOTAL SHEETS	SHEET NO.
55	(99-1&2)AC-3	WILL	524	43
CONTRACT NO. 60C31				
FED. ROAD DIST. NO. 1 ILLINOIS FED. AID PROJECT				

FINAL