

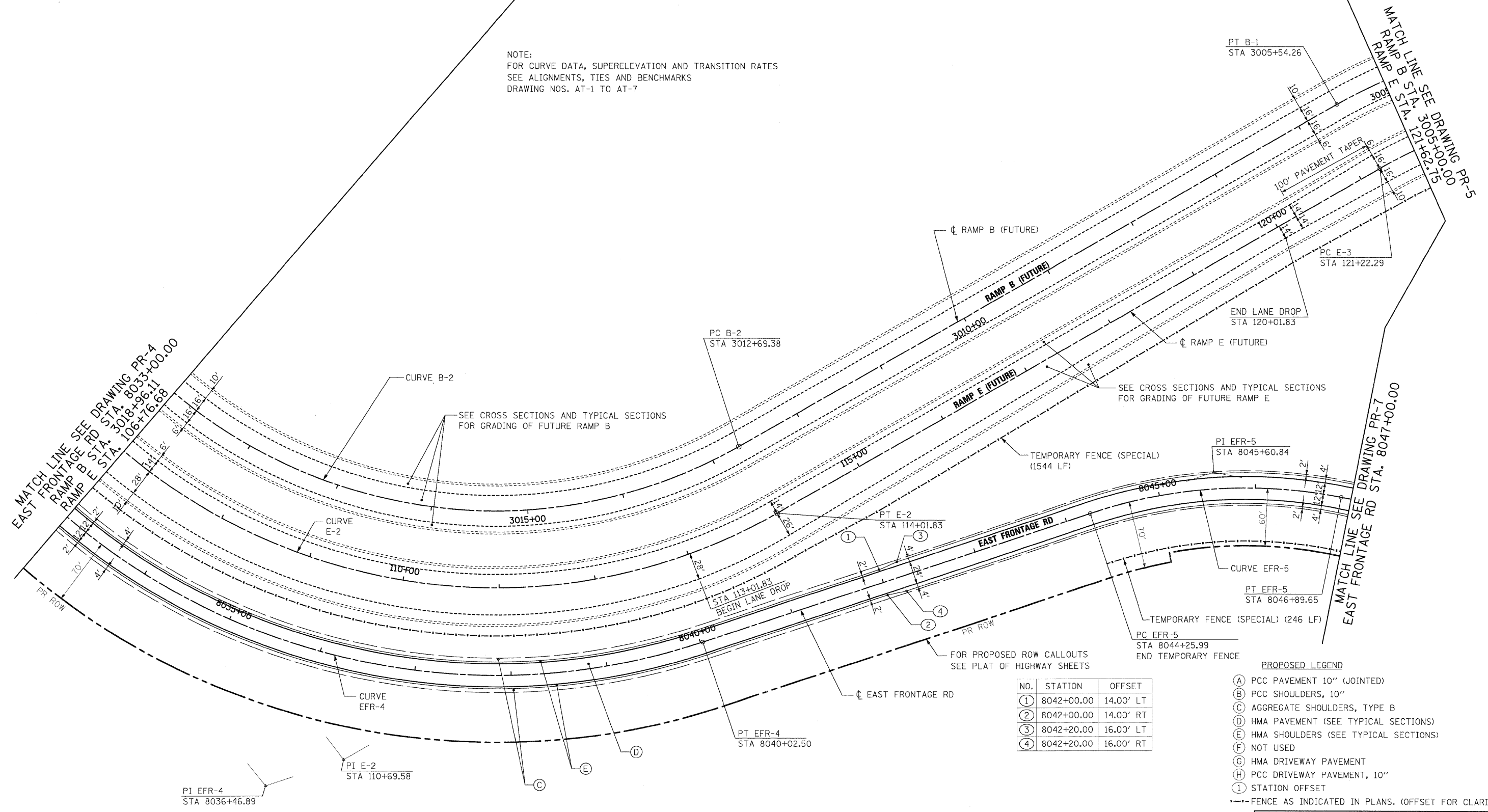

MATCH LINE SEE DRAWING PR-15

NOTE:  
FOR CURVE DATA, SUPERELEVATION AND TRANSITION RATES  
SEE ALIGNMENTS, TIES AND BENCHMARKS  
DRAWING NOS. AT-1 TO AT-7



NO.	STATION	OFFSET
1	8042+00.00	14.00' LT
2	8042+00.00	14.00' RT
3	8042+20.00	16.00' LT
4	8042+20.00	16.00' RT

- PROPOSED LEGEND**
- (A) PCC PAVEMENT 10" (JOINTED)
  - (B) PCC SHOULDERS, 10"
  - (C) AGGREGATE SHOULDERS, TYPE B
  - (D) HMA PAVEMENT (SEE TYPICAL SECTIONS)
  - (E) HMA SHOULDERS (SEE TYPICAL SECTIONS)
  - (F) NOT USED
  - (G) HMA DRIVEWAY PAVEMENT
  - (H) PCC DRIVEWAY PAVEMENT, 10"
  - (I) STATION OFFSET
- FENCE AS INDICATED IN PLANS. (OFFSET FOR CLARITY)

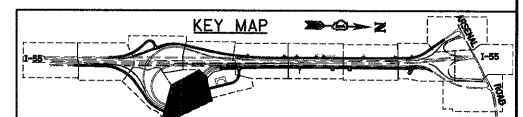

McDonough Associates Inc.  
Engineers / Architects  
130 East Randolph Street, Chicago, Illinois 60601

FILE NAME = D160C31-SHT-PLAN06.dgn  
PLOT SCALE = 1:50  
PLOT DATE = 12/11/2009

USER NAME = TKluegel	DESIGNED - JTF	REVISED -
	DRAWN - JTF	REVISED -
	CHECKED - DLT	REVISED -
	DATE - 12/18/09	REVISED -

STATE OF ILLINOIS  
DEPARTMENT OF TRANSPORTATION

PROPOSED PLAN

SCALE: 1"=50' SHEET NO. 6 OF 15 SHEETS STA. TO STA.

F.A.I. RTE.	SECTION	COUNTY	TOTAL SHEETS	SHEET NO.
55	(99-1&2)AC-3	WILL	524	58
CONTRACT NO. 60C31				

FED. ROAD DIST. NO. 1 ILLINOIS FED. AID PROJECT

FINAL