

**EJM ENGINEERING, INC.**  
 411 South Wells Street Suite 800  
 Chicago, Illinois 60607



**MAINTENANCE OF TRAFFIC LEGEND**

- WORK ZONE (CURRENT STAGE)
- WORK ZONE (CONTD. FROM PREVIOUS STAGE)
- DIRECTION OF TRAFFIC
- TYPE II BARRICADES (DRUMS), SPACING AS SHOWN
- TEMPORARY PAVEMENT (INSTALLED IN CURRENT STAGE)
- TEMPORARY PAVEMENT (INSTALLED IN PREVIOUS STAGE)

**NOTE:**  
 AT THE COMPLETION OF STAGE 1, PRIOR TO STAGE 1A, INSTALL WET REFLECTIVE TEMP TAPE TYPE III PAVEMENT MARKINGS PER FINAL MARKING PLAN AT W FRONTAGE RD FROM STA. 5013+83 TO STA. 5025+37, AT RAMP D FROM STA. 4000+00 TO STA. 4006+91, AND AT W FRONTAGE CONNECTOR FROM STA. 6000+00 TO STA. 6019+57.

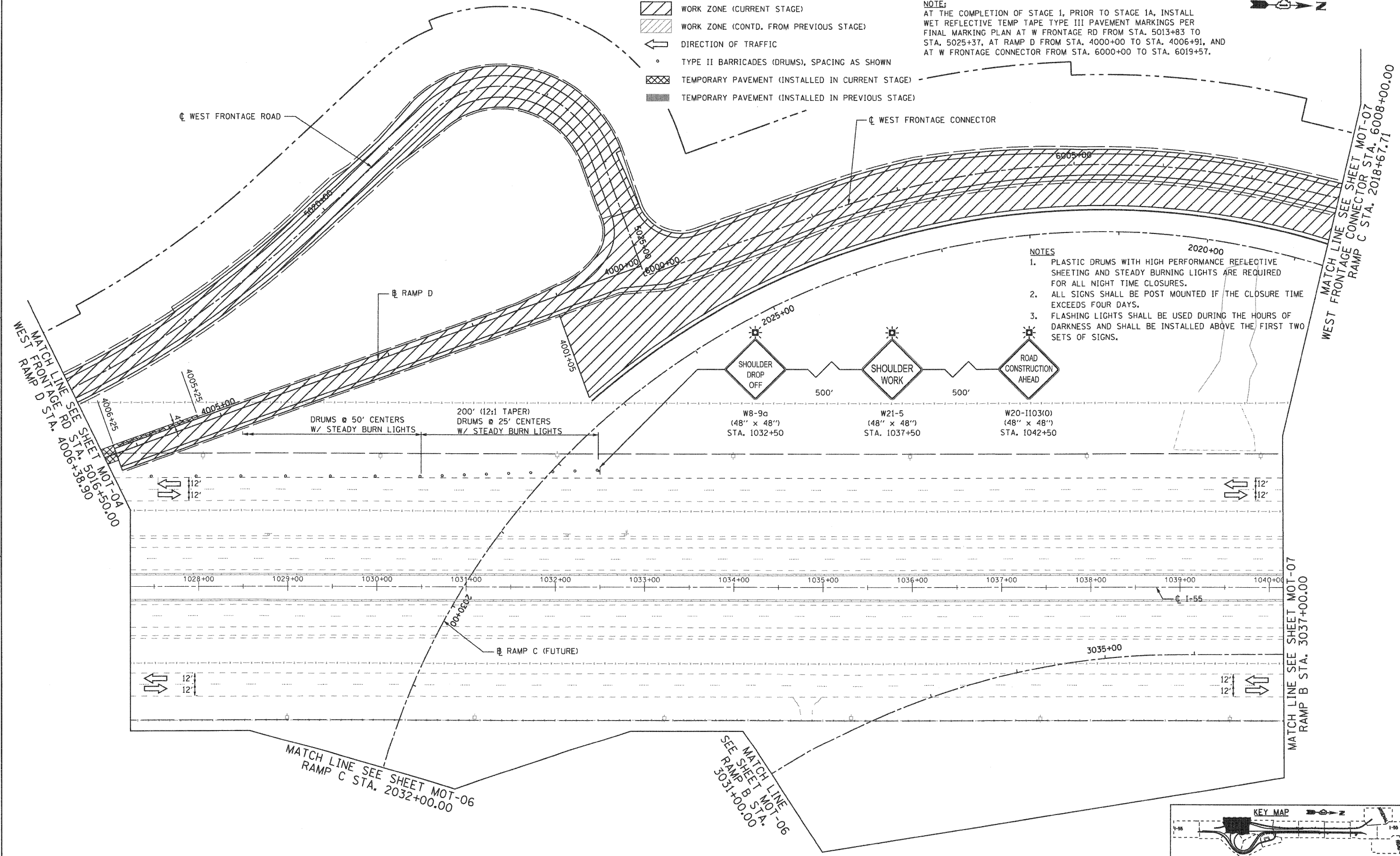

**NOTES**

1. PLASTIC DRUMS WITH HIGH PERFORMANCE REFLECTIVE SHEETING AND STEADY BURNING LIGHTS ARE REQUIRED FOR ALL NIGHT TIME CLOSURES.
2. ALL SIGNS SHALL BE POST MOUNTED IF THE CLOSURE TIME EXCEEDS FOUR DAYS.
3. FLASHING LIGHTS SHALL BE USED DURING THE HOURS OF DARKNESS AND SHALL BE INSTALLED ABOVE THE FIRST TWO SETS OF SIGNS.

SEE MATCH LINE  
 RAMP B STA. 3051+00.00

MATCH LINE SEE SHEET MOT-06  
 RAMP C STA. 2032+00.00

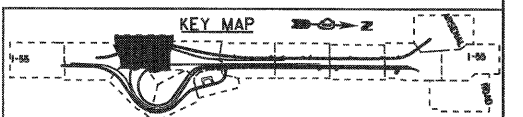

FILE NAME = ...ND160C31-SHT-STAGING103.dgn	USER NAME = gmat	DESIGNED - GR	REVISED -
		DRAWN - GR	REVISED -
		CHECKED - RY	REVISED -
		DATE - 12/18/2009	REVISED -
PLOT SCALE = 1:58			
PLOT DATE = 12/16/2009			

**STATE OF ILLINOIS  
 DEPARTMENT OF TRANSPORTATION**

**MAINTENANCE OF TRAFFIC  
 STAGE 1**

SCALE: 1"=50' SHEET NO. 3 OF 12 SHEETS STA. TO STA.

F.A.I. RTE.	SECTION	COUNTY	TOTAL SHEETS	SHEET NO.
55	(99-1&2)-3	WILL	524	91
CONTRACT NO. 60C31				
FED. ROAD DIST. NO. 1 (ILLINOIS) FED. AID PROJECT				

**FINAL**