

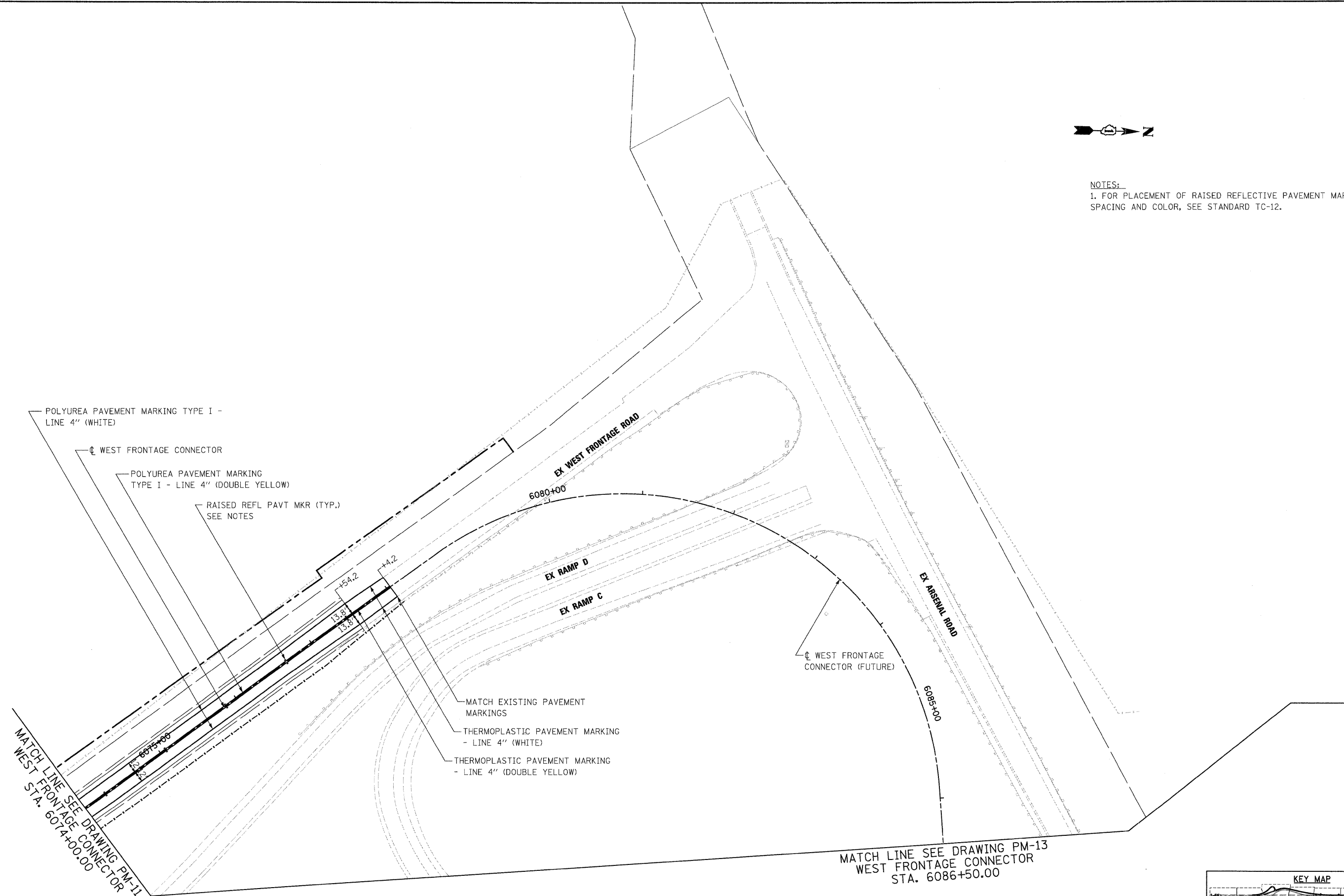

NOTES:
 1. FOR PLACEMENT OF RAISED REFLECTIVE PAVEMENT MARKERS, SPACING AND COLOR, SEE STANDARD TC-12.



McDonough Associates Inc.
 Engineers / Architects
 130 East Randolph Street, Chicago, Illinois 60601

FILE NAME = D168C31-SHT-PMK12.dgn	USER NAME = TKluegel	DESIGNED - MJT	REVISED -
PLOT SCALE - 1"=50'	CHECKED - DLT	DATE - 12/18/09	REVISED -
PLOT DATE = 12/11/2009			

STATE OF ILLINOIS
 DEPARTMENT OF TRANSPORTATION

PAVEMENT MARKING PLAN

SCALE: 1"=50' SHEET NO. 12 OF 15 SHEETS STA. TO STA.

F.A.I. RTE.	SECTION	COUNTY	TOTAL SHEETS	SHEET NO.
55	(99-1&2)AC-3	WILL	524	261
CONTRACT NO. 60C31				
FED. ROAD DIST. NO. 1 ILLINOIS FED. AID PROJECT				

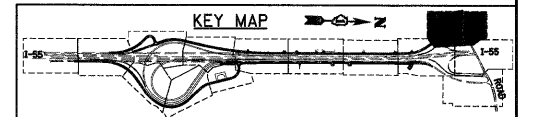

FINAL