

SIGNING NOTES:

1. REMOVE SIGN PANEL, TYPE 1.
2. REMOVE GROUND MOUNTED SIGN SUPPORT.

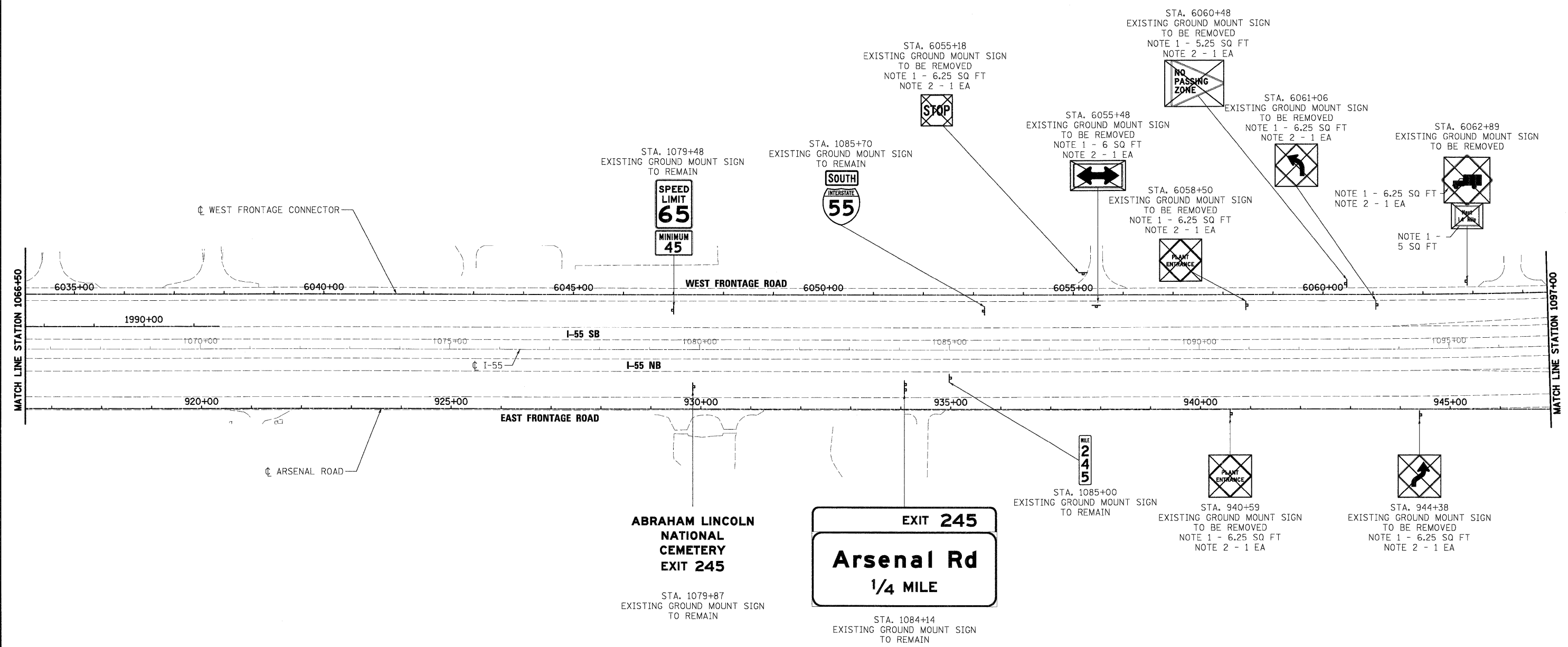

McDonough Associates Inc.
 Engineers / Architects
 130 East Randolph Street, Chicago, Illinois 60601

FILE NAME = D:\60C31-SHT-S\GN03.dgn	USER NAME = TKluegl	DESIGNED - ---	REVISED - ---
PLOT SCALE = 1:100	CHECKED - ---	REVISED - ---	REVISED - ---
PLOT DATE = 12/11/2009	DATE = 12/18/09	REVISED - ---	REVISED - ---

**STATE OF ILLINOIS
DEPARTMENT OF TRANSPORTATION**

EXISTING SIGNING PLAN

SCALE: 1"=100' SHEET NO. 3 OF 8 SHEETS STA. TO STA.

F.A.I. RTE.	SECTION	COUNTY	TOTAL SHEETS	SHEET NO.
55	(99-1&2)AC-3	WILL	524	282
FED. ROAD DIST. NO. 1 ILLINOIS FED. AID PROJECT			CONTRACT NO. 60C31	

FINAL