

IL 58 (GOLF RD.)  
Sta. 9+60 to Sta. 15+00  
PROPOSED WIDENING  
STAGE 1

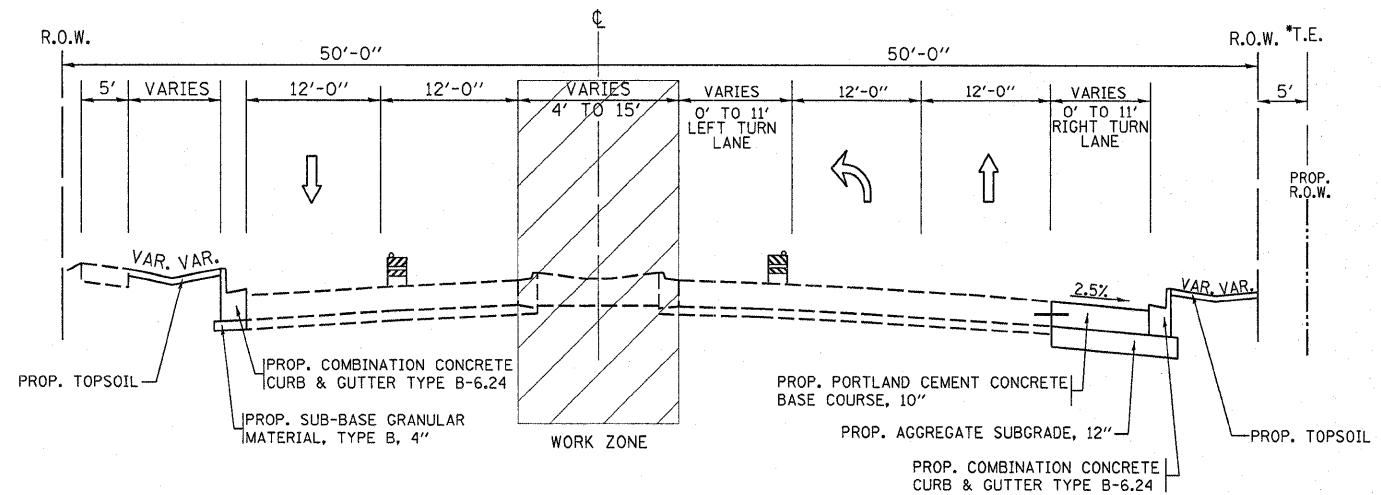

IL 58 (GOLF RD.)  
Sta. 9+60 to Sta. 15+00  
PROPOSED WIDENING  
STAGE 3

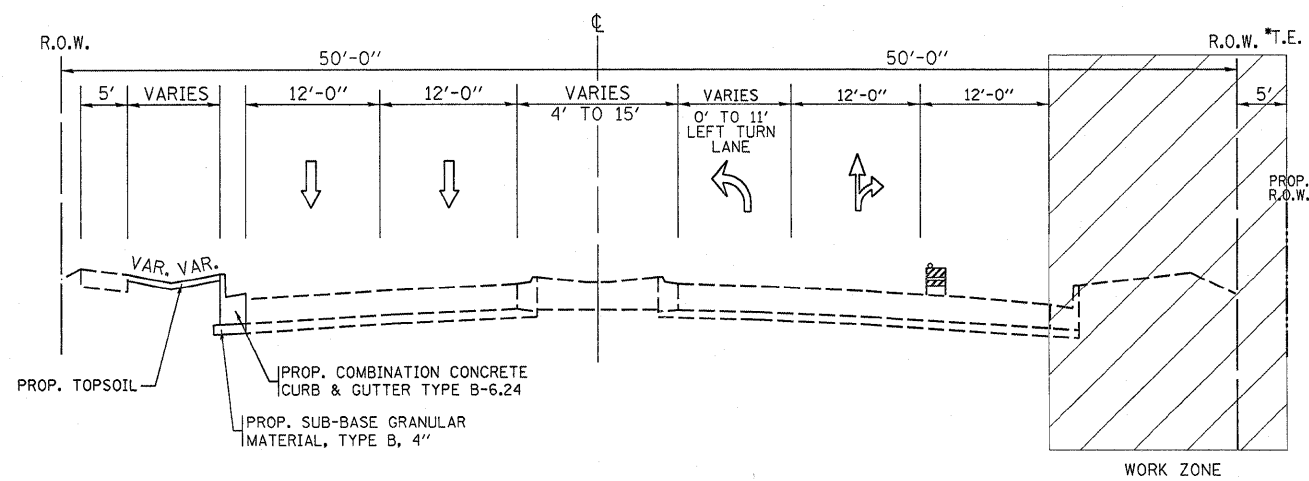

IL 58 (GOLF RD.)  
Sta. 9+60 to Sta. 15+00  
PROPOSED WIDENING  
STAGE 2

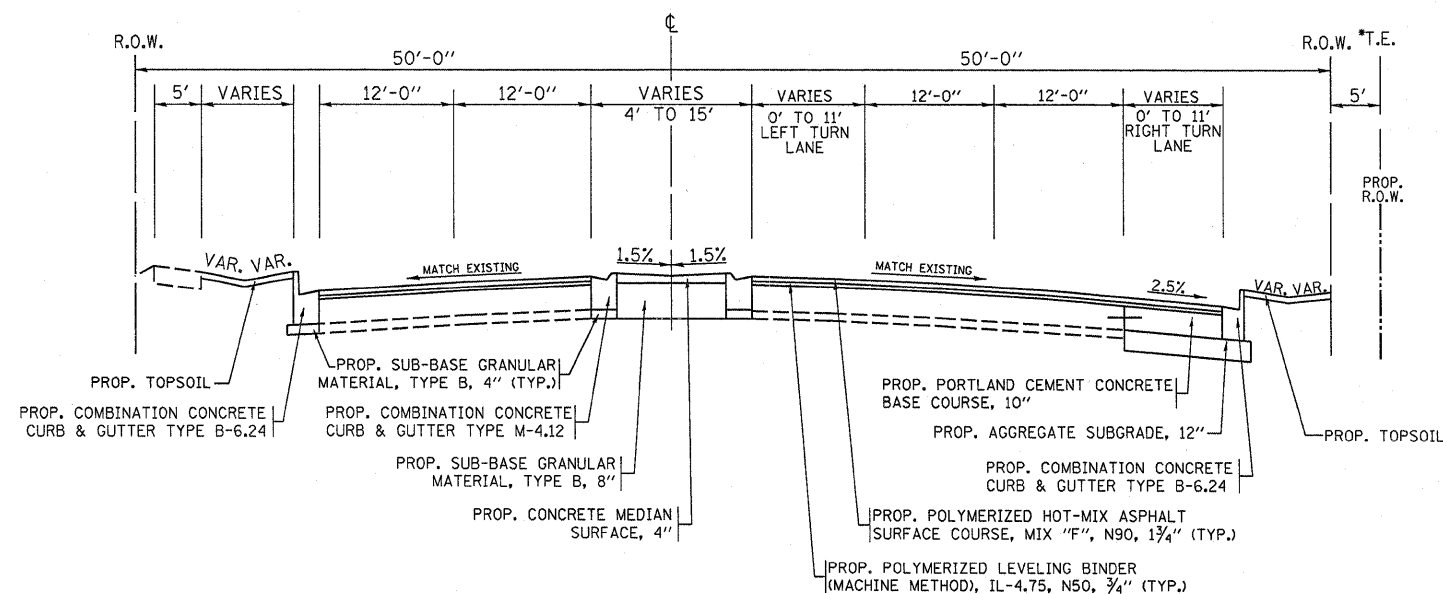

IL 58 (GOLF RD.)  
Sta. 9+60 to Sta. 15+00  
PROPOSED RESURFACING  
STAGE 4

|  |                    |            |           |
|--|--------------------|------------|-----------|
| FILE NAME =  | USER NAME = miduja | DESIGNED - | REVISED - |
| ca:\pw\work\PWIDOT\MIDYJA\dms93788\PI26784-Design3.dgn |                    | DRAWN -    | REVISED - |
|  |                    | CHECKED -  | REVISED - |
|  |                    | DATE -     | REVISED - |
|  |                    |            |           |

STATE OF ILLINOIS  
DEPARTMENT OF TRANSPORTATION

SUGGESTED STAGING AND TRAFFIC CONTROL  
(IL ROUTE 58)

SCALE: SHEET NO. OF SHEETS STA. TO STA.

| F.A.P. RTE.               | SECTION   | COUNTY | TOTAL SHEETS | SHEET NO. |
|---------------------------|-----------|--------|--------------|-----------|
| 339                       | 584 Y-N-1 | COOK   | 61           | 15        |
| CONTRACT NO. 60D25        |           |        |              |           |
| ILLINOIS FED. AID PROJECT |           |        |              |           |