

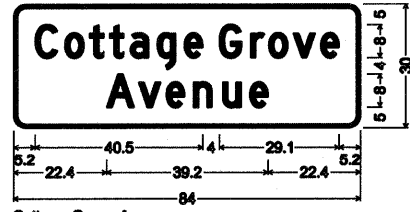

LEGEND:

- ① POLYUREA PAVEMENT MARKING, TYPE II - LINE 4"
- ② PREFORMED PLASTIC PAVEMENT MARKING, TYPE B - LINE 5"
- ③ THERMOPLASTIC PAVEMENT MARKING LINE 4"
- ④ THERMOPLASTIC PAVEMENT MARKING LINE 8"
- ⑤ THERMOPLASTIC PAVEMENT MARKING LINE 12"
- ← DIRECTION OF TRAVEL

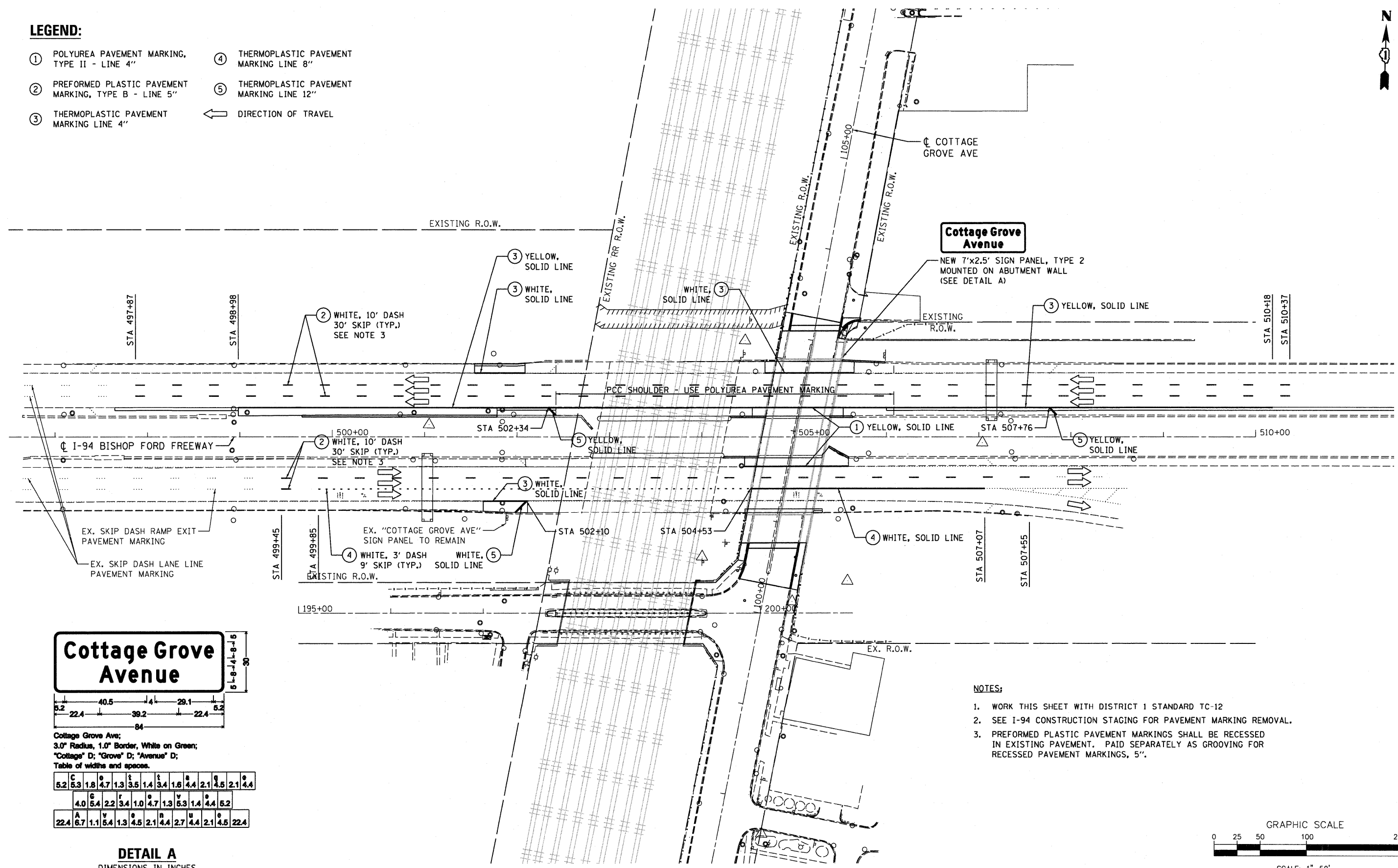

Cottage Grove Ave;
 3.0" Radius, 1.0" Border, White on Green;
 "Cottage" D; "Grove" D; "Avenue" D;
 Table of widths and spaces.

C	o	t	t	a	g	e	g	r	o	v	e	a	v	e	
5.2	5.3	1.8	4.7	1.3	3.5	1.4	3.4	1.6	4.4	2.1	4.5	2.1	4.4		
	C	o	t	t	a	g	e	r	o	v	e	a	v	e	
	4.0	5.4	2.2	3.4	1.0	4.7	1.3	5.3	1.4	4.4	5.2				
	A	v	e	n	u	e									
	22.4	6.7	1.1	5.4	1.3	4.5	2.1	4.4	2.7	4.4	2.1	4.5	22.4		

DETAIL A
 DIMENSIONS IN INCHES

NOTES:

1. WORK THIS SHEET WITH DISTRICT 1 STANDARD TC-12
2. SEE I-94 CONSTRUCTION STAGING FOR PAVEMENT MARKING REMOVAL.
3. PREFORMED PLASTIC PAVEMENT MARKINGS SHALL BE RECESSED IN EXISTING PAVEMENT. PAID SEPARATELY AS GROOVING FOR RECESSED PAVEMENT MARKINGS, 5".

