

CONSTRUCTION NOTES:

① THE CONTRACTOR SHALL DISCONNECT AND REMOVE EACH UNINTERRUPTIBLE POWER SUPPLY (UPS) CABINET AND ALL ASSOCIATED ITEMS NEEDED TO REINSTALL TO EACH NEW CONTROLLER CABINET. THE COST TO REINSTALL EACH OF THE UPS CABINETS WILL BE INCLUDED IN THE COST OF THE NEW CONTROLLER AND CABINET.

② THE CONTRACTOR SHALL REMOVE AND RELOCATE ALL THE EXISTING EMERGENCY VEHICLE PRIORITY SYSTEM PHASING UNITS FROM EACH OF THE EXISTING CONTROLLER CABINETS AND REINSTALL TO EACH OF THE NEW CABINETS. THE COST WILL BE INCLUDED IN THE COST OF THE NEW CONTROLLERS AND CABINETS.

THE CONTRACTOR SHALL INSTALL THE NEW SERVICE CABINET AND CONNECT TO THE EXISTING CONDUIT WITH A 1 1/2" REDUCER COUPLING. THE NEW SERVICE CABLE WILL THEN BE INSTALL AND THE EXISTING SERVICE CABLE REMOVED.

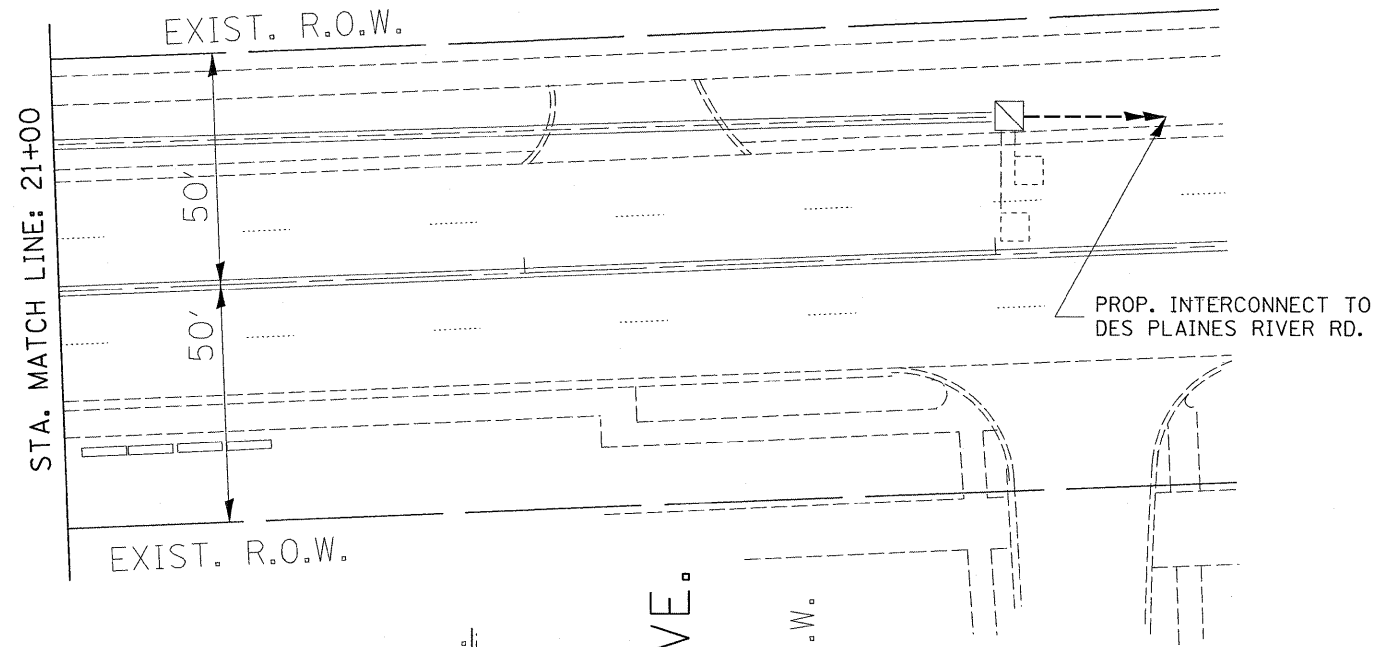

Michigan Ave.

LAWRENCE AVE.

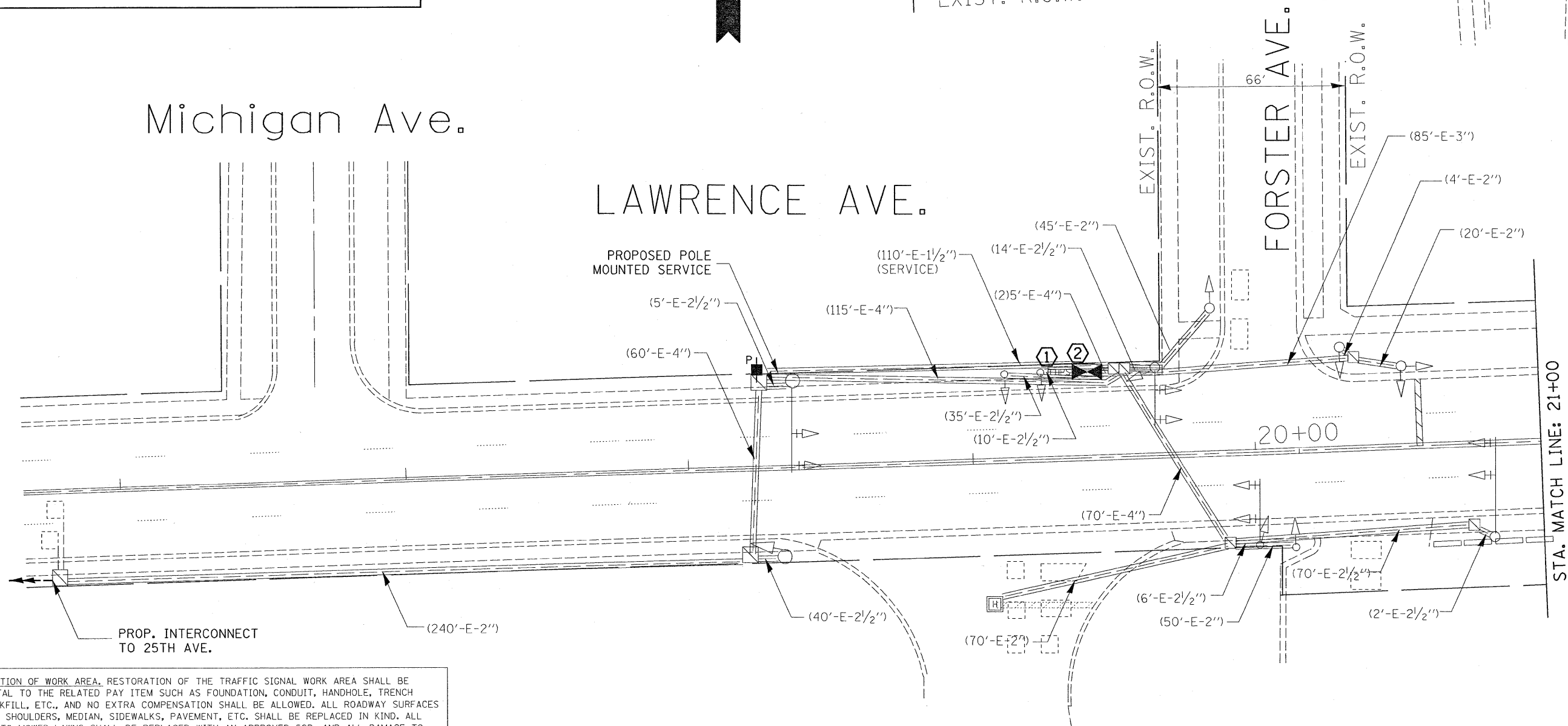

RESTORATION OF WORK AREA. RESTORATION OF THE TRAFFIC SIGNAL WORK AREA SHALL BE INCIDENTAL TO THE RELATED PAY ITEM SUCH AS FOUNDATION, CONDUIT, HANDHOLE, TRENCH AND BACKFILL, ETC., AND NO EXTRA COMPENSATION SHALL BE ALLOWED. ALL ROADWAY SURFACES SUCH AS SHOULDERS, MEDIAN, SIDEWALKS, PAVEMENT, ETC. SHALL BE REPLACED IN KIND. ALL DAMAGE TO MOWED LAWNS SHALL BE REPLACED WITH AN APPROVED SOD, AND ALL DAMAGE TO UNMOWED FIELDS SHALL BE SEEDED IN ACCORDANCE WITH STANDARD SPECIFICATIONS 252 AND 250 RESPECTIVELY.

FILE NAME =	USER NAME = kenthaphixajba	DESIGNED -	REVISED -	STATE OF ILLINOIS DEPARTMENT OF TRANSPORTATION	TRAFFIC SIGNAL MODIFICATION PLAN LAWRENCE AVE AT FORSTER AVE.	F.A. RTE.	SECTION	COUNTY	TOTAL SHEETS	SHEET NO.	
c:\pwwork\pwwork\kenthaphixajba\d011261\tr of fic . legend . v8 . dgn	PLOT SCALE = 20.0000 ' / IN.	DRAWN -	REVISED -			1362	2009 102 N	COOK	17	11	
PLOT DATE = 6/25/2010	DATE -	CHECKED -	REVISED -			CONTRACT NO. 60165					
		DATE -	REVISED -			ILLINOIS FED. AID PROJECT					
					SCALE:	SHEET NO.	OF	SHEETS	STA.	TO STA.	