

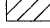

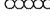
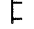

LEGEND

-  WORK AREA
-  IMPACT ATTENUATORS, TEMPORARY (FULLY REDIRECTIVE, NARROW), TEST LEVEL 3
-  TYPE III BARRICADE
-  TYPE I OR II BARRICADE
-  TEMPORARY CONCRETE BARRIER
-  DRUM WITH STEADY BURN MONODIRECTIONAL LIGHT (PER HWY. STD. 701606)
-  DIRECTION INDICATOR BARRICADE WITH STEADY BURN MONODIRECTIONAL LIGHT (PER HWY. STD. 701606)
-  SIGN

IL RTE 62 (ALGONQUIN RD)
S.N. 016-0581
(LOOKING EAST)

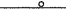

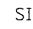
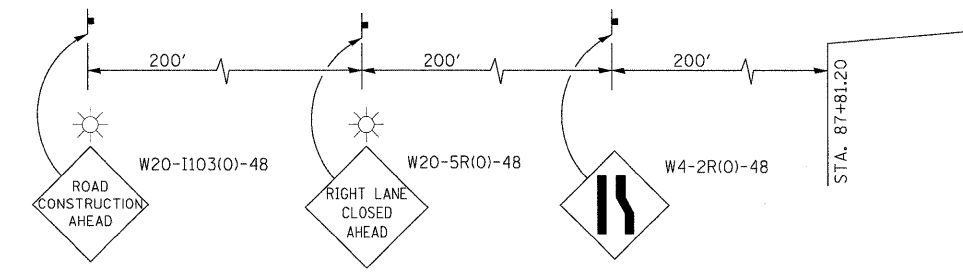
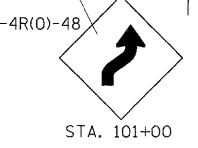
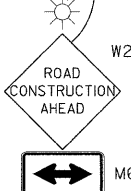
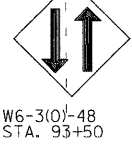
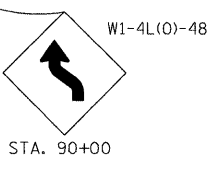
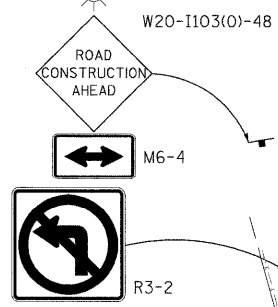
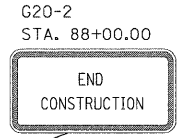
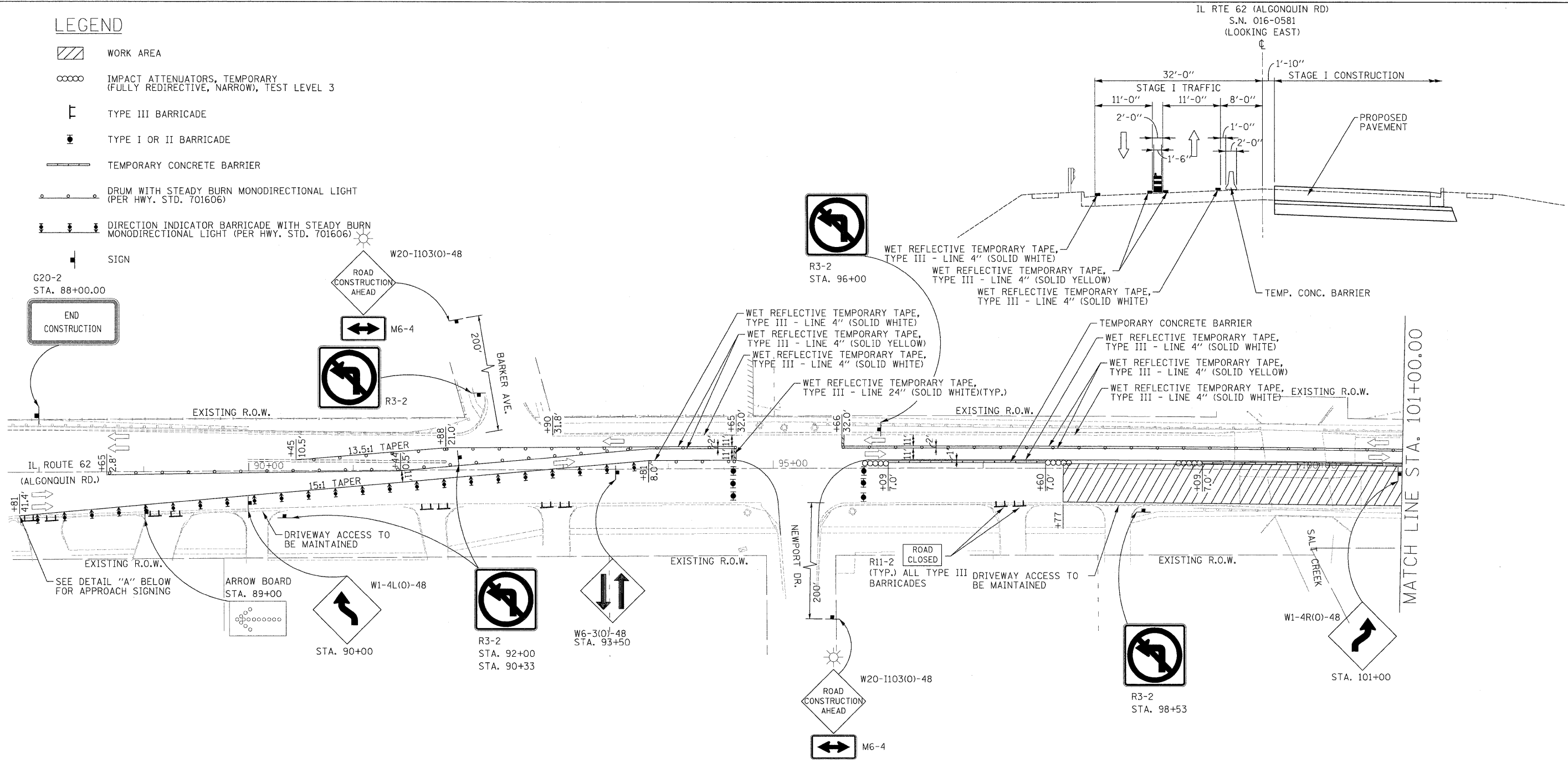
- STAGE I CONSTRUCTION:**
- REMOVE CONFLICTING EXISTING PAVEMENT MARKING LINES, REFLECTORS AND SIGNS UNDER HIGHWAY STANDARD 701306.
 - SHIFT TRAFFIC TO EXISTING WB LANES, PROVIDING ONE 11' LANE IN EACH DIRECTION UNDER HIGHWAY STANDARD 701606 AND AS SHOWN IN THE PLANS.
 - UPON COMPLETION OF CONSTRUCTION AND REMOVAL OF TRAFFIC CONTROL, PROVIDE PROPOSED PAVEMENT MARKINGS AND MARKERS TO REVERT TO EXISTING MARKINGS CONFIGURATION, AND AS SHOWN ON THE PROPOSED PAVEMENT MARKING PLAN.

- NOTES:**
- ACCESS TO BE MAINTAINED TO DRIVEWAYS SHOWN IN THE PLANS.

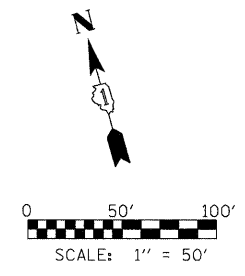

FILE NAME = #FILE#	USER NAME = #USER#	DESIGNED - SEW	REVISED -	STATE OF ILLINOIS DEPARTMENT OF TRANSPORTATION	MAINTENANCE OF TRAFFIC PLAN - STAGE 1 IL ROUTE 62 (ALGONQUIN ROAD) OVER SALT CREEK			F.A.P. RTE. 339	SECTION 116-Y-2-BR-1	COUNTY COOK	TOTAL SHEETS 74	SHEET NO. 16
PLOT SCALE = #SCALE#	CHECKED - FML	REVISED -	REVISED -		SCALE: 1" = 50'	SHEET NO. 1 OF 2 SHEETS	STA. 88+00.00 TO STA. 101+00.00	CONTRACT NO. 60J00				
PLOT DATE = #DATE#	DATE - 2/2010	REVISED -	REVISED -		FED. ROAD DIST. NO. ILLINOIS FED. AID PROJECT							