

FINAL SURVEY NO.	SURVEYED	BY	DATE
	PLOTTED		
	TEMPLATE		
	AREAS CHECKED		

ORIGINAL SURVEY NO.	SURVEYED	BY	DATE
	PLOTTED		
	TEMPLATE		
	AREAS CHECKED		

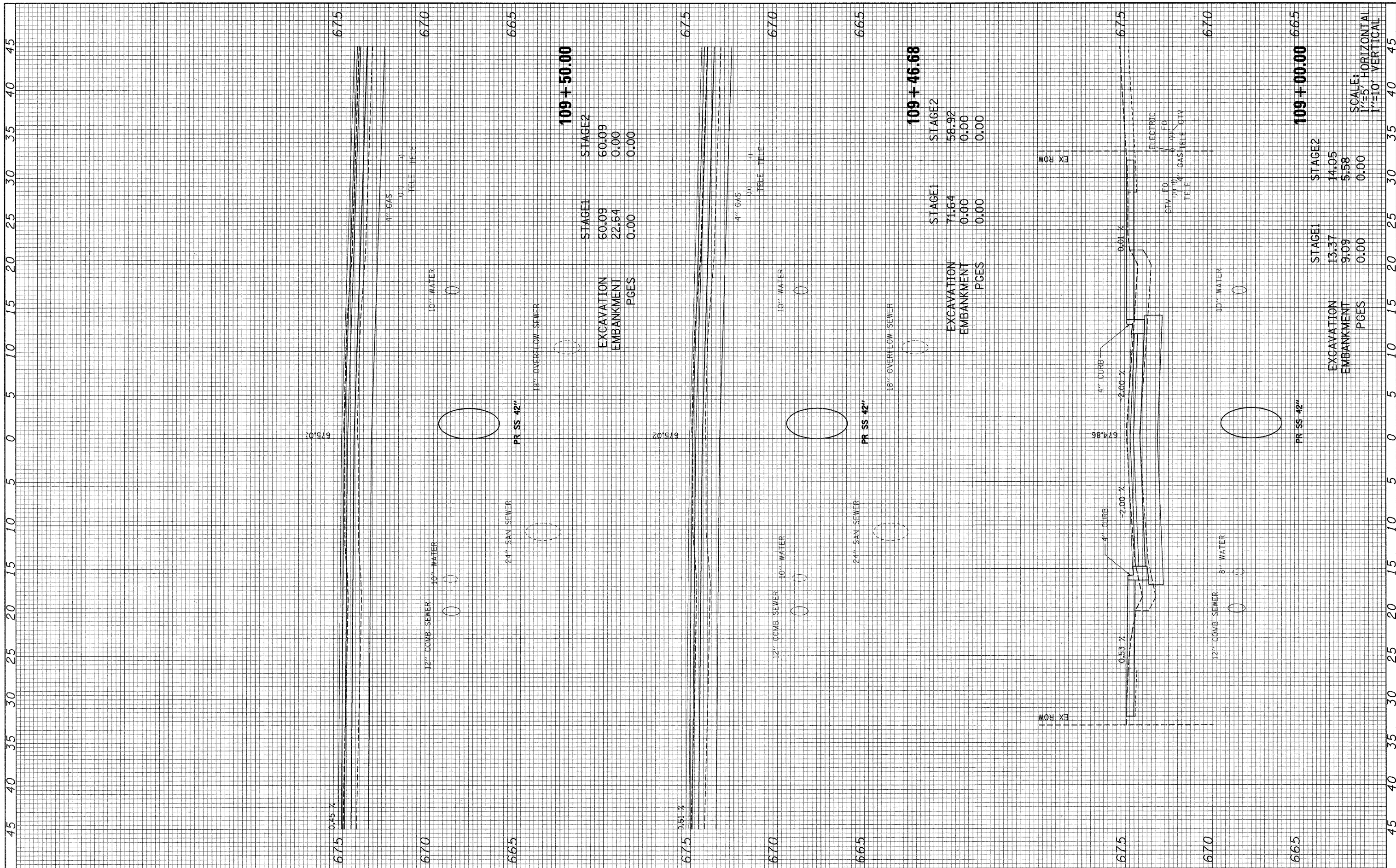

FILE NAME = 092-160_villa_xs.dgn	USER NAME = #USER#	DESIGNED -	REVISED -	STATE OF ILLINOIS DEPARTMENT OF TRANSPORTATION	S. VILLA AVE - CROSS SECTION		F.A. U. RTE. 2652	SECTION 00-00070-00-PV	COUNTY DuPAGE	TOTAL SHEETS 160	SHEET NO. 151	
PLOT SCALE = 1/4" = 1'	PLOT DATE = 6/15/2010	DRAWN -	REVISED -		SCALE: AS NOTED	SHEET NO. 60 OF 69 SHEETS	STA. 109+00.00 TO STA. 109+50.00	CONTRACT NO. 63379				
		CHECKED -	REVISED -		ILLINOIS FED. AID PROJECT							
		DATE -	REVISED -									