

MATCH LINE - STA. 6+00.0 CONTINUED BELOW

- = HMA DRIVEWAY PAVEMENT
- APPROXIMATE LOCATION OF CLASS 'D' PATCHES, TYPE II, III, OR IV, 5"
- = EXISTING PAVEMENT TO RECEIVE:
 - HOT-MIX ASPHALT SURFACE COURSE, MIX "C", N50, 2 1/4"
 - POLYMERIZED LEVELING BINDER (MACHINE METHOD), IL-4.75, N50, 1"
 - BITUMINOUS MATERIAL (PRIME COAT) (0.15 GAL/S.Y.)

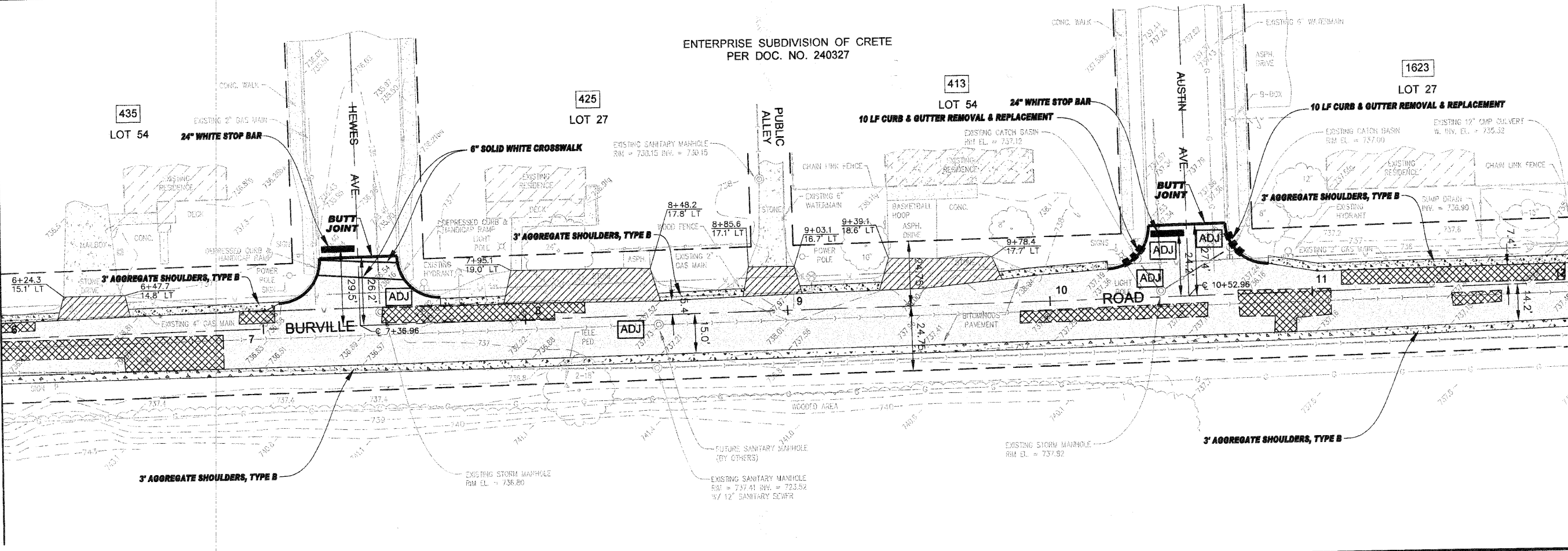

MATCH LINE - STA. 6+00.0 CONTINUED ABOVE



MATCH LINE - STA. 12+00.0 CONTINUED ON SHEET 5

TECH 3 Consulting Group, Inc.
 (630) 657-7000 SURVEYORS
 737 West Exchange St., Crete, IL 60417
 ph 708.672.6934 fax 708.672.3739

USER NAME =	DESIGNED BY = JGB	REVISED - 6/8/10 PER IDOT
PLOT SCALE =	DRAWN BY = JJF	REVISED - 6/28/10 PER IDOT
	CHECKED BY = RWM	REVISED - 7/7/10 PER IDOT
	DATE = 4/27/10	REVISED -

STATE OF ILLINOIS
DEPARTMENT OF TRANSPORTATION



Village of CRETE
BURVILLE ROAD RESURFACING
SITE PLAN - STA. 1+33 TO 12+00

SCALE: 1" = 20' SHEET NO. 4 OF 14 SHEETS STA. 1+33 TO 12+00

FAU. RATE	SECTION	COUNTY	TOTAL SHEET	SHEET NO.
4305	10-00046-00-RS	WILL	14	4
FED. ROAD DIST. NO. 1		CONTRACT NO. 63490		
		FED. AID PROJECT		